



For Sale

±11,400 SF Hangar

1500 Sally Ride Drive | Concord, CA

Property Highlights

Colliers is pleased to present a rare opportunity to acquire a private aircraft hangar at Buchanan Field Airport in Concord, CA, available on a long-term ground lease. Located at 1500 Sally Ride Drive, this ±11,400 SF facility features a ±7,400 SF hangar bay and a ±4,000 SF two-story office. The office space includes a welcoming lobby, three conference rooms, a kitchen, a break room, ample storage, and restroom facilities with showers. Additionally, the property offers a ±700 SF workshop with a roll-up door, conveniently situated adjacent to the hangar. This unique offering provides a prime aviation asset in a highly sought-after location.

Contact Brokers

Spencer Bones

Vice President
CA License No. 02014924
spencer.bones@colliers.com
+1 916 873 3445

Jon Quick

Senior Vice President
CA License No. 01242750
jon.quick@colliers.com
+1 707 863 8359

Floor Plan

First Floor

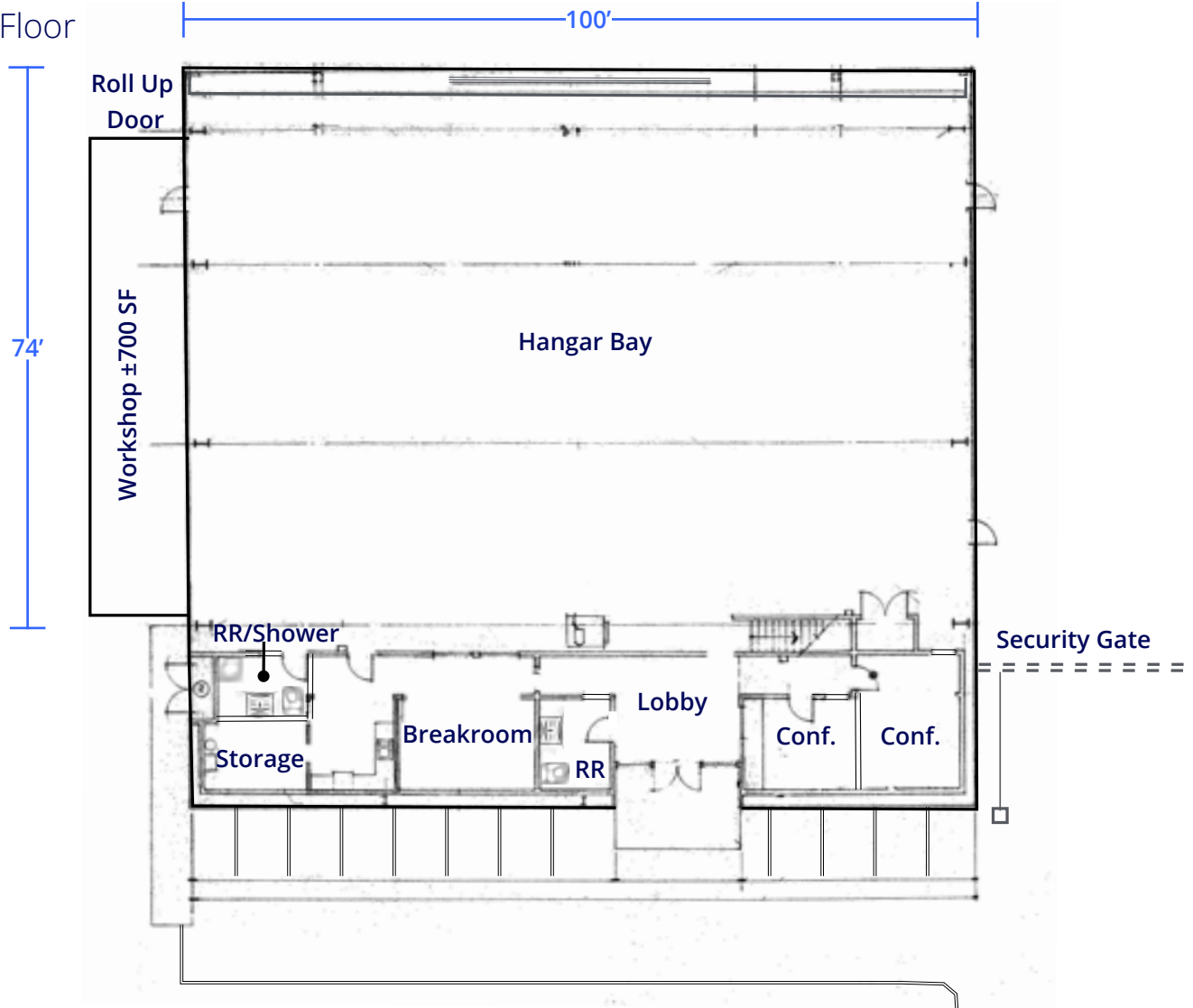

Second Floor



Property Specifications



Property Specifications

Building Size:	±11,400 SF
Lot Size:	0.86 Acres
Hangar Bay:	±7,400 SF (100' wide x 74' deep)
Office Space:	±4,000 SF (two-story)
Hangar Door:	19' tall x 65' wide
Loading Door:	1 grade level
Power:	400 amp; 240 volt
Built:	1996
Parking:	8 spaces + additional parking behind security gate
Ground Lease:	Thru June 20, 2046 Current monthly rent of \$2,514.88 <i>(can be extended with the county)</i>
Additional Features:	Private key-code controlled access gate; HVAC throughout office and warehouse areas; sprinklers; skylights; LED lighting

Buchanan Field Airport

1500 Sally Ride Drive is situated within Buchanan Field Airport, a county-owned public-use airport in Concord, CA, serving Contra Costa County.

Strategically positioned at the intersection of I-680, Highway 242, and Highway 4, Buchanan Field offers seamless access to the East Bay and the greater San Francisco Bay Area.

The airport is home to a variety of aviation-related businesses, including flight clubs, hangar rentals, and fixed base operations (FBO). It also features daily public charter service via JetSuiteX, connecting Concord to Burbank (LA) and Las Vegas. Surrounding the airport, visitors and tenants enjoy convenient access to dining, lodging, transportation, and entertainment options in the city of Concord.

1500 Sally Ride Drive | Concord, CA

Location Overview

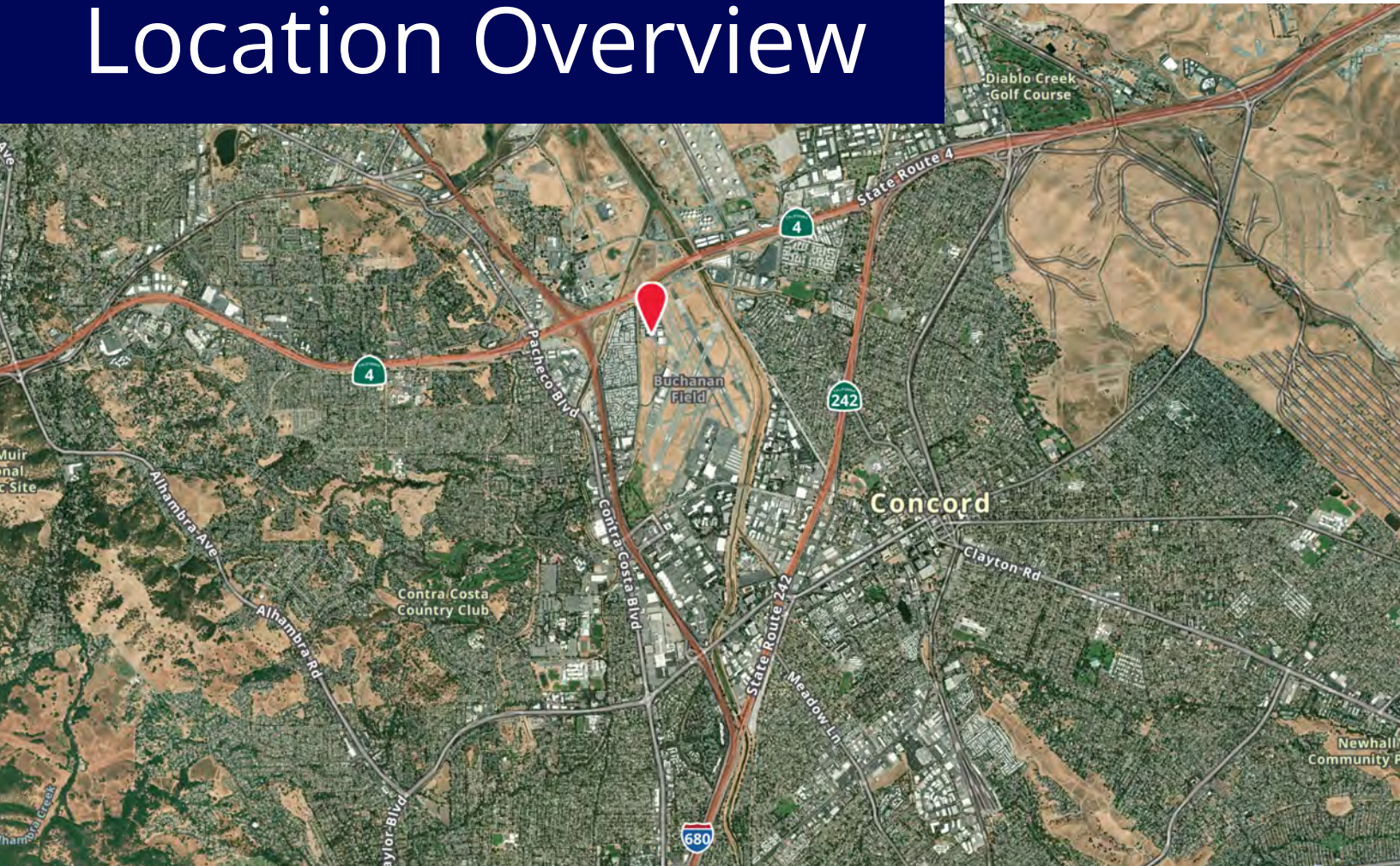

Location Highlights



Located at the
Buchanan Field Airport



30 miles to Oakland International Airport
41 miles to San Francisco International Airport
53.2 miles to San Jose International Airport



7 miles to Walnut Creek
22.5 miles to Oakland
31.3 miles to San Francisco
33 miles to Livermore
55.8 miles to San Jose

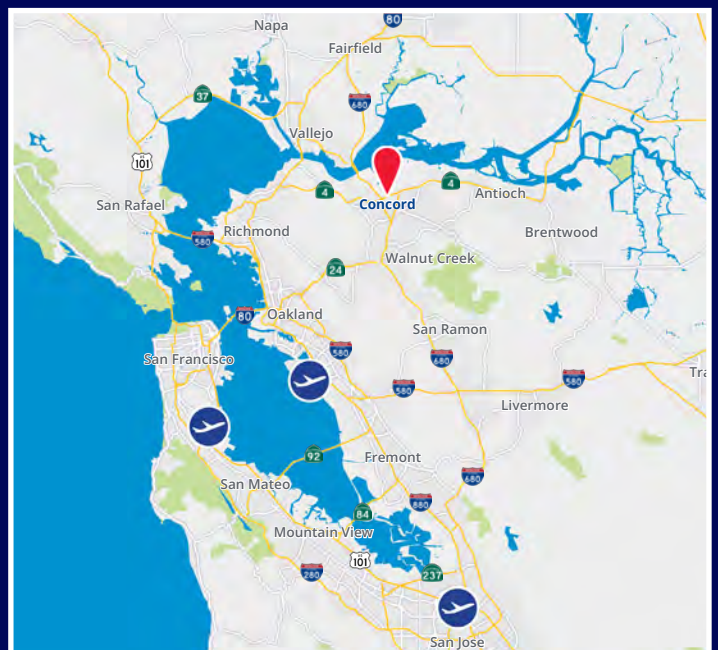

1500 Sally Ride Drive | Concord, CA

Photo Gallery

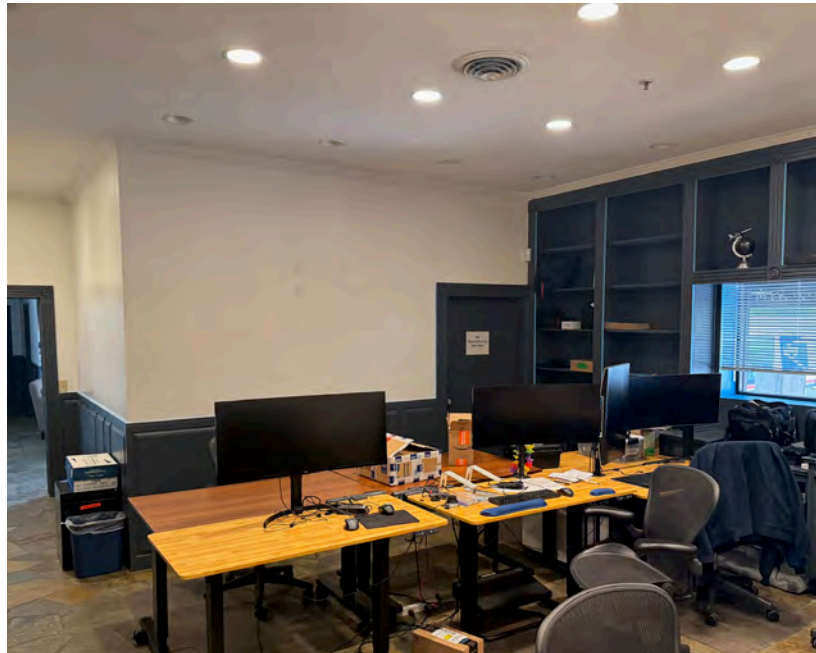
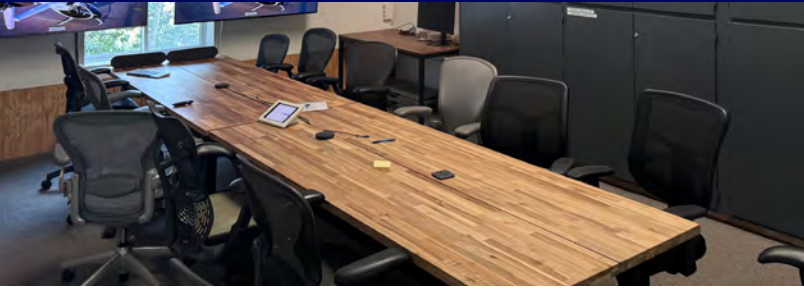

1500 Sally Ride Drive | Concord, CA

Aerial Overview



Contact Brokers

Spencer Bones

Vice President
CA License No. 02014924
spencer.bones@colliers.com
+1 916 873 3445

Jon Quick

Senior Vice President
CA License No. 01242750
jon.quick@colliers.com
+1 707 863 8359

Copyright © 2025 Colliers.
Information herein has been obtained from sources deemed reliable, however its accuracy cannot be guaranteed. The user is required to conduct their own due diligence and verification.

