

# 2970-2990 Congressman Lane

Dallas, Texas 75220

FOR SALE OR FOR LEASE



## BUILDING OFFERING

- Excellent Owner User Opportunity with In Place Income
- 51% Contiguous Vacancy Available
- 23,337 Total Square Feet (BOMA 2019)
- 15,427 SF Contiguous Space Available
- Loading: Dock High, Side & Front, and Ramp
- 40+ Parking Spaces (expandable)
- 14' Clear Height
- IR Zoning
- **Call Brokers for Pricing Guidance**

## SPACE AVAILABILITY

- 5 Total Suites (2 Leased / 3 Vacant)
- **Suite 2970 - 4,526 SF**
  - End Cap Space
  - 1 Grade Level Side Load Door
  - 1 Dock High Door
- **Suite 2978 - 3,423 SF**
  - 1 Dock High Door
  - April 2026 Availability
- **Suite 2982-2986 - 6,778 SF**
  - 2 Dock High Doors

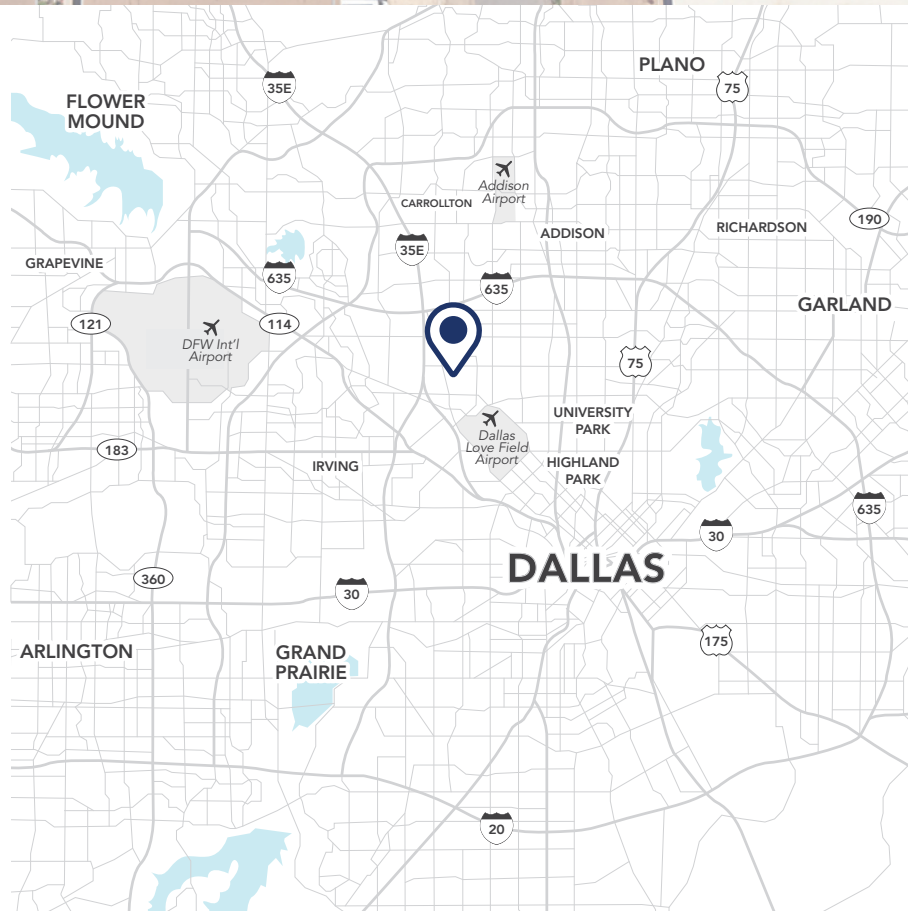

**Jamie Jennings** (Sale & Leasing)  
jjennings@streamrealty.com  
214.914.1809

**Giovanni Scardino** (Leasing)  
giovanni.scardino@streamrealty.com  
847.612.8488

**STREAM**®

# 2970-2990 Congressman Lane

Dallas, Texas 75220

FOR SALE OR FOR LEASE



**Jamie Jennings** (Sale & Leasing)  
jjennings@streamrealty.com  
214.914.1809

**Giovanni Scardino** (Leasing)  
giovanni.scardino@streamrealty.com  
847.612.8488

**STREAM**<sup>®</sup>

# 2970-2990 Congressman Lane

Dallas, Texas 75220

FOR SALE OR FOR LEASE



2970 - 2986 Congressman



2982-2986 Congressman - Warehouse

**Jamie Jennings** (Sale & Leasing)  
jjennings@streamrealty.com  
214.914.1809

**Giovanni Scardino** (Leasing)  
giovanni.scardino@streamrealty.com  
847.612.8488

**STREAM**®

# 2970-2990 Congressman Lane

Dallas, Texas 75220

FOR SALE OR FOR LEASE

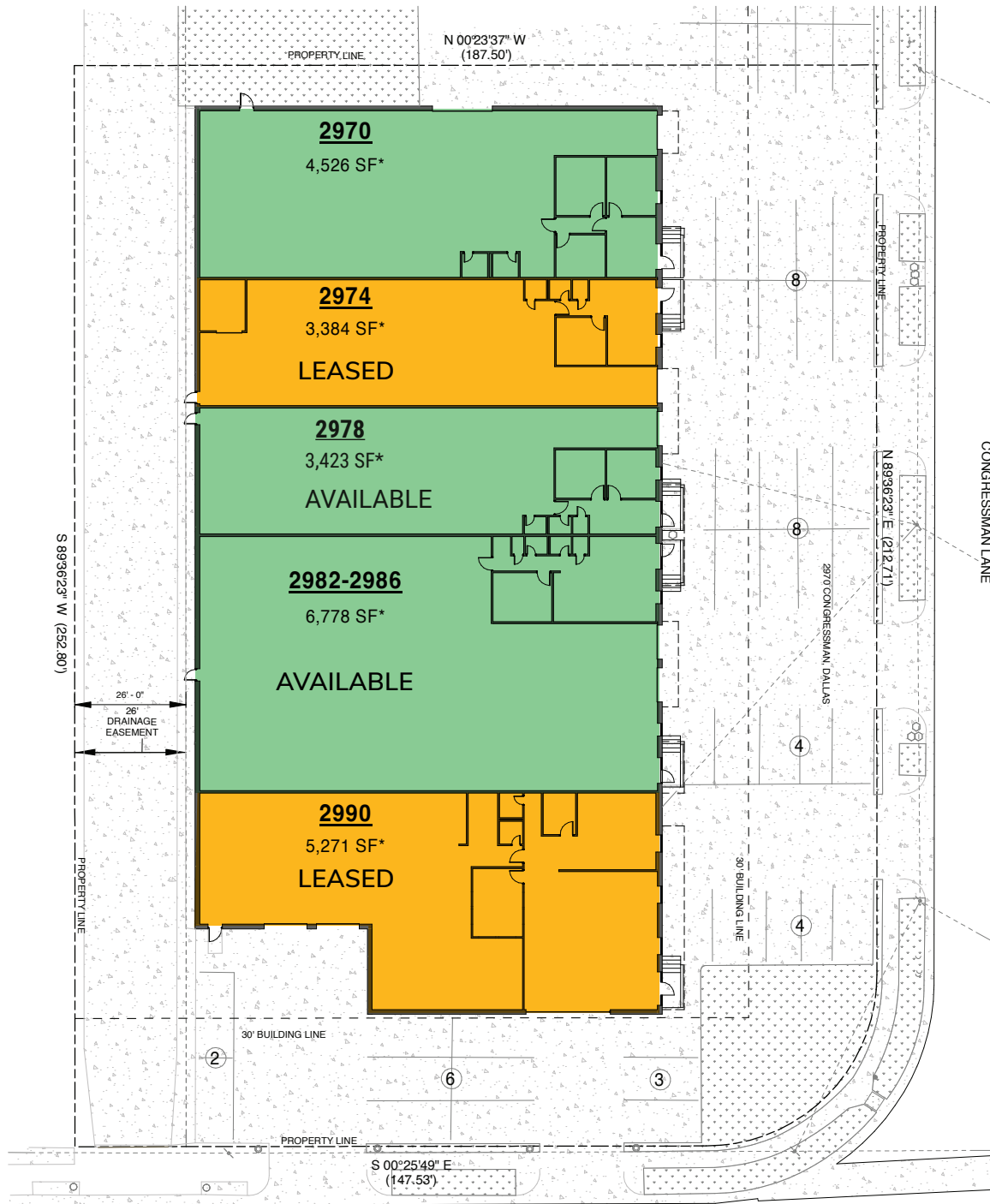

**Jamie Jennings** (Sale & Leasing)  
jjennings@streamrealty.com  
214.914.1809

**Giovanni Scardino** (Leasing)  
giovanni.scardino@streamrealty.com  
847.612.8488



# 2970-2990 Congressman Lane

Dallas, Texas 75220

FOR SALE OR FOR LEASE

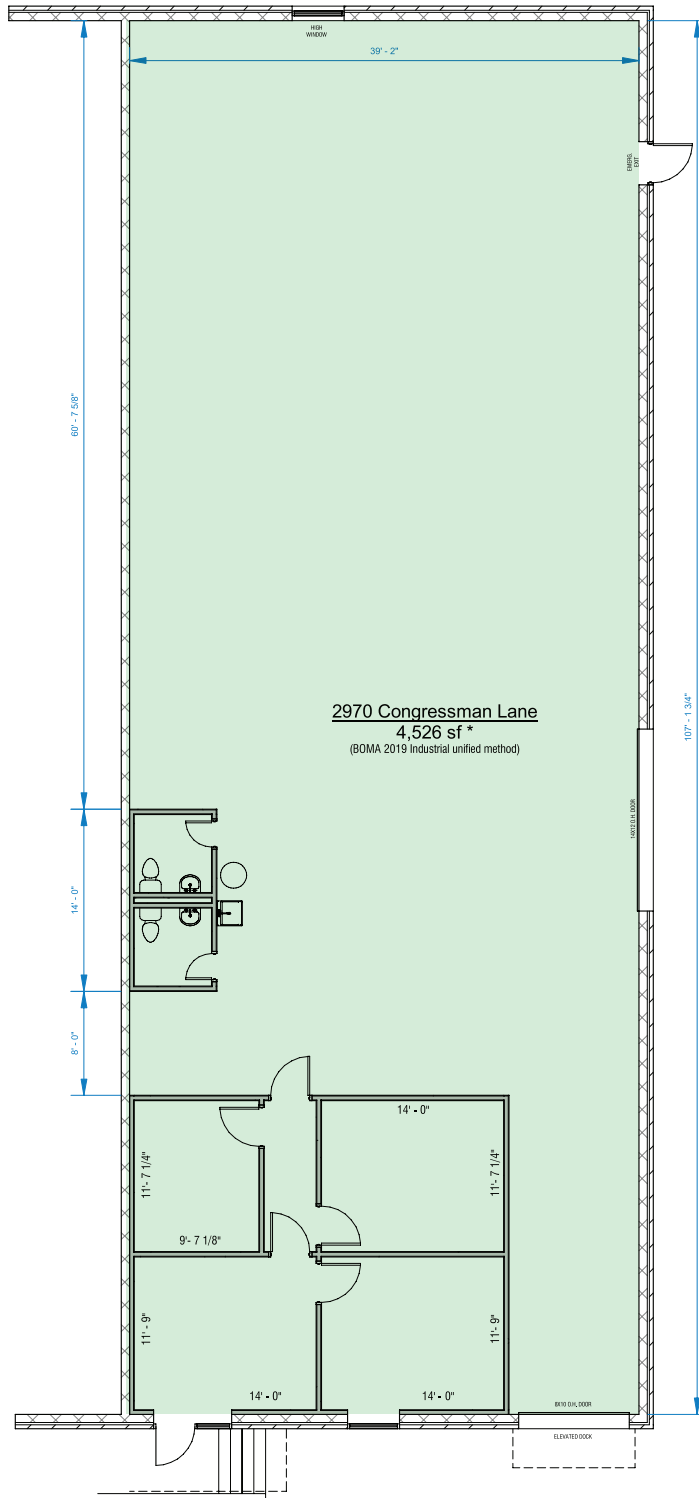

## 2970 Congressman Lane

### AREA SCHEDULE:

Warehouse Area = 3,711 sf  
Office Area = 815 sf  
Total Area = 4,526 sf



**Jamie Jennings** (Sale & Leasing)  
jjennings@streamrealty.com  
214.914.1809

**Giovanni Scardino** (Leasing)  
giovanni.scardino@streamrealty.com  
847.612.8488

**STREAM**

# 2970-2990 Congressman Lane

Dallas, Texas 75220

FOR SALE OR FOR LEASE

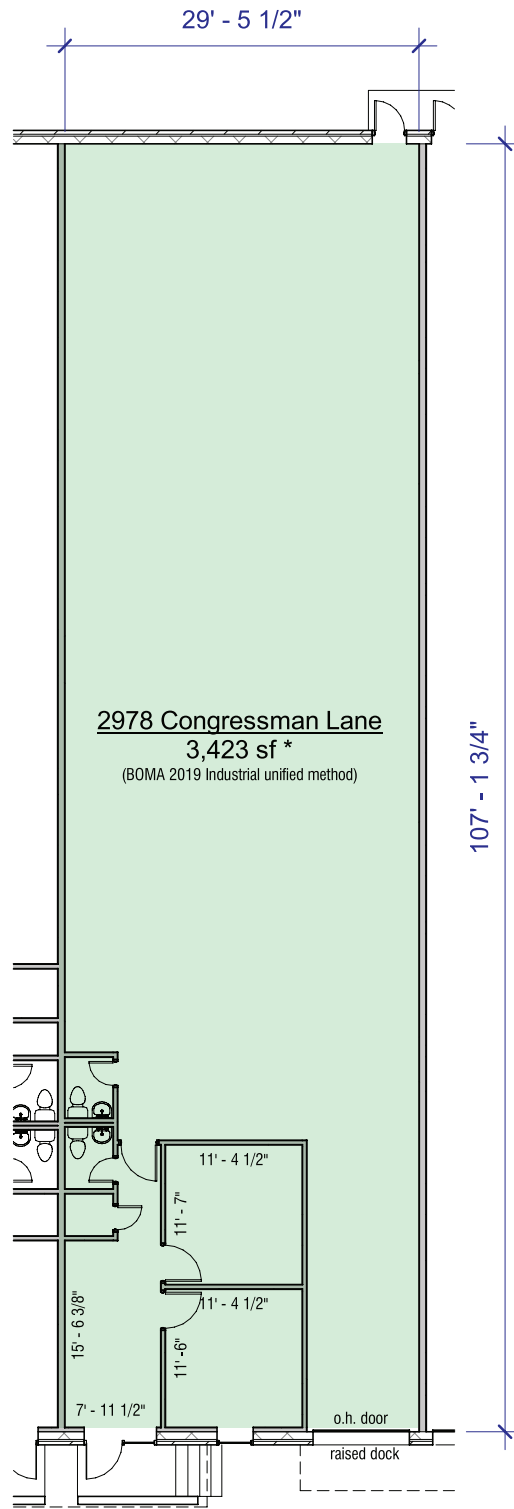

## 2978 Congressman Lane

### AREA SCHEDULE:

Warehouse Area	=	2,835
Office Area	=	588
Total Area	=	3,423



# 2970-2990 Congressman Lane

Dallas, Texas 75220

FOR SALE OR FOR LEASE

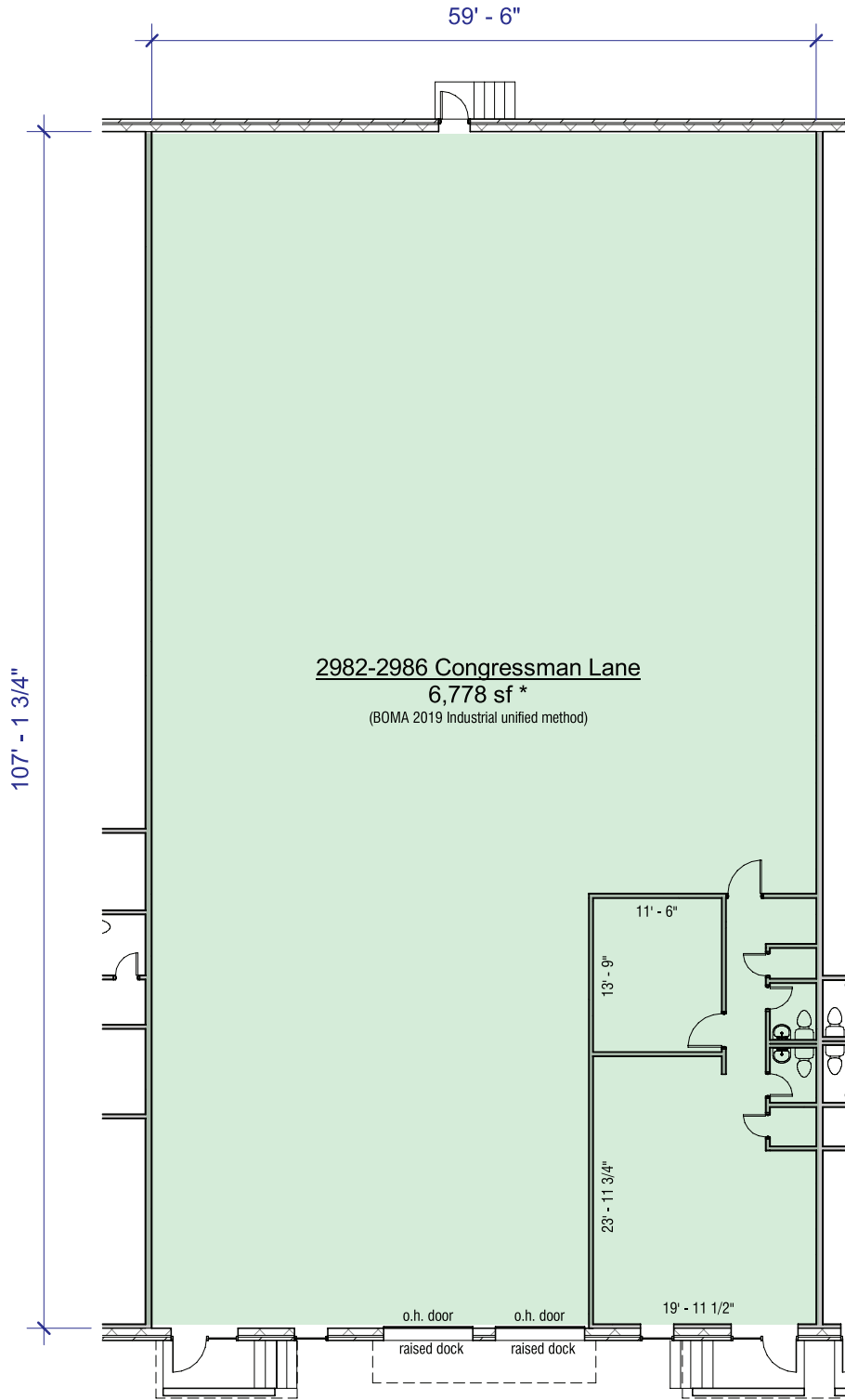

## 2982-2986 Congressman Lane

### AREA SCHEDULE:

Warehouse Area	=	5,888
Office Area	=	890
Total Area	=	6,778



**Jamie Jennings** (Sale & Leasing)  
jjennings@streamrealty.com  
214.914.1809

**Giovanni Scardino** (Leasing)  
giovanni.scardino@streamrealty.com  
847.612.8488

**STREAM**<sup>®</sup>

# 2970–2990 Congressman Lane

Dallas, Texas 75220

FOR SALE OR FOR LEASE

## Confidentiality Statement & Disclaimer

The information contained in this package is furnished solely for the purpose of review by a prospective purchaser of 2970 – 2990 Congressman, Dallas, Texas (“Property”), and is not to be used for any other purpose or made available to any other person without the express written consent of Stream Realty Partners, L.P., Property Owner or any of their respective affiliates (“Stream”). The information contained in this package is from sources deemed reliable, but is not guaranteed by Stream or Owner in any way and is subject to change in price, corrections, errors and omissions, prior sale, or withdrawal without notice.

Summaries of any documents are not intended to be comprehensive or all-inclusive, but rather a general outline of the pertinent provisions contained herein. Prospective purchasers should rely upon their own financial projections and conclusions without reliance upon the material contained herein and conduct their own independent due diligence, including engineering and environmental inspections, to determine the condition of the Property and the existence of any potentially hazardous material used in the construction or maintenance of the Property or located at the site.

No copies of this package may be made in whole or in part without the prior written consent of Stream or the Property Owner. This package is the property of Stream and may be used only by parties approved by Stream or the Property Owner. The Property is privately offered and, by accepting this package, the party in possession hereof agrees that the package and its contents are of a confidential nature and will be held and treated in the strictest confidence.

[Information On Brokerage Services](#)



**Jamie Jennings** (Sale & Leasing)  
jjennings@streamrealty.com  
214.914.1809

**Giovanni Scardino** (Leasing)  
giovanni.scardino@streamrealty.com  
847.612.8488

**STREAM**<sup>®</sup>