

Pinnacle at Ridgeway

10535 PARK MEADOWS BLVD.
SUITE 210 | LONE TREE, CO 80124



2,350 RSF
FOR SUBLEASE



KINSEY & COMPANY
COMMERCIAL REAL ESTATE

Jason F. Kinsey
Managing Principal
720-280-5757
Jason@KinseyCRE.com

Brady Kinsey
Principal
303-847-1295
Brady@KinseyCRE.com

Availability

- Availability: Sublease
- Pricing: Contact Broker
- Term Remaining: 3 Years
- SF: 2,350 RSF



Park Meadows Blvd.

Highlights

- Medical spa space for lease within a Class-A building
- High end finishes with:
 - 5 Exam / Treatment Rooms
 - In suite restroom
 - Mountain views
 - Functional modern medical buildout
- Move-in Ready
- Sought after outpatient medical building across from Sky Ridge Medical Center
- Abundant parking ratio of 4.25/1,000 SF
- On-site building maintenance
- Directly next to Charles Schwab corporate offices

No representations or warranties, expressed or implied, are made as to the accuracy of the information contained herein. Prospective tenant must independently verify the information and bears all risk for inaccuracies. Prices, terms, and availability are subject to change and/or withdrawal without notice

Pinnacle at Ridgeway

10535 PARK MEADOWS BLVD.
LONE TREE, CO 80124

Floor Plan

Suite 210 | 2,350 RSF

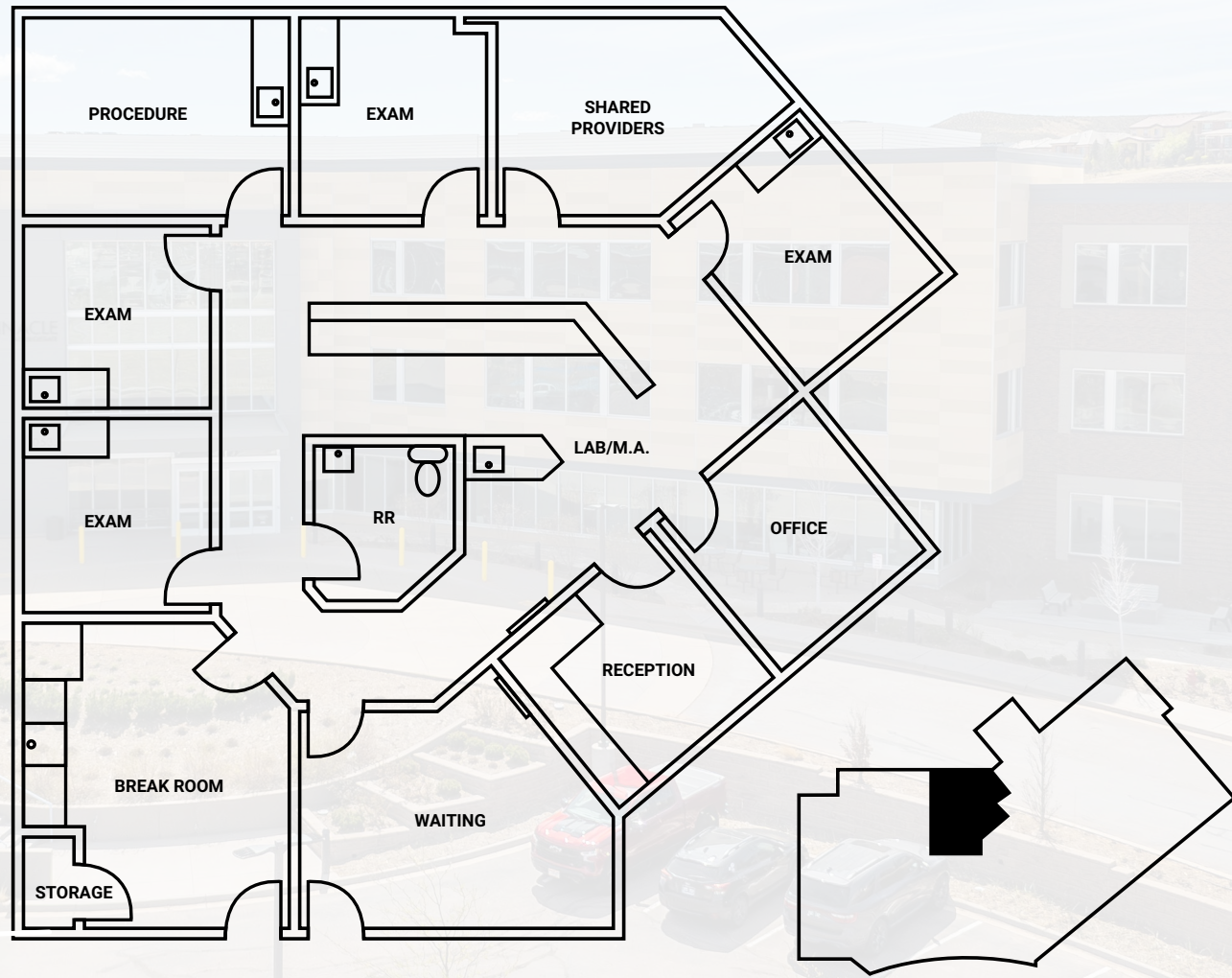

No representations or warranties, expressed or implied, are made as to the accuracy of the information contained herein. Prospective tenant must independently verify the information and bears all risk for inaccuracies. Prices, terms, and availability are subject to change and/or withdrawal without notice

Pinnacle at Ridgeway

10535 PARK MEADOWS BLVD.
SUITE 210 | LONE TREE, CO 80124





Demographics

	1 Mile	3 Miles	5 Miles
Population	8,614	59,363	194,601
Average Household Income	\$151,188	\$157,944	\$163,259
Daytime Population	9,904	45,476	119,719

Source: CoStar

Pinnacle at Ridgeway



Jason F. Kinsey
 Managing Principal
 720-280-5757
 Jason@KinseyCRE.com

Brady Kinsey
 Principal
 303-847-1295
 Brady@KinseyCRE.com

Disclaimer: The Interested Party acknowledges that any documents or information ("Materials") received from the Property Owner are provided solely for reference and review. The Property Owner makes no representations, expressed or implied, regarding the accuracy or completeness of these Materials. The Interested Party assumes full responsibility for evaluating all provided documents, which may include maps, schematics, and other property-related data. This includes, but is not limited to: (i) the structural integrity, condition, and features of the Property, including roofing, foundation, utilities, and landscaping; (ii) soil composition, geological factors, and groundwater conditions; (iii) the availability and adequacy of utility services; (iv) zoning, land use regulations, and development feasibility; (v) legal restrictions affecting the Property; (vi) adherence to applicable laws, codes, and regulations; (vii) potential environmental hazards on or near the premises; (viii) the quality of workmanship and materials in any existing structures; and (ix) the status of the Property's title. The Property Owner is not responsible for any conclusions drawn by the Interested Party based on these Materials. It is the sole duty of the Interested Party to conduct independent due diligence before finalizing any transaction. All documents are provided without warranty, and the Interested Party waives any claims against the Listing Agent and Property Owner regarding the accuracy or reliability of the information furnished.