

6575 Kirkville Road

East Syracuse, NY 13057

3,306 SF AVAILABLE



6575 Kirkville Road
East Syracuse, NY 13057

For Lease

3,306 SF Medical Office space available in this prime East Syracuse location, close to both I-690 and I-481. Full-height windows offer an abundance of natural light and the layout can be modified to meet the needs of the tenant. The space also has an on-site landlord, ample parking close to the building with neighboring tenant CNY Periodontics & Implants.

Property Highlights

- + 7,000 SF office building built in 2005
- + On-site landlord
- + Large floor to ceiling windows provide ample natural light
- + Excellent access to I-481 and I-690
- + Layout can be modified to meet tenant's needs
- + Ample parking in proximity to office suite
- + Signage available on Kirkville Road



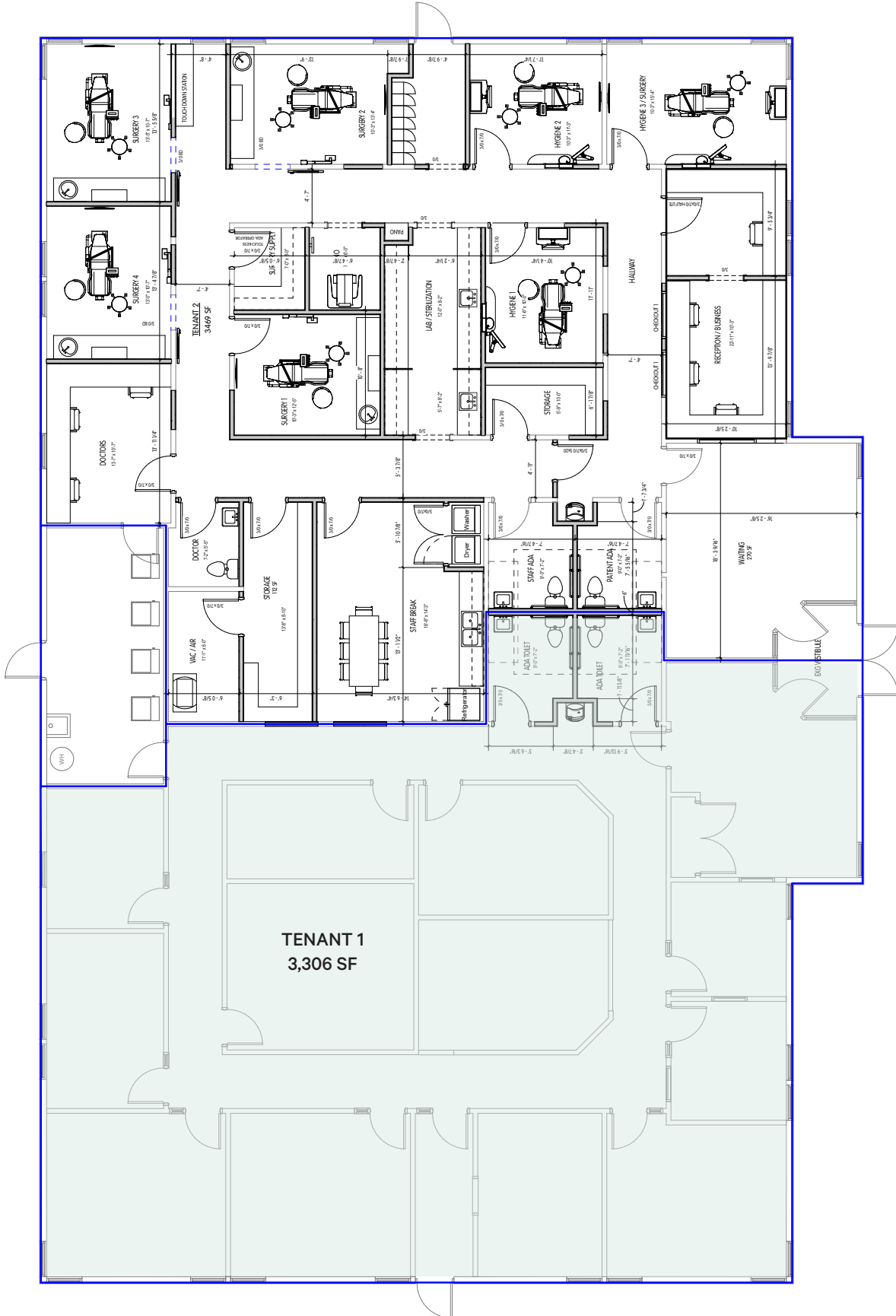

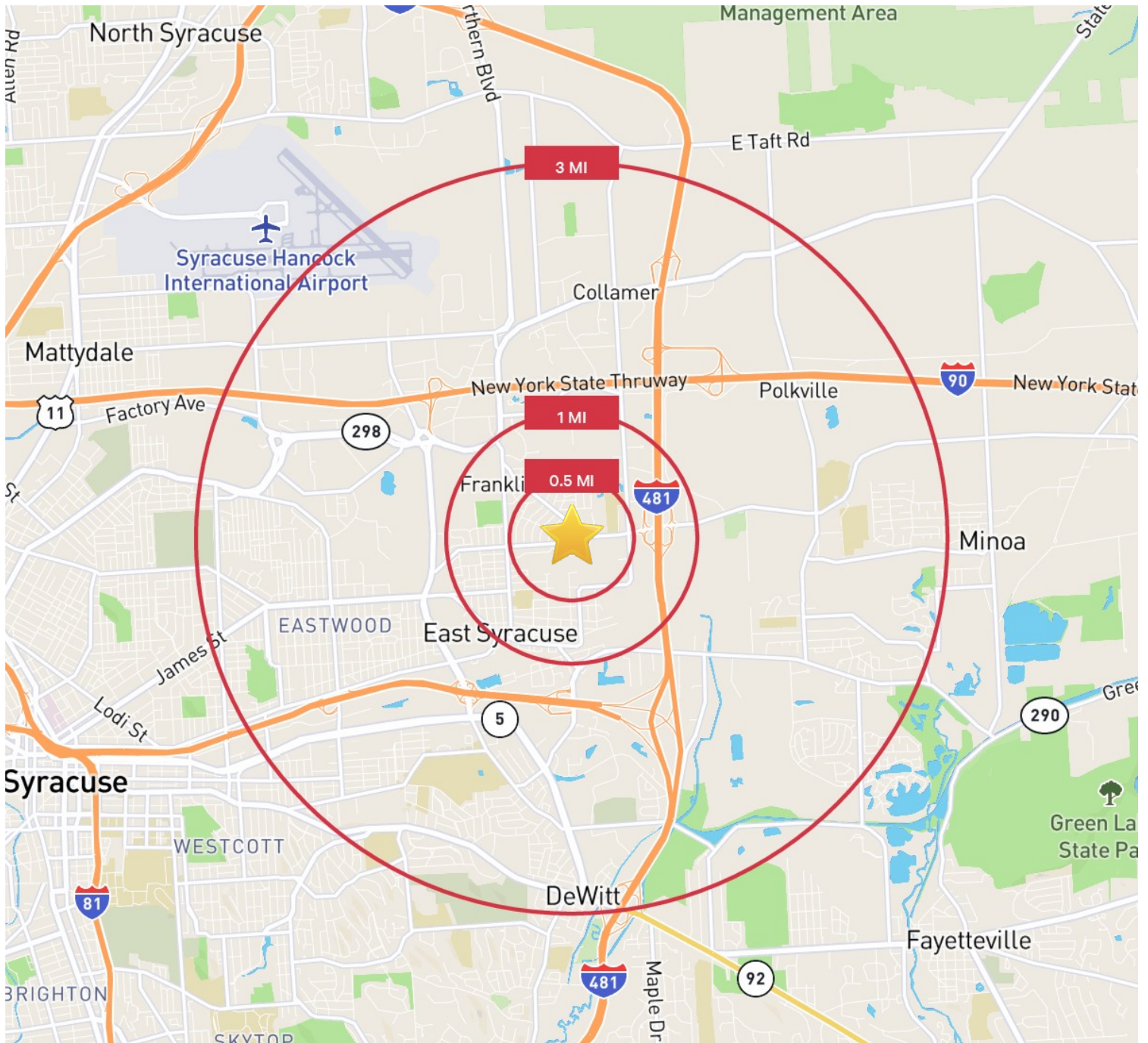

Area Demographics	.5 mi.	1 mi.	3 mi.
Total Population	2,286	7,544	42,530
Avg. Household Income	\$83,473	\$85,067	\$91,271
Housing Units	1,204	3,889	20,241

Annual Average Daily Traffic (AADT) = 11,110

6575 Kirkville Road
East Syracuse, NY 13057

For Lease



Contact Us

Cory LaDuke, SIOR

Lic. Associate Real Estate Broker
+1 315 422 4200 x 321
cory.laduke@cbre-syr.com

CBRE Upstate NY

500 Plum Street, Suite 402
Syracuse, New York 13204
+1 315 422 4200

© 2025 CBRE Upstate NY, part of the CBRE Affiliate Network. All rights reserved. This information has been obtained from sources believed reliable, but has not been verified for accuracy or completeness. You should conduct a careful, independent investigation of the property and verify all information. Any reliance on this information is solely at your own risk. CBRE Upstate NY and the CBRE Upstate NY logo are service marks of CBRE Upstate NY. All other marks displayed on this document are the property of their respective owners, and the use of such logos does not imply any affiliation with or endorsement of CBRE Upstate NY. Photos herein are the property of their respective owners. Use of these images without the express written consent of the owner is prohibited.

www.cbre.com/syracuse

CBRE Upstate NY
PART OF THE AFFILIATE NETWORK