

AVAILABLE FOR LEASE

Heritage Crossing
5019 Ace Lane Unit #167
Naperville, IL 60564



1,922 SF

RETAIL SPACE

\$20.00 PSF
NNN

- 1,922 SF store front retail space – END CAP

AVAILABLE NOW!

- Signage on both route 59 and 111th street
- Ample parking & located directly across the street from TJ Maxx and adjacent to Ace Hardware

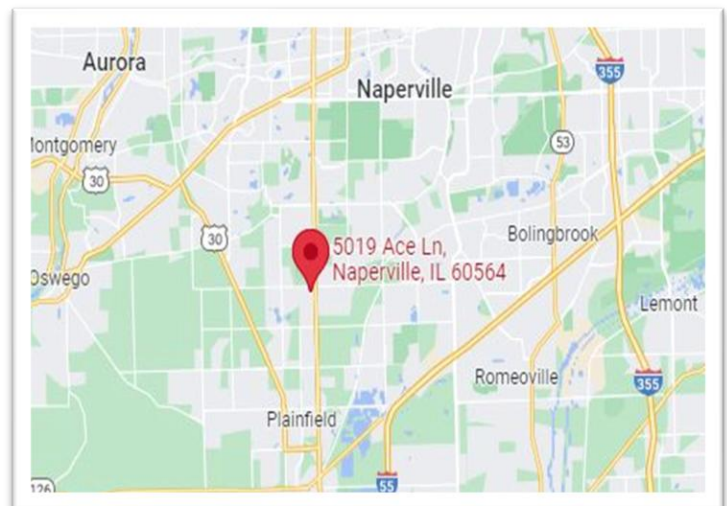

**KEY INVESTMENT
& Management Inc.**

Office: 630.932.5757
Fax: 630.932.5755
1263 S. Highland Ave., Suite 2W,
Lombard, IL 60148
www.key-investment.com

FOR FURTHER INFORMATION CONTACT:

Kimberly Hess

Phone: 630.932.5757

khess@key-investment.com

3/31/26

Real Estate

Brokerage

Leasing

Management

Heritage Crossing
5019 Ace Lane Unit #167
Naperville, IL 60564

1263 S. Highland Ave, Suite 2W
 Lombard, IL 60148
 Office: 630.932.5757
key-investment.com
 Kimberly Hess
khess@key-investment.com



AVAILABLE FOR LEASE

PROPERTY SPECIFICATIONS	
Building Size:	25,497 SF
Available Space:	1,922 SF
Year Built:	2000
Zoning:	B-2 Naperville
Parking:	Open lot
Ceiling Height:	'11 '18 to top of ceiling
Power:	100 AMP
Washrooms:	1 ADA
Sprinklered:	Yes
Utilities:	Gas & Electric
Real Estate Taxes:	\$3.20 PSF
CAM:	\$3.90 PSF
Possession:	Immediately
Lease Term:	3 years minimum
Lease Rate:	\$20.00 PSF Base

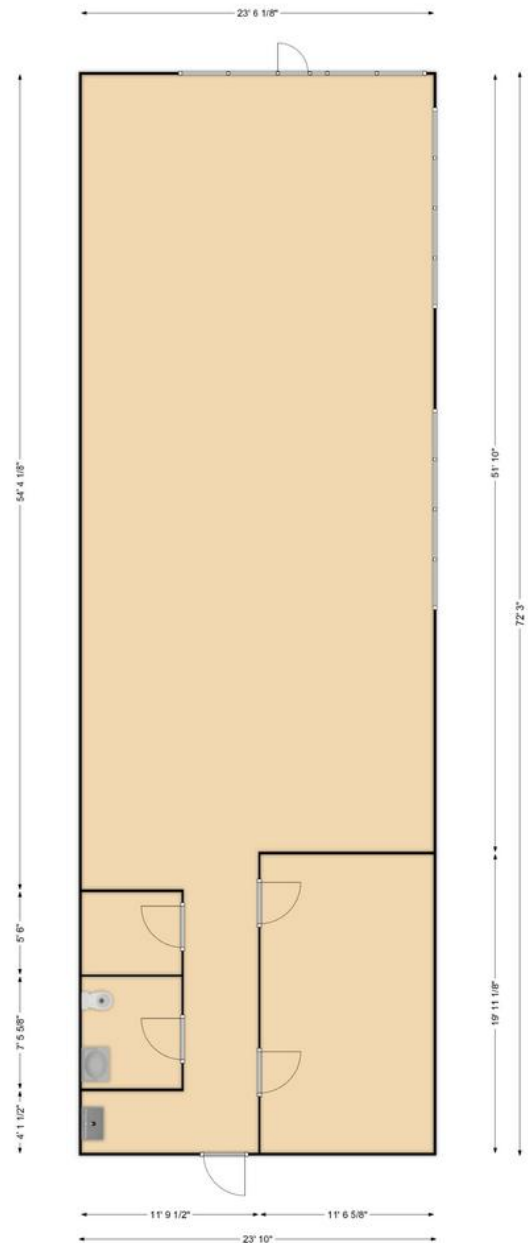

All dimensions are approximate. Drawing not to scale.



Real Estate

Brokerage

Leasing

Management