

FOR LEASE



INLAND
EMPIRE

±5,400 SQ.FT. INDUSTRIAL BUILDING

1443 S. GAGE ST., SAN BERNARDINO, CA 92408



PROPERTY FEATURES

Building Size: ± 5,400 Sq.Ft

Lot Size: ± 10,815 Sq.Ft.

APN: 0281-041-52-0000

Zoning: Industrial Heavy (IH) per the City of San Bernardino, CA

PROPERTY HIGHLIGHTS

- ±900 sq.ft. Office Space
- 2 Ground Level Doors (10' x 14')
- ±17' Clear Height
- Private & Secured Yard
- ±400 AMPS, 277/480v, 3-Phase, 4-Wire Power (verify)
- Great Access to I-10 Freeway from S. Tippecanoe Ave., Minutes from the I-215 Freeway

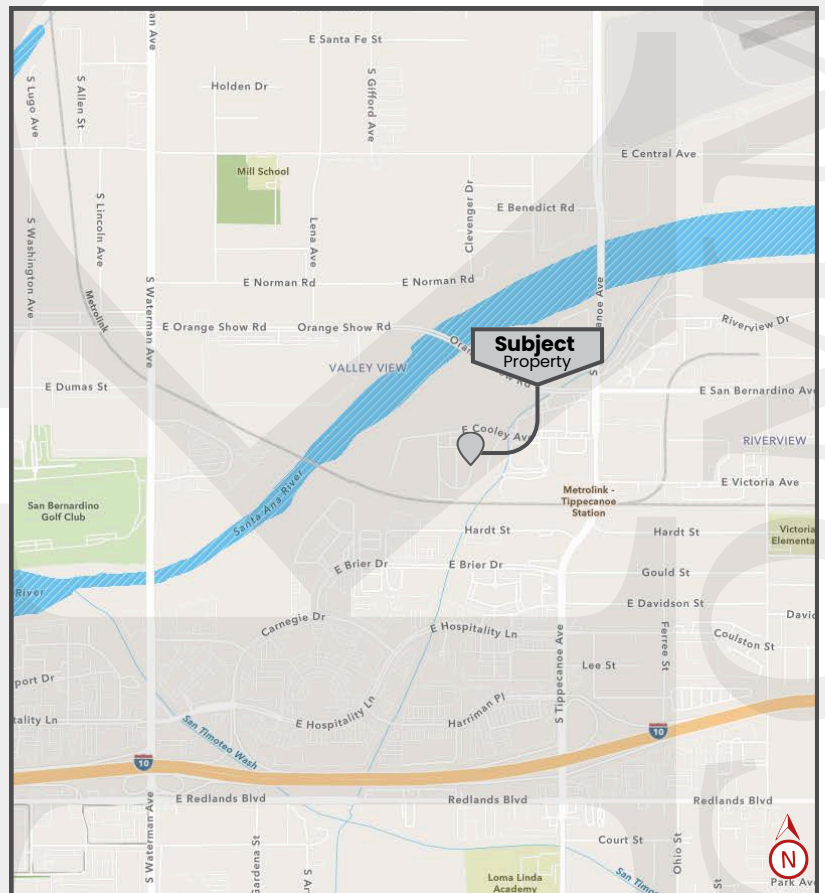

FOR LEASE

±5,400 SQ.FT. INDUSTRIAL BUILDING

1443 S. GAGE ST., SAN BERNARDINO, CA 92408



**INLAND
EMPIRE**

ADDITIONAL PICTURES



FOR LEASE

±5,400 SQ.FT. INDUSTRIAL BUILDING

1443 S. GAGE ST., SAN BERNARDINO, CA 92408



**INLAND
EMPIRE**

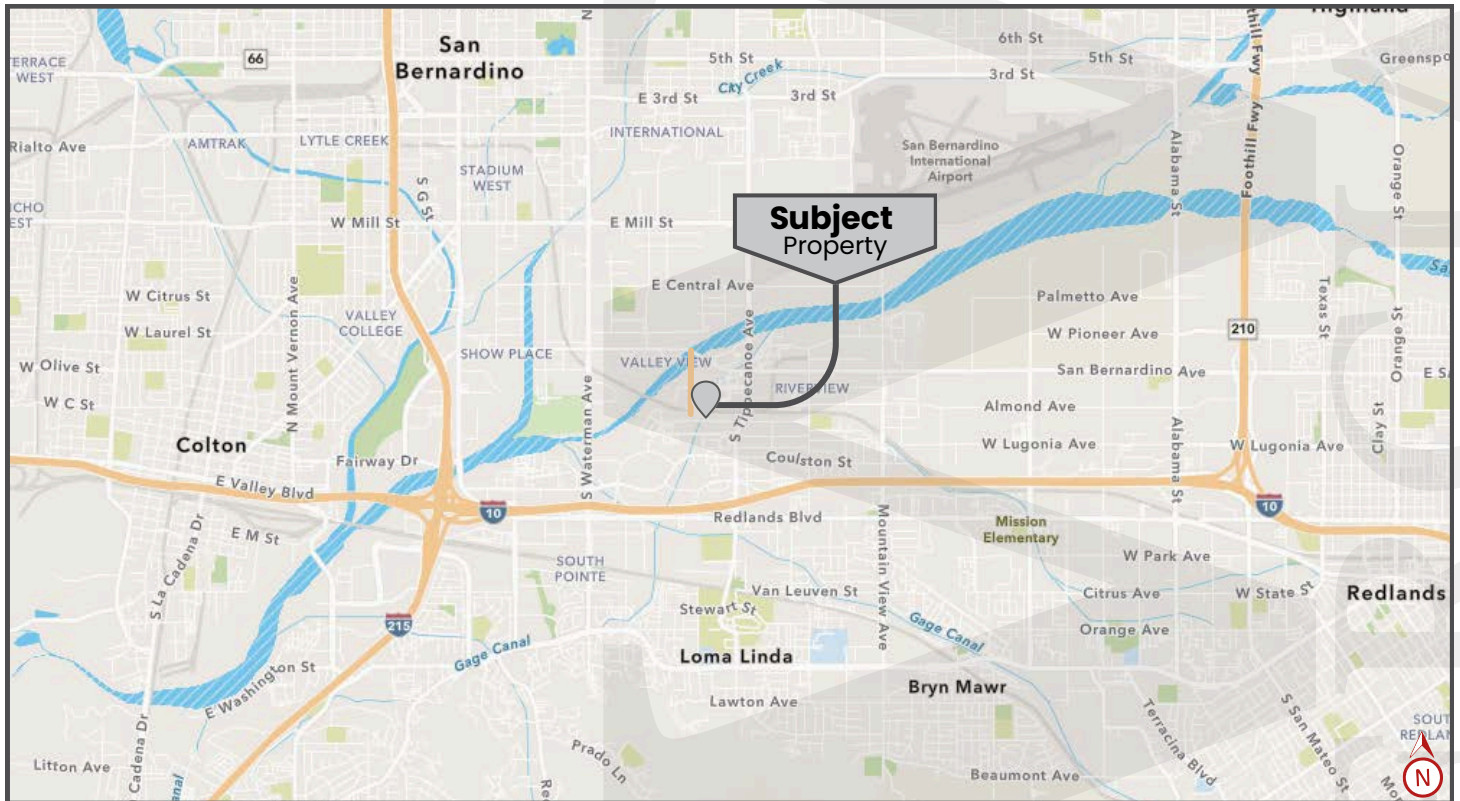

Rene Ramos, Jr.
T(909) 980-6868
Rene.Ramos@kwcommercial.com
CalDRE Lic. #01836872

Jacob B. Bernardy
T(909) 935-0935
Jacob.Bernardy@kwcommercial.com
CalDRE Lic. #02039512

Robert D. Bagley III
T(909) 935-0938
robert.bagley@kwcommercial.com
CalDRE Lic. #02131874

Daniel W. Richards
T(909) 243-7747 x 22
Daniel.Richards@kwcommercial.com
CalDRE Lic. #00803221



WE OBTAINED THE INFORMATION ABOVE FROM SOURCES WE BELIEVE TO BE RELIABLE. HOWEVER, WE HAVE NOT VERIFIED ITS ACCURACY AND MAKE NO GUARANTEE, WARRANTY, OR REPRESENTATION ABOUT IT. IT IS SUBMITTED SUBJECT TO THE POSSIBILITY OF ERRORS, OMISSIONS, CHANGE OF PRICE, RENTAL OR OTHER CONDITIONS, PRIOR SALE, LEASE OR FINANCING, OR WITHDRAWAL WITHOUT NOTICE. WE INCLUDE PROJECTIONS, OPINIONS, ASSUMPTIONS OR ESTIMATES FOR EXAMPLE ONLY, AND THEY MAY NOT REPRESENT CURRENT OR FUTURE PERFORMANCE OF THE PROPERTY. YOU AND YOUR TAX AND LEGAL ADVISORS SHOULD CONDUCT YOUR OWN INVESTIGATION OF THE PROPERTY AND TRANSACTION.

KW COMMERCIAL- INLAND EMPIRE

3595-1 Inland Empire Blvd.

Suite 1250

Ontario, CA 91764

909.980.6868

www.kwcie.com