

SUBJECT
PROPERTY

E MCLELLAN RD

E IVY ST

FOR LEASE

*±8,500 SF Suite Available with Yard,
Located in Mesa, Arizona.*

800 AMPS, 120V/208V
BUILDING POWER

4725 E IVY ST, SUITE 102, MESA, AZ 85205

APRIL 1, 2026

DATE AVAILABLE

\$1.30/SF

NNN



±8,500 SF industrial suite with quality improvements and fenced yard access in a prime Mesa industrial location.

ADDRESS	4725 E Ivy St, Suite 102 Mesa, AZ 85205
SUITE SIZE	±8,500 SF
OFFICE SIZE	±1,500 SF
POWER	800 Amps, 120/208
INSULATED	Yes
SPRINKLERS	Yes
HVAC	90%
ZONED	LI (Light Industrial)
CLEAR HEIGHT	±15' to Drop Ceiling
YARD	Fenced/Shared
APN	141-34-302
ASKING RATE	\$1.30/SF NNN
DATE AVAILABLE	April 1st, 2026

FLOOR PLAN

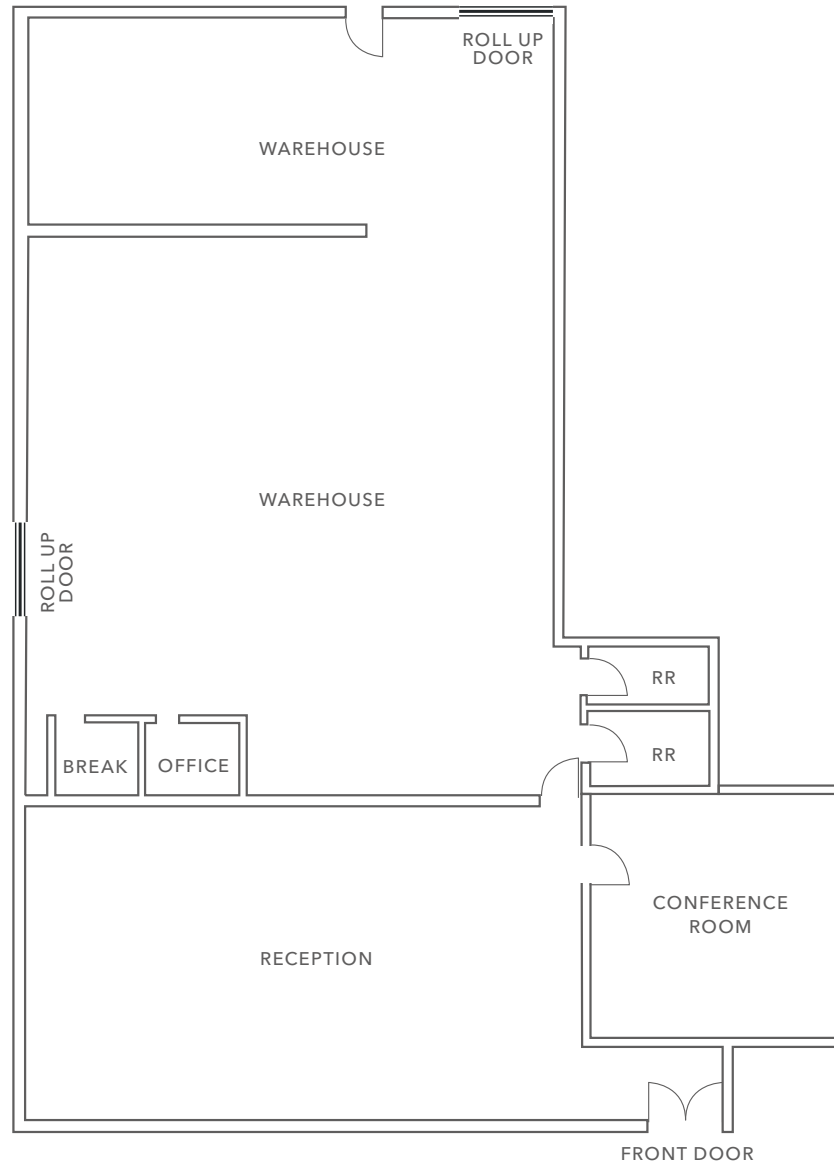

±8,500 SF

SUITE SIZE

±1,500 SF

OFFICE SIZE

Floor Plan is Not to Scale

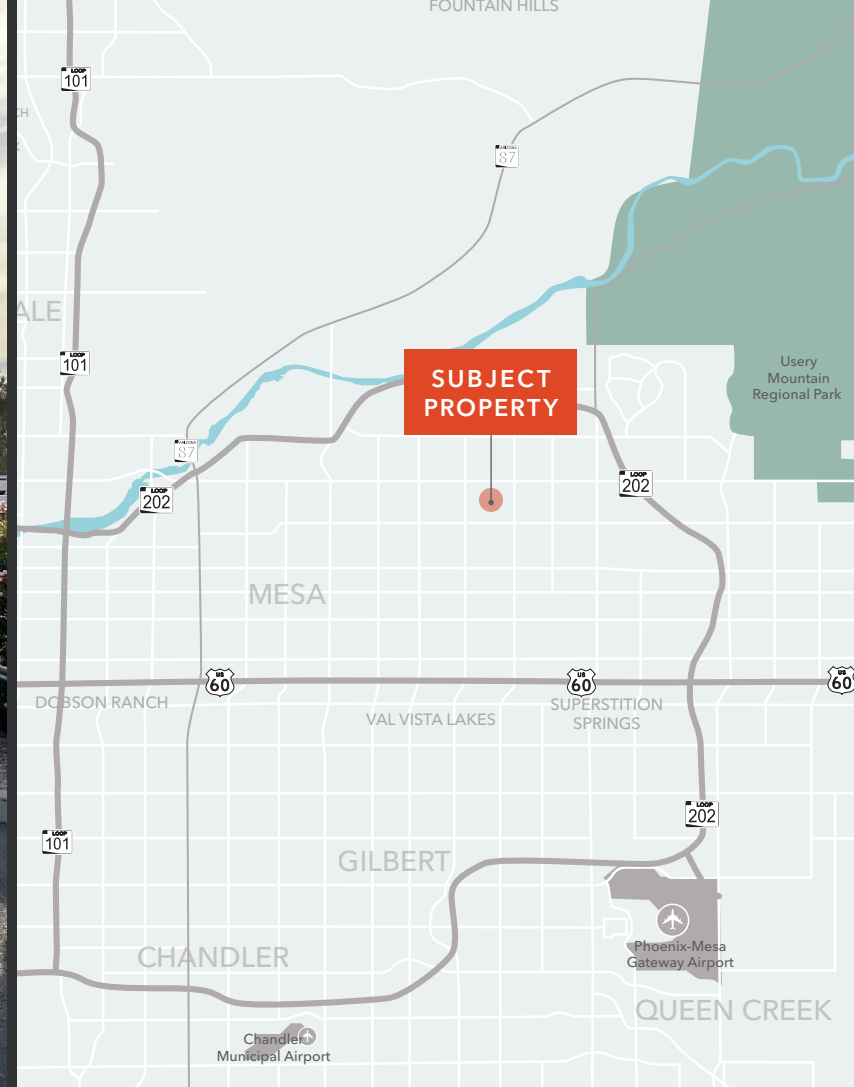

4725 E IVY ST

*For more information on
this property, please contact*

KENT HANSON
602.622.8584
kent.hanson@kidder.com

KYLE HANSON
480.262.8985
kyle.hanson@kidder.com

KIDDER.COM

This information supplied herein is from sources we deem reliable. It is provided without any representation, warranty, or guarantee, expressed or implied as to its accuracy. Prospective Buyer or Tenant should conduct an independent investigation and verification of all matters deemed to be material, including, but not limited to, statements of income and expenses. Consult your attorney, accountant, or other professional advisor.

