

FOR LEASE

FORMER BANK LOCATION
50 RIO RANCHO RD | POMONA, CA 91766

Unit A: ±1,660 SF | Unit B: ±2,210 SF | Unit C: ±2,130 SF



Encon Commercial, Inc

12145 Mora Dr, Ste 7
Santa Fe Springs, CA 90670

3281 East Guasti Rd, Ste 700
Ontario, California 91761

562.777.2200

enconcommercial.com

John Scatoloni

DRE#01780335

Angela Pan

DRE#02016910

Encon Commercial, Inc or its personnel makes no warranties, representations or guarantees about the information provided herein. These materials are based on information and content provided by others, which we believe are accurate, however, it has not been verified and all interested parties must independently confirm its accuracy. The information contained herein is subject to errors and omissions and is subject to change without notice. Any and all projections, opinions, assumptions, and estimates provided are for purposes of example and may not represent the current or future performance of this property. Your tax, financial, legal and toxic substance advisors should conduct a careful investigation of the property and its suitability for your needs, including land use limitations.

PROPERTY HIGHLIGHTS

Freestanding former Bank of America building situated in a bustling retail shopping center. The City of Pomona has officially sectioned diminishing this pad space into three separate units, ranging from $\pm 1,660$ - $2,210$ SF, ideal for a variety of retail uses. The site boasts high street visibility on a major area thoroughfare, exterior signage facing three directions, and ample parking in a sizable, shared lot. The center's A+ national co-tenants include Starbucks and IHOP, completed by mix of local food and service-oriented providers. Adjacent to Walmart and WinCo, high volume sales retail outlets generating a consistent stream of consumer traffic.

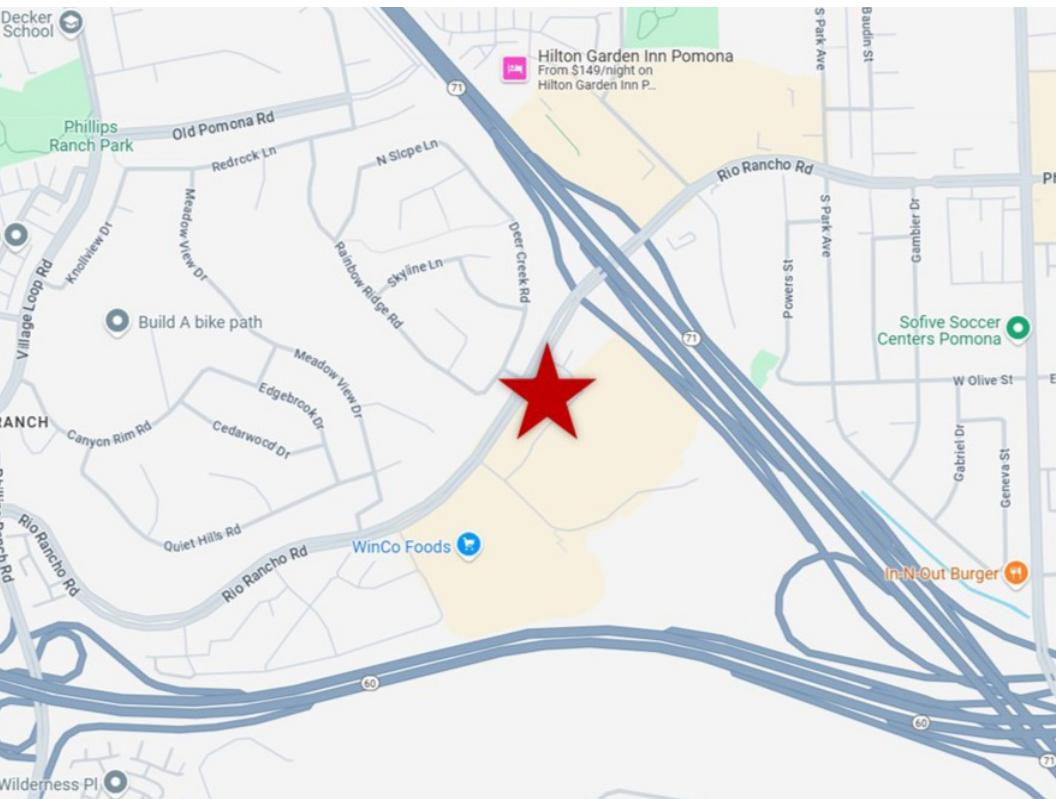

Former Bank of America location divisible into three units, suitable for a variety of retail uses



Well-maintained, newer construction property with excellent curb appeal



Outstanding parking in a sizable onsite shared lot; $\pm 1,279$ parking stalls



Situated in a Walmart + WinCo anchored shopping center, offering ample shared parking and security



Located along a heavily trafficked retail corridor



Three (3) available units ranging from $\pm 1,660$ - $2,210$ SF



Lease rate: \$26/SF yearly + NNN fee



Last Remaining Units!

58 RIO RANCHO RD | POMONA, CA 91766



PROPERTY DETAILS

Total Pad Space Size:	±6,019 SF
Unit Size Range:	±1,660
Total Potential Units:	3
Shopping Center Total GLA:	±149,072 SF
Anchor Tenants:	Walmart + WinCo
Parking (Shared):	±1,279 Stalls in Shared Lot
Total Lot Size:	40.49 Acres
Year Built:	1995

AVAILABLE UNITS

SPACE	SIZE	RENTAL RATE	RENTAL TYPE
Unit A	±1,660 SF	\$26/SF/Yearly	NNN
Unit B	±2,210 SF	\$26/SF/Yearly	NNN
Unit C	±2,130 SF	\$26/SF/Yearly	NNN

58 RIO RANCHO RD | POMONA, CA 91766

SITE PLAN

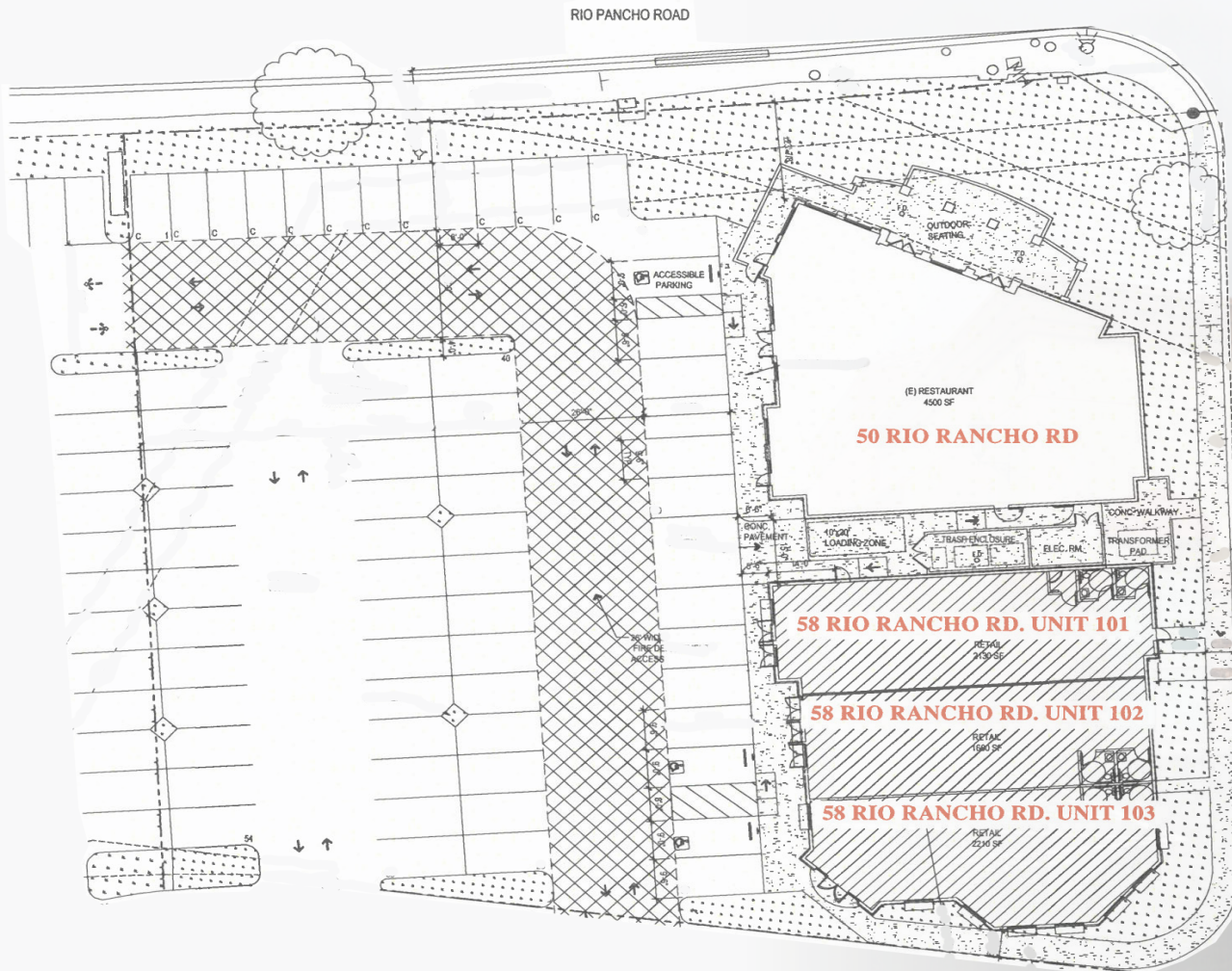

SITE OVERVIEW



DEMOGRAPHICS

	1-Mile	3-Mile	5-Mile
Population:	17,420	136,850	326,792
Households:	4,832	40,157	97,985
Median Age:	40	39	39
Average HH Income:	\$116,208	\$111,390	\$115,377

**Courtesy of 2020 Census Data*

COMMUNITY PROFILE

A flourishing community on the northeastern edge of Los Angeles County, Pomona is positioned at the gateway to SoCal's Inland Empire. With a population of 150,000+ residents, Pomona ranks as LA County's 7th largest city. Boasting a progressive, business-friendly economy, driven by a strong local workforce bolstering the city's productivity. Key industries include retail trade, healthcare, education, and manufacturing. Cal Poly Pomona University has over 25,000 students presently enrolled and employs nearly 5,000 faculty members and support staff.

58 RIO RANCHO RD | POMONA, CA 91766

BROKER TEAM



John Scatoloni

DRE#01780335

Managing Director

562.777.2200 (o)

310.663.6688 (m)

jscatoloni@enconcommercial.com



Angela Pan

DRE#02016910

Associate

562.777.2200

909.662.2552

apan@enconcommercial.com



Encon Commercial, Inc or its personnel makes no warranties, representations or guarantees about the information provided herein. These materials are based on information and content provided by others, which we believe are accurate, however, it has not been verified and all interested parties must independently confirm its accuracy. The information contained herein is subject to errors and omissions and is subject to change without notice. Any and all projections, opinions, assumptions, and estimates provided are for purposes of example and may not represent the current or future performance of this property. Your tax, financial, legal and toxic substance advisors should conduct a careful investigation of the property and its suitability for your needs, including land use limitations.