

FAIRLANE GREEN III - FAIRLANE DRIVE OUTLOTS



MID-AMERICA[®]
Real Estate-Michigan, Inc.

FOR LEASE

3100 Fairlane Drive / Allen Park, MI



RETAIL OPPORTUNITY

FAIRLANE DRIVE OUTLOTS



Address

3100 Fairlane Drive
Allen Park, MI 48101

Availability

Fairlane Drive Outlots:

(7) Retail Buildings

B-A: Fully Leased

B-B: 4,000 SF + Drive-thru

B-C: 2,722 SF

B-D: Fully Leased

B-E: 3,422 SF + Drive-thru

B-F: 1,021 SF + Drive-thru

B-G: 2,360 - 9,440 SF + Drive-thru

Features

- Brand new retail development consisting of seven retail buildings, with 20,605 SF remaining available for lease, including drive-thru opportunities.
- Alrig USA has proposed plans to develop the last 20 acres of land adjacent to Fairlane Green's 1,400,000 square foot power center.
- This shopping arcade is strategically situated between Southfield Freeway (M-39), Outer Drive, I-94, and Oakwood Boulevard in Allen Park, Michigan.
- Co-Tenants include Target, Meijer, Barnes & Noble, Five Below, TJ Maxx, The Home Depot, Best Buy, LA Fitness, and many more.
- The daytime population within a 1-mile radius is over 18,000 people.
- The number of people working at Ford Motor Company is nearly 25,000 employees.
- Pylon signage available.

Area Tenants



Demographics (2025)

	1 MILE	3 MILES	5 MILES
POPULATION	9,469	104,881	351,635
HOUSEHOLDS	3,605	42,071	131,547
AVG HOUSEHOLD INCOME	\$92,438	\$82,903	\$78,099
DAYTIME POPULATION	16,131	121,837	332,028

FAIRLANE DRIVE OUTLOTS

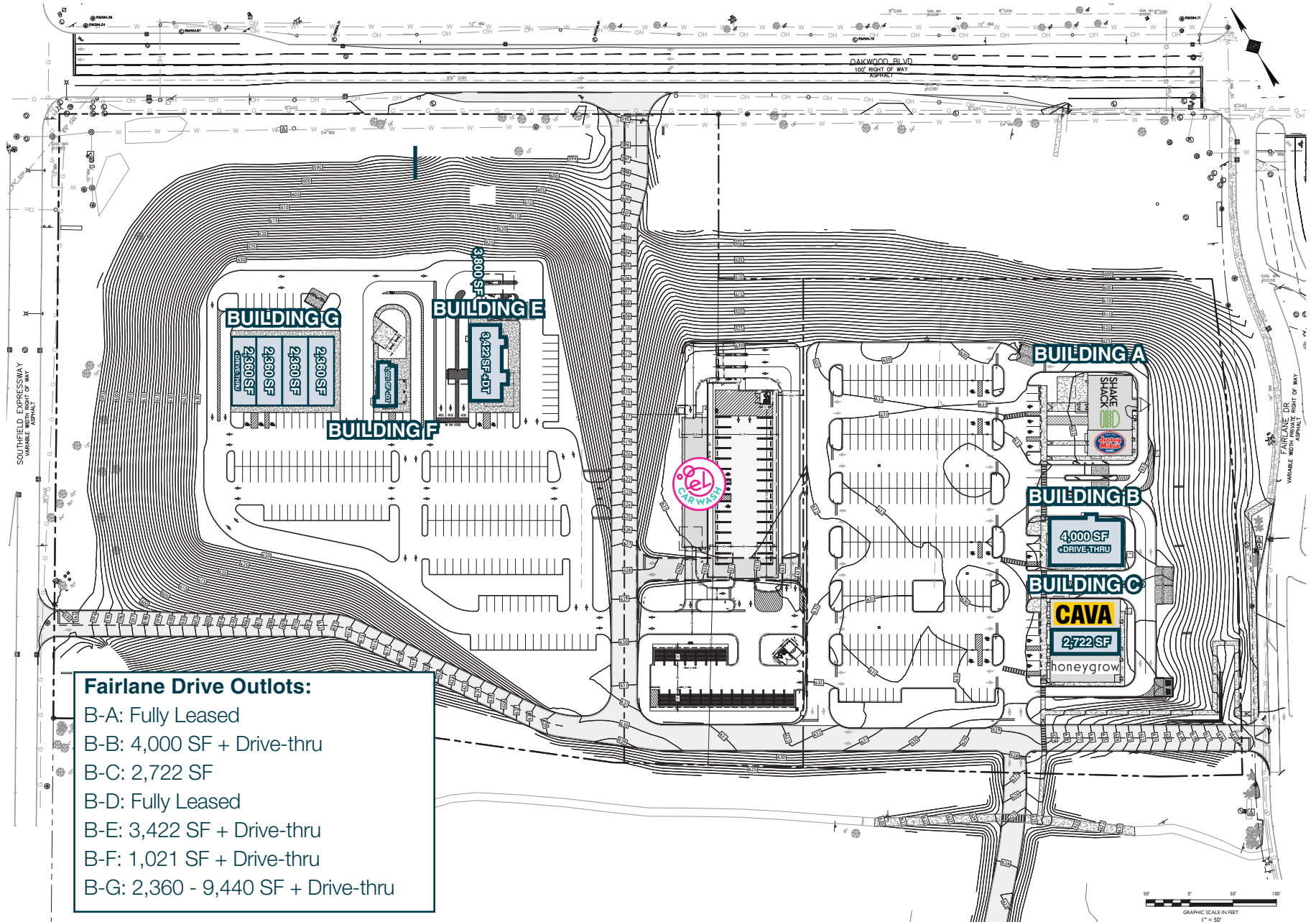

FAIRLANE DRIVE OUTLOTS

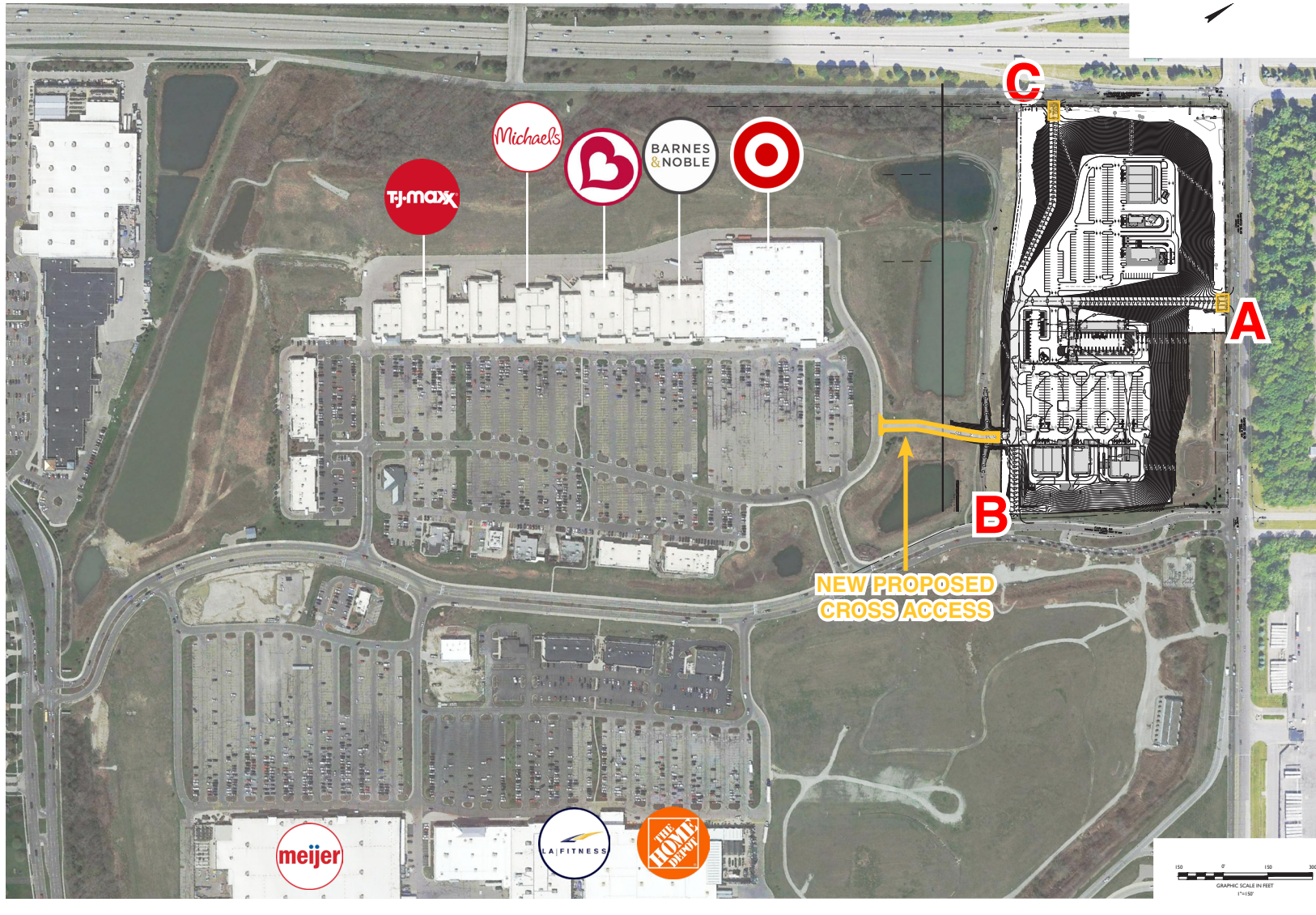

Property Access Description (Preliminary):

- A) Oakwood Boulevard – Right Ingress / Right Egress Full Movement Driveway
- B) Fairlane Drive - Right Ingress / Right Egress Access Drive
- C) Southfield Road - Right Ingress / Right Egress Access Drive

FAIRLANE DRIVE OUTLOTS



FAIRLANE DRIVE OUTLOTS



Gabe
Schuchman

Mid-America Real Estate -
Michigan, Inc.

T: 248.855.6800

GSchuchman@MidAmericaGrp.com



38500 Woodward Ave, Suite 100
Bloomfield Hills, Michigan 48304
248.855.6800

MidAmericaGrp.com

Developed By:
 **ALRIG USA**
DEVELOPMENT