



FOR LEASE



NORTHPOINTE
PORTLAND



NORTHPOINTE OVERLOOK RETAIL

1st-Gen Retail Storefront / Restaurant / Service Space

± 3,399 SF (Divisible) | \$24-\$26 psf + NNN

1332 N Skidmore St, Portland, OR 97217

- Ground-Floor Retail of a 6-Story Mixed-Use Building in North Portland
- Steps to N Mississippi Avenue
- Retail Space Features Corner Exposure, Large Windows and Potential Sidewalk Seating
- Available Immediately-T1 Dollars Available for Qualified Tenants
- On-Street Parking Available

IAN M. BIGGI

Senior Associate Broker | Licensed in OR
503-222-1683 | ianbiggi@capacitycommercial.com

MICHELLE D. ROZAKIS

Principal Broker | Licensed in OR
503-222-1195 | mrozakis@capacitycommercial.com



PROPERTY SUMMARY



FOR LEASE



PROPERTY DETAILS

Address	1332 N Skidmore St, Portland, OR 97217
Available Space	± 3,399 SF (Divisible)
Lease Rate	\$24-\$26 psf + NNN
Use Type	Retail, Service, Restaurant
Availability	Now
Space Condition	Vanilla Shell

Location Features

- North Portland Location Just off I-5 and Walking Distance to N Mississippi and Williams Ave
- Close Proximity to Restaurants, Cafes, Bars and Boutiques
- Walkable, Bike Friendly Neighborhood with Easy Access to Public Transit
- Two Blocks to N Prescott St MAX Light Rail Station and Nike BIKETOWN Bicycle-Sharing Station
- Next to The Prescott Apartments at N Interstate & N Skidmore

Nearby Highlights

- Laughing Planet
- Little Big Burger
- The Alibi Tiki Lounge
- Fire on the Mountain
- Pinky's Pizza
- Prost!
- The Rambler
- Paxton Gate
- Mississippi
- Lovely's Fifty Fifty
- The Fresh Pot
- Gravy
- Miss Delta
- The 1905
- Pistils Nursery
- Blue Star Donuts
- StormBreaker Brewing
- Harbor Freight Tools
- US Bank
- Kaiser Permanente Interstate Medical Center



FLOOR PLAN

FLOOR PLAN

N SKIDMORE ST

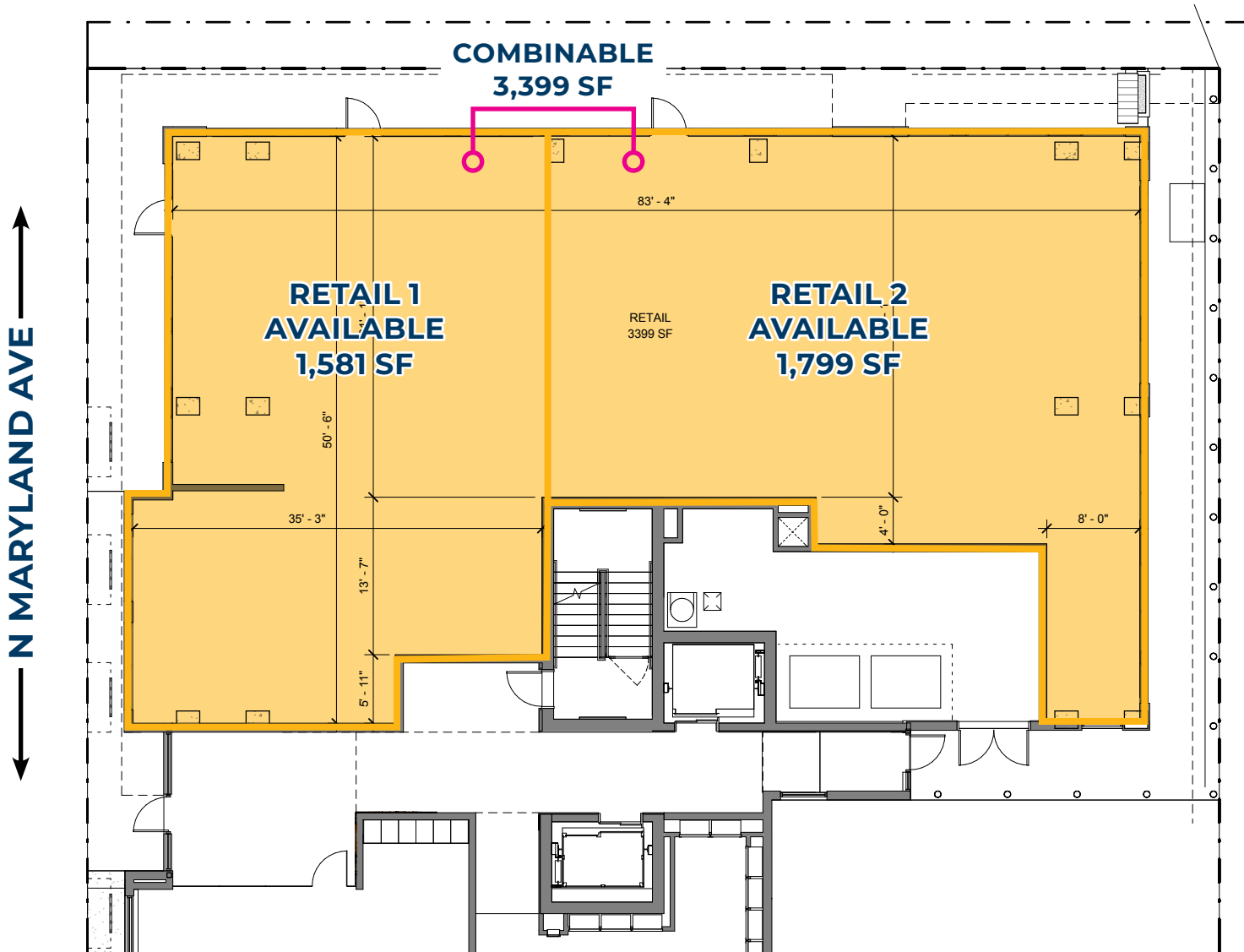



DRIVE TIMES & DEMOGRAPHICS

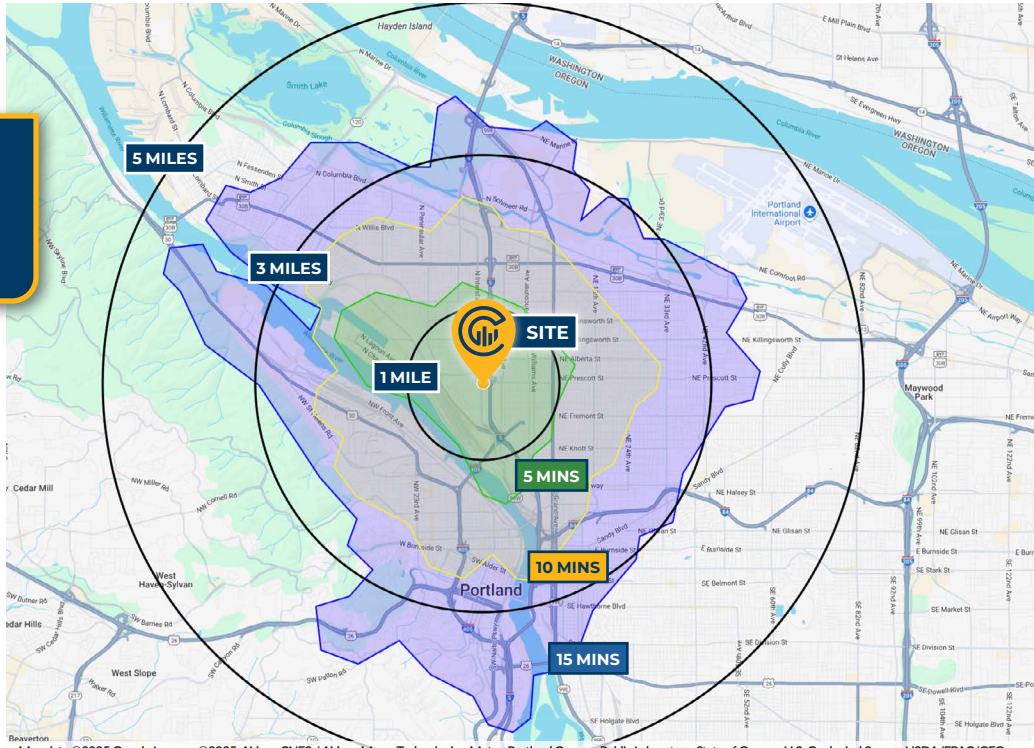

Map data ©2025 Google Imagery ©2025, Airbus, CNES / Airbus, Maxar Technologies, Metro, Portland Oregon, Public Laboratory, State of Oregon, U.S. Geological Survey, USDA/FPAC/GEO



AREA DEMOGRAPHICS			
Population	1 Mile	3 Mile	5 Mile
2025 Estimated Population	23,518	193,276	365,427
2030 Projected Population	24,216	193,728	364,700
2020 Census Population	24,091	180,791	356,914
2010 Census Population	17,383	147,969	305,344
Projected Annual Growth 2025 to 2030	0.6%	-	-
Historical Annual Growth 2010 to 2025	2.4%	2.0%	1.3%
Households & Income			
2025 Estimated Households	11,137	94,150	175,887
2025 Est. Average HH Income	\$138,219	\$133,259	\$142,038
2025 Est. Median HH Income	\$104,743	\$98,703	\$105,747
2025 Est. Per Capita Income	\$65,721	\$65,345	\$68,691
Businesses			
2025 Est. Total Businesses	1,562	20,310	32,967
2025 Est. Total Employees	14,086	202,553	292,386

Demographic Information, Traffic Counts, and Merchant Locations are Provided by REGIS Online at SitesUSA.com ©2025, Sites USA, Chandler, Arizona, 480-491-1112 Demographic Source: Applied Geographic Solutions 05/2025, TIGER Geography-RS1

Neighborhood Scores

82

Walk Score®
"Very Walkable"

93

Bike Score®
"Biker's Paradise"

55

Transit Score®
"Good Transit"

Ratings provided by <https://www.walkscore.com>

IAN M. BIGGI

Senior Associate Broker | Licensed in OR
503-222-1683 | ianbiggi@capacitycommercial.com

MICHELLE D. ROZAKIS

Principal Broker | Licensed in OR
503-222-1195 | mrozakis@capacitycommercial.com

NORTHPOINTE OVERLOOK RETAIL