

3517-3529

W COMMONWEALTH AVE
FULLERTON | CALIFORNIA

Voit
REAL ESTATE SERVICES

ZEHNER HILL
INDUSTRIAL GROUP



COMMONWEALTH BUSINESS CENTER

PROPERTY DETAILS

COMMONWEALTH BUSINESS CENTER

Address:	3517-3529 W Commonwealth Ave. Fullerton, CA
Business Park Size:	±47,035 Square Feet
# of Buildings:	4
Typical Unit Size:	1,200 - 5,400 SF
Loading Doors:	Grade Level Loading Doors (oversized)
Clear Height:	14'
Parking Ratio:	±1.66:1000
Total Parking Spaces:	78 Parking Spaces
Fire System:	Fire Sprinkler System
Power:	125 Amps 120/208 Volt, 3-Phase 4 Wire (verify)
CAM:	Includes Trash & Water



MASTER AVAILABILITY LIST - MARCH 2026

ADDRESS	TOTAL SF	RATE PSF	CAM PSF	AVAILABLE	FEATURES
3517 W. Commonwealth Ave. Unit E	±1,485 SF	\$1.50 Gross	\$0.12 CAM	Now	
3529 W. Commonwealth Ave. Unit X	±1,800 SF	\$1.50 Gross	\$0.12 CAM	Now	
3529 W. Commonwealth Ave. Unit Z	±5,400 SF	\$1.50 Gross	\$0.12 CAM	Now	1,440 SF Office Electric GL Door Fenced Yard

SITE PLAN

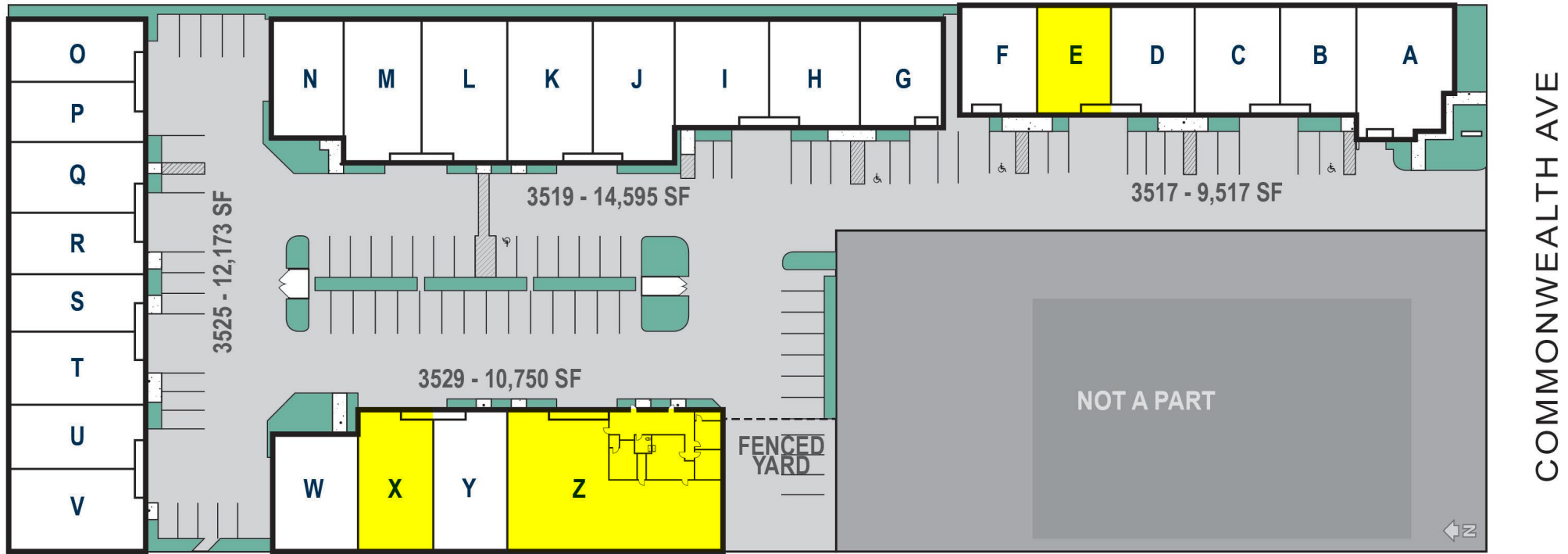

MASTER AVAILABILITY LIST - MARCH 2026

ADDRESS	TOTAL SF	RATE PSF	CAM PSF	AVAILABLE	FEATURES
3517 W. Commonwealth Ave. Unit E	±1,485 SF	\$1.50 Gross	\$0.12 CAM	Now	
3529 W. Commonwealth Ave. Unit X	±1,800 SF	\$1.50 Gross	\$0.12 CAM	Now	
3529 W. Commonwealth Ave. Unit Z	±5,400 SF	\$1.50 Gross	\$0.12 CAM	Now	1,440 SF Office Fenced Yard

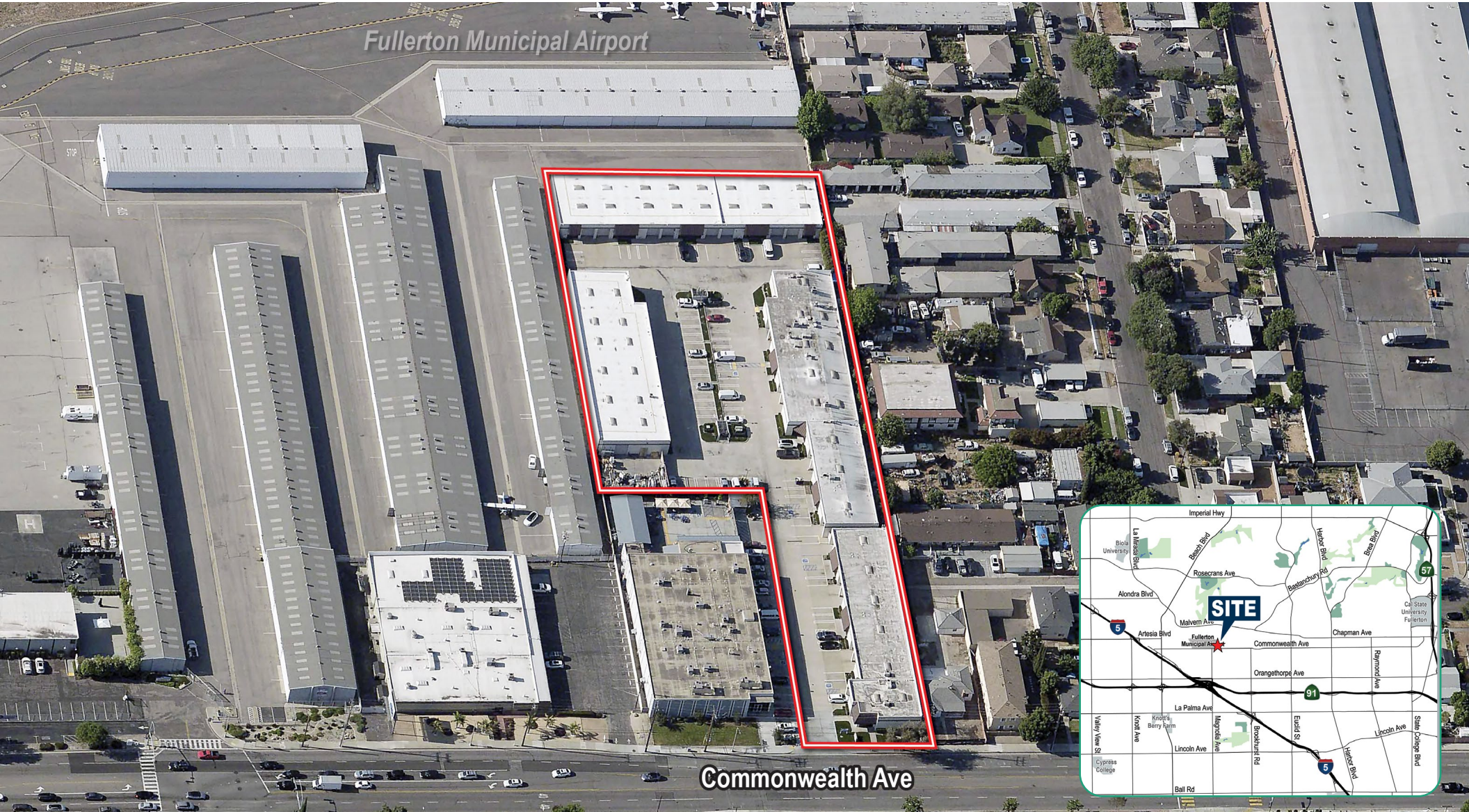

REED RUTTER
SENIOR ASSOCIATE

949.933.5744
RRutter@voitco.com
Lic. #02153762

The information contained herein has been obtained from sources we deem reliable. While we have no reason to doubt its accuracy, we do not guarantee it. Licensed as Real Estate Salespersons by the DRE.
©2026 Voit Real Estate Services, Inc. All Rights Reserved. License #01991785.

Voit
REAL ESTATE SERVICES

ZEHNER HILL
INDUSTRIAL GROUP

2020 Main Street | Suite 100
Irvine, California 92614
949.851.5100 | www.VoitCo.com