

# FREE STANDING FORMER IHOP

920 SOUTH GILBERT ROAD, GILBERT, ARIZONA, 85296

# FOR SALE / LEASE



**BETH JO ZEITZER** | 602.319.1326 | [bjz@roiproperties.com](mailto:bjz@roiproperties.com)

**REUBEN NACH** | 602.881.4724 | [rnach@roiproperties.com](mailto:rnach@roiproperties.com)

R.O.I. Properties  
3333 E Camelback Rd., Ste 252  
Phoenix, AZ 85018  
[www.roiproperties.com](http://www.roiproperties.com)



# EXECUTIVE SUMMARY

ADDRESS:	920 S Gilbert Rd
SALE/LEASE PRICE:	Inquire with Broker
BUILDING SIZE (SF):	4,022 SF
OCCUPANCY:	Vacant
BUILDOUT:	Second Generation Restaurant
APN:	302-82-970
LOT SIZE (AC):	0.896 AC
ZONING:	C-2
CROSS STREETS:	Gilbert Road & American Heroes Way
PARKING RATIO:	10.00/1,000 SF
FRONTAGE:	Gilbert Road (Premium Frontage)

Located in the heart of Gilbert, 920 S Gilbert Road — a former IHOP and second-generation restaurant building constructed in 2002 — offers an exceptional opportunity for restaurant operators seeking a premier location in one of the Valley's most desirable trade areas. Surrounded by strong demographics and a vibrant mix of retail, office, residential, and civic uses, the property benefits from its proximity to Gilbert Town Square, the Gilbert Civic Center, local schools, and numerous Class A multifamily communities. Situated on a signalized hard corner with outstanding frontage and visibility along Gilbert Road, the site enjoys excellent exposure and accessibility. The property is positioned on a large ±39,043-square-foot parcel and features ample on-site parking, making it well-suited for a variety of restaurant concepts.

- Free Standing, Second Gen Restaurant, Former IHOP
- Close Proximity to Gilbert Town Square and Gilbert Civic Center
- Surrounded by high performing national tenants
- Hard Corner Location - Premium frontage along Gilbert Rd.



# NORTH FACING OBLIQUE - DENSE INFILL GILBERT LOCATION

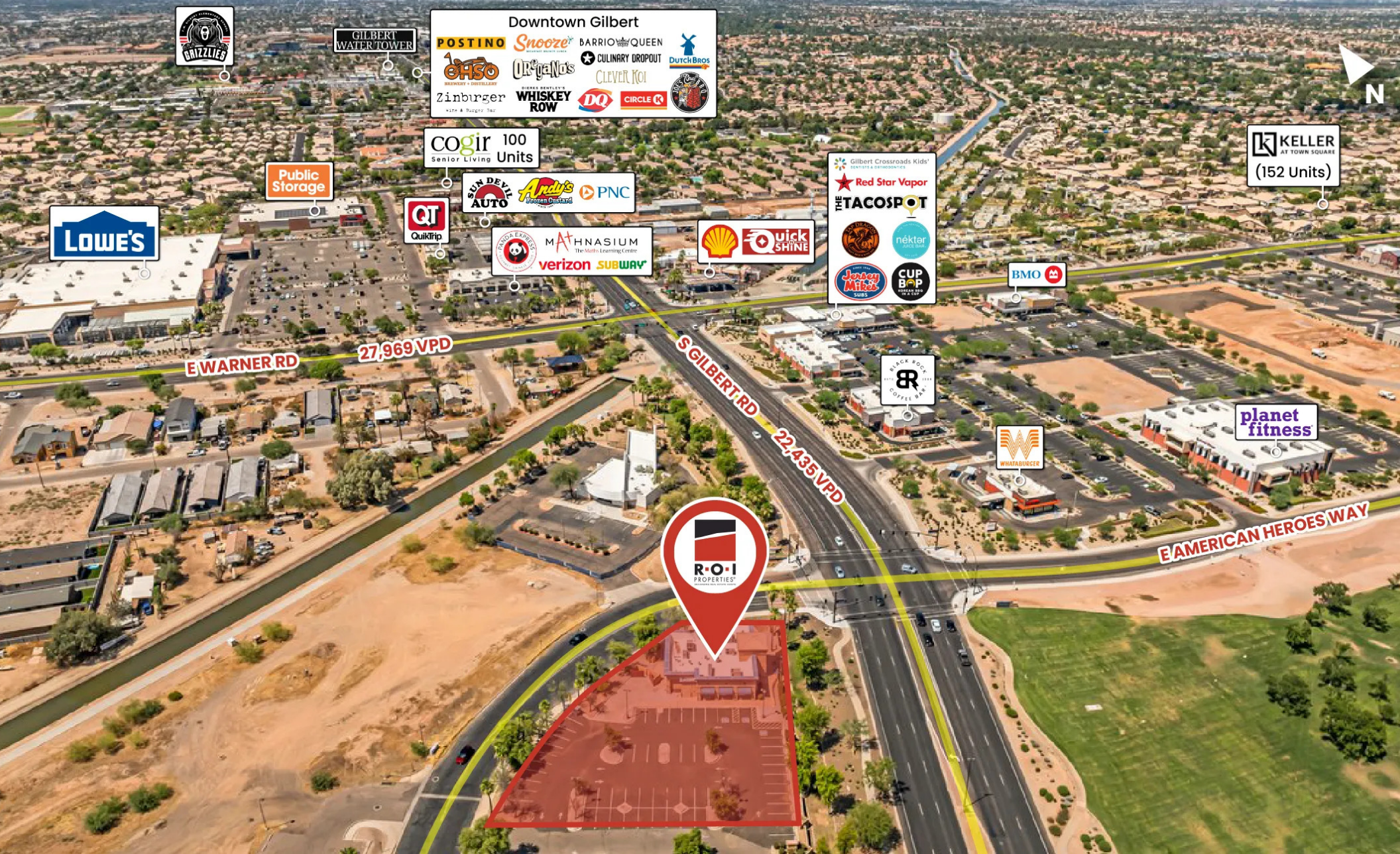

# SOUTH FACING OBLIQUE - SURROUNDED BY MAJOR EMPLOYERS, MULTIFAMILY, AND OTHER RETAILERS



# PREMIUM FRONTAGE ALONG SOUTH GILBERT RD



**S Gilbert Rd - 20,603 VPD**

**E American Heroes Way**

# DEMOGRAPHIC REPORT

POPULATION	1 MILE	3 MILES	5 MILES
Total Population	14,943	127,410	341,731
Average Age	39.1	37.7	36.1
Average Age (Male)	40.5	36.5	35.0
Average Age (Female)	39.1	38.9	36.9

HOUSEHOLDS & INCOME	1 MILE	3 MILES	5 MILES
Total Households	5,417	46,011	124,399
# of Persons per HH	2.8	2.8	2.7
Average HH Income	\$133,519	\$129,512	\$122,003
Average House Value	\$484,230	\$485,042	\$467,633

2023 American Community Survey (ACS)

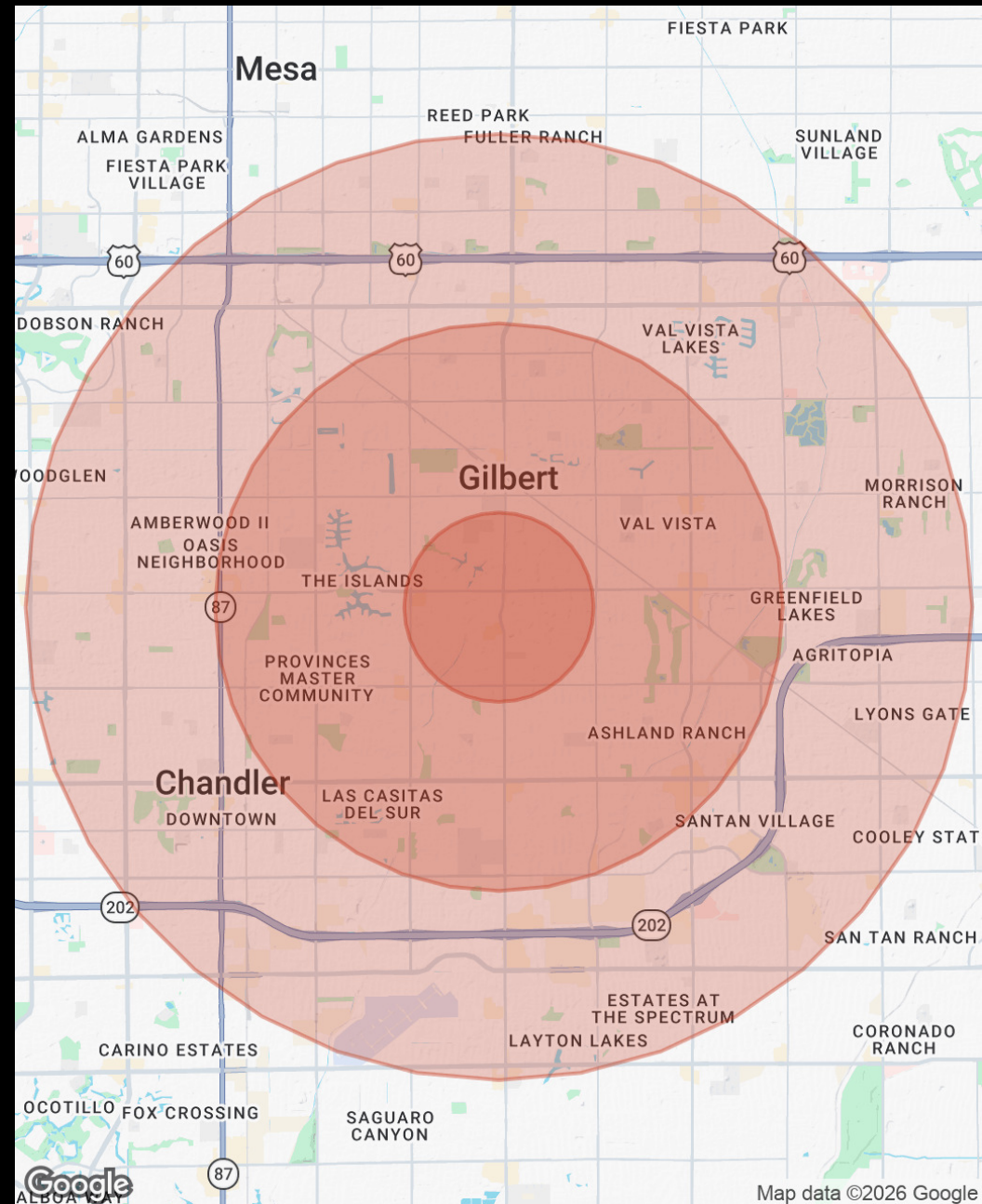

Map data ©2026 Google



3333 E. CAMELBACK RD, SUITE 252  
PHOENIX, AZ 85018

FOR MORE INFORMATION VISIT  
[WWW.ROIPROPERTIES.COM](http://WWW.ROIPROPERTIES.COM)



Beth Jo Zeitzer  
CEO - Designated Broker  
602.319.1326  
[bjz@roiproperties.com](mailto:bjz@roiproperties.com)



Reuben Nach  
Vice President, Commercial Division  
602.881.4724  
[rnach@roiproperties.com](mailto:rnach@roiproperties.com)  
  
AZ #SA687040000