

COMMERCIAL BUILDING FOR SALE

337 Burney Street, Modesto, California

EXCEPTIONAL VALUE!



BURNEY STREET

RANDY BREKKE DRE# 00856863

Office 209.571.7230 | Cell 209.606.0044 | randy@brekkere.com

BREKKE REAL ESTATE DRE# 01208688

1500 Standiford Ave., Bldg. D | Modesto, CA 95350 | www.brekkere.com

The information above has been obtained from sources believed reliable. While we do not doubt its accuracy, we have not verified it and make no guaranty, representation or warranty about it. It is your responsibility to independently confirm its accuracy and completeness. Any assumptions, estimates or projections used are for example only and do not represent the current or future performance of the property. You are advised to consult independent advisors as to value, tax factors, financial and legal matters in determining the suitability of the property for your needs.





PROPERTY DETAILS

- Price: \$315,000 (\$248[±] per sf)
- Total Size: 1,270[±] sf (990[±] sf Main Bldg. + 280[±] Rear Bldg.)
- Parcel Size: 5,662[±] sf
- A. P. N.: 106-003-004 - Stanislaus County
- Zoned: END (East Neighborhood Downtown Zone)
- Year Built: 1920, Remodeled

PROPERTY HIGHLIGHTS

- 3 private rooms/offices; reception/open work area
- Single restroom, kitchen and break room
- Hardwood flooring throughout
- Small building in rear of property with restroom
- New 100 amp electrical service
- New A/C unit (3-ton) installed in 2022
- Good lighting and utilization of windows and interior glass
- Gated, concrete parking area w/ 6 parking stalls
- Street signage opportunity



Back Building

RANDY BREKKE DRE# 00856863

Office 209.571.7230 | Cell 209.606.0044 | randy@brekkere.com

BREKKE REAL ESTATE DRE# 01208688

1500 Standiford Ave., Bldg. D | Modesto, CA 95350 | www.brekkere.com



FLOOR PLAN

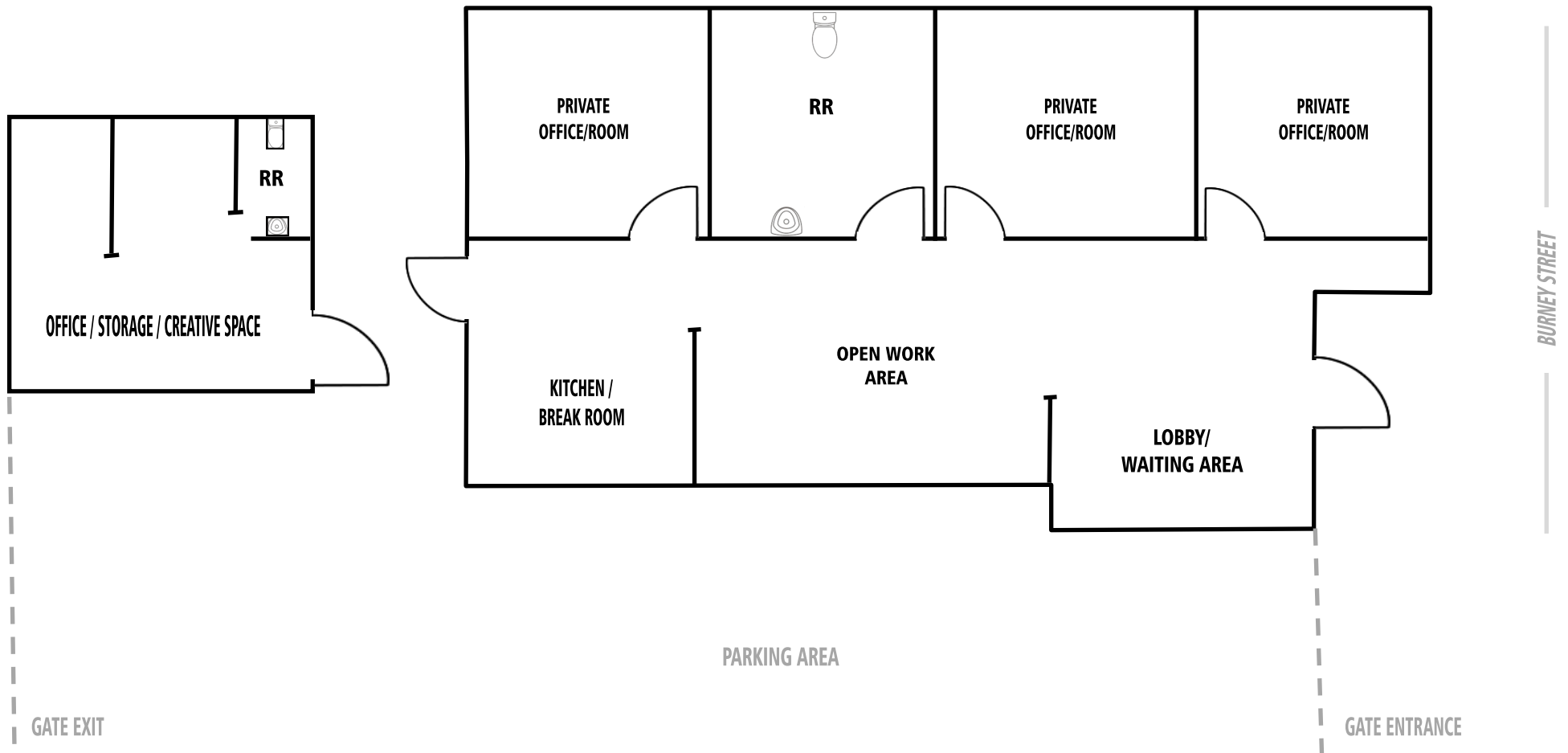

RANDY BREKKE DRE# 00856863

Office 209.571.7230 | Cell 209.606.0044 | randy@brekkere.com

BREKKE REAL ESTATE DRE# 01208688

1500 Standiford Ave., Bldg. D | Modesto, CA 95350 | www.brekkere.com

The information above has been obtained from sources believed reliable. While we do not doubt its accuracy, we have not verified it and make no guaranty, representation or warranty about it. It is your responsibility to independently confirm its accuracy and completeness. Any assumptions, estimates or projections used are for example only and do not represent the current or future performance of the property. You are advised to consult independent advisors as to value, tax factors, financial and legal matters in determining the suitability of the property for your needs.



COMMERCIAL BUILDING FOR SALE

337 Burney St., Modesto, CA



RANDY BREKKE DRE# 00856863

Office 209.571.7230 | Cell 209.606.0044 | randy@brekkere.com

BREKKE REAL ESTATE DRE# 01208688

1500 Standiford Ave., Bldg. D | Modesto, CA 95350 | www.brekkere.com

The information above has been obtained from sources believed reliable. While we do not doubt its accuracy, we have not verified it and make no guaranty, representation or warranty about it. It is your responsibility to independently confirm its accuracy and completeness. Any assumptions, estimates or projections used are for example only and do not represent the current or future performance of the property. You are advised to consult independent advisors as to value, tax factors, financial and legal matters in determining the suitability of the property for your needs.



COMMERCIAL BUILDING FOR SALE

337 Burney St., Modesto, CA



RANDY BREKKE DRE# 00856863
Office 209.571.7230 | Cell 209.606.0044 | randy@brekkere.com

BREKKE REAL ESTATE DRE# 01208688
1500 Standiford Ave., Bldg. D | Modesto, CA 95350 | www.brekkere.com



The information above has been obtained from sources believed reliable. While we do not doubt its accuracy, we have not verified it and make no guaranty, representation or warranty about it. It is your responsibility to independently confirm its accuracy and completeness. Any assumptions, estimates or projections used are for example only and do not represent the current or future performance of the property. You are advised to consult independent advisors as to value, tax factors, financial and legal matters in determining the suitability of the property for your needs.

COMMERCIAL BUILDING FOR SALE

337 Burney St., Modesto, CA



Approx. 280 sf rear building with wood flooring and neutral finishes. Includes a built-in wet bar with sink & cabinetry, plus a private office or meeting room with glass French doors. Clean, functional layout ideal for professional or creative workspace.



Back Building

RANDY BREKKE DRE# 00856863

Office 209.571.7230 | Cell 209.606.0044 | randy@brekkere.com

BREKKE REAL ESTATE DRE# 01208688

1500 Standiford Ave., Bldg. D | Modesto, CA 95350 | www.brekkere.com

The information above has been obtained from sources believed reliable. While we do not doubt its accuracy, we have not verified it and make no guaranty, representation or warranty about it. It is your responsibility to independently confirm its accuracy and completeness. Any assumptions, estimates or projections used are for example only and do not represent the current or future performance of the property. You are advised to consult independent advisors as to value, tax factors, financial and legal matters in determining the suitability of the property for your needs.



COMMERCIAL BUILDING FOR SALE

337 Burney St., Modesto, CA



RANDY BREKKE DRE# 00856863

Office 209.571.7230 | Cell 209.606.0044 | randy@brekkere.com

BREKKE REAL ESTATE DRE# 01208688

1500 Standiford Ave., Bldg. D | Modesto, CA 95350 | www.brekkere.com

The information above has been obtained from sources believed reliable. While we do not doubt its accuracy, we have not verified it and make no guaranty, representation or warranty about it. It is your responsibility to independently confirm its accuracy and completeness. Any assumptions, estimates or projections used are for example only and do not represent the current or future performance of the property. You are advised to consult independent advisors as to value, tax factors, financial and legal matters in determining the suitability of the property for your needs.



COMMERCIAL BUILDING FOR SALE

337 Burney St., Modesto, CA



RANDY BREKKE DRE# 00856863

Office 209.571.7230 | Cell 209.606.0044 | randy@brekkere.com

BREKKE REAL ESTATE DRE# 01208688

1500 Standiford Ave., Bldg. D | Modesto, CA 95350 | www.brekkere.com

The information above has been obtained from sources believed reliable. While we do not doubt its accuracy, we have not verified it and make no guaranty, representation or warranty about it. It is your responsibility to independently confirm its accuracy and completeness. Any assumptions, estimates or projections used are for example only and do not represent the current or future performance of the property. You are advised to consult independent advisors as to value, tax factors, financial and legal matters in determining the suitability of the property for your needs.



COMMERCIAL BUILDING FOR SALE

337 Burney St., Modesto, CA

LOCATION MAP

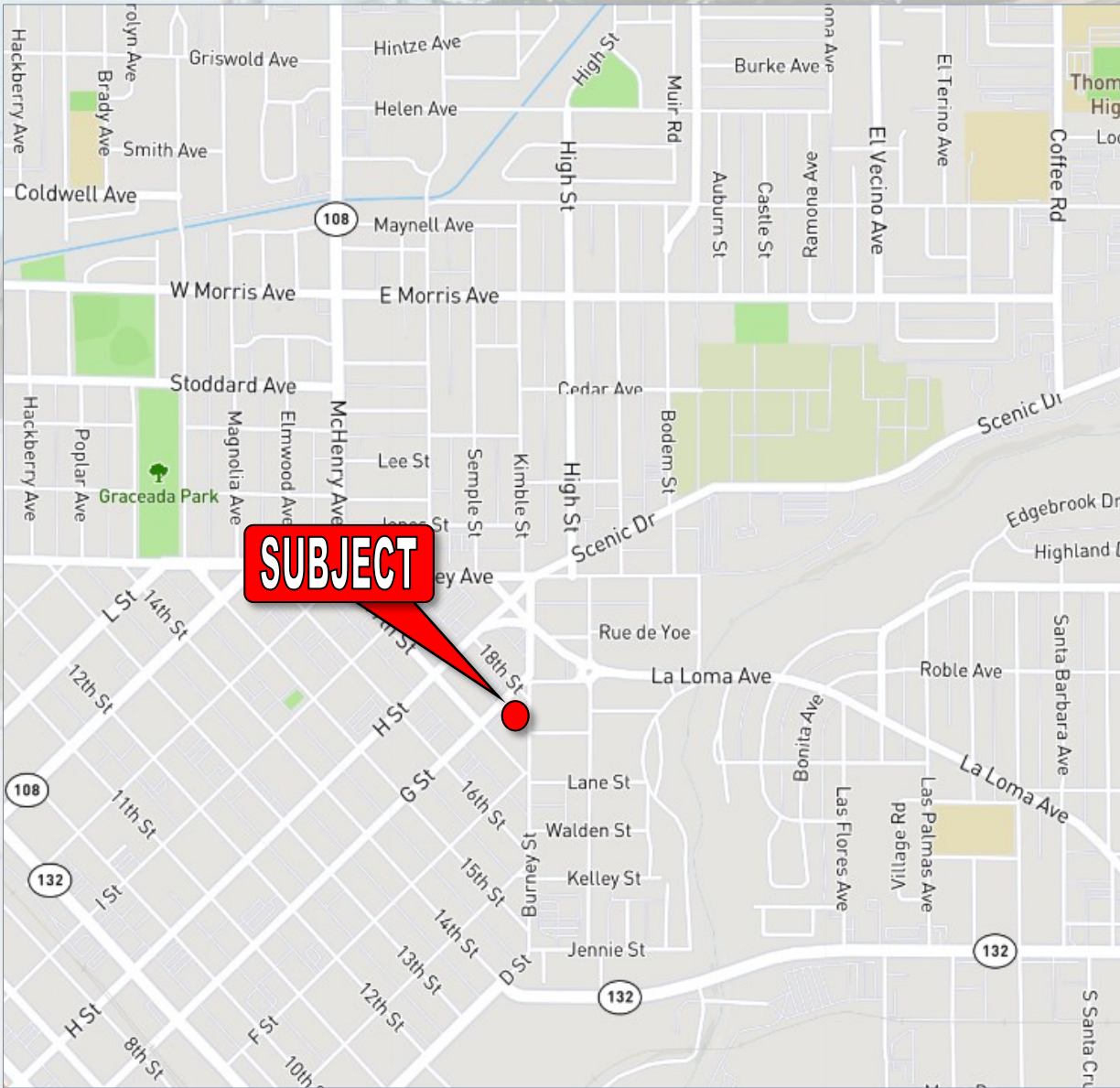

MAP OF CENTRAL VALLEY



POPULATION

City of Modesto - 212,175
Stanislaus County - 538,388

DISTANCES

To Stockton.....37 Miles
To Manteca.....33 Miles
To Turlock.....15 Miles
To Sacramento.....79 Miles
To San Francisco.....91 Miles

RANDY BREKKE DRE# 00856863
Office 209.571.7230 | Cell 209.606.0044 | randy@brekkere.com

BREKKE REAL ESTATE DRE# 01208688
1500 Standiford Ave., Bldg. D | Modesto, CA 95350 | www.brekkere.com



The information above has been obtained from sources believed reliable. While we do not doubt its accuracy, we have not verified it and make no guaranty, representation or warranty about it. It is your responsibility to independently confirm its accuracy and completeness. Any assumptions, estimates or projections used are for example only and do not represent the current or future performance of the property. You are advised to consult independent advisors as to value, tax factors, financial and legal matters in determining the suitability of the property for your needs.