

# 10

SOUTH  
STATE  
STREET

CHICAGO, ILLINOIS

## The Premier State Street Flagship Opportunity



**STEPHEN ANSANI**

+1 312 935 1907

[STEPHEN.ANSANI@CBRE.COM](mailto:STEPHEN.ANSANI@CBRE.COM)

**DANNY JACOBSON**

+1 312 935 1901

[DANNY.JACOBSON@CBRE.COM](mailto:DANNY.JACOBSON@CBRE.COM)

**LUKE MOLLOY**

+1 312 935 1905

[LUKE.MOLLOY@CBRE.COM](mailto:LUKE.MOLLOY@CBRE.COM)

**CONTACT**

**CBRE**

# 10 SOUTH STATE STREET

## HIGHLIGHTS:

- **Flagship opportunity in the heart of the State Street retail district**
- **Two level branding opportunity surrounded by premier retail co-tenancy**
- **Over 60 Feet of State Street Frontage**
- **10 South State Street is the center of Chicago's central business district and two blocks from Millennium Park, Illinois' #1 tourist destination**
- **Located adjacent to CTA Red Line Station, which averages over 3.3 million riders per year**

## 10 SOUTH STATE STREET | GROUND FLOOR PLAN

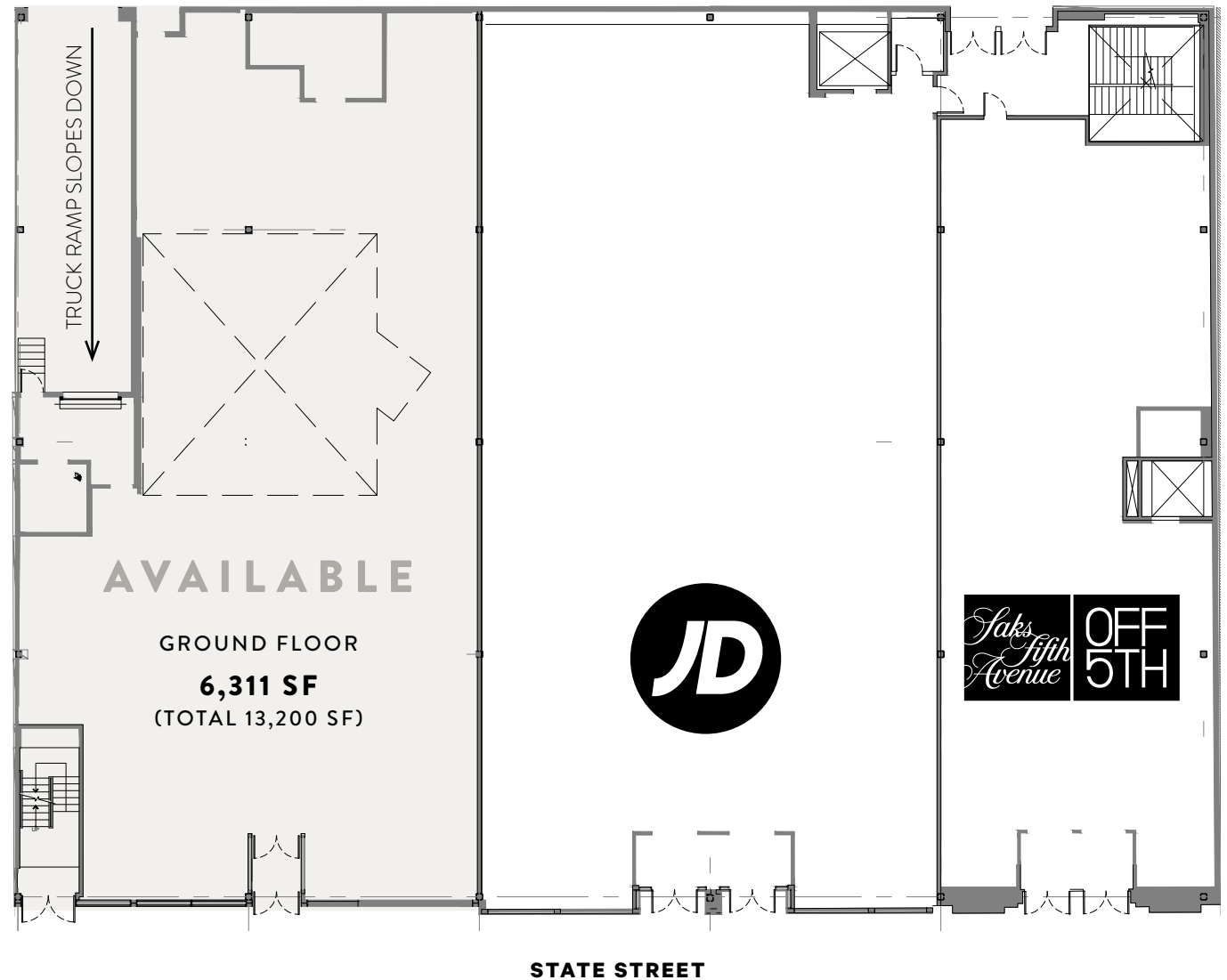

TOTAL SF INCLUDES 303 SF IN THE LOWER LEVEL



122'-4"

**STATE STREET**

TOTAL SF INCLUDES 303 SF IN THE LOWER LEVEL

# 10 SOUTH STATE STREET



## AREA HIGHLIGHTS:



\$184,777  
AVG HH INCOME



543,236  
DAYTIME POPULATION



515,688  
EMPLOYEES



\$424.9 M  
CONSUMER EXPENDITURE  
ON DINING



\$270.2 M  
CONSUMER EXPENDITURE  
ON APPAREL



+25.0 M  
VISITORS TO  
MILLENNIUM PARK



\*2025 | 0.5 MILE RADIUS

# 10 SOUTH STATE STREET

## **STEPHEN ANSANI**

+1 312 935 1907

[STEPHEN.ANSANI@CBRE.COM](mailto:STEPHEN.ANSANI@CBRE.COM)

## **DANNY JACOBSON**

+1 312 935 1901

[DANNY.JACOBSON@CBRE.COM](mailto:DANNY.JACOBSON@CBRE.COM)

## **LUKE MOLLOY**

+1 312 935 1905

[LUKE.MOLLOY@CBRE.COM](mailto:LUKE.MOLLOY@CBRE.COM)

**CBRE** © 2025 CBRE, Inc. All rights reserved. This information has been obtained from sources believed reliable, but has not been verified for accuracy or completeness. You should conduct a careful, independent investigation of the property and verify all information. Any reliance on this information is solely at your own risk. CBRE and the CBRE logo are service marks of CBRE, Inc. All other marks displayed on this document are the property of their respective owners, and the use of such logos does not imply any affiliation with or endorsement of CBRE. Photos herein are the property of their respective owners. Use of these images without the express written consent of the owner is prohibited.