

NEC Redlands Avenue

Placentia Avenue

4862 Placentia Ave | Perris, CA

FOR LEASE
121,000 SF



Scott Sanders, SIOR
Executive Vice President
CA Lic. 01481466
+1 909 937 6322
scott.sanders@colliers.com

Thomas Taylor
Vice Chair
CA Lic. 00598896
+1 909 612 2614
Thomas.Taylor@colliers.com



DEDEAUX
PROPERTIES

NEC Redlands Avenue & Placentia Avenue

Building Features



Building Size
121,000 SF

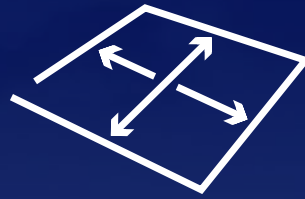

Site Area
5.74 Acres

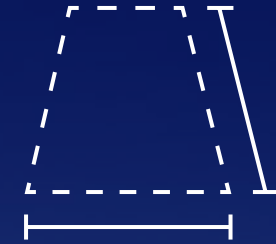

Office Area
BTS



Clear Height
32' Minimum



Loading
16 Dock High Doors
1 Grade Level Door



Sprinkler System
ESFR



Trailer Parking
27 Trailer Stalls



Car Parking
75 Auto Stalls



Truck Court
185'

Site Plan

NEC Redlands Avenue Placentia Avenue

4862 Placentia Ave | Perris, CA

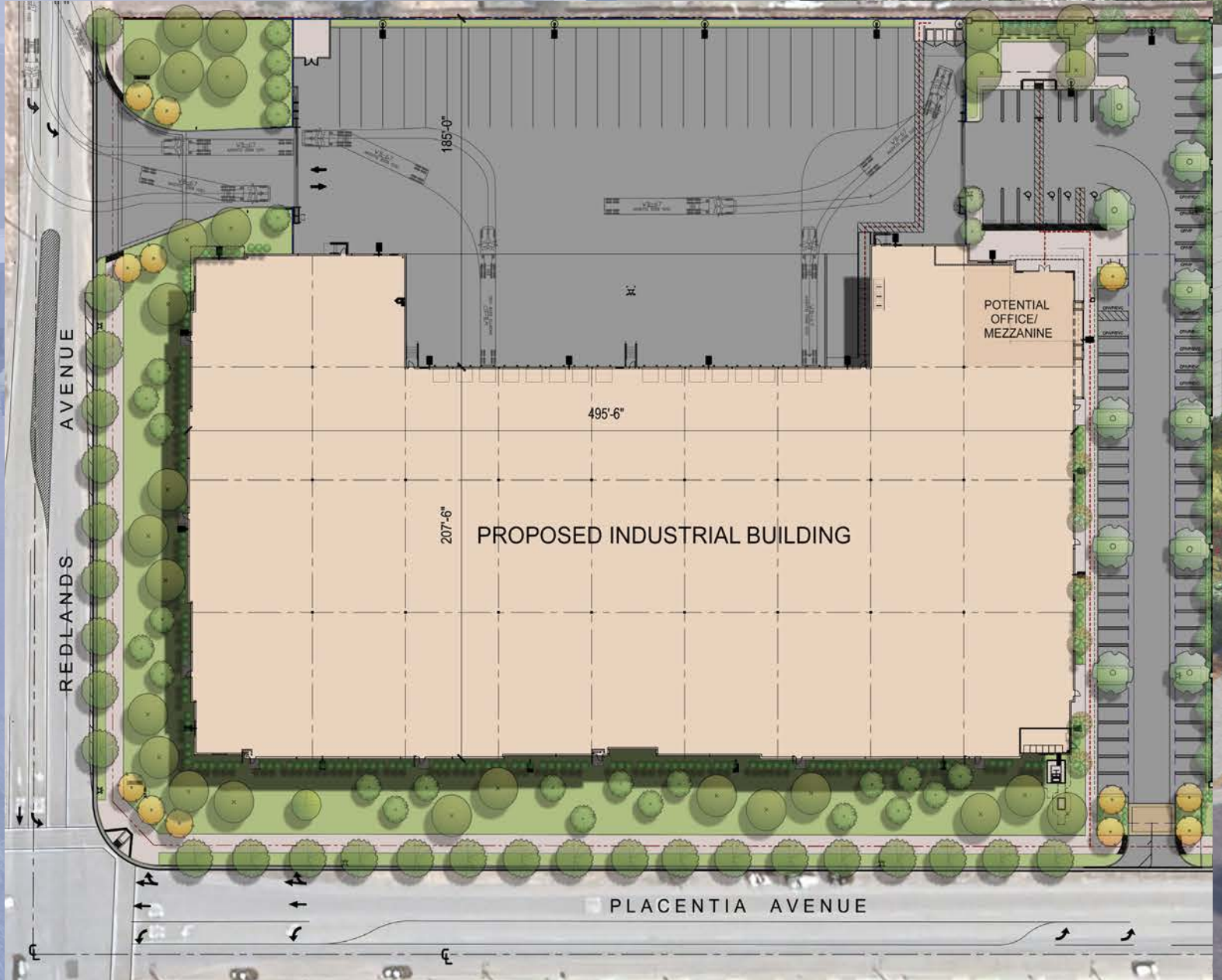

NEC Redlands Avenue Placentia Avenue

4862 Placentia Ave
Perris, CA

Scott Sanders, SIOR
Executive Vice President
CA Lic. 01481466
+1 909 937 6322
scott.sanders@colliers.com

Thomas Taylor
Vice Chair
CA Lic. 00598896
+1 909 612 2614
Thomas.Taylor@colliers.com

Colliers
2855 E Guasti Rd, Suite 401
Ontario, CA 91761
+1 909 605 9400
www.colliers.com

A Quality Project By:



Colliers International makes no guarantees, representations or warranties of any kind, expressed or implied, regarding the information including, but not limited to, warranties of content, accuracy and reliability. This publication is the copyrighted property of Colliers International and/or its licensor(s). 2024. All rights reserved



Corporate Occupiers
Oleander Av

NEC Redlands Avenue
Placentia Avenue