

# Avidex Building

13555 NE Bel-Red Rd Bellevue, WA 98005



**FOR LEASE**

Service Retail Space for Lease

**Josh Heyum**

Principal

425.445.5799

josh@vistapacificgroupinc.com

**Jake Staniszewski**

Broker

425.284.4270 ext. 1009

jake@vistapacificgroupinc.com



# Avidex Building

13555 NE Bel-Red Rd Bellevue, WA 98005

Suites	SF	Rate	Availability
202	865 SF	\$32.00/SF ~ MG	Now
204	707 SF	\$32.00/SF ~ MG	Now

## Features

- Bellevue Spring District
- Private Entries
- Ample Parking
- Efficient Build-Out
- Private Restrooms



**Josh Heyum**  
Principal  
425.445.5799

**Jake Staniszewski**  
Broker  
425.284.4270 ext. 1009  
jake@vistapacificgroupinc.com



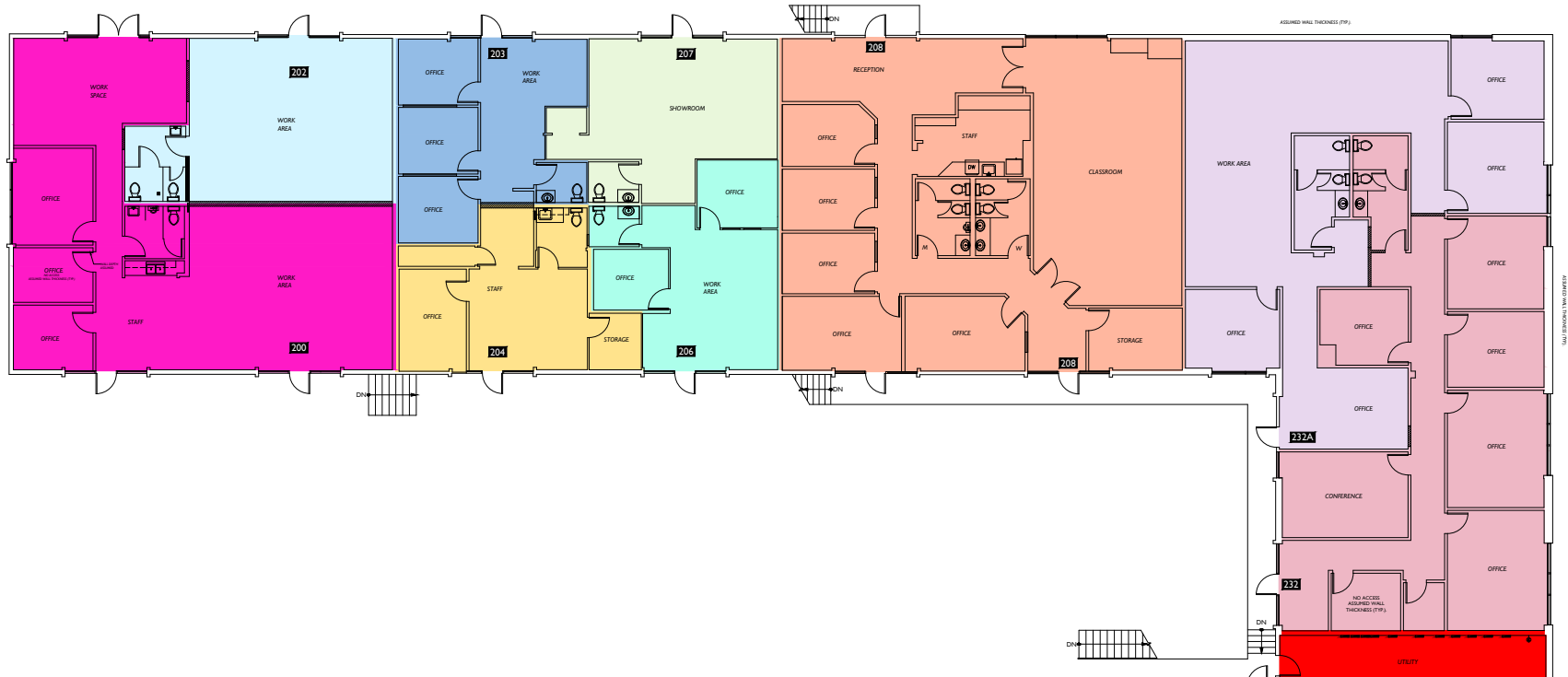

 PROPOSED WALL



**Floor Summary**      **SQ. FT.**  
 Total Rentable Area    22,441.88  
 Total Occupant Area    22,209.19  
 Load Factor            1.010477

**Floor Service Area**      0  
**Building Service Area**    339.50  
**Total Vertical**            0

Suite #	Occupant Area	Rentable Area
Suite 200	1,895.48	1,915.34
Suite 202	855.81	864.78
Suite 203	715.63	723.13
Suite 204	688.75	695.97
Suite 206	699.53	706.86
Suite 207	657.70	664.59
Suite 208	2,906.81	2,937.26
Suite 226-230	9,713.44	9,815.21
Suite 232	2,050.84	2,072.33
Suite 232A	2,025.19	2,046.41