

# 8041 S 228th Street - Suite 103

Kent, WA

## Key Facts

Property type Industrial space

Building size 40,300 SF

Space available 9,828 SF



## Contact Us

Learn more about this property or schedule a tour by reaching out to our local investment and leasing officer.

**Chad Rawlings**

+1 (206) 310-4229

chad.rawlings@eqtpartners.com

# 8041 S 228th Street - Suite 103

Kent, WA

## SPACE SPECIFICATIONS

Suite 103 Available
Warehouse Space: 8,622 SF
Office Space: 1,206 SF
Total Space: 9,828 SF
Loading: 1 GL / 4 DH (2 Edge of Dock Levelers)
Lighting: LED
Power: 400 Amps, 277/480 Volt
Clear Height: 24'

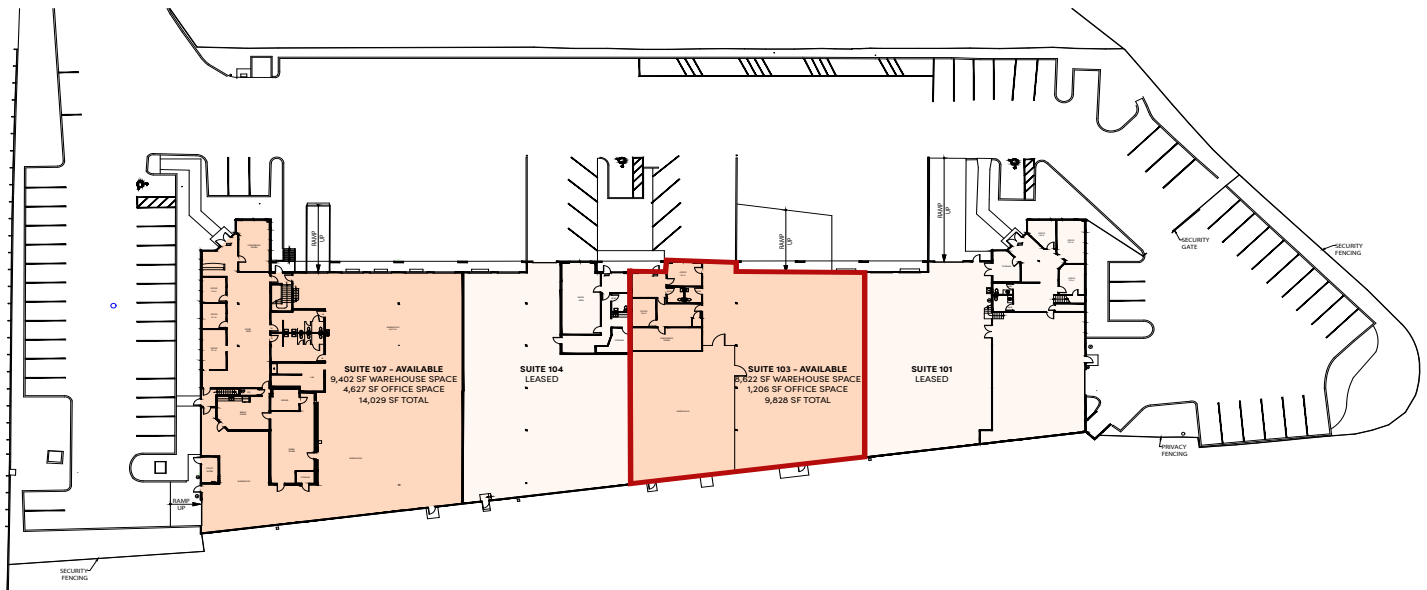
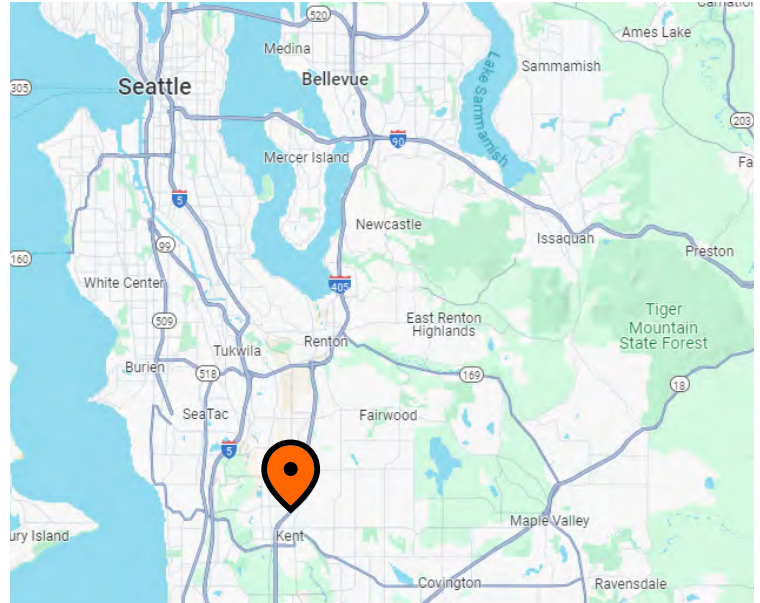

## Contact Us

Learn more about this property or schedule a tour by reaching out to our local investment and leasing officer.

**Chad Rawlings**

+1 (206) 310-4229

chad.rawlings@eqtpartners.com

# 8041 S 228th Street - Suite 103

Kent, WA

## LOCATION



## Contact Us

Learn more about this property or schedule a tour by reaching out to our local investment and leasing officer.

**Chad Rawlings**

+1 (206) 310-4229

[chad.rawlings@eqtpartners.com](mailto:chad.rawlings@eqtpartners.com)