

Puyallup West Distribution Center

Available 1/1/2027



DISTRIBUTION CENTER IN THE HEART OF PUYALLUP

170,592 SF For Lease

2606 16th St NW, Puyallup, WA 98371



For more information, contact:

SCOTT PRICE

Principal/Broker
+1 253 279 3710
sprice@neilwalter.com

JOEL JONES

Principal/Broker
+1 253 219 9914
jjones@neilwalter.com



Neil Walter Company
1940 East D St, #100
Tacoma, WA 98421
www.neilwalter.com

No warranty or representation, expressed or implied, is made as to the accuracy of the information contained herein, and same is submitted subject to error and omission.

Available 1/1/2027

2606 16th St NW, Puyallup, WA 98371

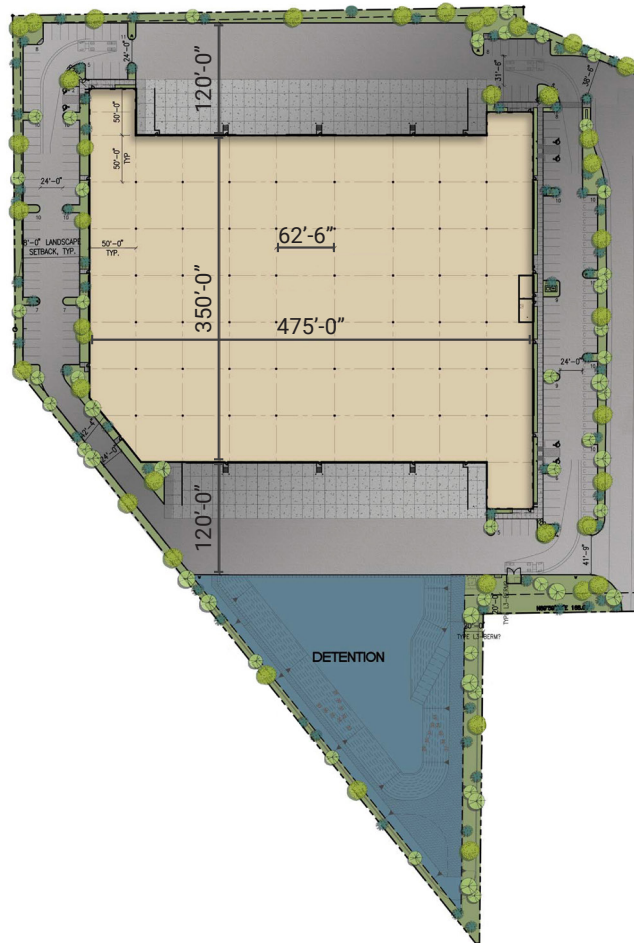

PROPERTY FEATURES

Total Building Size	170,592 SF Total (Divisible)
Office Size	2,500 SF
Property	Fully fenced and secure
Grade Level Doors	4 (12' x 14')
Dock High Doors	44 (9' x 10')
Clear Height	30'
Sprinklers	ESFR
Column Spacing	50' x 50'
Slab Thickness	6"
Dock Amenities	60' concrete apron
Lighting	T-5 (w/motion detection)
Power	1,200a of 277/480v
Parking	174 Stalls
Zoning	ML - Limited Manufacturing (City of Puyallup)

Available 1/1/2027

2606 16th St NW, Puyallup, WA 98371

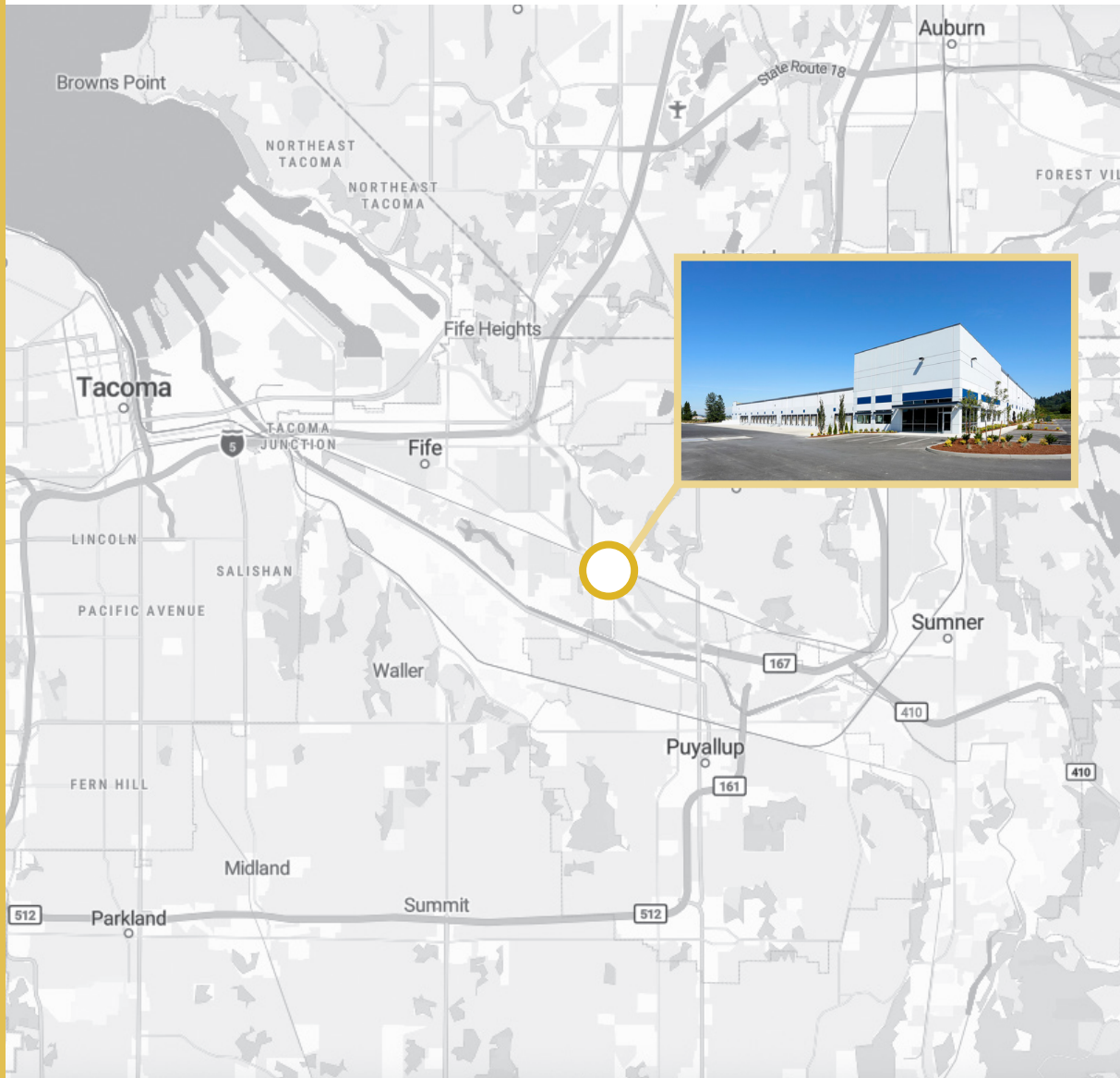

LOCATION HIGHLIGHTS

- Prime South Sound industrial location with immediate access to SR-167 and I-5
- Adjacent to IAC Port 167 industrial park
- Frontage along Valley Avenue for efficient regional connectivity
- Within the Puyallup city limits
- Approximately 10 minutes to the Port of Tacoma
- Centrally positioned between the Seattle and Tacoma industrial markets
- Excellent access to major distribution, manufacturing, and logistics corridors
- Strategic location for last-mile and port-oriented users

3.5 miles

to Interstate 5

10 miles

to Tacoma