

# 249 HARVARD, MA AYER RD



COMMERCIAL  
**O'BRIEN**  
PROPERTIES, INC

**Office Spaces For Lease**



# 249 AYER RD

249 AYER RD HARVARD, MA

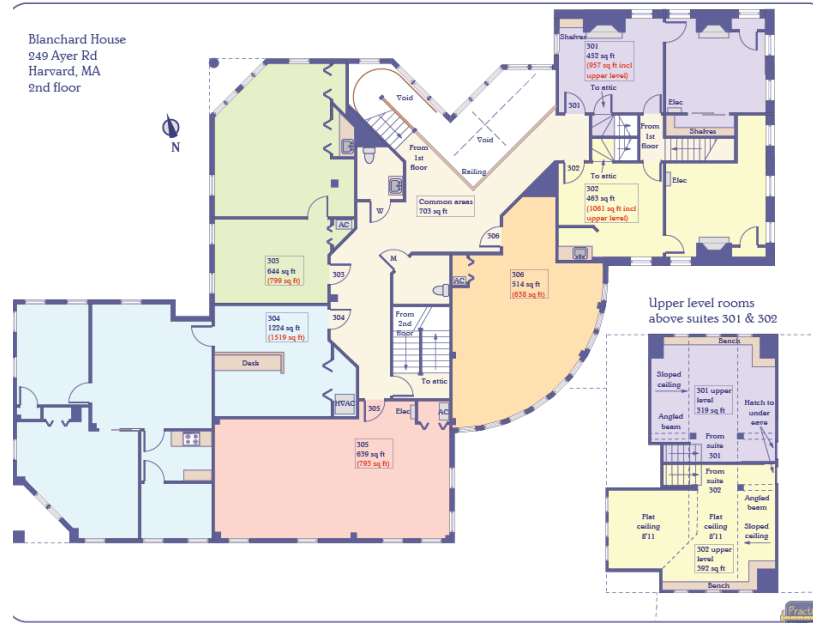

## PROPERTY DESCRIPTION

Introducing 249 Ayer Rd, an exceptional office available for lease in Harvard, MA. This office space boasts a prime location near Route 111 and Route 2, and its spacious floor layout makes it ideal for a wide range of business ventures. The property's ample parking, nearby restaurants, and major transportation routes ensure connectivity and convenience.

## PROPERTY HIGHLIGHTS

- Adjacent to Route 111
- 1 mile from Route 2
- 44 surface parking spots with covered parking available
- 3 stories
- General Commercial (GC) zoning

### OFFERING SUMMARY

Building Size:	18,319 SF
Available SF:	974 - 3,075 SF
Lot Size:	1.41 Acres
Lease Rate:	Market

### DEMOGRAPHICS

	1 MILE	2 MILES	3 MILES
Total Households	233	2,210	4,932
Total Population	725	5,981	13,568
Average HH Income	\$209,308	\$168,140	\$176,854

### SECOND FLOOR

2,574 SF Available

### GROUND FLOOR

3,075 SF Contiguous

# 249 AYER RD

249 AYER RD HARVARD, MA

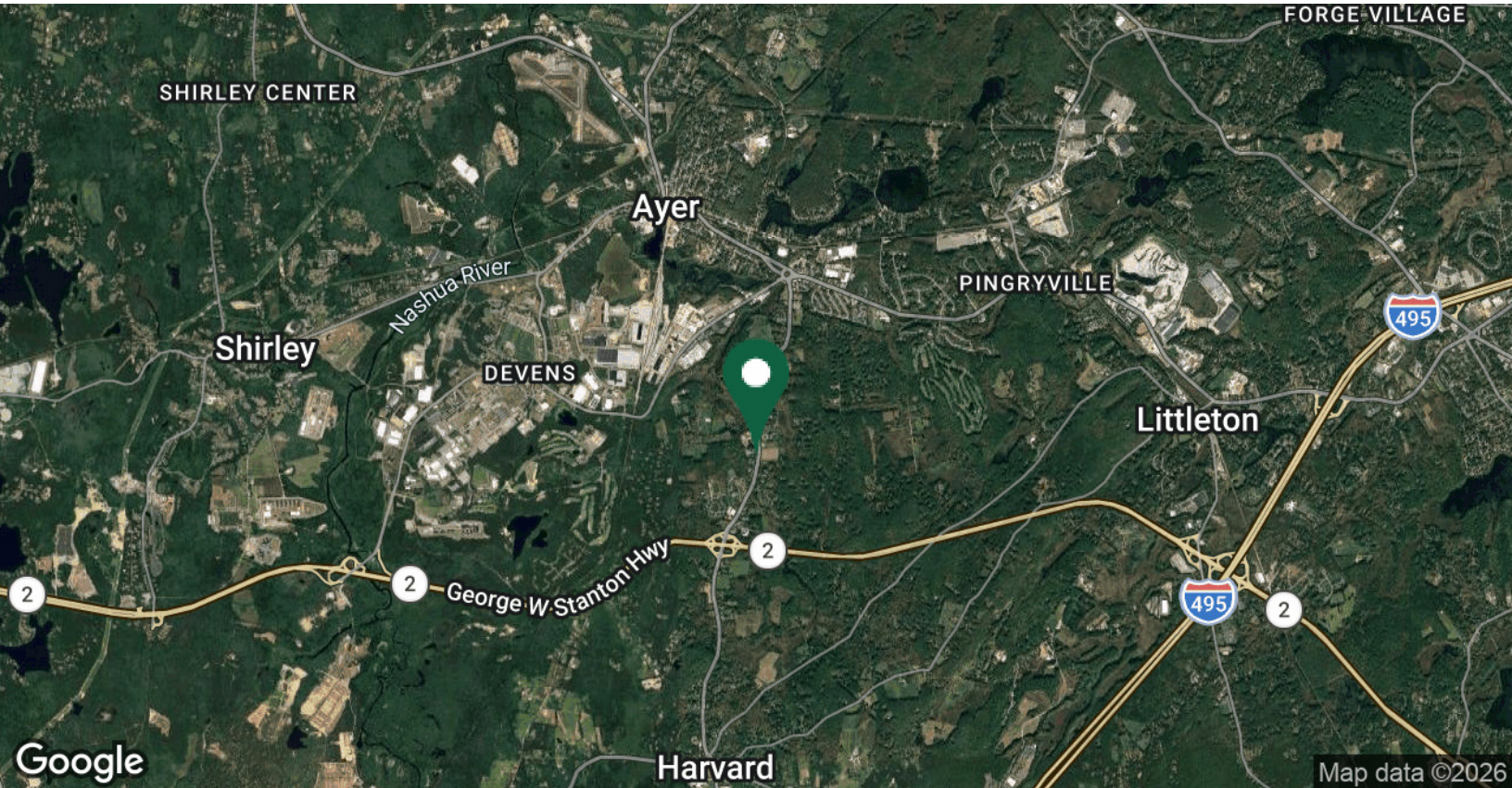

**BRANDON MEEKS**  
Senior Associate  
brandon@obriencommercial.com  
Mobile: 508.281.2939

COMMERCIAL  
**O'BRIEN**  
PROPERTIES, INC



# 249 AYER RD

*HARVARD, MA*



**BRANDON MEEKS**  
Senior Associate  
Mobile: 508.281.2939  
[brandon@obriencommercial.com](mailto:brandon@obriencommercial.com)

We obtained the information above from sources we believe to be reliable. However, we have not verified its accuracy and make no guarantee, warranty or representation about it. It is submitted subject to the possibility of errors, omissions, change of price, rental or other conditions, prior sale, lease or financing, or withdrawal without notice. We include projections, opinions, assumptions or estimates for example only, and they may not represent current or future performance of the property. You and your tax and legal advisors should conduct your own investigation of the property and transaction.