

3000 WEST
MACARTHUR BLVD.
SANTA ANA
CALIFORNIA
FOR LEASE



OFFICE SPACE AVAILABLE FOR LEASE

CONTACT: 714.434.4831

DENNIS DE MEIS | ddemeis@swcre.com

JORDAN DE MEIS | jdemeis@swcre.com

Southwest
 Commercial
Commercial Real Estate Services

PROPERTY HIGHLIGHTS

location.

SOUTH COAST METRO
MINUTES FROM
SOUTH COAST PLAZA

Lake Center

THE KWAVE 107.9FM BUILDING

4:1

SURFACE PARKING RATIO
FREE RESERVED COVERED
PARKING AVAILABLE

on-site

PROPERTY
MANAGEMENT

105,000

SQUARE FOOT
6-STORY OFFICE
BUILDING

flexible

FLOOR PLANS
OFFICE / MEDICAL /
EDUCATION POSSIBLE

security

HIGHLY SECURED
OFFICE CAMPUS
W/ PATROL

campus

OUTDOOR SITTING AREAS

free

RESERVED PARKING
EXTRA PARKING
POSSIBLE!

wired

HIGH SPEED
INTERNET

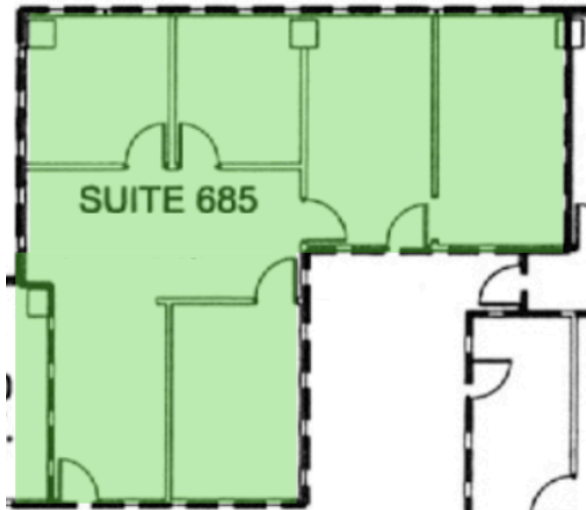

FLOOR PLAN

Suite 685 = 1,161 rentable square feet

