



Kyle Selby, MSRE
kselby@selbyrealty.com
(386) 295-3313



**SELBY
REALTY**

200 E. Granada Blvd., Suite 207
Ormond Beach, FL 32176
(386) 238-4456 O.
(386) 238.8377 F.

13,000SF—25,800SF RETAIL SPACE FOR LEASE



Enhanced w/ AI



333 W. Granada Blvd., UNIT 200 Ormond Beach, FL 32174

Property Highlights

- 333 West Granada— Multi-Tenant Retail Business Center
- Available space could be subdivided from 13,000sf up to 25,800sf.
- 20'+ Clear Height
- The red outline on the picture to the right is approximately 13,000SF and the blue is approximately 25,800SF
- 13,000sf (red) portion dimensions are 84' x 155'.

Property Details

- Site:** Highly Visible and well-known plaza Located between US1 and Nova Rd. on the most desirable commercial corridor in Ormond Beach.
- Building:** Single-story, Multi-Tenant Retail Building
- Parking:** On-site parking lot with 237 spaces
- Unit 200:** 13,000SF—25,800SF of move-in ready space
- Rate:** Base rate for front (red) 13,000sf is \$19.50 NNN.
- Passthroughs:** Estimated to be \$4.14
- Signage:** Building and monument signage
- Zoning:** B-10, Central Business, City of Ormond Beach
- Traffic:** 36,000 (AADT 2020)
- Location:** Granada Blvd (St. Rt. 40), 1 block West of A1A
- Businesses**
- Nearby:** Ace Hardware, WaWa, Aldi, Office Depot, Culver's
- Availability:** April 2026

333 W GRANADA UNIT 200 FLOOR PLAN

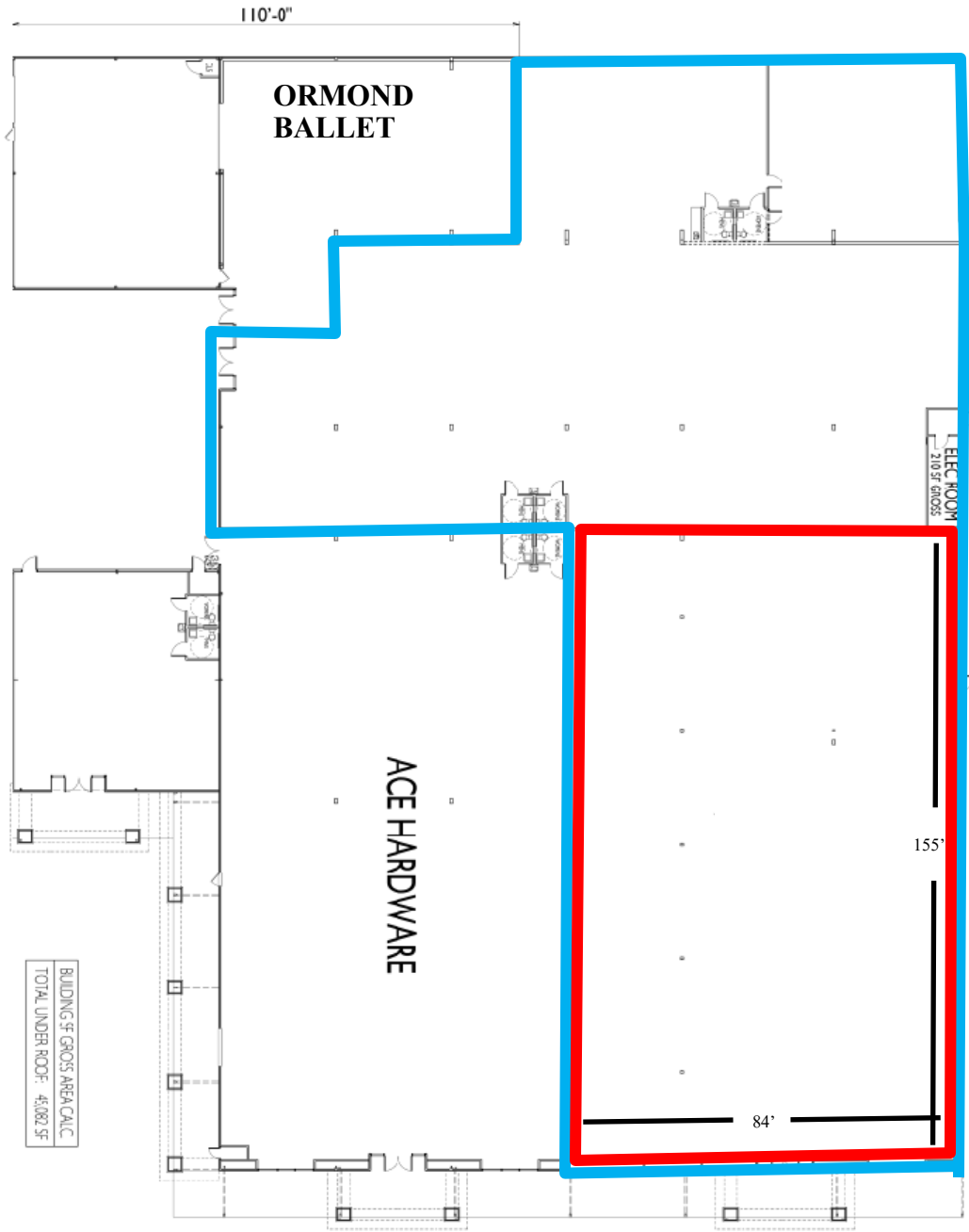

333 W GRANADA UNIT 200 PICTURES



SELBY
REALTY



*Pictures 2 and 3 are AI generated
to show what the space could look
like.*

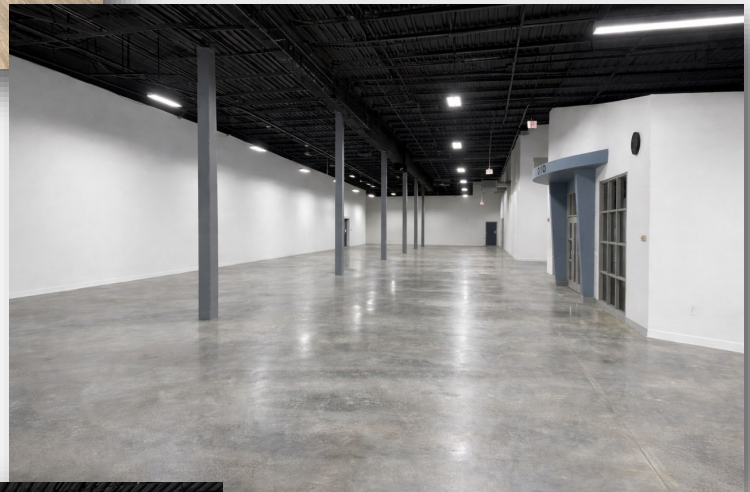

333 W. GRANADA UNIT 200 PROPERTY MAP

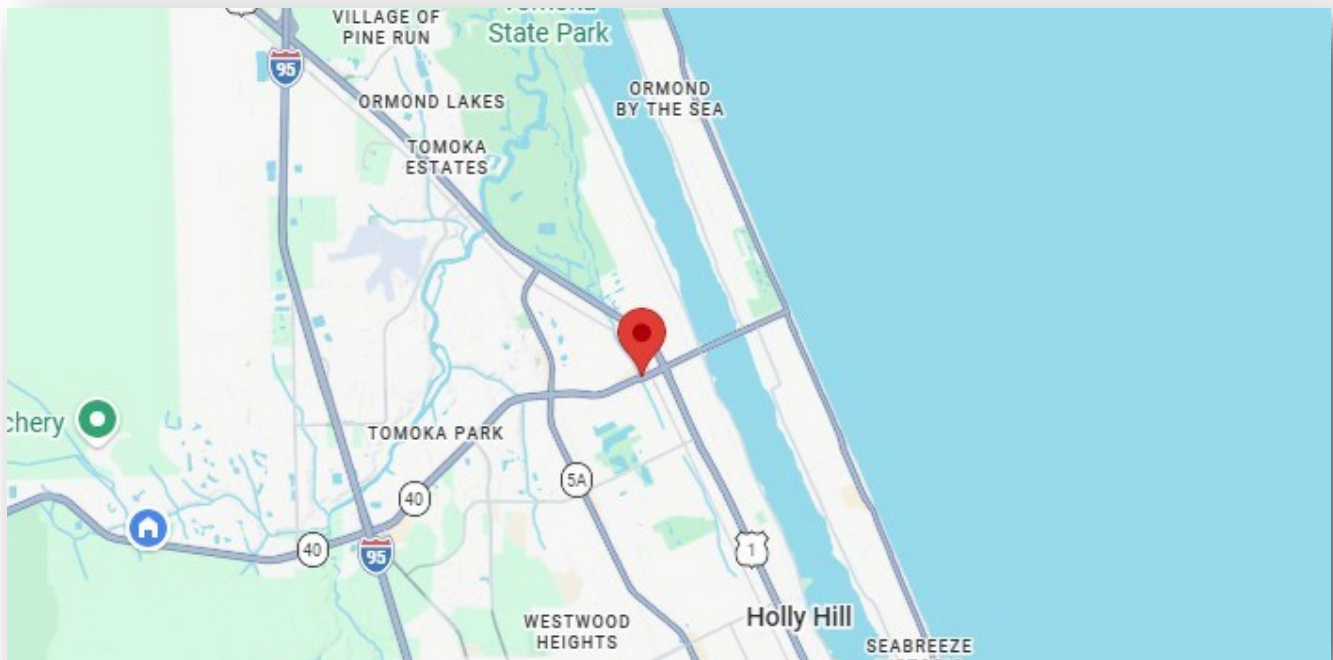
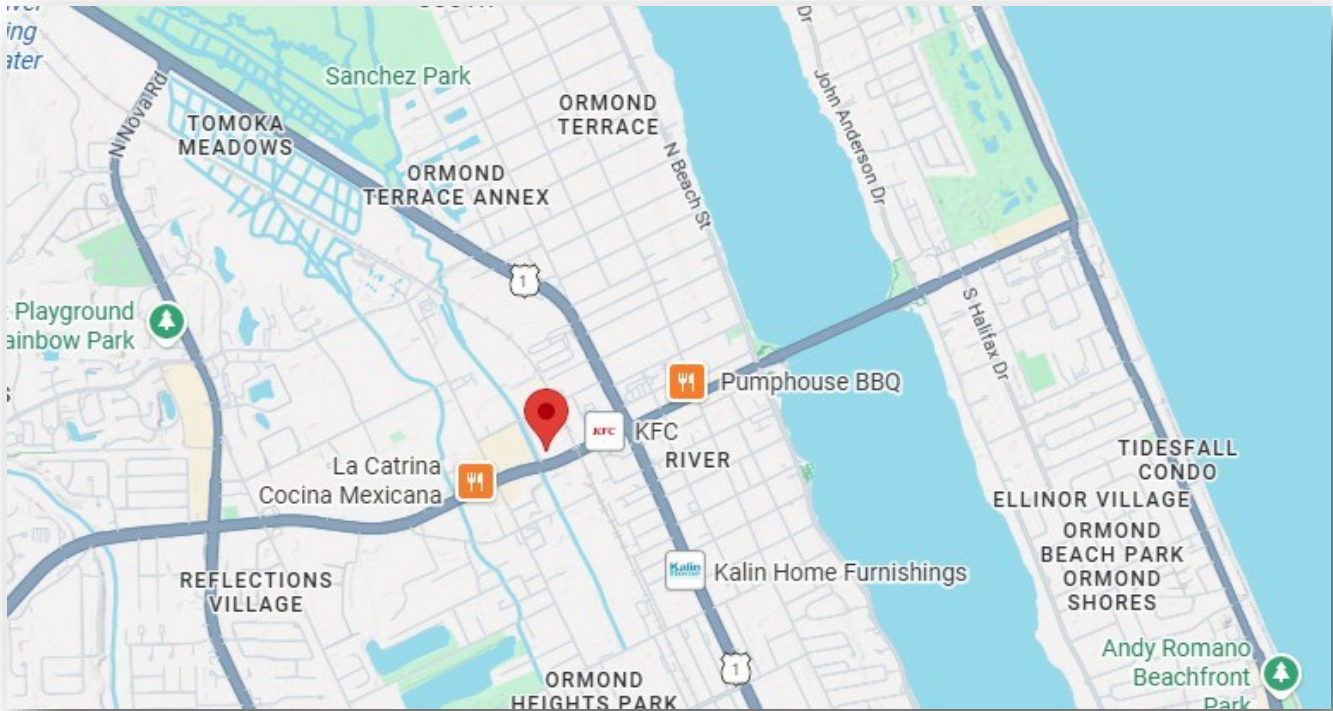

Information is collected from sources deemed reliable; however, not warranted by the Seller or Selby Realty, Inc. Subject to errors, omissions, change of terms, price withdrawal, or prior sale without notice. Interested parties must conduct their own investigations to reach an investment decision. Property is being sold in "As Is, Where Is" condition with Seller making no representations or warranties.