

For Sublease

Westwood II

6270 Bury Drive | Eden Prairie, MN 55346

ROKOS
ADVISORS

Flexible Industrial
Sublease Opportunity
in Eden Prairie



Harry Ollington
harry.ollington@rokosadvisors.com
m: 612 442 6004

515 N Washington Ave, Suite 300
Minneapolis, MN 55401
rokosadvisors.com



For Sublease

Westwood II

6270 Bury Drive | Eden Prairie, MN 55346

ROKOS
ADVISORS

Space Highlights

- 5,000 – 11,882 SF of warehouse space
- Sublease term through December 31st, 2027
- Asking rent: \$6.50/sf NNN
- 2026 CAM/Tax: \$3.86/sf
- Subtenant to be responsible for gas, electric, trash, & Wi-Fi
- 13' clear height with 1 drive-in door and 1 dock door
- Good power available
- Trench drains and flammable waste trap in place
- Building and monument signage on Bury Drive
- Easy access to Hwy 62 and I-494



For Sublease

Westwood II

6270 Bury Drive | Eden Prairie, MN 55346

ROKOS
ADVISORS

Space Plan

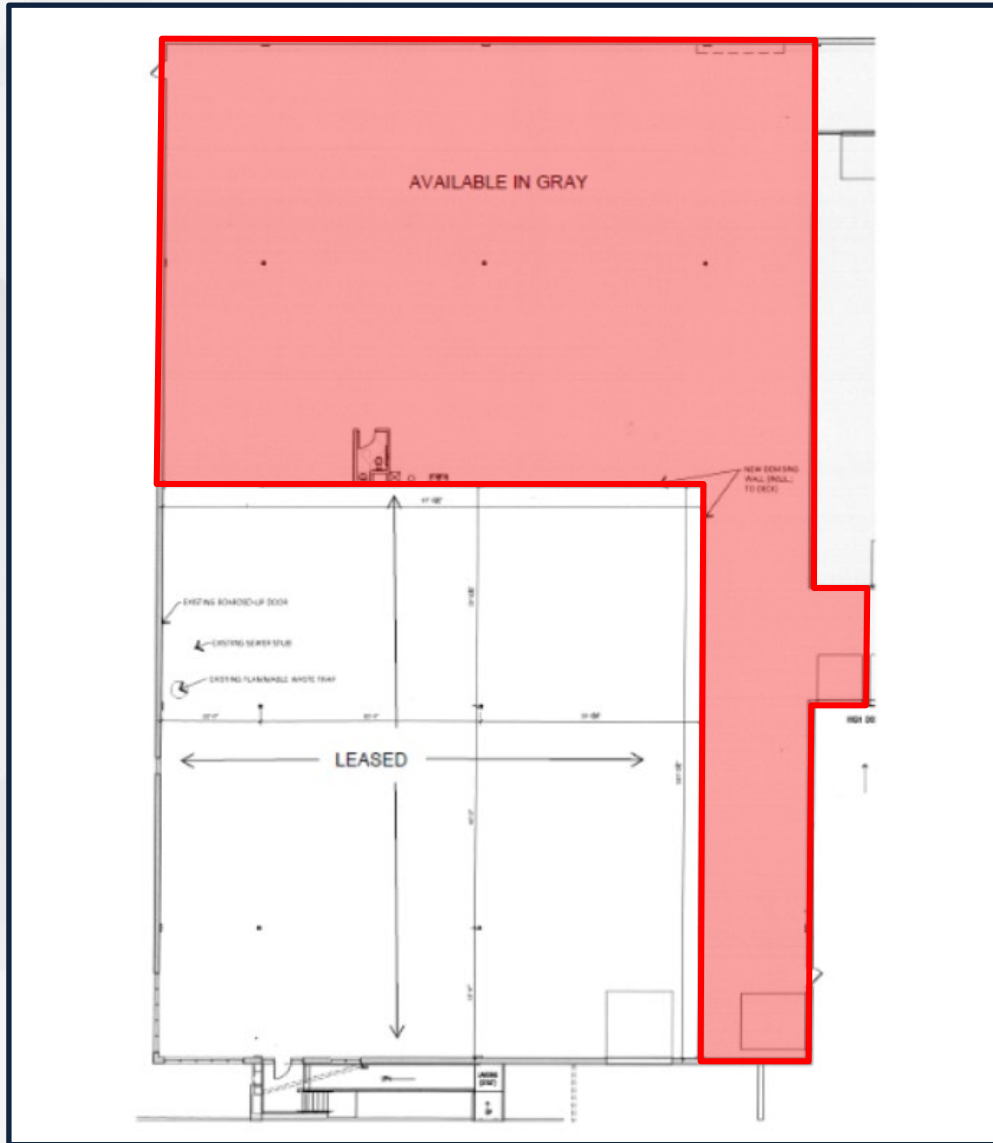

MISSISSIPPI RIVER

LIGHTRAIL GREEN LINE

For Sublease

Westwood II

6270 Bury Drive | Eden Prairie, MN 55346

ROKOS
ADVISORS



CONTACT US

Harry Ollington
harry.ollington@rokosadvisors.com
m: 612 442 6004

515 N Washington Ave, Suite 300
Minneapolis, MN 55401
rokosadvisors.com



* No warranty or representation, express or implied, is made to the accuracy or completeness of the information contained herein, and same is submitted to errors, omissions, change or price, rental or other conditions. Withdrawal without notice and to any special listing conditions imposed by the property owner(s). As applicable, we make no representation as the condition of the property in question.