

**9070 RANCHO PARK COURT
RANCHO CUCAMONGA, CA 91730**



FOR LEASE

±15,503 SF Industrial Building

PROPERTY HIGHLIGHTS:

- ±15,503 SF Available
- ±5,600 SF of 2 Story Office
(Classroom/Bullpen)
- Fire Sprinklers - .35/ 3,000
- 400 Amps 3 Phase 480V/277V
- 24' Clear Height
- 12 X 14 Ground Level Door (Auto)
- 2 Dock High Positions
- Fenced Yard

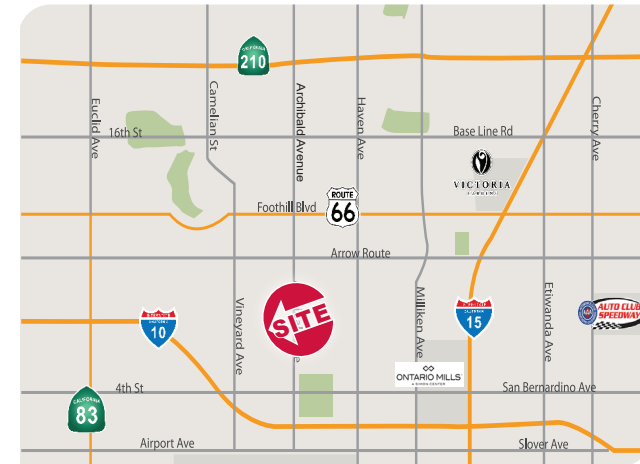

JONATHAN PAULS
DRE#: 01417045 | 951.276.3643
jpauls@lee-associates.com

Lee & Associates - Riverside, 3240 Mission Inn Avenue, Riverside, CA 92507 | Corporate License DRE#: 01048055

No warranty or representation has been made to the accuracy of the foregoing information. Terms of sale or lease and availability are subject to change or withdrawal without notice.

**9070 RANCHO PARK COURT
RANCHO CUCAMONGA, CA 91730**

FOR LEASE
±15,503 SF Industrial Building



JONATHAN PAULS
DRE#: 01417045 | 951.276.3643
jpauls@lee-associates.com

Lee & Associates - Riverside, 3240 Mission Inn Avenue, Riverside, CA 92507 | Corporate License DRE#: 01048055

No warranty or representation has been made to the accuracy of the foregoing information. Terms of sale or lease and availability are subject to change or withdrawal without notice.

9070 RANCHO PARK COURT
RANCHO CUCAMONGA, CA 91730

FOR LEASE
±15,503 SF Industrial Building

SITE PLAN

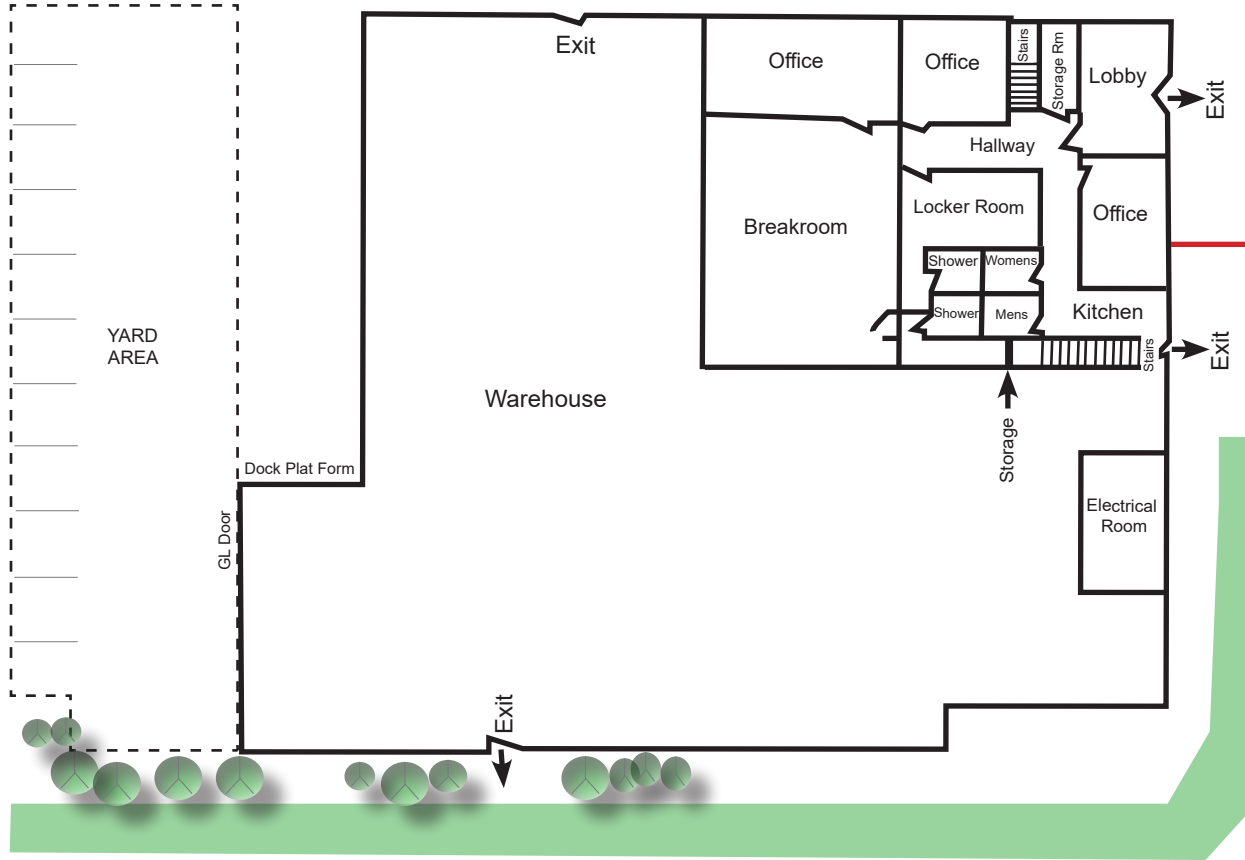

2ND FLOOR OFFICE

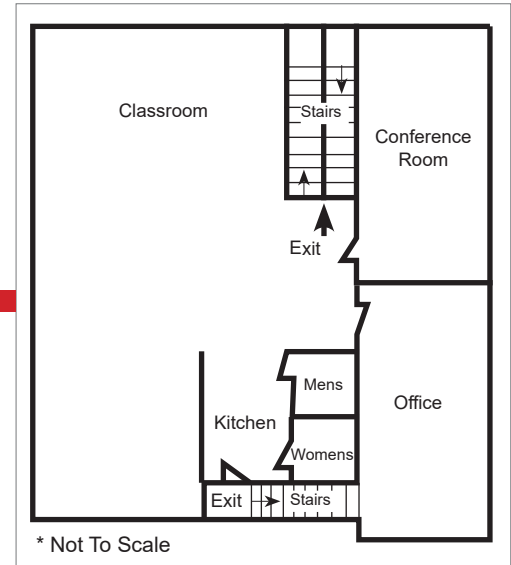

* Not To Scale



JONATHAN PAULS
DRE#: 01417045 | 951.276.3643
jpauls@lee-associates.com

Lee & Associates - Riverside, 3240 Mission Inn Avenue, Riverside, CA 92507 | Corporate License DRE#: 01048055

No warranty or representation has been made to the accuracy of the foregoing information. Terms of sale or lease and availability are subject to change or withdrawal without notice.