

PORTION ROAD
(FARM TO MARKET ROAD)(C.R. 16)

N82°37'24"E
35.92'

N74°09'18"E

163.94'

L=263.13'

R=3,325.83'

N41°31'53"E
43.73'

100.61'

N02°03'06"E
117.26'

N11°39'02"E
181.88'

HOLBROOK ROAD

N02°10'30"E

S80°14'53"W LAND NOW OR FORMERLY OF SUFFOLK COUNTY 156.12'

S80°14'53"W

90.52'

S03°35'08"E

LAND NOW OR FORMERLY OF SUFFOLK COUNTY

393.01'

S03°27'39"E

347.70'

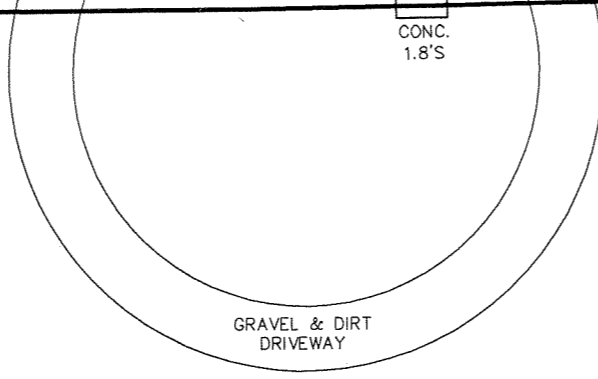
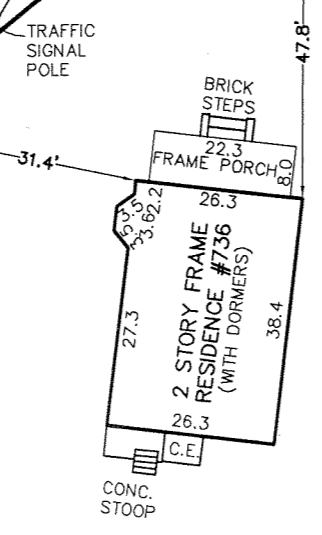

MAP OF
DESCRIBED PROPERTY
SITUATE

RONKONKOMA

TOWN OF BROOKHAVEN, SUFFOLK COUNTY N.Y.
AREA = 181,675 SQ. FT., OR 4.17 ACRES
DATE: NOVEMBER 5, 2019 SCALE: 1"=30'

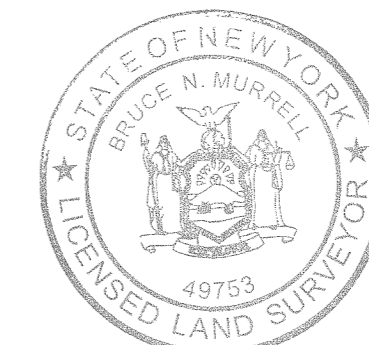

Bruce N. Murrell

PREPARED BY
SCHNEPF & MURRELL, P.C.
LAND SURVEYORS - LAND PLANNERS

126 MAIN STREET
SAYVILLE, NEW YORK
TEL. 631-589-1322 FAX 631-589-1779
INFO@SCHNEPFANDMURRELL.COM

DISTRICT	SECTION	BLOCK	LOT
200	650	3	1.1

Unauthorized alteration or addition to this survey is a violation of Section 7209, sub-division 2, of the New York State Education Law.
Copies of this Survey Map not bearing the land surveyor's inked or embossed seal shall not be considered to be a valid true copy.
Certifications indicated hereon signify that this survey was prepared in accordance with the existing Code of Practice for Land Surveys adopted by the New York State Association of Professional Land Surveyors. Said certifications shall run only to the person for whom the survey was prepared, and on his behalf to the title company, governmental agency and lending institution listed hereon, and to the successors and/or assigns of the lending institution for the purpose of their mortgage to said person(s) for whom this survey was prepared. Certifications are not transferable to additional institutions or subsequent owners other than those stated.