

Retail/Commercial Space

FOR LEASE



THE BEHAR GROUP
LANDLORD SERVICES

3443-3461 WESTON ROAD, TORONTO



Retail units fronting on Weston Road one block south of Finch.

- Casa Emery Village is an exciting mixed-use development located near the southeast corner of Finch Ave. W and Weston Road.
- Upon completion of all three phases the development will offer approximately 1400 residential units and over 48,000 square feet of prime retail space.
- Phase 1 of the development is complete and street front retail units are ready for build out and occupancy. Phase 2 currently under construction.
- Development conveniently located in the heart of Emery Village close proximity to HWY's 400, 407 and 427.

ARYEH ROSENZWEIG

Sales Representative

416 636 8898 EXT 251

arosenzweig@thebehargroup.com

The Behar Group Realty Inc., Brokerage

1170 Sheppard Avenue West, Unit 24,

Toronto, ON M3K 2A3

Tel: 416.636.8898 / Fax: 416.636.8890

www.thebehargroup.com

AVAILABILITIES

MASTER SITE PLAN

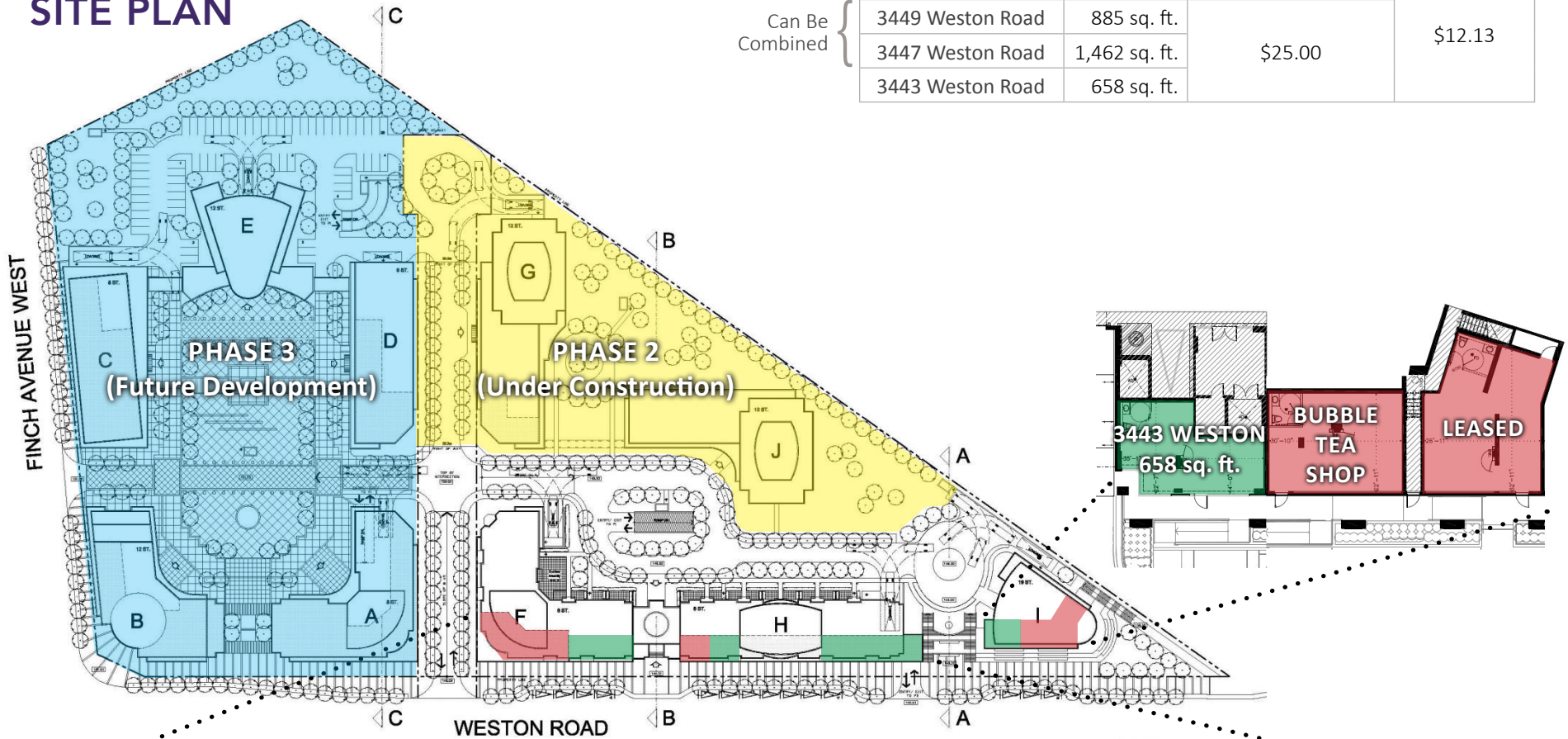

Can Be Combined

Unit Address	Size	Asking Rent	Additional Rent (Estimated)
3461 Weston Road	1,317 sq. ft.	\$27.00	\$12.13
3449 Weston Road	885 sq. ft.	\$25.00	
3447 Weston Road	1,462 sq. ft.		
3443 Weston Road	658 sq. ft.		

FLOOR PLANS

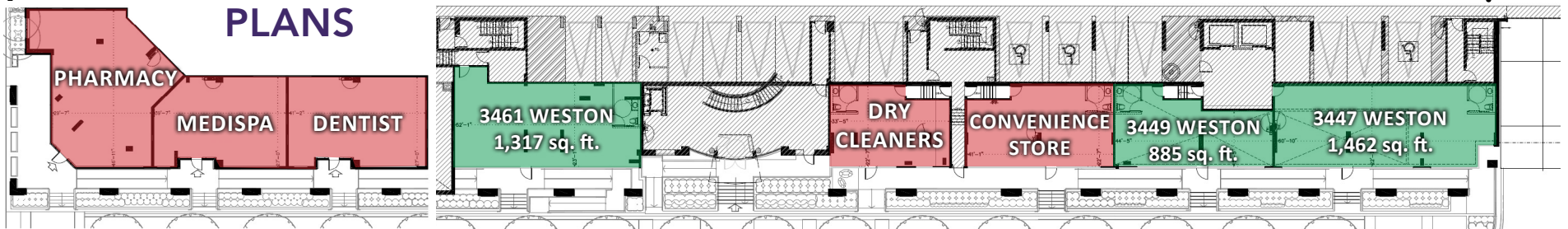

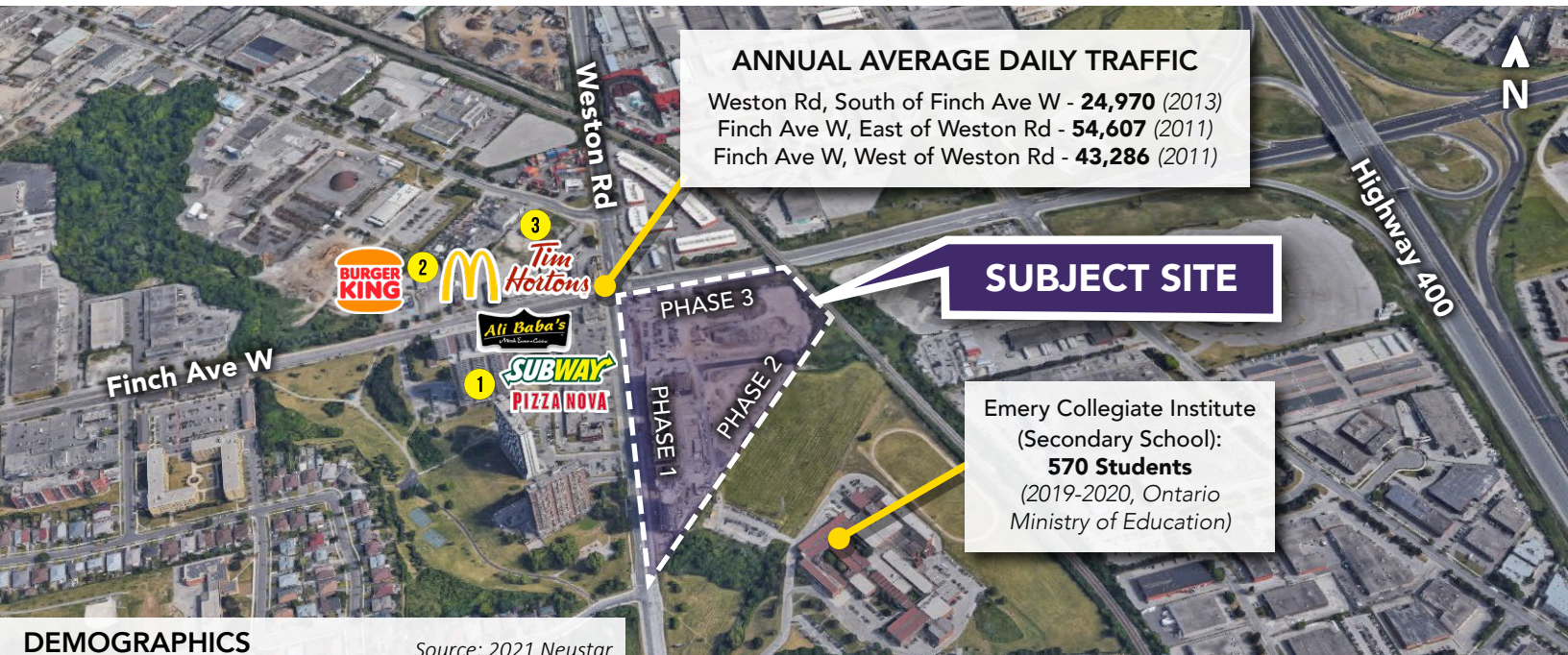
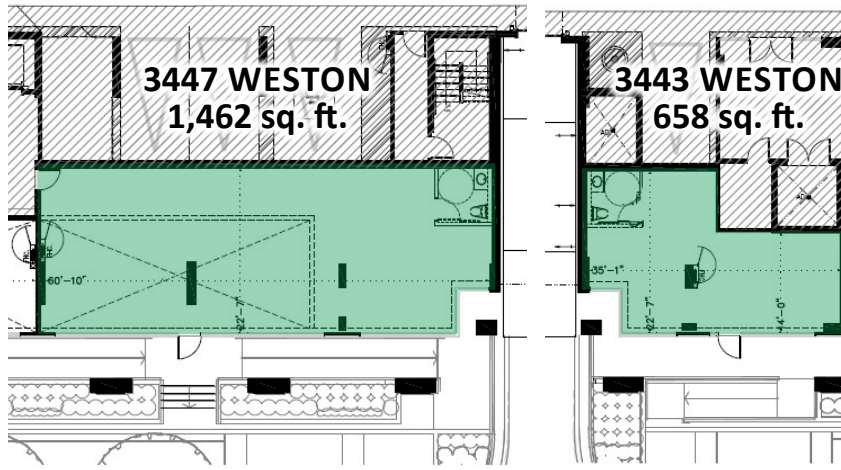
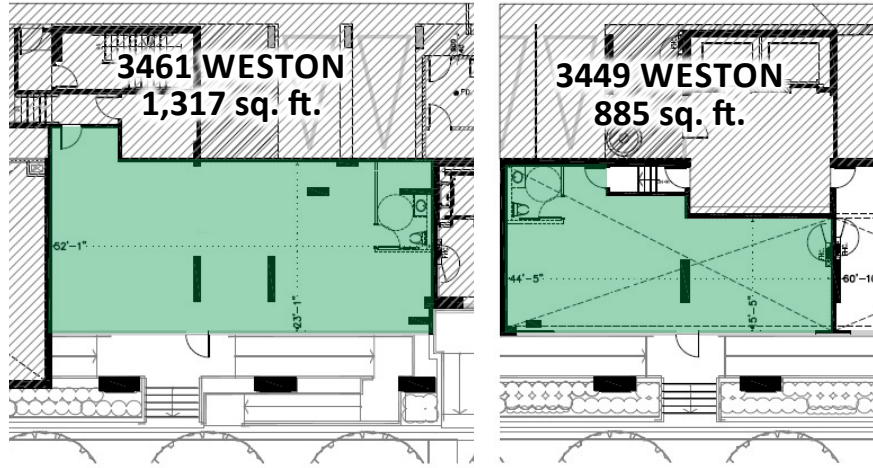

DEMOGRAPHICS

Source: 2021 Neustar

RADIUS	1 km	3 km	5 km
Total Population	12,601	97,728	255,834
Total Daytime Population	16,806	124,366	315,080
Total Households	4,202	31,544	85,388
Average Household Income	\$68,049	\$76,325	\$80,318

RESIDENTIAL DEVELOPMENTS:

+/- 1,925 Total Units

NUMBER & NAME	TYPE	STATUS	UNITS
1 2405 Finch Avenue West	Rental Apartment	Pre-Construction	480
2 2370 Finch West	Condo	Pre-Construction	268
3 19 Toryork	Rental Apartment	Pre-Construction	1,177

Map Source: Google Earth 2021