

AVAILABLE FOR SUBLEASE ±18,800 SF INDUSTRIAL SUITE



7949

STROMESA COURT
SUITES C-R

SAN DIEGO, CA 92126

MIRAMAR SUBMARKET

Voit

REAL ESTATE SERVICES

GREG MARX, SIOR

Senior Vice President
Lic.#01940696
858.458.3302
gmarx@voitco.com

** Image has been digitally modified by artificial intelligence (AI). The depiction is for visualization purposes only and may not reflect actual property conditions. Original image available upon request.*

CARTER SHANNON

Associate
Lic.#02244724
858.458.3303
cshannon@voitco.com

SUITE FEATURES

- » ±18,800 SF Industrial Suite Available For Sublease
- » 5% Office / 95% Warehouse
- » 22' Clear Height
- » **4,000 SF of Free Bonus Mezzanine (Metal)**
- » 2 Grade Level Doors
- » 2 Dock High Doors
- » Heavy Power
- » Fully Sprinklered
- » 3.17/1,000 Parking Ratio
- » Skylights
- » Central Miramar Location
- » Convenient Truck Access
- » Available Immediately

LEASE RATE: \$1.09 NNN PSF

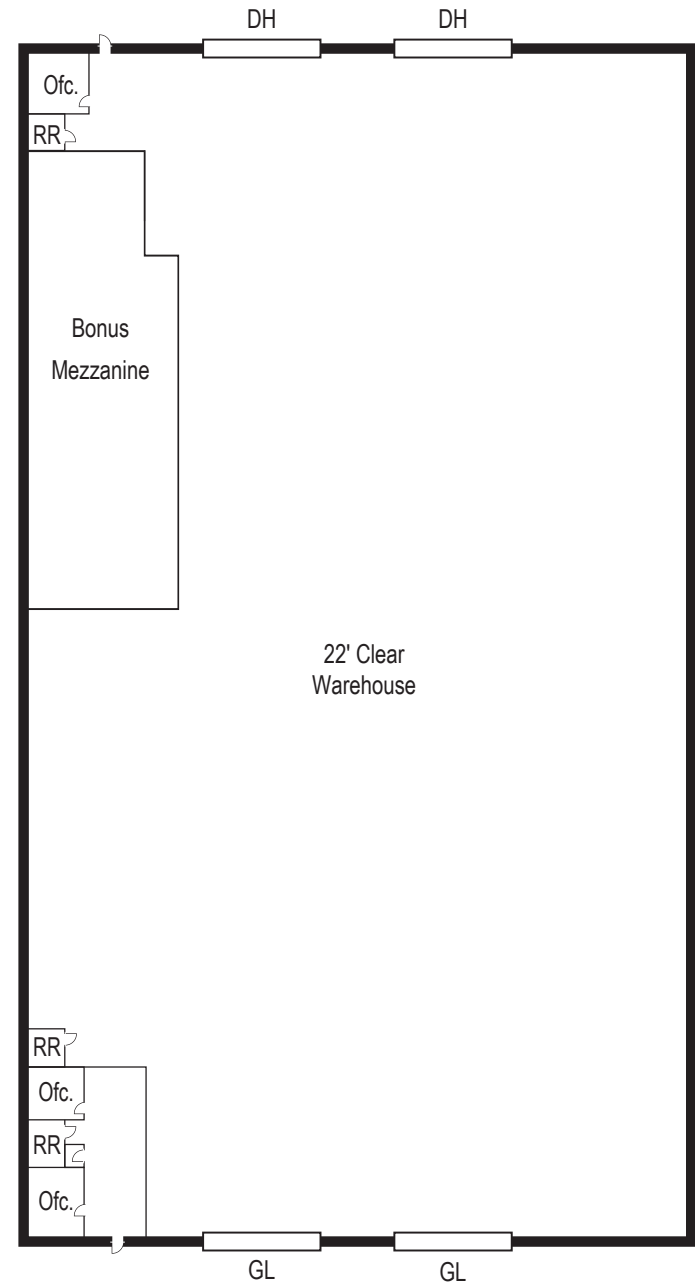

SITE PLAN

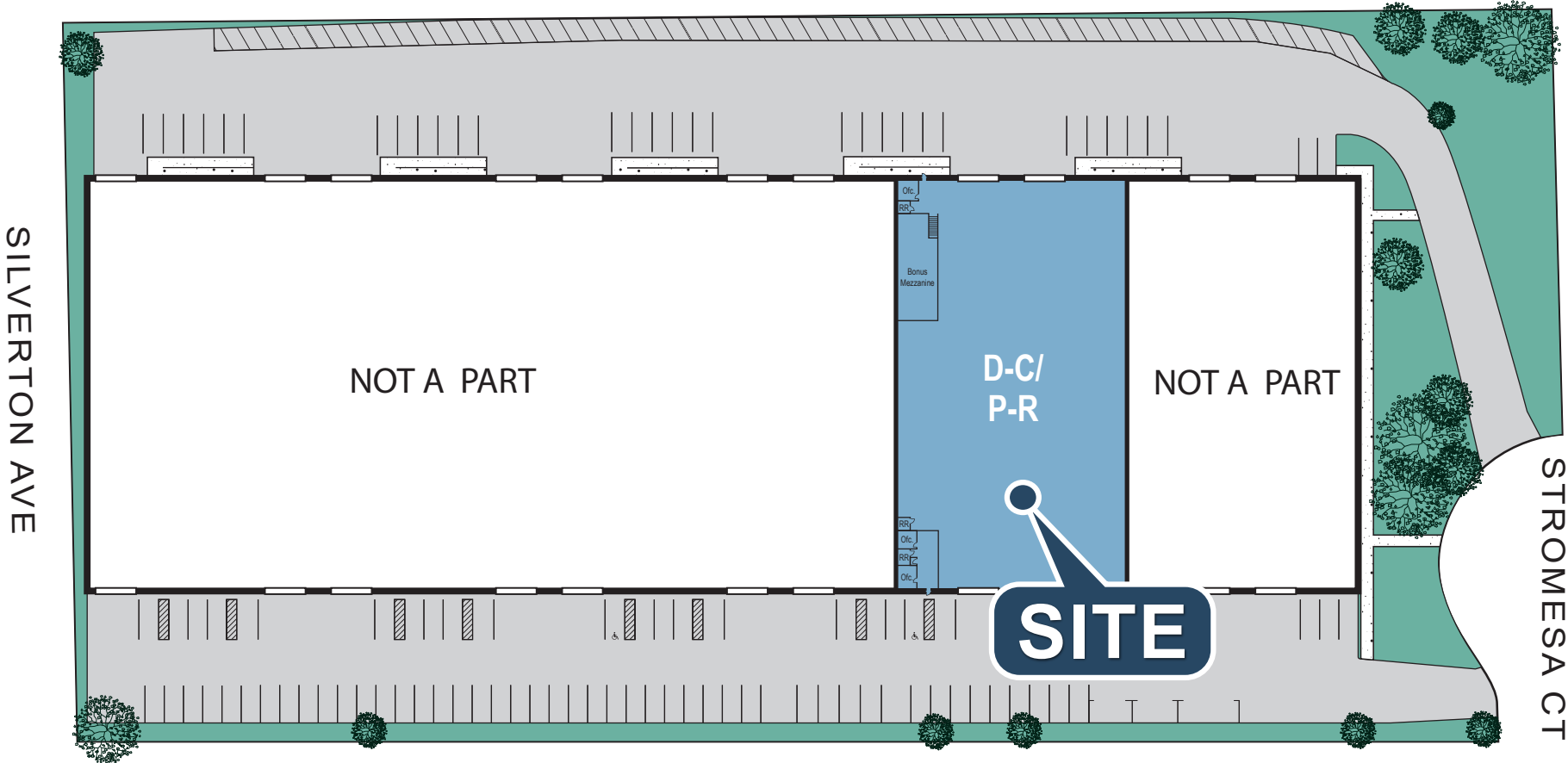

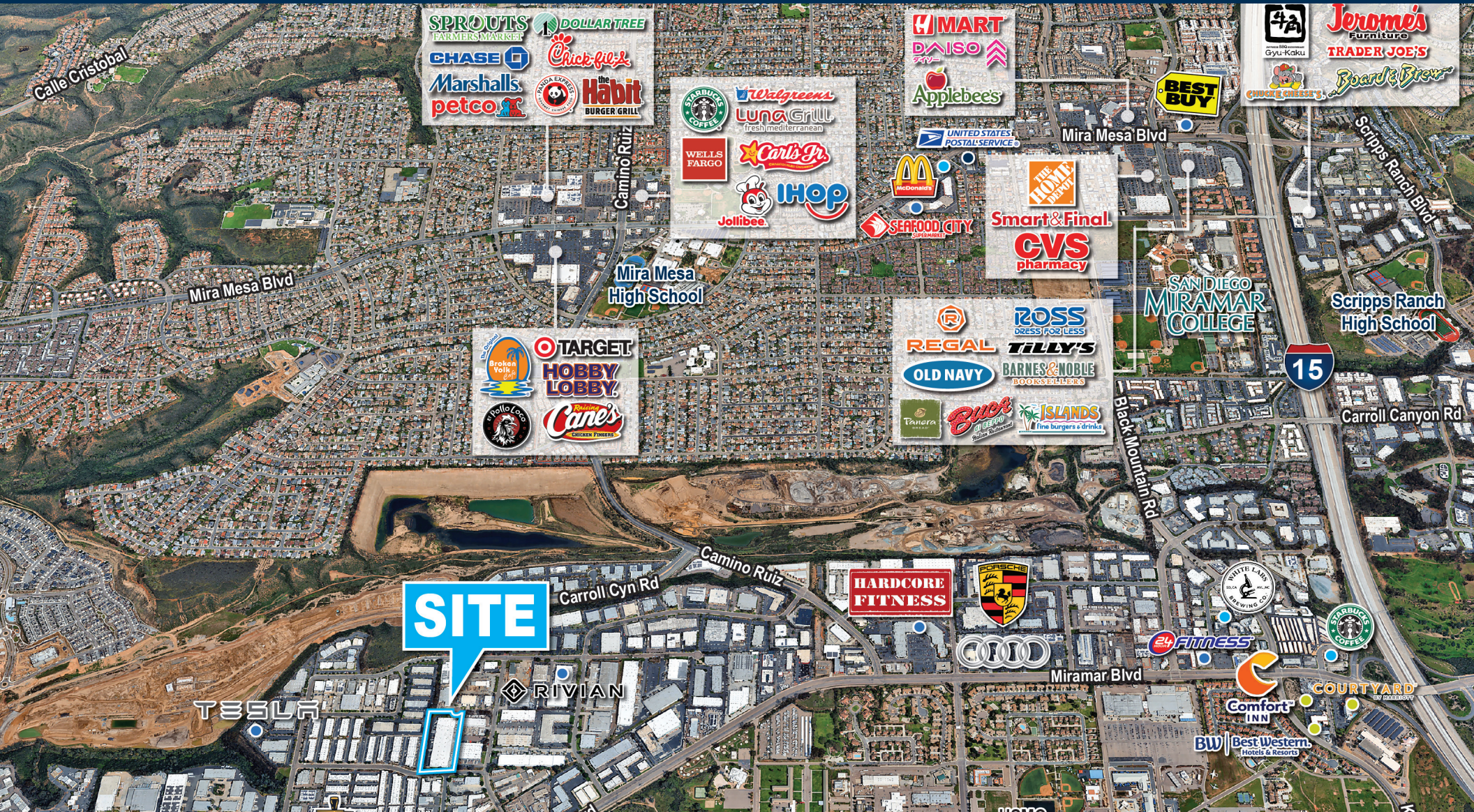

GREG MARX, SIOR
 Senior Vice President
 Lic.# 01940696
 858.458.3302 | gmarx@voitco.com

CARTER SHANNON
 Associate
 Lic.# 02244724
 858.458.3303 | cshannon@voitco.com

4180 La Jolla Village Drive, Suite 100, La Jolla, CA 92037 | 858.453.0505 | Lic #01991785 | www.voidco.com

Licensed as a Real Estate Broker and Salesperson by the DRE. The information contained herein has been obtained from sources we deem reliable. While we have no reason to doubt its accuracy, we do not guarantee it. ©2026 Voit Real Estate Services, Inc. All Rights Reserved.

Voit
 REAL ESTATE SERVICES