



SW Tucson Office Space for Sublease

Riverfront Professional Offices - 1360 W. Irvington Road, Tucson, Arizona

2,173 SF Office - Located just west of I-19 along the Santa Cruz River Park

For more information, please contact
exclusive listing agents:

David Carroll

DavidC@PaulAshCRE.com

John Yarborough

JohnY@PaulAshCRE.com



- Located in the Riverfront Professional Offices within the Riverfront Plaza
- Newer construction with space originally built out for a real estate office
- Functional layout with a combination of private offices and open space
- Initial Lease Rate: \$24.00/SF Modified Gross - rate is subject to 3% annual increases
- Lease expires October 31, 2028.
- Convenient location close to I-19 with convenient access to Downtown Tucson and the Airport
- Close to retail, restaurants and amenities

Paul Ash Commercial Real Estate

3499 N. Campbell Ave., Suite 907

Tucson, AZ 85719

Main 520.795.2100

www.PaulAshCRE.com

License #LC509321000

The above information has been secured from sources we believe to be reliable, but we make no representation or warranties, expressed or implied, as to the accuracy of the information. References to square footage or age are approximate. We make no representations or warranties that the premises are free of environmental hazards or that the premises are suitable in all respects to your contemplated use. You should conduct an independent investigation of all pertinent property information. We bear no liability for any errors, inaccuracies, or omissions.



SW Tucson Office Space for Sublease

Riverfront Professional Offices - 1360 W. Irvington Road, Tucson, Arizona

2,173 SF Office - Located just west of I-19 along the Santa Cruz River Park

For more information, please contact
exclusive listing agents:

David Carroll

DavidC@PaulAshCRE.com

John Yarborough

JohnY@PaulAshCRE.com

Paul Ash Commercial Real Estate

3499 N. Campbell Ave., Suite 907

Tucson, AZ 85719

Main 520.795.2100

www.PaulAshCRE.com

License #LC509321000



The above information has been secured from sources we believe to be reliable, but we make no representation or warranties, expressed or implied, as to the accuracy of the information. References to square footage or age are approximate. We make no representations or warranties that the premises are free of environmental hazards or that the premises are suitable in all respects to your contemplated use. You should conduct an independent investigation of all pertinent property information. We bear no liability for any errors, inaccuracies, or omissions.



SW Tucson Office Space for Sublease

Riverfront Professional Offices - 1360 W. Irvington Road, Tucson, Arizona

2,173 SF Office - Located just west of I-19 along the Santa Cruz River Park

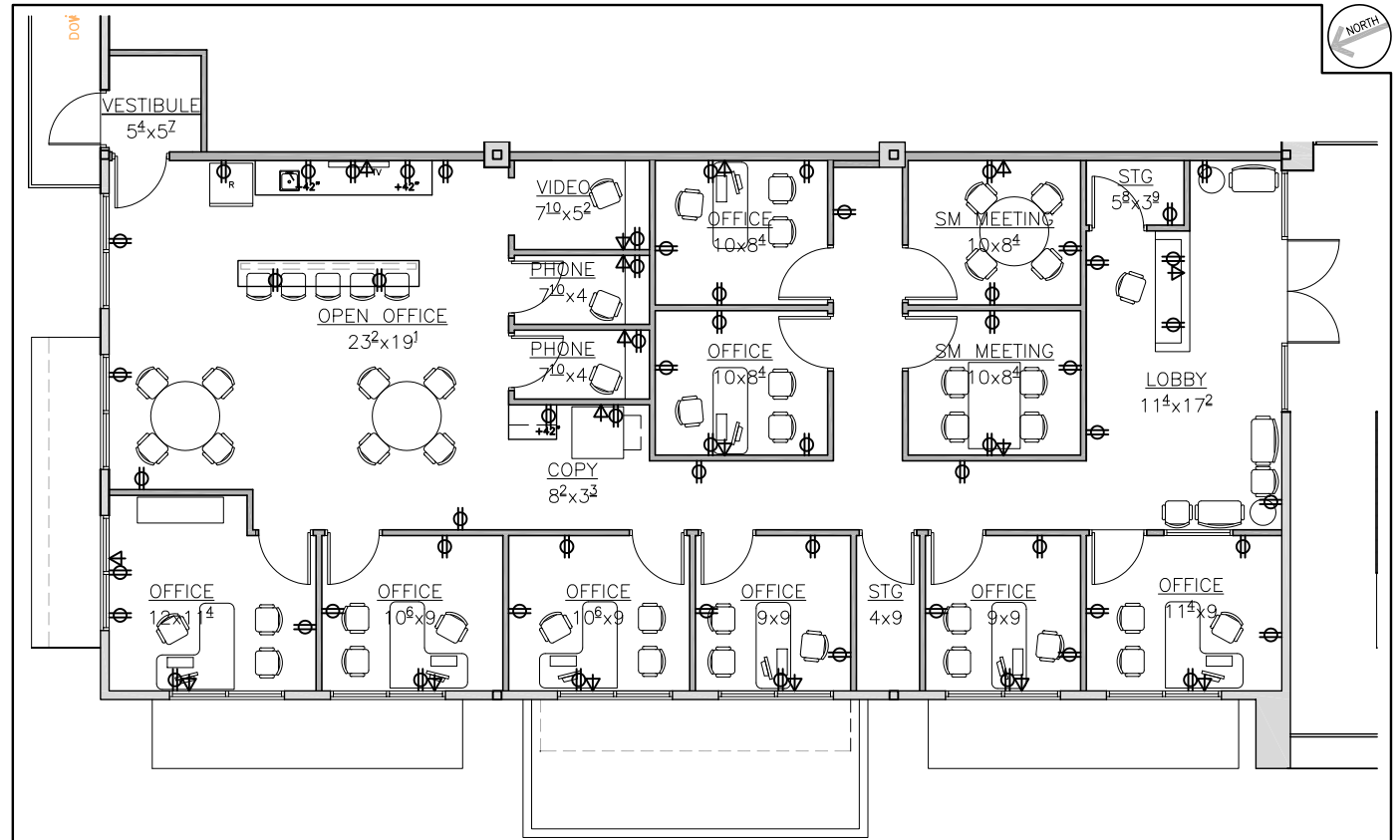

For more information, please contact exclusive listing agents:

David Carroll
DavidC@PaulAshCRE.com

John Yarborough
JohnY@PaulAshCRE.com

REALTY ONE GROUP

SCALE: 1/8" = 1'-0"
POWER/DATA **A2**

PROJECT: #21.011 ADDRESS: 1360 W. IRVINGTON ROAD, TUCSON, AZ 85746
DATE: 05.25.2021

APPROVED BY:

DATE:

NOT FOR CONSTRUCTION



ARCHITECTS
6418 E TANQUE VERDE RD
TUCSON, AZ 85715
P 520.546.6667
F 520.546.4777
GEORGE.LANCE@L2ARCHITECT.COM
WWW.L2ARCHITECT.COM

Paul Ash Commercial Real Estate
3499 N. Campbell Ave., Suite 907
Tucson, AZ 85719
Main 520.795.2100
www.PaulAshCRE.com

License #LC509321000

The above information has been secured from sources we believe to be reliable, but we make no representation or warranties, expressed or implied, as to the accuracy of the information. References to square footage or age are approximate. We make no representations or warranties that the premises are free of environmental hazards or that the premises are suitable in all respects to your contemplated use. You should conduct an independent investigation of all pertinent property information. We bear no liability for any errors, inaccuracies, or omissions.