

**Union Crossing**  
**303 Credit Union Drive; Isanti, MN 55040**



- 18,750 SF
- Built in 2003
- Zoned B2 Convenience/Strip Center/Retail
- Steel Frame/Masonry Façade
- 10" Clear Height
- 3 Phase power
- Suites available : Suite 6 (1250sf)  
Suite 8 (1313sf)  
Suite 9 & 10 (3532sf)
- 87 parking spaces
- 1-3 yr. terms  
(depending on Tenant Improvements)
- 2025 Taxes \$1.16
- 2025 CAM \$3.71
- \$8-\$11 psf NNN

**Contact:**

**Nik Anderson**  
COMMERCIAL AGENT

651.497.7222 direct 763.689.0349 office 763.552.5754 fax  
[Nik@ricproperty.com](mailto:Nik@ricproperty.com)

**Contact:**

**Matt Anderson**  
COMMERCIAL BROKER

612.327.2977 direct 763.689.0349 office 763.552.5754 fax  
[Matt@ricproperty.com](mailto:Matt@ricproperty.com)

## Local Retail



McDonalds  
Coborn's  
Wintergreen Golf & Grill  
Subway  
Allina Health Clinic  
O'Reilly Auto Parts

Minnco Credit Union  
Kwik Trip  
Best Western Plus  
Snap  
Greater Midwest Realty  
Compass Daycare

Contact:

**Nik Anderson**  
COMMERCIAL AGENT

651.497.7222 direct 763.689.0349 office 763.552.5754 fax  
[Nik@ricproperty.com](mailto:Nik@ricproperty.com)

Contact:

**Matt Anderson**  
COMMERCIAL BROKER

612.327.2977 direct 763.689.0349 office 763.552.5754 fax  
[Matt@ricproperty.com](mailto:Matt@ricproperty.com)

## Floor Plans

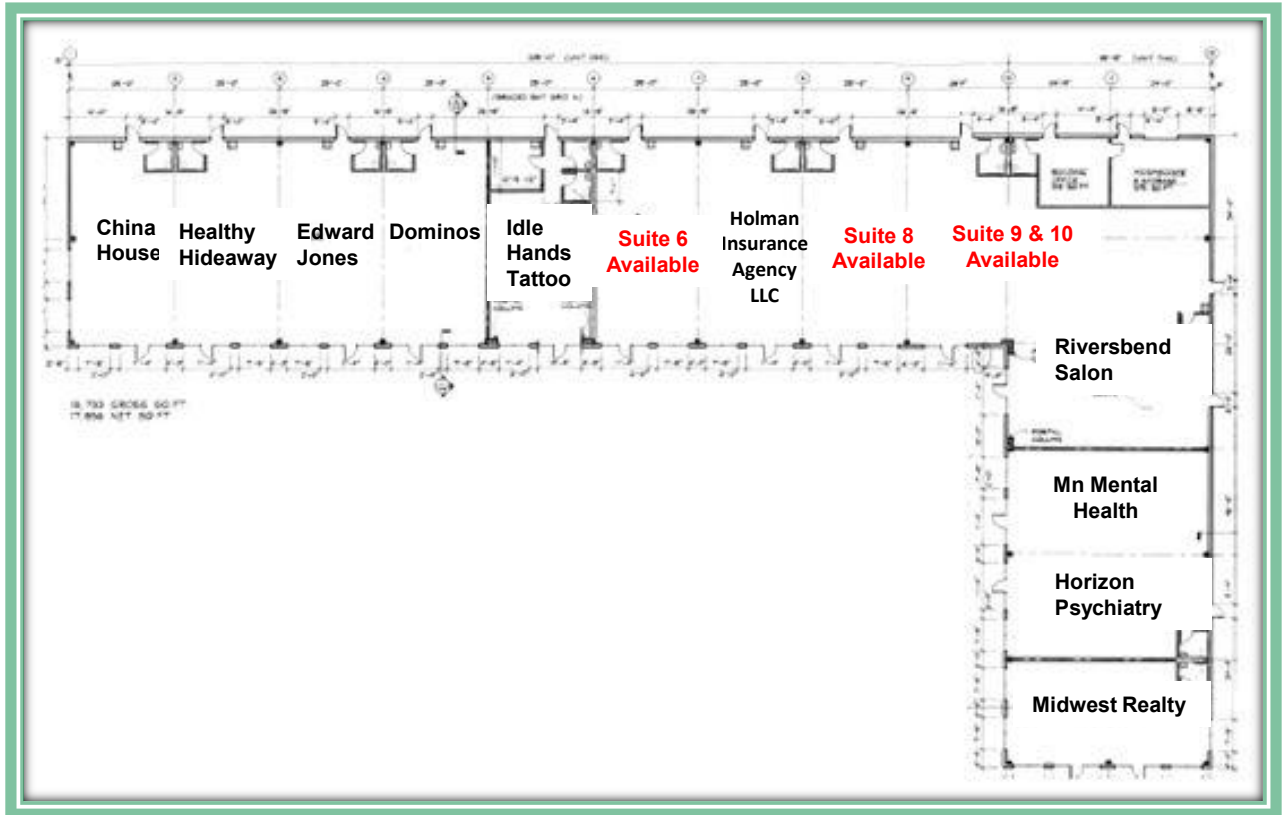

Contact:

**Nik Anderson**  
COMMERCIAL AGENT

651.497.7222 direct 763.689.0349 office 763.552.5754 fax  
[Nik@ricproperty.com](mailto:Nik@ricproperty.com)

Contact:

**Matt Anderson**  
COMMERCIAL BROKER

612.327.2977 direct 763.689.0349 office 763.552.5754 fax  
[Matt@ricproperty.com](mailto:Matt@ricproperty.com)

## Photos

**Suite 6  
1250 SF**



Contact:

**Nik Anderson**  
COMMERCIAL AGENT

651.497.7222 direct 763.689.0349 office 763.552.5754 fax

[Nik@ricproperty.com](mailto:Nik@ricproperty.com)

Contact:

**Matt Anderson**  
COMMERCIAL BROKER

612.327.2977 direct 763.689.0349 office 763.552.5754 fax

[Matt@ricproperty.com](mailto:Matt@ricproperty.com)

## Photos

**Suite 8**  
**1313 SF**



Contact:

**Nik Anderson**  
COMMERCIAL AGENT

651.497.7222 direct 763.689.0349 office 763.552.5754 fax

[Nik@ricproperty.com](mailto:Nik@ricproperty.com)

Contact:

**Matt Anderson**  
COMMERCIAL BROKER

612.327.2977 direct 763.689.0349 office 763.552.5754 fax

[Matt@ricproperty.com](mailto:Matt@ricproperty.com)

## Photos

### Suite 9&10 3532 SF



Contact:

**Nik Anderson**  
COMMERCIAL AGENT

651.497.7222 direct 763.689.0349 office 763.552.5754 fax

[Nik@ricproperty.com](mailto:Nik@ricproperty.com)

Contact:

**Matt Anderson**  
COMMERCIAL BROKER

612.327.2977 direct 763.689.0349 office 763.552.5754 fax

[Matt@ricproperty.com](mailto:Matt@ricproperty.com)

Although the information contained herein is based upon sources believed to be reasonably reliable, Owner and Broker, on their own behalf of their respective officers, employees, shareholders, partners, directors, members and affiliates, or any other affiliated party, disclaim any responsibility or liability for inaccuracies, representations and warranties (expressed or implied) contained in, or omitted from, this information or any other written or oral communication or information transmitted or made available to the recipient.



**DEMOGRAPHICS**

	<b>3 MILES</b>	<b>5 MILES</b>	<b>10 MILES</b>
<b>POPULATION</b>	<b>9,006</b>	<b>17,866</b>	<b>50,201</b>
<b>MEDIAN HH INCOME</b>	<b>\$73,693</b>	<b>\$73,272</b>	<b>\$76,534</b>

**TRAFFIC COUNTS**

<b>HWY 65 AT COUNTY RD 5</b>	<b>18,900 CARS PER DAY</b>
<b>COUNTY RD 5 AT DUAL BLVD</b>	<b>1050-1550 CARS PER DAY</b>
<b>HWY 65 AT CAJIMA</b>	<b>18,900 CARS PER DAY</b>

Contact:

**Nik Anderson**  
COMMERCIAL AGENT

651.497.7222 direct 763.689.0349 office 763.552.5754 fax

[Nik@ricproperty.com](mailto:Nik@ricproperty.com)

Contact:

**Matt Anderson**  
COMMERCIAL BROKER

612.327.2977 direct 763.689.0349 office 763.552.5754 fax

[Matt@ricproperty.com](mailto:Matt@ricproperty.com)