

# Office Space

## UNIT 302A

**361 SF Total**

DESCRIPTION	Turnkey 3rd Floor updated office space with private office with ocean view.
SIZE	361 SF
BASE RENT	INQUIRE WITH AGENT
CAM	INQUIRE WITH AGENT

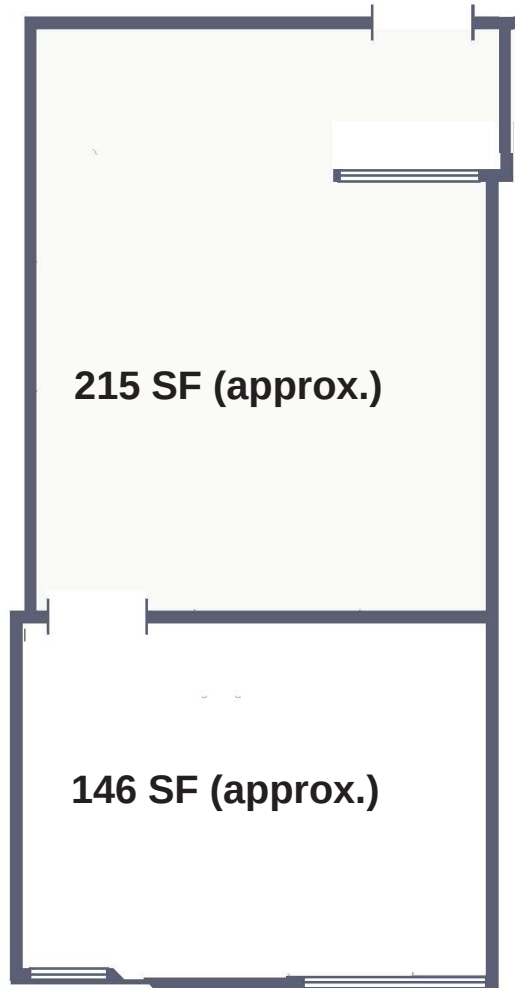

**Peter Grossman**  
 Lic. (RS) 68843  
 peter@  
 pacificpropertygrouphawaii.com  
 (808) 282-0086

**Keane Omaye-Backman**  
 Lic. (RS) 76415  
 keane@  
 pacificpropertygrouphawaii.com  
 (808) 292-6861

**Grace Asevedo**  
 Lic. (RS) 88159  
 grace@  
 pacificpropertygrouphawaii.com  
 (225) 333-7965

