



Orchard Bend Shopping Center

11977 St. Charles Rock Rd

Bridgeton, MO 63044

FOR MORE INFORMATION CONTACT:

Burt Follman, SIOR, CPM | Owner/Broker
(314) 614-2688 bfullman@gershmancre.com

5,177 SF RESTAURANT ENDCAP FOR LEASE

- Primest Endcap Restaurant in Northwest St. Louis County Available April 2026
- Anchored by Hobby Lobby, Hibbett Retail, Guitar Center & Beauty Icon
- Less than 1 Mile from DePaul Hospital & Super Walmart Located Across the Street
- Adjacent to I-270 & I-70
- Signalized Access & Excellent Parking
- Fully Sprinklered
- Contact Broker for Lease Rate





Orchard Bend Shopping Center



Monument Signage Highly Visible From St. Charles Rock Rd/I-70





Orchard Bend Shopping Center

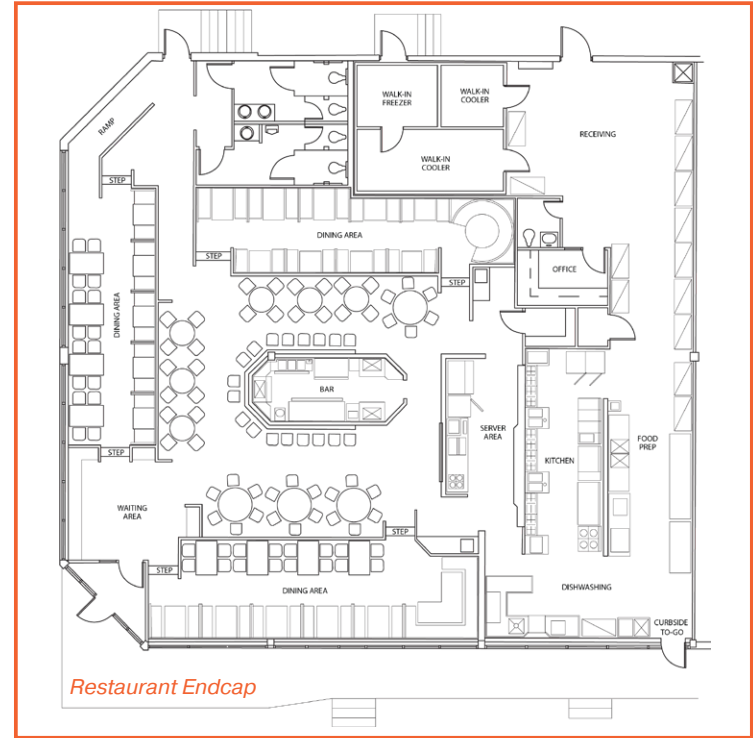
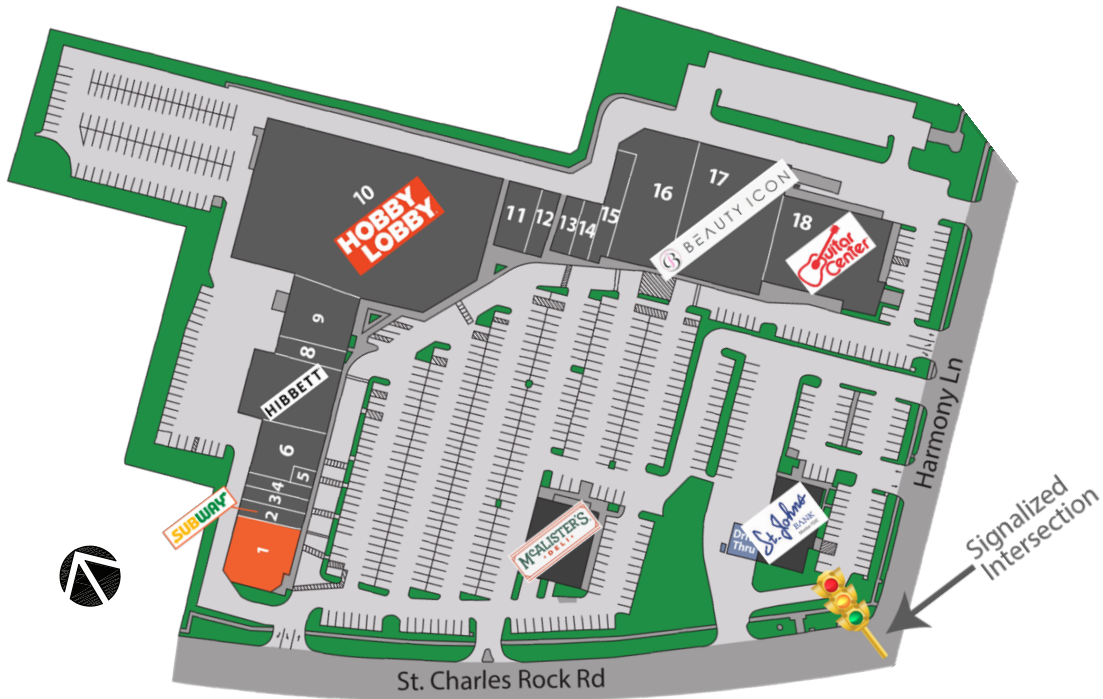

#	Address	Tenant	#	Address	Tenant
1	150	AVAILABLE (5,177 SF)	10	120	Hobby Lobby
2	140	Subway	11	115	15 Brunch Bar
3	135	Envy Salon	12	114	Smart Solutions
4	134	Lavish Salon Suites	13	113	The Brow Bar
5	133	Light & Style	14	111	License Office
6	131-132	Reach Reproductive Health	15	110B	Xplicit Fit
7	130	Hibbet Retail	16	110A	Rockler Woodwork
8	125	Destined Indulgence	17	110	Beauty Icon
9	121-24	The Mary Center	18	100	Guitar Center





Orchard Bend Shopping Center



Traffic Count
155,908 VPD

Traffic Count
158,958 VPD

Orchard Bend Shopping Center
RETAIL SPACES AVAILABLE

2025 Demographics			
	Daytime Population	Number of Households	Average HH Income
1 Mile	13,697	2,618	\$85,841
3 Miles	73,253	19,210	\$72,902
5 Miles	208,655	64,908	\$70,142
7 Miles	388,176	137,917	\$74,427

Traffic Count
43,481 VPD