

THE USE OF THESE PLANS & SPECIFICATIONS SHALL BE RESTRICTED TO CONTRACTED PROJECT FOR WHICH THEY WERE PREPARED AND ALL PRINTS THEREFORE ARE LIMITED TO SUCH USE. RE-USE, PUBLICATION, REPRODUCTION OR COPYING BY MEANS OR METHOD, IN WHOLE OR IN PART, ARE PROHIBITED. TITLE TO THESE PLANS AND SPECIFICATIONS REMAIN WITH THE ARCHITECT, CAARC, INC., WITHOUT PREJUDICE. VISUAL CONTACT WITH THESE PLANS AND SPECIFICATIONS SHALL CONSTITUTE PRIMA FACIE EVIDENCE OF THE ACCEPTANCE OF THE ABOVE RESTRICTIONS.

CAARC, Inc.

4781 REDBLUFF CIRCLE
IRVINE, CALIFORNIA 92604
Tel: (714) 306-1802
Email: nguyenv.k.hiep@att.net

STAMP

05/28/17

ACCIDENTAL REPAIR
**Southern California
Spine & Pain
Institute**
24707 RAILROAD AVENUE
SANTA CLARITA, CA 91321
Tel: (714) 234-5826

REVISIONS

DATE	DESCRIPTION
01/31/17	PLAN COMPLETION

SITE/FLOOR PLAN, FRONT ELEVATION, WALL SECTION & NOTES

Completion Date: January 31, 2017
Issued for Construction: May 28, 2017
Project #: SC - ACC

A-100

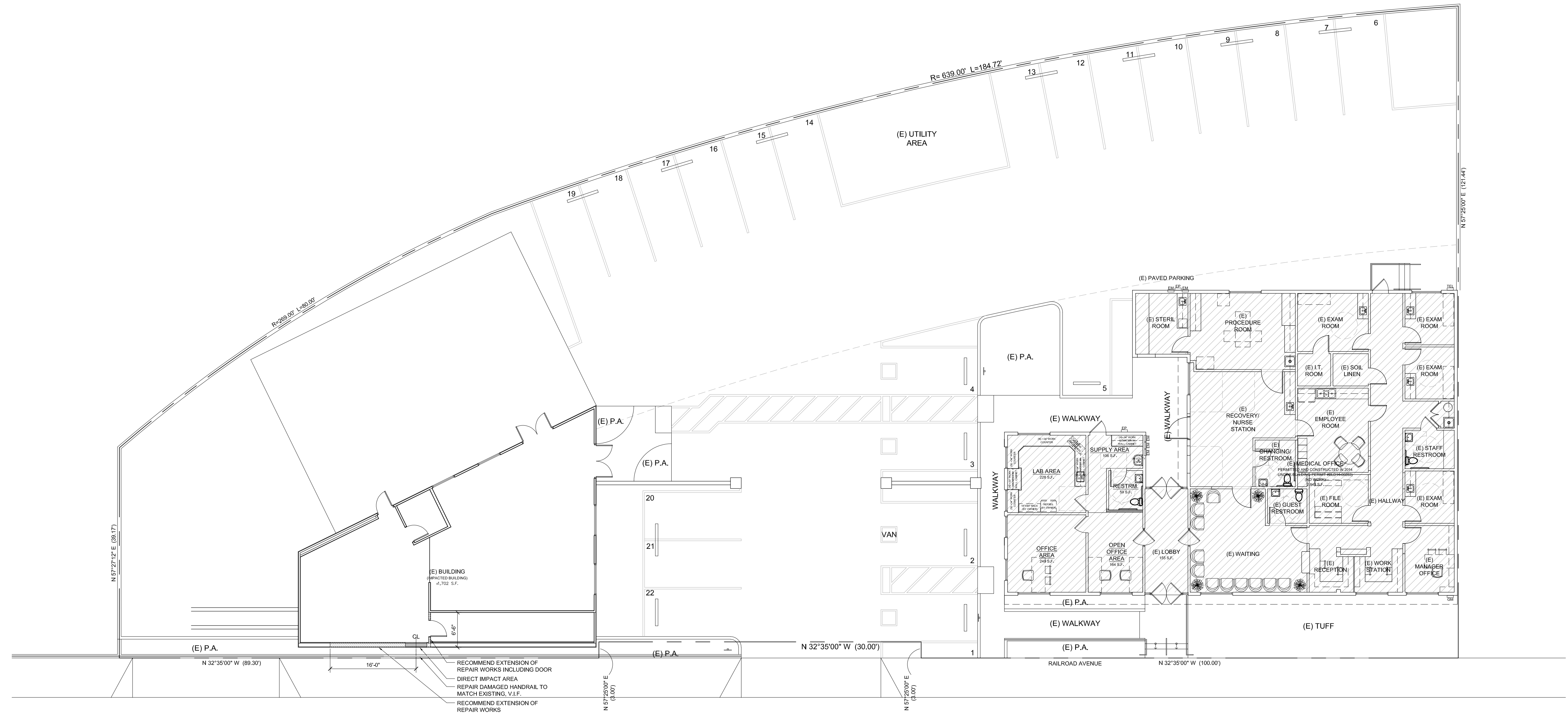

1 SITE / FLOOR PLAN
SCALE: 1/8" = 1'-0"

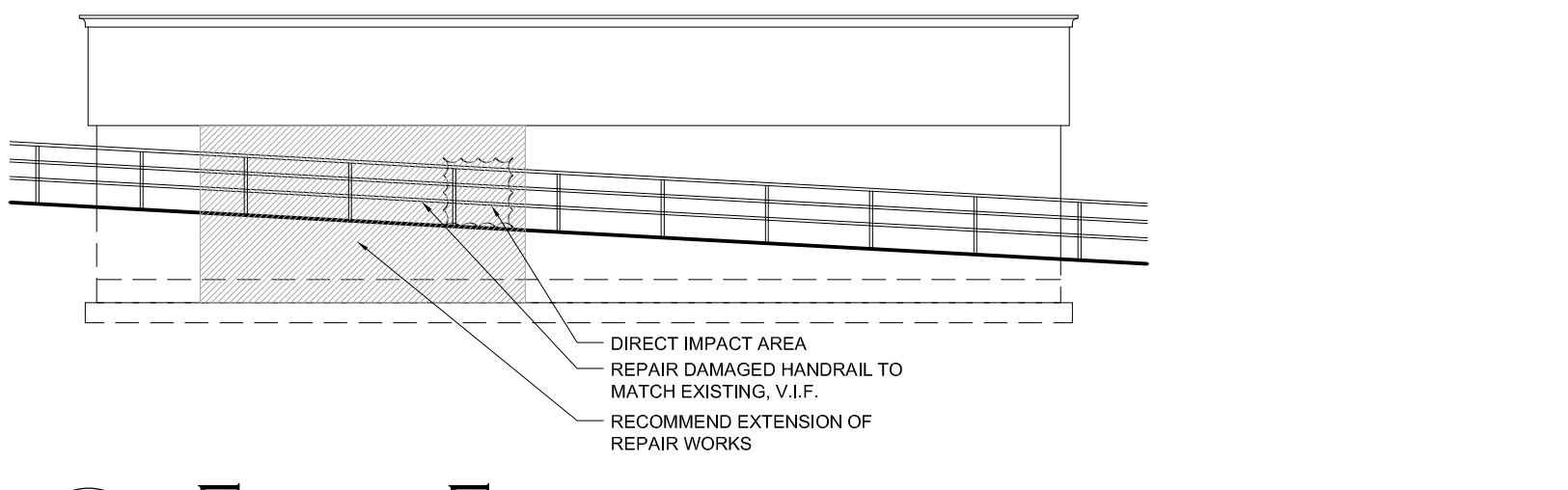

2 FRONT ELEVATION
SCALE: 1/8" = 1'-0"



3 WALL SECTION
SCALE: 1/8" = 1'-0"

FLOOR PLAN GENERAL NOTES:

- INSTALL BLOCKING IN WALLS FOR ALL CASEWORK, SHELVING, COUNTERTOPS, GRAP BARS, PLUMBING ACCESSORIES, AND OWNER SUPPLIED EQUIPMENT.
- COORDINATE WITH OWNER FOR FINAL FINISH AND COLOR SELECTION
- HATCHED AREA SHOWN ARE RECOMMEND REPAIR AREA
- RECOMMEND GC TO DOCUMENT EXISTING EXTERIOR COLOR PAINTS AND TO RE-PAINT ENTIRE EXTERIOR BUILDING TO AVOID COLOR DISCREPANCIES