

Packard Professional Building

41690 Enterprise Circle North
Temecula, CA 92590

OFFICE SUITE FOR LEASE

688± - 806± SF for Lease

Available Immediately

\$1.58 PSF MG Per Month



SUITE 210 FOR LEASE

- 688± SF
- \$1.58 PSF/MG (\$1,087.04/Month)
- Contact Agent for Touring Instructions
- Available Immediately

SUITE 211 FOR LEASE

- 806± SF
- \$1.58 PSF/MG (\$1,273.48/Month)
- Contact Agent for Touring Instructions
- Available Immediately

SUITE 214 FOR LEASE

- 690± SF
- \$1.58 PSF/MG (\$1,090.20/Month)
- Reception and 2 Offices
- Contact Agent for Touring Instructions
- Available Immediately

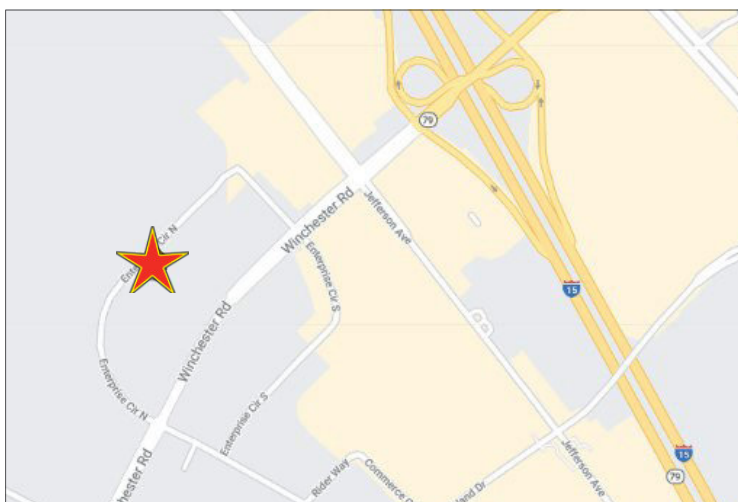

Luanne Palmer

Vice President

CA License # 01444893

(951) 491-6321

lpalmer@westmarcre.com



The above information, while not guaranteed, has been secured from sources we believe to be reliable.
Floor plan, site plan, price, tenant mix, and availability subject to change without notice.

SECOND FLOOR

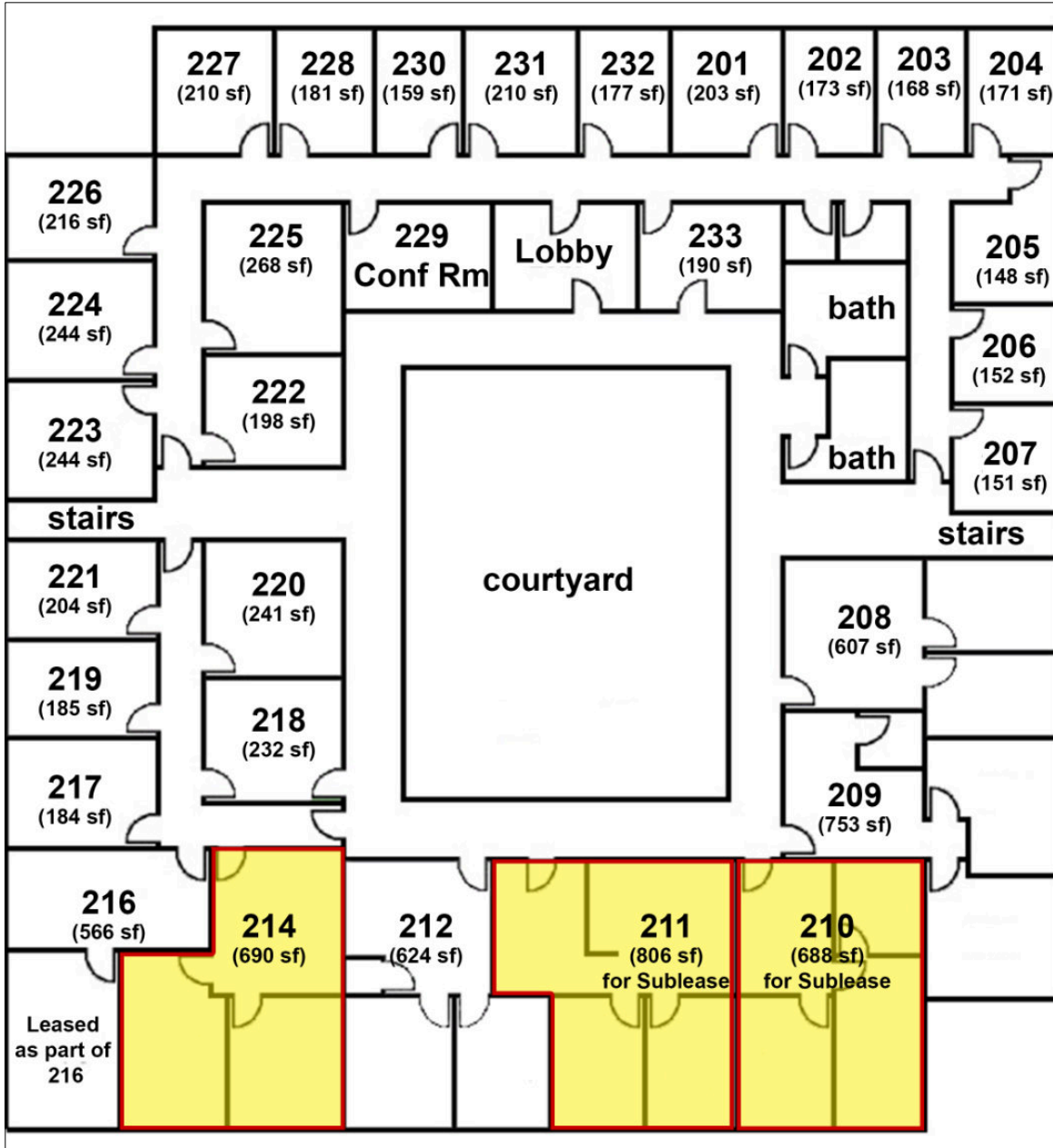

2nd Floor Office

Suite	SF	Description	Lease Rate (MG)	Monthly Rate
210	688±	Available	\$1.58	\$1,087.04
211	806±	Available	\$1.58	\$1,273.48
214	690±	Available - Reception and 2 Offices	\$1.58	\$1,090.20