

NOTES:  
 1) ALL DOORS 3'-0" UNLESS OTHERWISE NOTED.  
 2) DIMENSIONS ARE FOR INTERIOR REFERENCE ONLY, AND DO NOT REFLECT TOTAL SUITE SQUARE FOOTAGE.

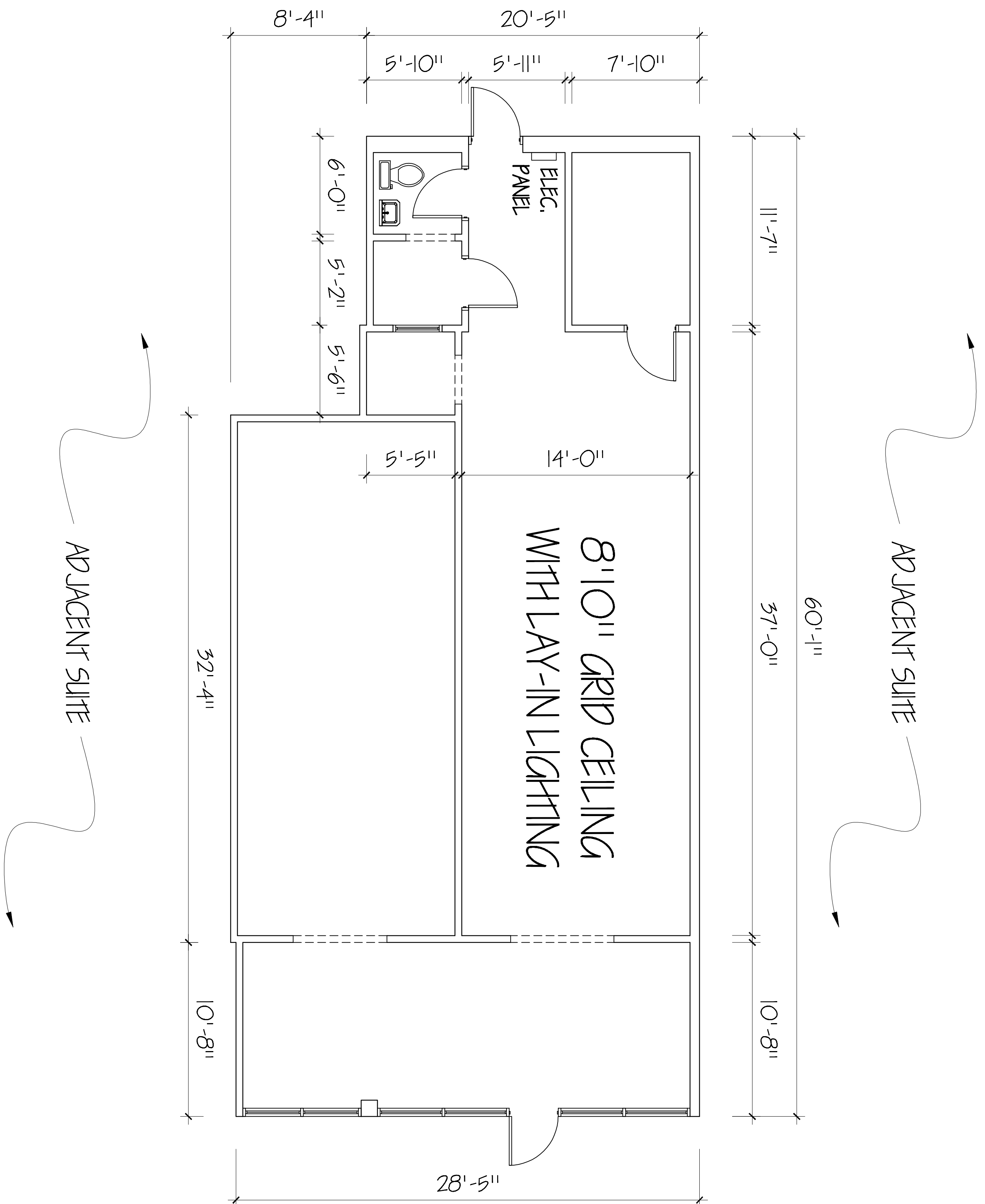

1,600 S.F.

1" = 1' SHEET <b>A-1</b> SHEETS 1	DRAWN <b>M.W. ALLEN</b>
	DATE <b>6/12/2008</b>
	JOB NO. <b>MIMMS DESIGN</b>

<b>SPACE PLAN</b>
SCALE <b>AS SHOWN</b>

**NORSIDE VILLAGE  
 425 SIGMAN ROAD  
 SUITE 120  
 CONYERS, GA 30012**

**MALON D MIMMS CO.  
 85-A MILL ST.  
 ROSWELL, GA 30075  
 770-518-1100**

