

For Sale

4205

4205 EDGEWATER DRIVE
ORLANDO | 32804

OFFICE SPACE IN COLLEGE PARK





**PURCHASE
PRICE
REDUCTION:
\$1,099,000**

PROPERTY INFORMATION:



- 3,224 SF ONE-STORY, OFFICE BUILDING



- 0.24 AC



- ZONING: C-1 COMMERCIAL

- CONCRETE BLOCK MASONRY

- BUILT: 1966

- FAR: 0.41

- PARKING: 16 SURFACE SPACES

- FRONTAGE: 77' ON EDGEWATER DRIVE

- SIGNAGE



- REAR FENCED COURTYARD AREA





FLOOR PLAN

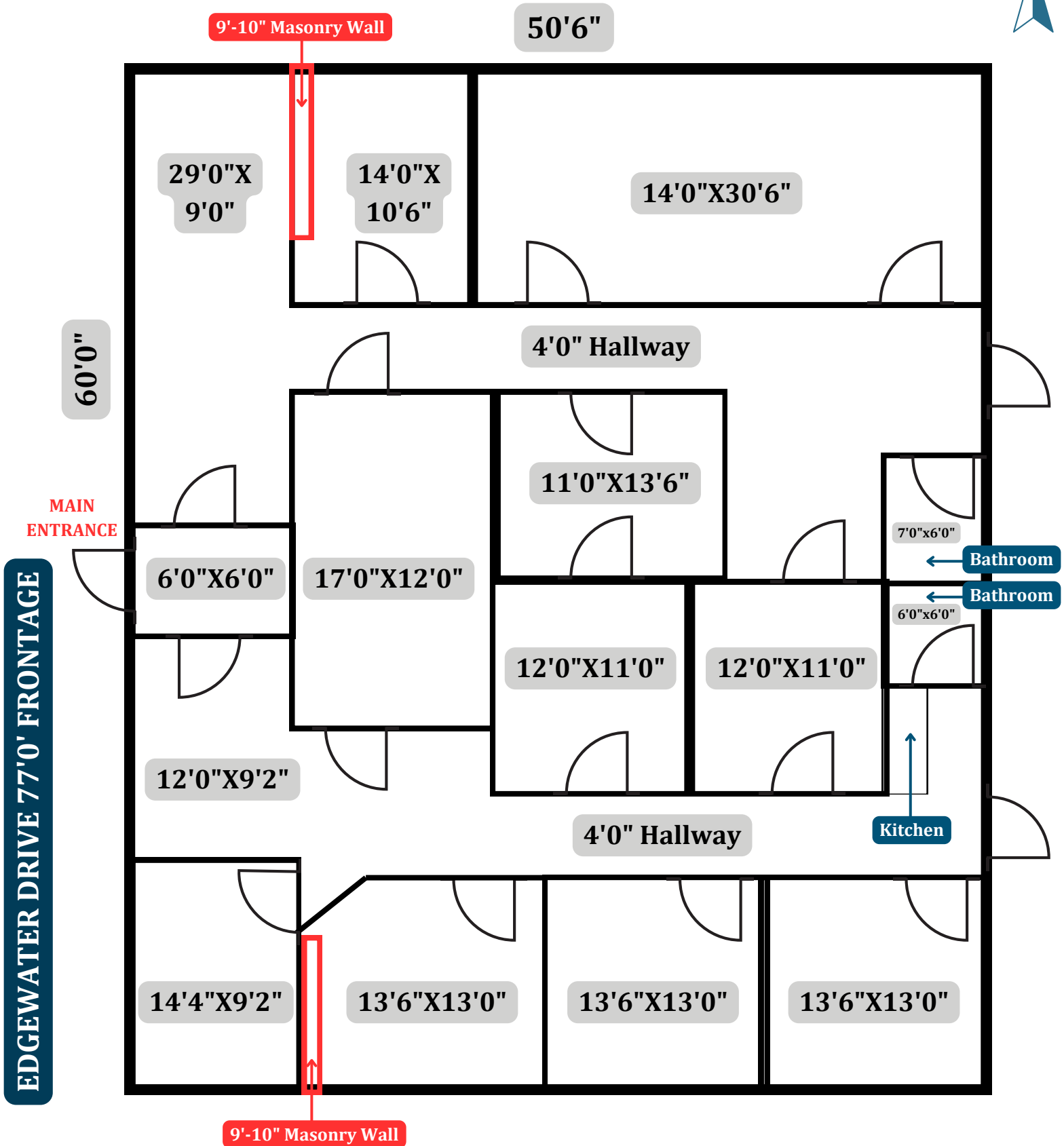

32804



SUBJECT PROPERTY



**LESS THAN 10
MINUTE DRIVE
TO WINTER PARK** →

- **MORNING STAR SCHOOL**
- **ST. CHARLES CATHOLIC SCHOOL**
- **BISHOP MOORE CATHOLIC HIGH SCHOOL**

**FIRST FLORIDA
CREDIT UNION**

**COLLEGE PARK
MIDDLE SCHOOL**

CVS

DUBSDREAD GOLF COURSE

**COLLEGE PARK ACE
HARDWARE**

APENBERRY'S GARDENS

EDGEWATER HIGH SCHOOL

WALGREENS

GABIEL'S SUBS

DUNKIN'

PAPA JOHNS PIZZA

BANK OF AMERICA

EINSTEIN BROS BAGELS

REGIONS BANK

**LAKE SILVER
ELEMENTARY SCHOOL**

**THE WELLESLEY
CONDOMINIUM HOMES**

**ADVENTHEALTH
ORLANDO**

**PUBLIX
SUPERMARKET AT
THE GROVES AT
COLLEGE PARK**

**PUBLIX SUPERMARKET
AT COLLEGE PARK**

**10 MINUTE DRIVE
TO DOWNTOWN
ORLANDO/CBD**





College Park is a lively neighborhood near downtown Orlando, offering urban living with a small-town atmosphere. It features local retailers, award-winning restaurants, and small businesses, along with bungalow-style homes, tree-lined streets, and numerous parks and lakes, creating a vibrant and comfortable lifestyle for residents.

3 MILE DEMOGRAPHICS



POPULATION
86,780



2024 HOUSEHOLDS
39,072



AVG HH INCOME
\$92,172



MEDIAN AGE
38.6



— 4205 EDGEWATER DRIVE —

EXCLUSIVELY LISTED BY:
BISHOP WOOD PARTNERS



FOR NEXT STEPS:

COLTON BISHOP

Associate

Colton@BishopWoodPartners.com

Mobile: 407.404.0175

BILLY BISHOP

Principal

Billy@BishopWoodPartners.com

Mobile: 407.468.6507

KYLE WOOD

Principal

Kyle@BishopWoodPartners.com

Mobile: 386.314.7547



**PURCHASE
PRICE
REDUCTION:
\$1,099,000**

Although information has been obtained from sources deemed reliable, neither Owner nor Bishop Wood Partners, LLC makes any guarantees, warranties or representations, express or implied, as to the completeness or accuracy as to the information contained herein. Any projections, opinions, assumptions or estimates used are for example only. There may be differences between projected and actual results, and those differences may be material. The Property may be withdrawn without notice. Neither Owner nor Bishop Wood Partners, LLC accepts any liability for any loss or damage suffered by any party resulting from reliance on this information. If the recipient of this information has signed a confidentiality agreement regarding this matter, this information is subject to the terms of that agreement. ©2025 Bishop Wood Partners, LLC. All rights reserved.