

WALL LEGEND

- PRECAST PANELS WALL
- INTERIOR PARTITION
- 2 HR FIRE RATE INTERIOR PARTITION

EXIT SIGNAL w/ BATTERY BACK UP (SEE ELECT. DRAWINGS)

Self-contained emergency lighting unit, wall, 90 min battery back-up

FIRE EXTINGUISHER ABC

PROJECT NOTES

- N-01. All dimensions to be field verified by contractor.
- N-02. All door dimensions shown to be verified by GC. Refer to schedule for door size and type.
- N-03. All ADA clearances to be verified and altered to by GC.
- N-04. Threshold shall have 1/2" beveled maximum HT. at main accessible entrance door
- N-05. Provide sign posted on top of door w/ Maximum permitted occupancy to remain within 5 feet of the front door.
- N-06. Provide Address building number according NFPA 102.1 thru 102.1.3
- N-07. Steel stud supporting hung plumbing fixtures shall be double and or no less than 20 gauge.
- N-08. All glass windows/doors to receive impact resistant glass and to comply w/energy calculation.
- N-09. Glass to be safety glass cat-II

Building #3 | Ground Floor
Scale: 3/16" = 1'-0"

REVISIONS	Issue	Issue date / For

PROJECT NO.	
DATE	12/22/2020

PROJECT ADDRESS
221 NE 67 ST MIAMI FL 33138

FOLIO: 01-3218-020-0020
01-3218-020-0031
01-3218-020-0040

PROJECT NAME:
NEW WAREHOUSES CONDOMINIUM

SHEET TITLE
GROUND FLOOR PLAN BUILDING #3

CONSULTANTS:

ALL DOCUMENTS, DESIGNS, SCHEDULES, SPECIFICATIONS AND DETAILS INDICATED OR REPRESENTED BY THESE DRAWINGS ARE AND SHALL REMAIN THE PROPERTY OF CARMEN T DIAZ ARCHITECT. THESE DRAWINGS ARE FOR THE USE ON AND IN CONNECTION WITH THE SPECIFIED PROJECT. THE OWNER AND/OR TENANT SHALL ONLY BE PERMITTED TO RETAIN COPIES OF THESE DRAWINGS FOR INFORMATION AND REFERENCE AND SHALL NOT BE USED OR REPRODUCED WHOLE OR IN PART WITH-OUT WRITTEN AGREEMENT OR BE LIABLE FOR THE FULLEST LEGAL RECOURSE



CARMEN T DIAZ, ARCH.
Florida Registration No.: AR96290
1901 NW South River Dr, Suite 30, Miami, FL 33125
www.ctdarch.com
email: ctd.architect@gmail.com | ph: 786-312-6000
Project manager: Pedro Azcon
786 333 5366

SEAL:	DATE:
	12/22/2020
	SHEET
	AC-1.0

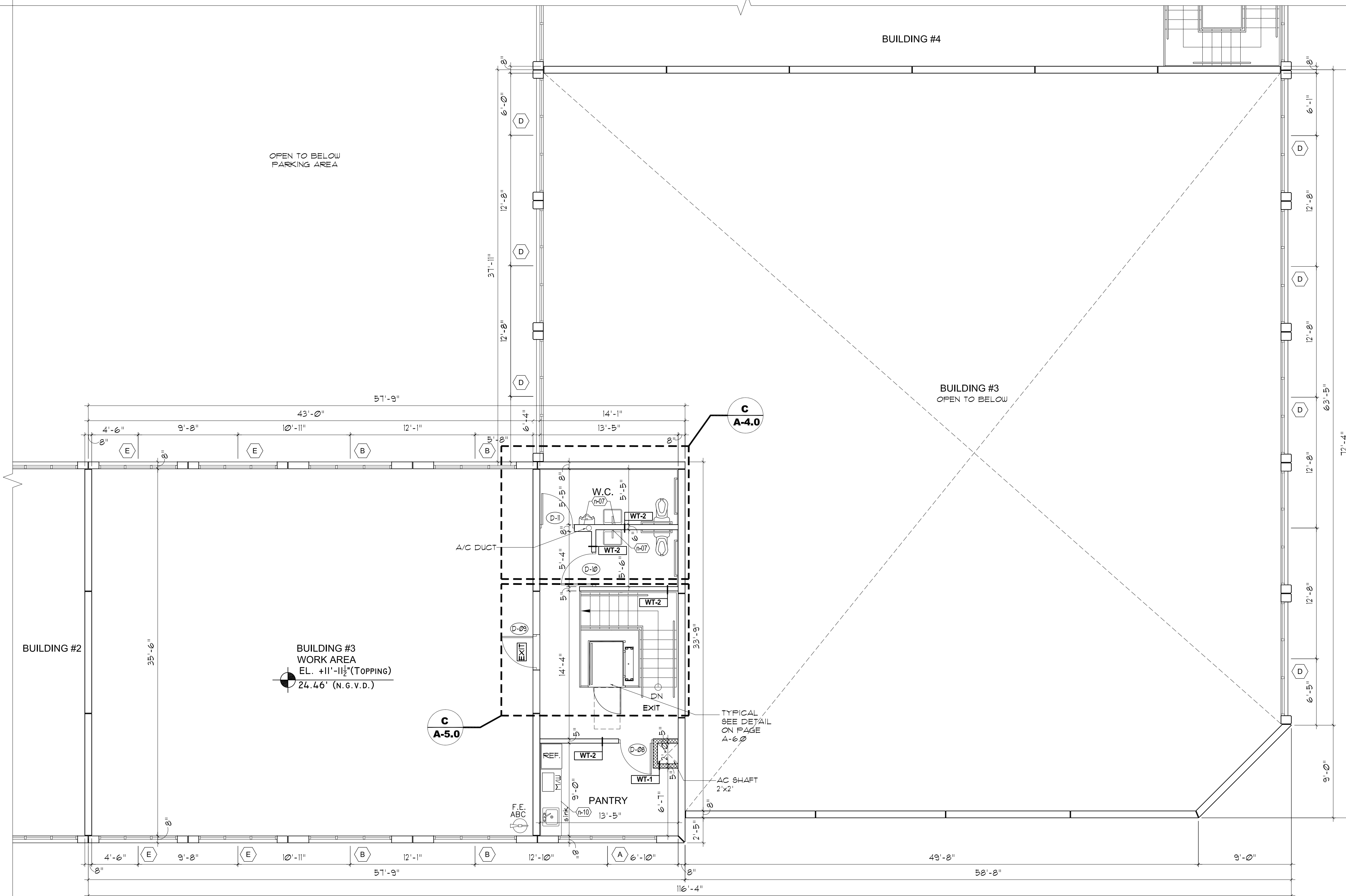

WALL LEGEND

- PRECAST WALL
- INTERIOR PARTITION
- 2 HR FIRE RATE INTERIOR PARTITION

EXIT EXIT SIGNAL w/ BATTERY BACK UP (SEE ELECT. DRAWINGS)

Self-contained emergency lighting unit, wall, 30 min battery back-up

ABC F.E. FIRE EXTINGUISHER

PROJECT NOTES

- N-01. All dimensions to be field verified by contractor.
- N-02. All door dimensions shown to be verified by GC. Refer to schedule for door size and type.
- N-03. All ADA clearances to be verified and adhered to by GC.
- N-04. Step shall have 1/2" beveled maximum HT.
- N-05. Provide sign posted on top of door w/ Maximum permitted occupancy to remain within 5 feet of the front door.
- N-06. Provide Address building number according N.F.P.A 10.12.1 thru 10.12.13
- N-07. Steel stud supporting hung plumbing fixtures shall be double and of no less than 20 gauge.
- N-08. All glass windows/doors to receive impact resistant glass and to comply w/energy calculation.
- N-09. Glass to be safety glass cat-II
- N-10. Counter top 36" Ht.

Building #3 | Mezzanine
Scale: 3/16" = 1'-0"

Issue	Issue date / For

PROJECT NO. _____
DATE: 12/22/2020

PROJECT ADDRESS
221 NE 67 ST MIAMI FL 33138

FOLIO: 01-3218-020-0020
01-3218-020-0031
01-3218-020-0040

PROJECT NAME:
NEW WAREHOUSES CONDOMINIUM

SHEET TITLE
MEZZANINE FLOOR PLAN BUILDING #3

CONSULTANTS:

ALL DOCUMENTS, DESIGNS, SCHEDULES, SPECIFICATIONS AND DETAILS INDICATED OR REPRESENTED BY THESE DRAWINGS ARE AND SHALL REMAIN THE PROPERTY OF CARMEN T DIAZ ARCHITECT. THESE DRAWINGS ARE FOR THE USE ON AND IN CONNECTION WITH THE SPECIFIED PROJECT. THE OWNER AND/OR TENANT SHALL ONLY BE PERMITTED TO RETAIN COPIES OF THESE DRAWINGS FOR INFORMATION AND REFERENCE AND SHALL NOT BE USED OR REPRODUCED WHOLE OR IN PART WITH-OUT WRITTEN AGREEMENT OR BE LIABLE FOR THE FULLEST LEGAL RECOURSE.



CARMEN T DIAZ, ARCH.
Florida Registration No.: AR96290
1901 NW South River Dr, Suite 30, Miami, FL 33125
www.ctdarchitect.com
email: ctd.architect@gmail.com | ph: 786-312-6000
Project manager: Pedro Achon
786 333 5066

SEAL: _____ DATE: 12/22/2020

SHEET: _____

AC-1.1