

FOR LEASE – CORKTOWN RETAIL SPACE

PREMIER FIRST FLOOR RETAIL OPPORTUNITY



2050 8th ST | DETROIT, MI



2050 8th ST
4,047 SF AVAILABLE

MGM GRAND
DETROIT

THE GODFREY
HAMILTON'S

Nemo's

OTTAVA VIA

McShane's

ALAN STERN
SENIOR VICE PRESIDENT | BROKERAGE SERVICES
P: 248.848.4119 E: ALAN.STERN@FREG.COM

ANDREW J. BOWER
VICE PRESIDENT | ADVISORY & BROKERAGE SERVICES
P: 248.848.4193 E: ANDREW.BOWER@FREG.COM

ELTON PARK RETAIL SPACE

PROPERTY HIGHLIGHTS

- Up to 4,097 SF of 1st Floor Retail Space Available
- Elton Park Corktown features 151 residential units across five blocks and six buildings
- Ideal for food and beverage operator with in-place ventilation and gated, shared resident/employee parking
- Close proximity to Ford's Michigan Central (5,000 Employees), The Godfrey Hotel, and Perennial Corktown
- Nearby Tenants include Hamilton's, Memento Gelato, Ottava Via, McShane's Irish Pub, Ima, Slows BBQ, Corktown Taphouse, and many others
- Lease Rate: Contact Broker

eCode	184
Available SF	4,047 SF
Property Type	Retail
City	Detroit
Lease Rate	Contact Broker

The information provided herein along with any images or attachment(s) was obtained from sources believed to be reliable, however, Friedman Real Estate makes no guarantees, warranties, or representations as to the completeness or accuracy of such information and legal counsel is advised. All information provided is subject to verification and no liability for reliance on such information or errors or omissions is assumed. The presentation of this property is submitted subject to errors, omissions, change of price or conditions, prior sale or lease, or withdrawal without notice. Copyright © 2026 Friedman Real Estate. All rights reserved.



PROPERTY HIGHLIGHTS

SITE OVERVIEW



The Corner Ballpark

THE CORNER MICHIGAN CHASE

Memento

McShane's

OTTAWA VIA

Nemo's

THE GODFREY HAMILTON'S

Citizens Bank

Subway

MICHIGAN AVE

PERENNIAL CORKTOWN

Firestone COMPLETE AUTO CARE



2050 8TH ST

NEARBY AMENITIES



Matar City
CASINO-HOTEL

CT
CASS TECHNICAL
HIGH SCHOOL

MGM GRAND
DETROIT

The Corner Ballpark

2050 8TH ST
4,047 SF AVAILABLE

±14,907
Vehicles Per Day

OTAVA VIA
Momento
McShane's
Nemo's

THE GODFREY
HAMILTON'S

MICHIGAN CENTRAL

TRUMBULL & PORTER
— AN AUTHENTIC DETROIT HOTEL —

ima IZAKAYA
Sugar House
SLOWS

ELTON PARK RETAIL SPACE

AREA AMENITIES



FOOD & DRINK

Bobcat Bonnie's
Cork & Gable
Folk Detroit
Hamilton's
James Oliver
McShane's
Mercury Bar
Michigan & Trumbull
Mink Detroit
Mudgie's Deli
Ottava Via
Johnny Noodle King
PJ's Lager House
Slows Bar BQ
Takoi
The Brooklyn Street Local
The Pink Flamingo
Two James Distillery



SHOPPING & ENTERTAINMENT

All Things Marketplace
Detroit Dye House
Detroit Wick
Eldorado General Store
Good Stuff Corktown
Mama Coo's Boutique
Of What Dreams Are Made
Teezonus



FITNESS & RECREATION

Detroit Meditation & Yoga
MGM Grand Fitness Center & Pool
Planet Fitness
Roberto Clemente Recreation Center
The Corner Ballpark
True Body Fitness



LODGING

Motor City Casino Hotel
MGM Grand Detroit Hotel
Trumbull and Porter Hotel
The Godfrey Detroit

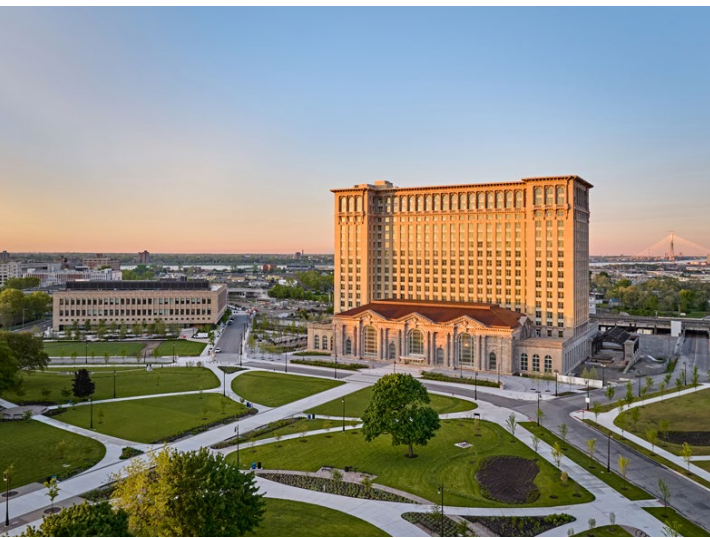

CORKTOWN

Located just west of downtown Detroit, Corktown is the city's oldest current neighborhood, with a rich history and distinct urban character. The area is named after County Cork in Ireland, reflecting the significant influx of Irish immigrants in the mid-19th century. The neighborhood is defined by its historic architecture, including Victorian-style homes, rowhouses, and a variety of commercial buildings.

The neighborhood has undergone significant revitalization and development in recent years, making it one of Detroit's most vibrant areas. Corktown is known for its trendy restaurants, bars, and boutique shops, which attract both locals and tourists alike. Major recent developments include The Godfrey Hotel, The Perennial apartment complex, and the renovation of the historic Michigan Central Station (which is being transformed into a hub for innovation by Ford Motor Company). This development has spurred further investment in the area, creating additional jobs and boosting the local economy.

Corktown's proximity to downtown Detroit provides easy access to major highways such as I-75 and I-96, facilitating travel throughout the metropolitan area. The neighborhood is also accessible by public transportation, with several bus routes running through the area. The Detroit People Mover, an elevated rail system, has a station nearby, connecting Corktown to other parts of the city. Additionally, the Detroit Metropolitan Wayne County Airport, located about 20 miles southwest of the neighborhood, offers extensive domestic and international flight services.

DETROIT DEMOGRAPHICS

ESTIMATED POPULATION (2022)	636,787
HOUSEHOLDS (2022)	243,240
MEDIAN HH INCOME (2022)	\$37,761
POPULATION PER SQUARE MILE (2022)	4,456

2050 8TH STREET
ADDITIONAL PHOTOS



2050 8TH STREET
FLOOR PLAN

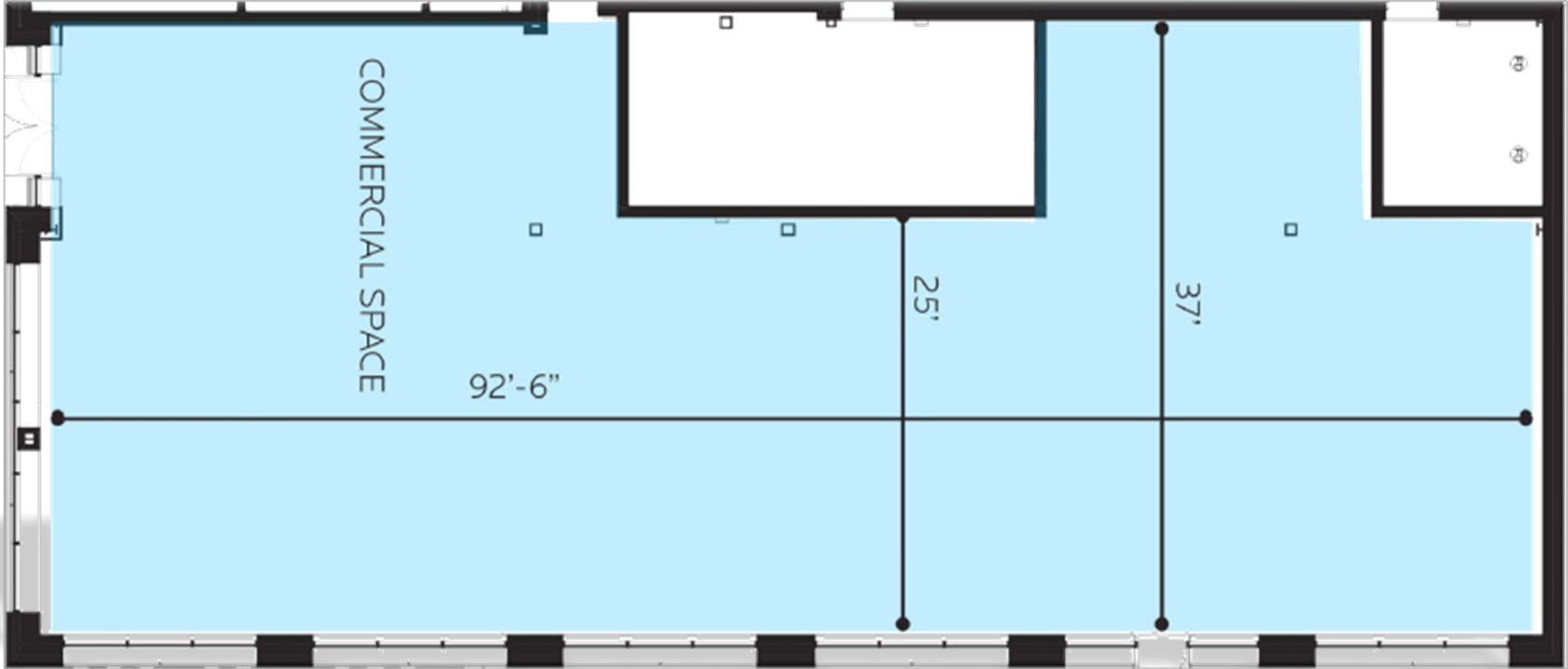

2050 8TH STREET

CREATING
VALUE
BEYOND
REAL
ESTATE



ALAN STERN | SENIOR VICE PRESIDENT | BROKERAGE SERVICES
ANDREW J. BOWER | VICE PRESIDENT | ADVISORY & BROKERAGE SERVICES

FRIEDMAN REAL ESTATE | 34975 W. 12 MILE ROAD | FARMINGTON HILLS, MI 48331 | FRIEDMANREALESTATE.COM

