

1740

MONROVIA

PROPERTY HIGHLIGHTS

1740 Monrovia Avenue is a rare large-block office lease opportunity in the heart of Westside Costa Mesa. Formerly the global headquarters of Volcom (and previously Quiksilver), this iconic 36,000-square-foot creative office building offers an unmatched blend of industrial character and modern functionality. The two-story layout includes an indoor-outdoor kitchen and expansive patio area—perfect for team gatherings, brand activations, or private events. Located in a dynamic and evolving neighborhood known for its surf and streetwear roots, the property places tenants in the center of a cultural hub that's quickly becoming one of Orange County's most exciting creative corridors. This is more than just office space—it's a statement address for forward-thinking companies looking to align with authenticity, innovation, and lifestyle.

±36,000
SQUARE FEET

2
STORIES

4.0/1,000
PARKING RATIO

NOW
AVAILABLE

1987 r. 2010
YEAR BUILT

FOR LEASE
PRICING - CALL





17TH STREET

17TH STREET

MONROVIA AVENUE



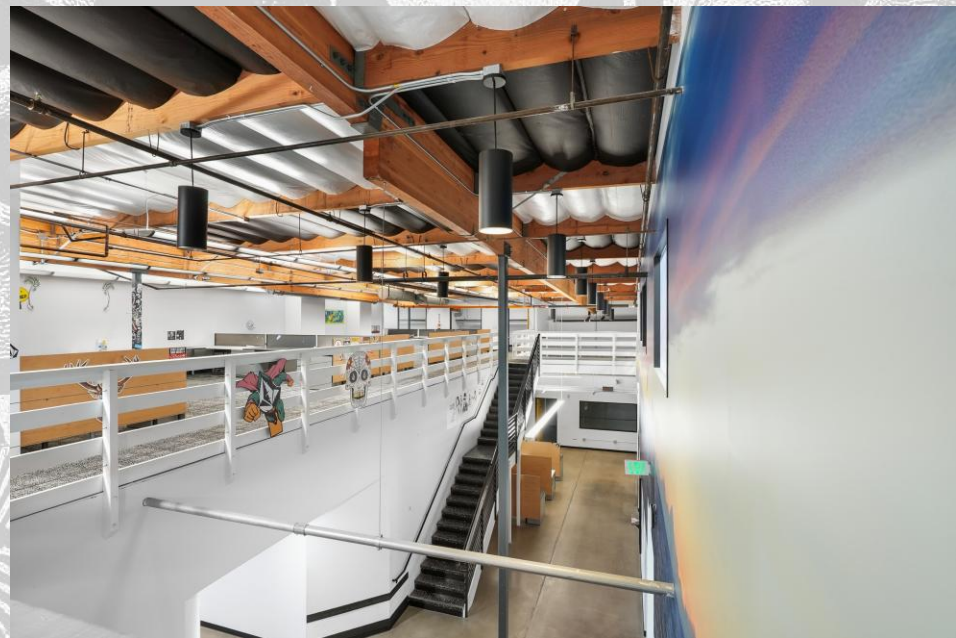
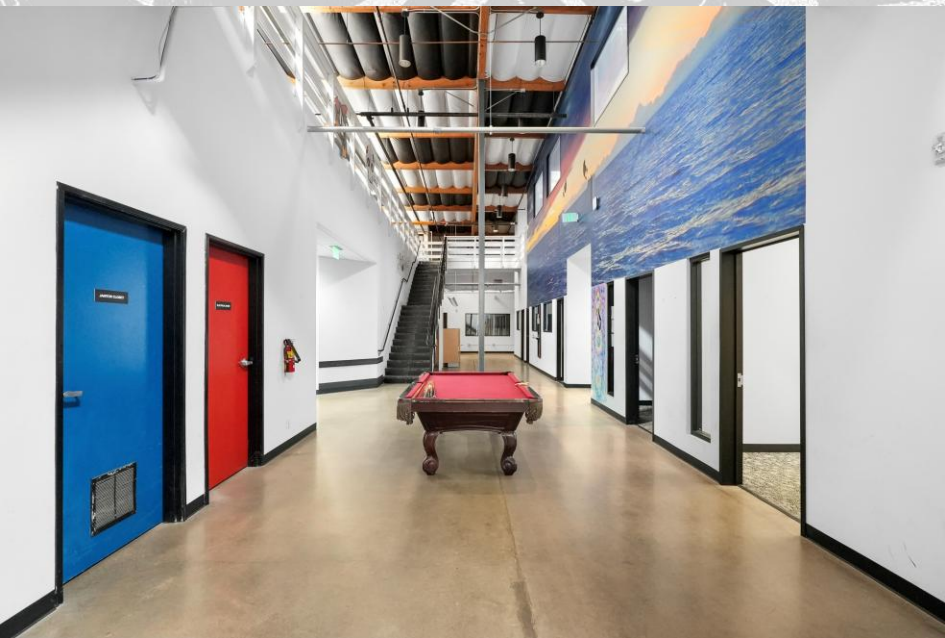

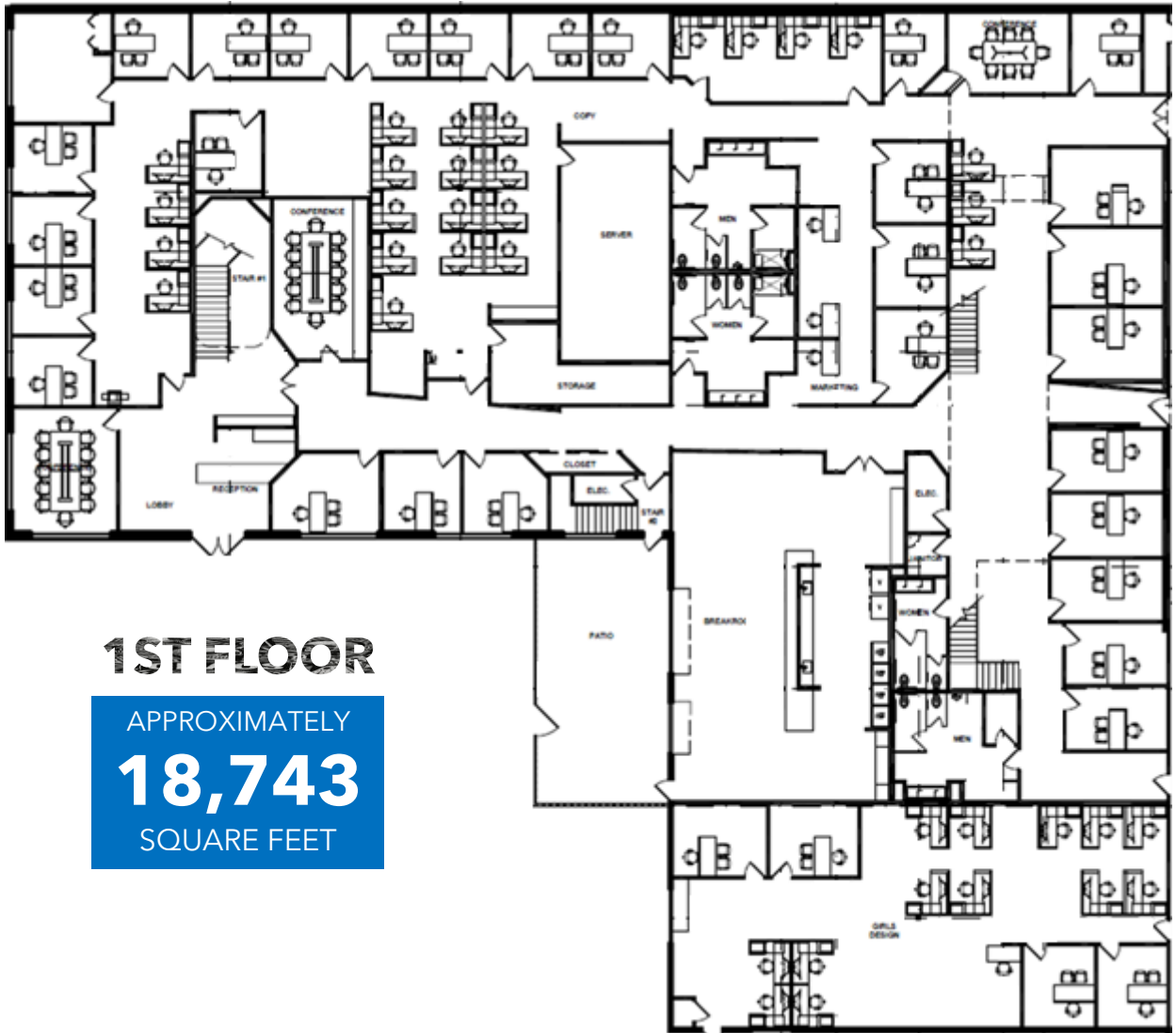

1ST FLOOR

APPROXIMATELY
18,743
SQUARE FEET

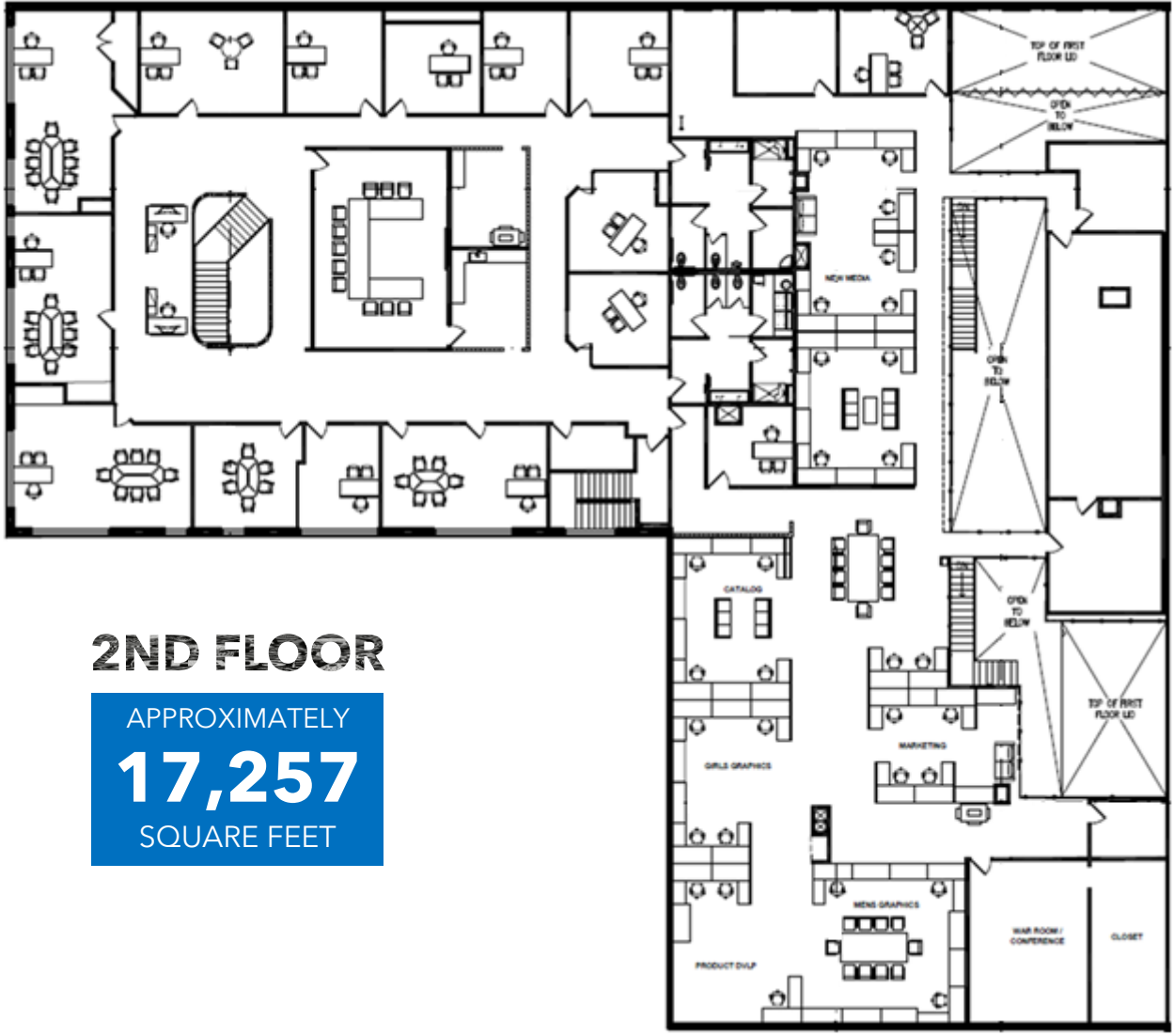

2ND FLOOR

APPROXIMATELY
17,257
SQUARE FEET

MONROVIA AVE

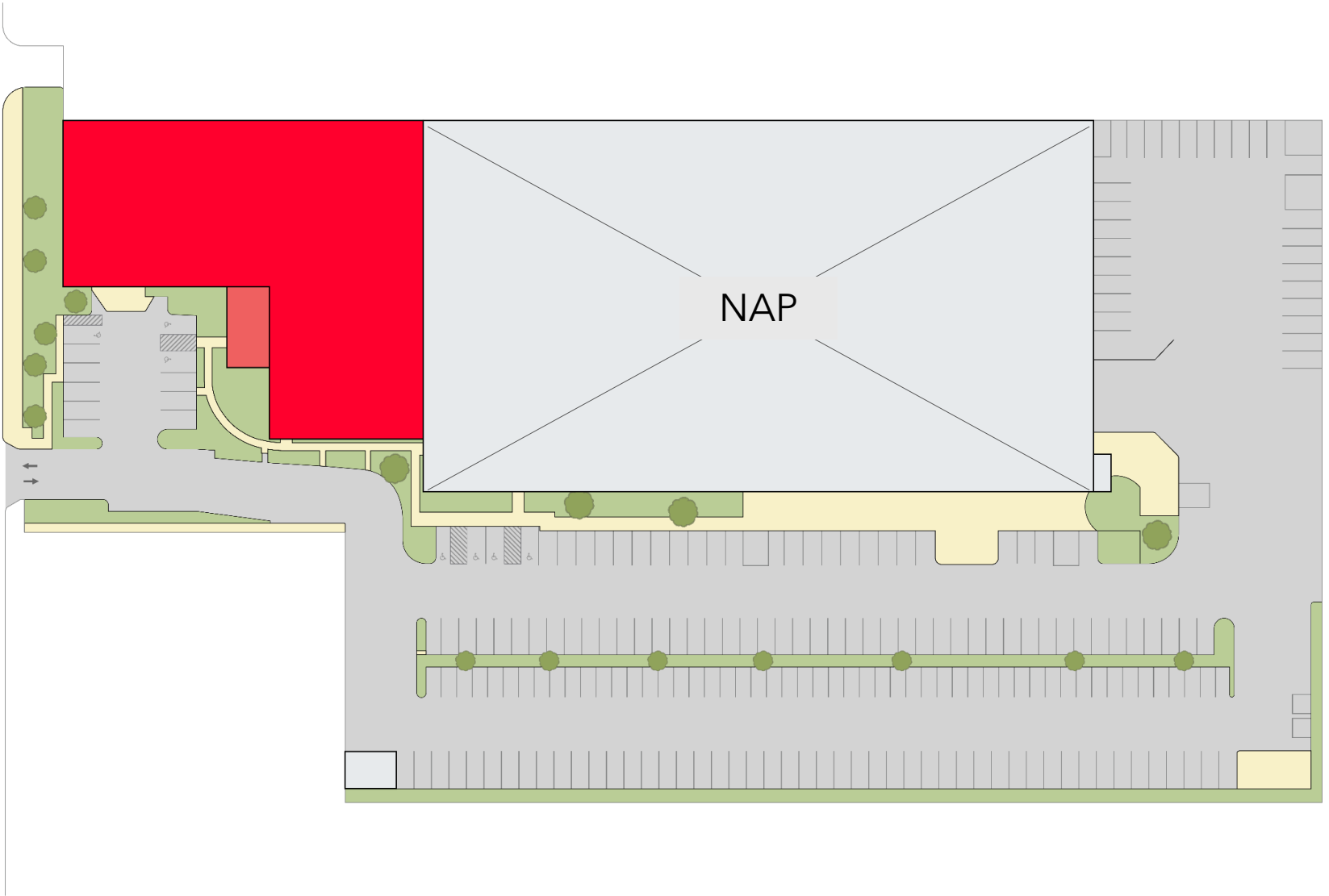

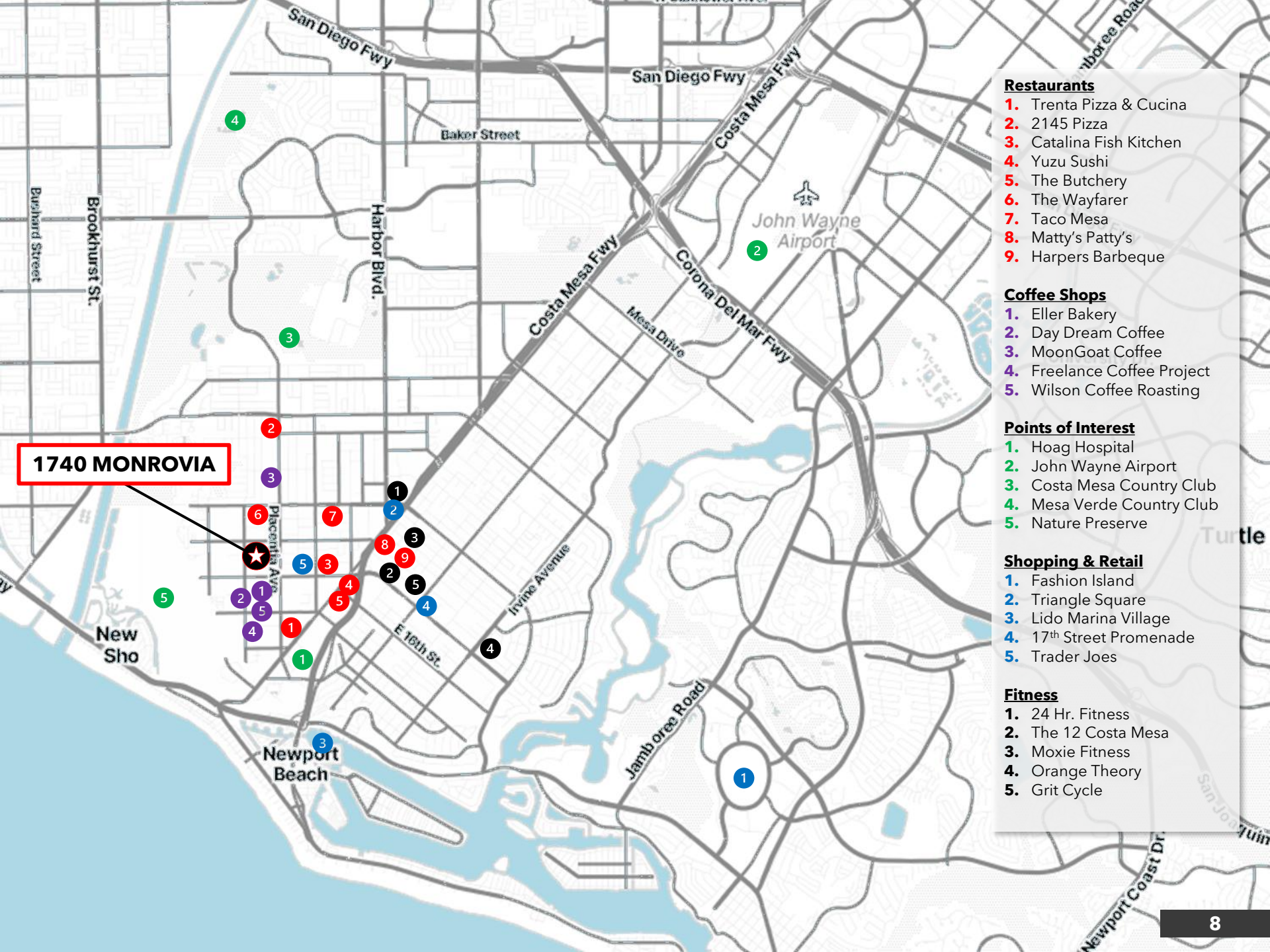

1740 MONROVIA

- Restaurants**
1. Trenta Pizza & Cucina
 2. 2145 Pizza
 3. Catalina Fish Kitchen
 4. Yuzu Sushi
 5. The Butchery
 6. The Wayfarer
 7. Taco Mesa
 8. Matty's Patty's
 9. Harpers Barbeque
- Coffee Shops**
1. Eller Bakery
 2. Day Dream Coffee
 3. MoonGoat Coffee
 4. Freelance Coffee Project
 5. Wilson Coffee Roasting
- Points of Interest**
1. Hoag Hospital
 2. John Wayne Airport
 3. Costa Mesa Country Club
 4. Mesa Verde Country Club
 5. Nature Preserve
- Shopping & Retail**
1. Fashion Island
 2. Triangle Square
 3. Lido Marina Village
 4. 17th Street Promenade
 5. Trader Joes
- Fitness**
1. 24 Hr. Fitness
 2. The 12 Costa Mesa
 3. Moxie Fitness
 4. Orange Theory
 5. Grit Cycle



Freelance Coffee



Day Dream Coffee



The Butchery

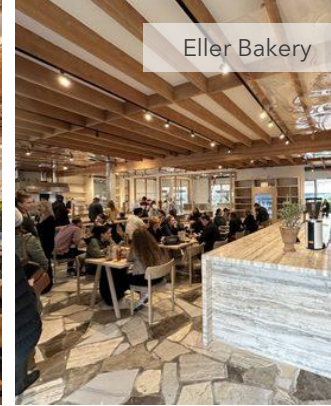

Eller Bakery



Lido Marine Village

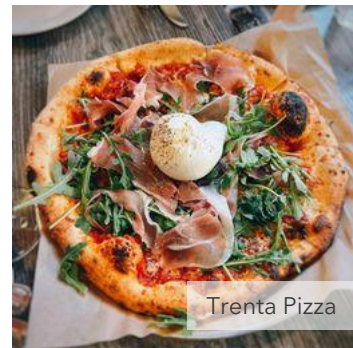

Trenta Pizza

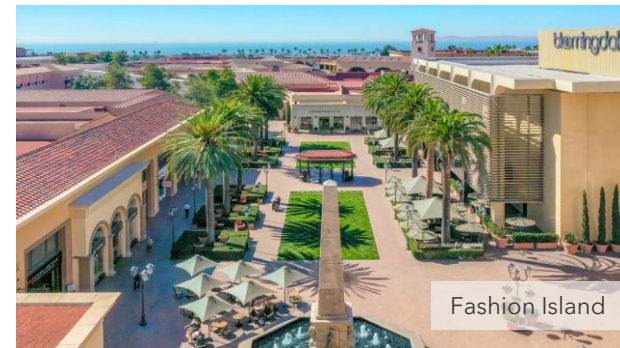

Fashion Island



Triangle Square

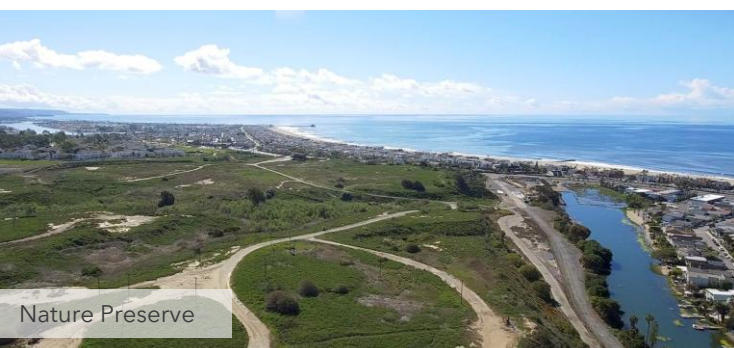

Nature Preserve

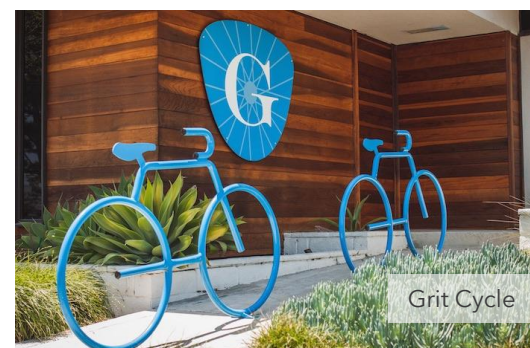

Grit Cycle



Sidecar Donuts



MoonGoat Coffee



Milligram Coffee

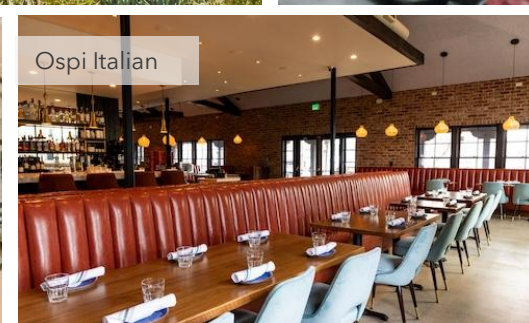

Ospi Italian

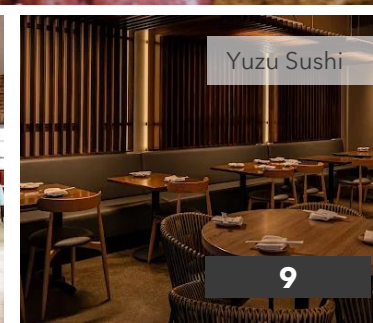

Yuzu Sushi



Robert Hunter
949.689.8199
Robert.Hunter@Elliman.com
DRE#: 02030490



All materials and information received or derived from Douglas Elliman of California (DE) its directors, officers, agents, advisors, affiliates and/or any third party sources are provided without representation or warranty as to completeness, veracity, or accuracy, condition of the property, compliance or lack of compliance with applicable governmental requirements, developability or suitability, financial performance of the property, projected financial performance of the property for any party's intended use or any and all other matters.

Neither DE, its directors, officers, agents, advisors, or affiliates makes any representation or warranty, express or implied, as to accuracy or completeness of the any materials or information provided, derived, or received. Materials and information from any source, whether written or verbal, that may be furnished for review are not a substitute for a party's active conduct of its own due diligence to determine these and other matters of significance to such party. DE will not investigate or verify any such matters or conduct due diligence for a party unless otherwise agreed in writing. EACH PARTY SHALL CONDUCT ITS OWN INDEPENDENT INVESTIGATION AND DUE DILIGENCE.