

Industrial Space For Sublease

265

Castleberry Industrial
Cumming, GA 30040

44,056 SF
LED: June 30, 2032

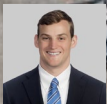

Rhett Delk
rdelk@cresa.com
678.438.0537



Scott Polinski
spolinski@cresa.com
404.748.2633

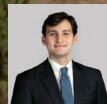

Camden Evans
cevans@cresa.com
404.831.5380

cresa

Property Highlights

- 44,056 SF Space Available
- ± 1,045 SF Office Space
- 2 Dock Highs
- 1 Drive In
- 31' Clear Height
- Built in 2003
- Zoning: M1



Floor Plan

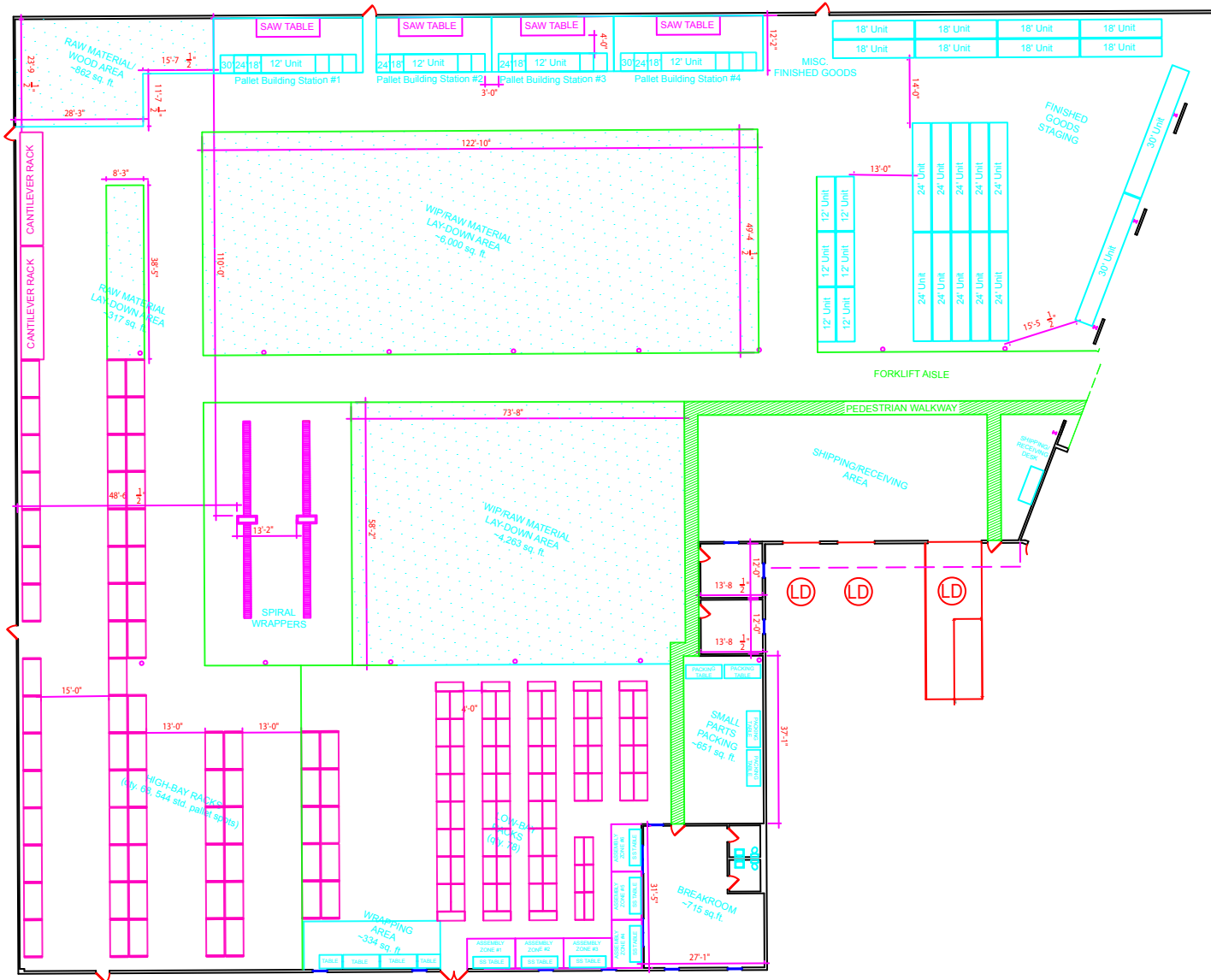



265 Castleberry Industrial Drive

presents a highly functional industrial location in Cumming, GA, within close proximity to GA 400, enabling seamless north-south connectivity across Metro Atlanta.

The property is situated in a rapidly developing industrial submarket characterized by strong tenant demand and ongoing economic growth. Its location provides efficient access to major transportation corridors, supporting streamlined distribution and logistics operations. With a robust surrounding labor force and continued residential expansion in Forsyth County, the property is well-positioned for users requiring both operational efficiency and workforce accessibility.





For More Information



Rhett Delk
rdelk@cresa.com
678.438.0537



Scott Polinski
spolinski@cresa.com
404.748.2633



Camden Evans
cevans@cresa.com
404.831.5380

265

Castleberry Industrial

Cumming, GA 30040



Cresa © 2026. All rights reserved. The information contained in this document has been obtained from sources believed reliable. While Cresa does not doubt its accuracy, Cresa has not verified it and makes no guarantee, warranty, or representation about it. It is your responsibility to independently confirm its accuracy and completeness. Any projections, opinions, assumptions or estimates used are for example only and do not represent the current or future performance of the property. The value of this transaction to you depends on tax and other factors which should be evaluated by your tax, financial and legal advisors. You and your advisors should conduct a careful, independent investigation of the property to determine to your satisfaction the suitability of the property for your needs.

cresa