

DOOR NUMBER	LOCATION	QTY	DOOR				FRAME	HARDWARE SET	FIRE RATING	DOOR FINISH	FRAME FINISH
			SIZE	TYPE	THICKNESS	MATERIAL					
101	RESTROOM	1	3'-0" x 7'-0"	A	1-3/4"	HM	HM	#1	---	PAINT	PAINT
103	STORAGE	2	3'-6" x 7'-3"	B	1-3/4"	HM	HM	#2	1 HR	WOOD VENEER	PAINT

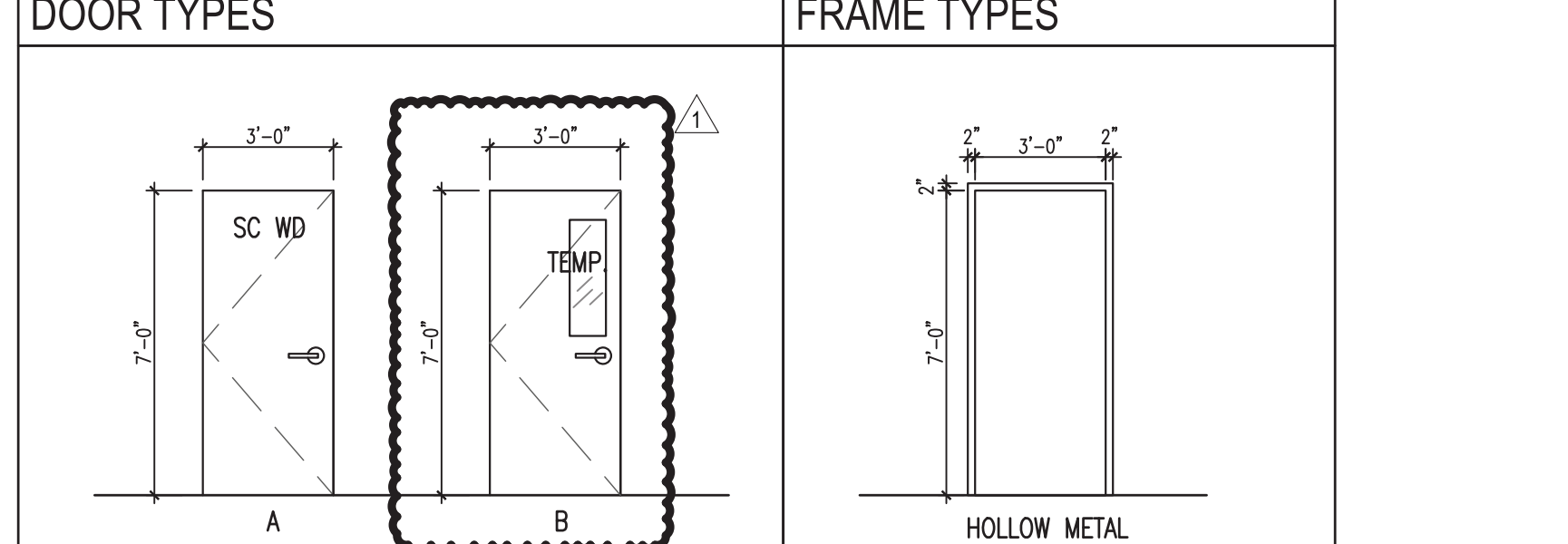

HARDWARE SCHEDULE		HARDWARE SCHEDULE CONT.	
MFR LIST	NAME	HARDWARE SETS	
AB	ABH MANUFACTURING INC.	SET #01 - INT - SGL - RESTROOM	
AD	ADAMS RITE	DOORS: 101	
BE	BEST ACCESS SYSTEMS	3 BUTT HINGE	FBB179 4.5" X 4.5" 26D ST
IV	IVES	1 PRIVACY LATCHSET	QCL140 M 478S 626 SH
NA	NATIONAL GUARD	1 DOOR CLOSER	QDC111 R SN 689 SH
PR	BEST PRECISION EXIT DEVICES	1 KICK PLATE	K0050 10" X 2" LDW CSK 630 TR
SH	DORMAKABA COMMERCIAL HARDWARE	1 WALL BUMPER	1270WV 630 TR
ST	BEST HINGES AND SLIDING	1 WARDROBE HOOK	582 B 26D IV
TR	TRIMCO	3 SILENCER	1229A GREY TR
FINISH LIST	DESCRIPTION	SET #02 - INT - SGL - STORAGE / UL90	
130	RITECOAT PAINTED - SATIN ALUMINUM	DOORS: 103	
26D	SATIN CHROME	3 BUTT HINGE	CB199 4.5"x4.5" NRP 630W ST
626	SATIN CHROMIUM PLATED	1 CLASSROOM LOCKSET	QCL161 M 478S LC 626 SH
628	SATIN ALUMINUM, CLEAR ANODIZED	1 CORE	1C-7 626 BE
630	SATIN STAINLESS STEEL	1 DOOR CLOSER	QDC111 R SN 689 SH
630W	STAINLESS STEEL, WEATHERIZED	1 KICK PLATE	K0050 10" x 2" LDW CSK 630 TR
689	ALUMINUM PAINTED	1 WALL BUMPER	1210WV 630 TR
AL	ALUMINUM	1 SILENCER	1229A GREY TR
S1	SPRAYED ALUMINUM FINISH		
OPTION LIST	DESCRIPTION		
3RO	PREFIX OPTION FOR 2000 APEX SERIES		
478S	4 7/8" ANSI STRIKE		
CSK	COUNTER SINKING OF KICK PLATES		
HC	HURRICANE CODE DEVICE		
LC	LESS SFIC CYLINDER		
R	FULL SIZE ROUNDED PLASTIC COVER		
S300	STD. STRIKE - RIM AND TOP OF SVR DEVICES		
SN	HEX NUTS		

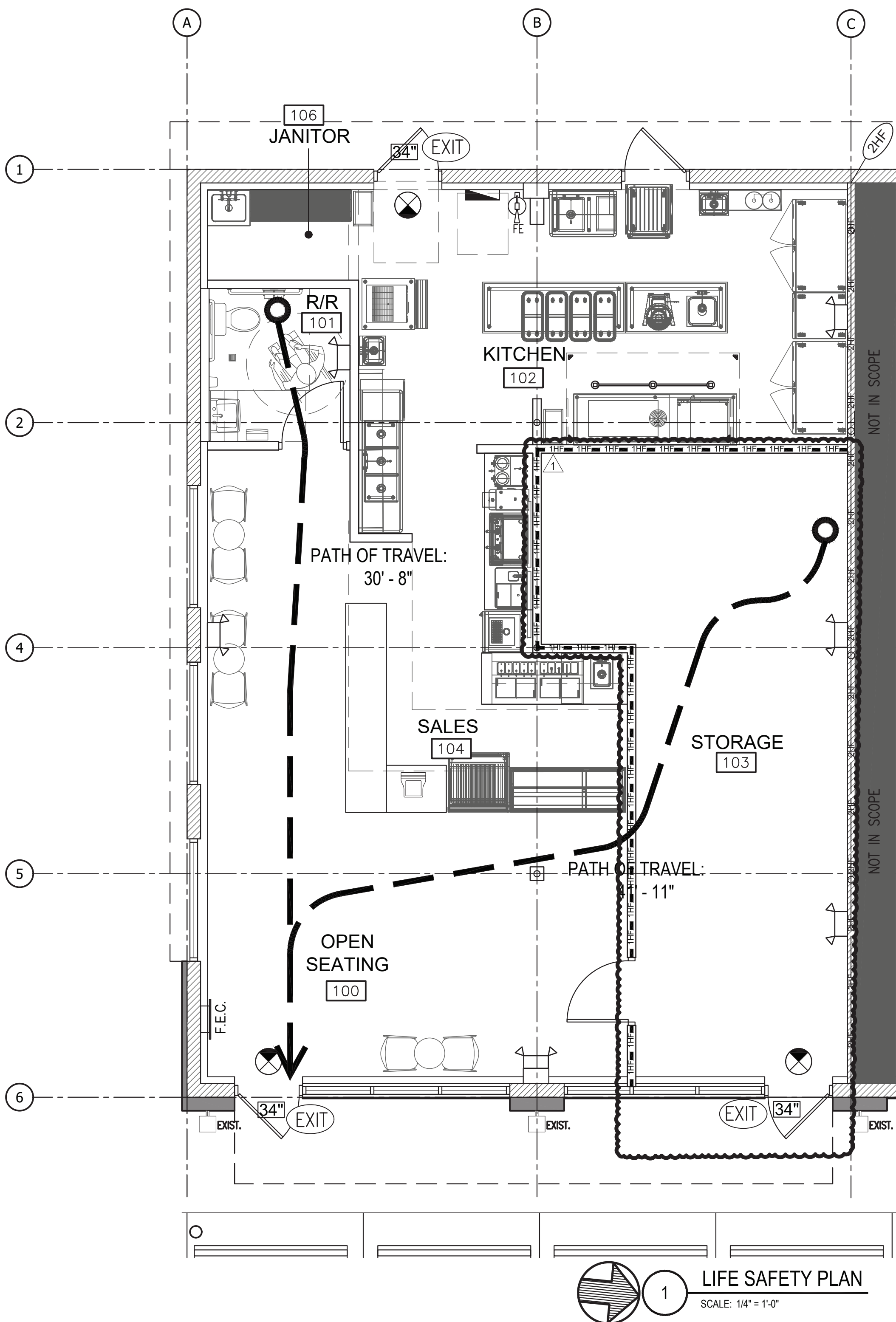

1 LIFE SAFETY PLAN SCALE: 1/4" = 1'-0"

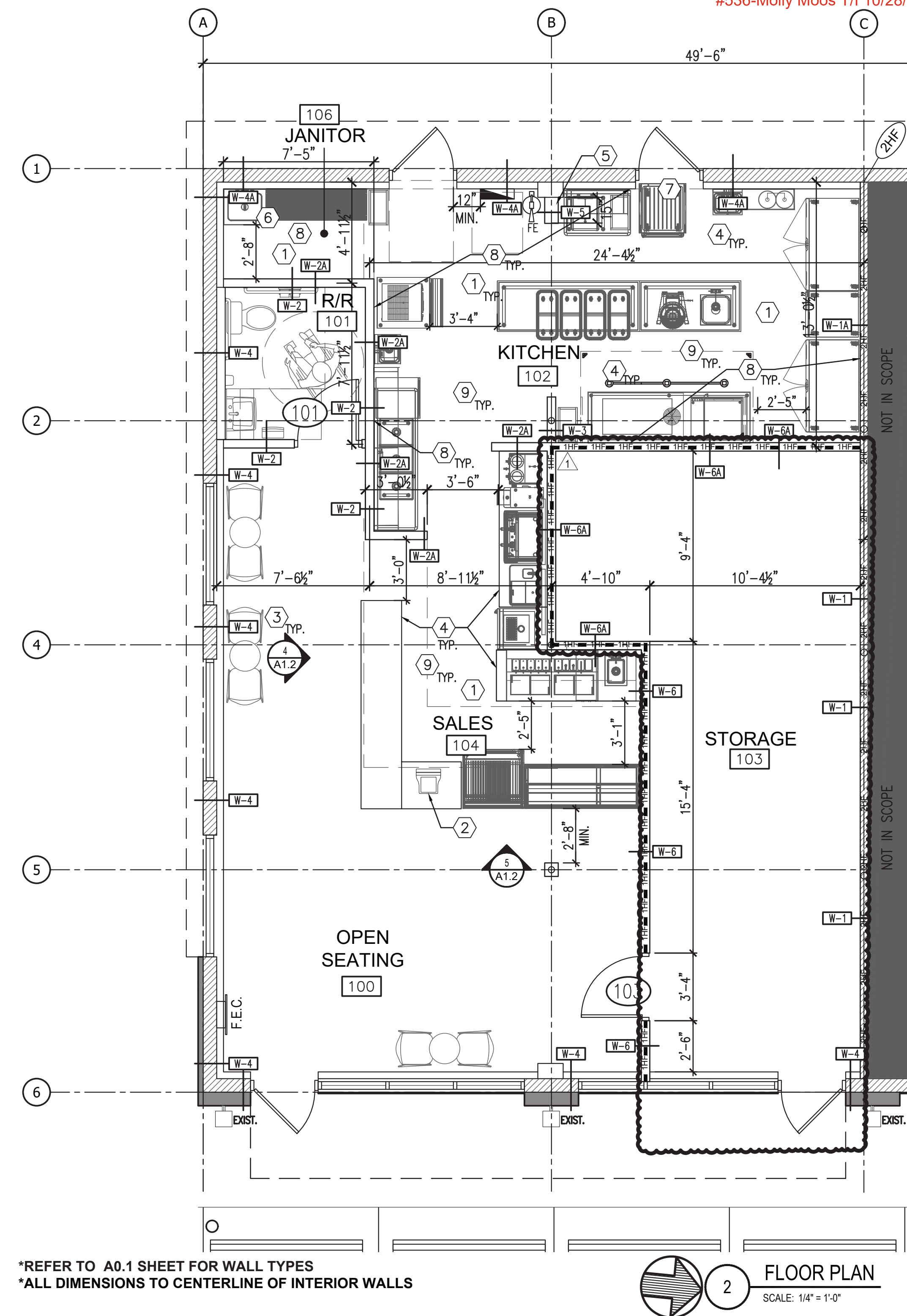

2 FLOOR PLAN SCALE: 1/4" = 1'-0"

### GENERAL LIFE SAFETY NOTES

- EMERGENCY LIGHTING AND EXIT LIGHTS SHALL MEET REQUIREMENTS OF FFPC INCLUDING NFPA 1 & 101
- SEE ELEC. FOR FIRE ALARM PLAN STROBES AND HORNS
- FINAL LOCATIONS FOR ALL FIRE EXTINGUISHERS TO BE CONFIRMED IN BUILDING DURING WALK-THRU WITH LOCAL FIRE MARSHAL AND OWNER'S SET-UP COORDINATOR
- 1/2" MAX. CHANGE IN ELEVATION AT ALL EXTERIOR DOORS.
- EACH FIRE WALL, FIRE BARRIER, FIRE PARTITION, SMOKE BARRIER, OR NEW WALL REQUIRED TO HAVE PROTECTIVE OPENINGS SHALL BE PERMANENTLY IDENTIFIED WITH SIGNS OR STENCILING ABOVE ANY CEILING AND IN CONCEALED SPACES WITH THE WORDING, "FIRE AND SMOKE BARRIER, PROTECT ALL OPENINGS", SHALL BE 4 INCH HIGH LETTERS, ONE HALF INCH STROKE AND NOT MORE THAN 15 FEET ON CENTER. NFPA 101
- ALL INTERIOR FINISH MATERIALS SHALL COMPLY WITH NFPA 101 CLASSIFICATION OF INTERIOR FINISH MATERIALS SHALL BE IN ACCORDANCE WITH TESTS MADE UNDER CONDITIONS SIMULATING ACTUAL INSTALLATIONS, PROVIDED THAT THE AUTHORITY HAVING JURISDICTION IS PERMITTED TO ESTABLISH THE CLASSIFICATION OF ANY MATERIAL FOR WHICH CLASSIFICATION BY A STANDARD TEST IS NOT AVAILABLE.
- PORTABLE FIRE EXTINGUISHERS ON PLANS SHALL BE IN COMPLIANCE WITH FFPC INCLUDING NFPA 1 & 101. THERE SHALL BE

### GENERAL LIFE SAFETY NOTES (CONT.)

- A MINIMUM OF ONE EXTINGUISHER PER EVERY 2,500 SF MINIMUM TYPE A10BC. FINAL LOCATIONS FOR ALL FIRE EXTINGUISHERS TO BE CONFIRMED IN BUILDING DURING WALK-THRU WITH FIRE MARSHAL AND OWNER'S REP.
- REFER TO ELECTRICAL DRAWINGS FOR EMERGENCY LIGHT LOCATIONS.
- PROVIDE EXIT DOOR TACTILE SIGNAGE PER NFPA 101 AT EACH EXIT DOOR REQUIRING AN EXIT SIGN.

### LEGEND

- LED ILLUMINATED LIGHT EXIT SIGN. ARROW INDICATES DIRECTION IF NEEDED.
- TRAVEL DISTANCE
- FIRE EXTINGUISHER
- NOTE: CONFIRM TYPE AND LOCATIONS WITH ELEC.
- FIRE EXTINGUISHER SEMI RECESSED CABINET
- LED BATTERY BACKUP EMERGENCY LIGHT (2) HEAD.

### MAX. ALLOWABLE TRAVEL DIST.

DESCRIPTION	OCCUPANCY
COMMON PATH OF TRAVEL (TABLE 1006.2.1)	ASSEMBLY (A-2)
DEAD-END (FBC 1020.5)	75 FT (NON-SPRINKLERED)
EXIT ACCESS TRAVEL DISTANCE (TABLE 1017.2)	20 FT (NON-SPRINKLERED)
	200 FT (NON-SPRINKLERED)
DESCRIPTION	OCCUPANCY
COMMON PATH OF TRAVEL (TABLE 1006.2.1)	MERCANTILE
DEAD-END (FBC 1020.5)	75 FT (NON-SPRINKLERED)
EXIT ACCESS TRAVEL DISTANCE (TABLE 1017.2)	20 FT (NON-SPRINKLERED)
	200 FT (NON-SPRINKLERED)

### OCCUPANT LOAD & EGRESS CALCS.

Room	Area in SF	Occupant Load Factor	Occupants
Mercantile	522	60	9
Kitchen (A-2)	596	200	3
Storage (S-1)	269	300	1
Dining Area (Unconcentrated)(S-2)	25	15	2
<b>Total</b>	<b>1,412</b>		<b>16</b>

### PLUMBING CALCS

Tenant 100			
<b>Toilets</b>		<b>LAVATORIES</b>	
Occupants	Required	Provided	Required
15	1	1	1
<b>Service Sink</b>		<b>DRINKING FOUNTAIN (HI/LO)</b> 1 per 100	
Occupants	Required	Provided	PER FBC 410
15	1	1	0

### GENERAL FLOORPLAN NOTES

- TACTILE SIGNAGE TO BE PROVIDED PER FBC ACCESSIBILITY 216.4.1 LOCATED AT EACH EXIT DOOR REQUIRING AN EXIT SIGN. TO READ "EXIT". SHALL COMPLY WITH ANSI A117.1 AMER. NATIONAL STANDARDS FOR ACCESSIBLE AND USABLE BUILDINGS AND FACILITIES
- ALL EXTERIOR DOOR LOCKS SHALL COMPLY WITH FFPC 2023 INCLUDING NFPA 1 & 101 THUMB TURN LOCKS TO COMPLY. INDICATING LOCKS ARE REQUIRED ON ALL ENTRANCE DOOR INTERIORS.
- PORTABLE FIRE EXTINGUISHERS ON PLANS SHALL BE IN COMPLIANCE WITH FFPC INCLUDING NFPA 1 & 101, NEW EDITION. THERE SHALL BE A MINIMUM OF ONE EXTINGUISHER PER EVERY 2,500 SQ. FT. MINIMUM SIZE 2A10BC & 3A40BC TYPE.
- THE PROJECT COMPLIES WITH THE ADA ACCESSIBILITY CODE FOR BUILDING CONSTRUCTION.
- THE ENTIRE BUILDING SHALL BE CLEANED THROUGHOUT AT THE COMPLETION OF CONSTRUCTION.
- THERE SHALL BE A MAXIMUM OF 1/2" FINISHED FLOOR ELEVATION BETWEEN ADJACENT FLOOR SURFACES.
- VERIFY ALL DIMENSIONS IN FIELD.
- EMPAD ARCHITECTURE & DESIGN IS NOT RESPONSIBLE FOR

### GENERAL FLOORPLAN NOTES (CONT.)

- ACCURACY OF AREA CALCULATIONS. LAYOUT AND FIELD VERIFICATIONS SHOULD BE VERIFIED IN FIELD BY CONTRACTOR
- ALL DOORS TO MEET CODE COMPLIANCE WITH A CLEAR SPACE OF 34" AND MEET PULL/PUSH RESTRICTIONS, U.O.N.
- DO NOT SCALE DRAWINGS
- LOCATE ALL DOOR HINGE SIDES 4" FROM ADJACENT WALL UNLESS DIMENSIONED OTHERWISE

### FLOORPLAN KEYED NOTES

- KITCHEN EQUIPMENT BY OWNER, INSTALLED BY G.C. REFER TO EQUIPMENT SPECS, TYP.
- POS SYSTEM BY OWNER, INSTALLED BY G.C. ON 34" HEIGHT ADA COUNTER.
- FURNITURE BY OWNER, SHOWN FOR REFERENCE ONLY.
- MILLWORK AND CASEWORK BY OTHERS, REFER TO CASEWORK AND EQUIPMENT SPECS AND DRAWINGS.
- WING WALL TO ENCAPSULATE EXISTING VERTICAL PIPE
- MOP SINK
- SEAL OFF EXISTING DOOR, PROVIDE 3M FILM AS REQUIRED.
- CEMENT BOARD ON BACK OF HOUSE WALLS, NOT GWB.
- PROVIDE PLYWOOD BACKING FLOOR TO CEILING ALL KITCHEN WALLS, REFER TO A0.1 WALL TYPES

THIS DRAWING AND ALL INFORMATION CONTAINED HEREIN IS THE EXCLUSIVE PROPERTY OF EMPAD ARCHITECTURE & DESIGN. NO PART OF THIS DRAWING IS TO BE REPRODUCED, COPIED, OR TRANSMITTED IN ANY FORM OR BY ANY MEANS, WITHOUT THE EXPRESS WRITTEN CONSENT OF EMPAD ARCHITECTURE & DESIGN. P.A. AND MUST BE RETURNED UPON REQUEST. THIS DRAWING IS NOT FOR GENERAL USE OR FOR REPRODUCTION. ALL RIGHTS RESERVED. TO THE BEST OF MY KNOWLEDGE, THE SPECIFICATIONS AND BUILDING CODES IN EFFECT AT THIS TIME.

**EMPAD ARCHITECTURE AND DESIGN**  
interior designers • planners • architects

AA26000994  
1901 Ulmerton Rd., Ste 195  
Clearwater FL, 33762  
(727)570-9506  
WWW.EMPAD.NET

**LIFE SAFETY PLAN & FLOOR PLAN**  
MOLLY MOOS (INTERIORS)  
ICE CREAM SHOP  
2004 PASSA GRILLE WAY  
ST. PETE BEACH, FLORIDA

REVISIONS:

NO.	DATE	COMMENTS
1	10/24/2025	

CHRIS CULBERTSON  
ARCHITECT AR91712

**A1.1**

Issue Date: 05/16/2025  
Project No.: 240027