



**ARES  
INDUSTRIAL  
MANAGEMENT**

# SOUTHPARK

3000 SOUTHPARK BOULEVARD, ELLENWOOD GA 30294

Suite 150 | 112,600 - 136,600 Leasable SQ FT | Class A Warehouse Facility

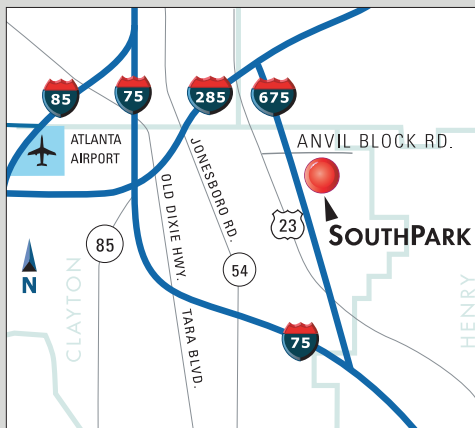

## BUILDING HIGHLIGHTS

- 273,200 SF cross-dock
- 32' clear ceiling
- 40'w x 50'd columns
- ESFR sprinkler system
- 140'-180'd secured truck courts with 60' concrete aprons
- Tier 1 Community with tax incentives

## SUITE 150 HIGHLIGHTS

- 112,600 SF available May 2026; additional 24,000 SF available now for 136,600 SF total
- Expandable to 273,200 SF total
- 4,524 SF of office
- T5 warehouse lights
- 36 (9'x10') dock-high doors; 11 pit levelers; 25 EOD levelers
- 600 amp, 277-480 volt, 3 phase, 4 wire electrical service
- Secured truck court

JOHN DOWNING  
404.314.0390  
jdowning@mcdco.com

JOHN MCDONALD III  
404.909.7144  
jrmdonald@mcdco.com





**ARES  
INDUSTRIAL  
MANAGEMENT**

# SOUTHPARK

3000 SOUTHPARK BOULEVARD, ELLENWOOD GA 30294

Suite 150 | 112,600 - 136,600 Leasable SQ FT | Class A Warehouse Facility

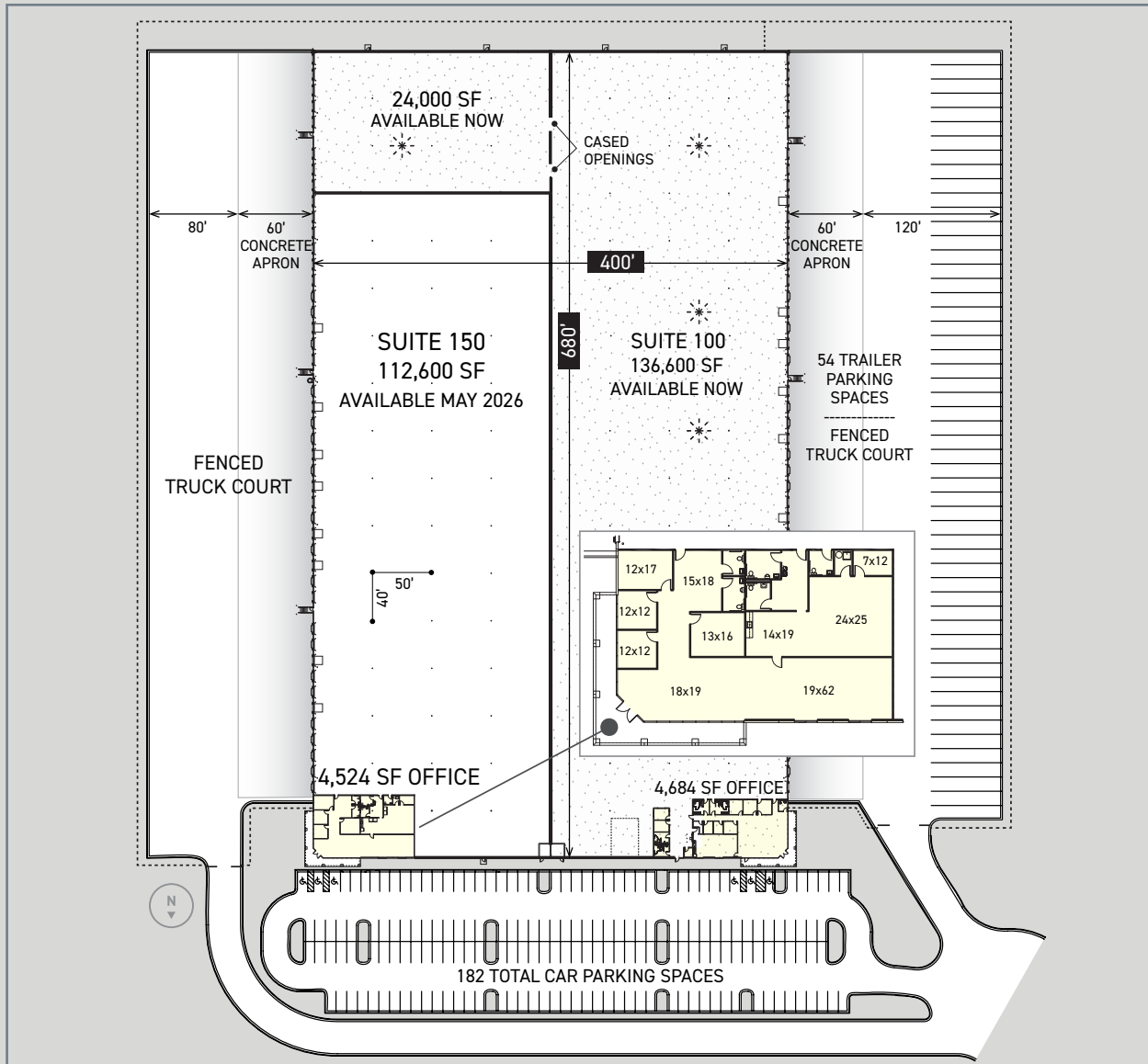

JOHN DOWNING  
404.314.0390  
jdowning@mcdco.com

JOHN MCDONALD III  
404.909.7144  
jrmcdonald@mcdco.com

