

# PROPERTY FOR SALE

FREESTANDING  
COMMERCIAL BUILDING  
WITH LARGE YARD

**FOR  
SALE**  
...

**±6,300 SF ON ±2.08 ACRES**

10391 ARLINGTON AVENUE  
RIVERSIDE, CA 92505

## PROPERTY FEATURES

- ± 6,300 SF Freestanding Commercial Building
- ± 3,000 SF Showroom and remainder is warehouse
- Refresh complete: Roof, Electrical, Floor, Paint, Restrooms, etc.
- Fully Fenced Drive Around Building
- ± 200 Amps Power (verify)
- Two (2) Ground Level Doors
- ± 30' x 30' Freezer in Warehouse (can be removed)
- Electrical Outlets in Yard previously Used for Ice Cream Vehicles
- Access to 91, 15 & 60 Fwys
- Zoned General Commercial (per city of Riverside)
- Previously Occupied by Ice Cream Wholesale and Party Supply Business
- APN #154-321-024

The information contained herein has not been verified by real estate brokers. Although we have no reason to doubt its accuracy we do not guarantee it. Buyers and tenant should verify information independently.

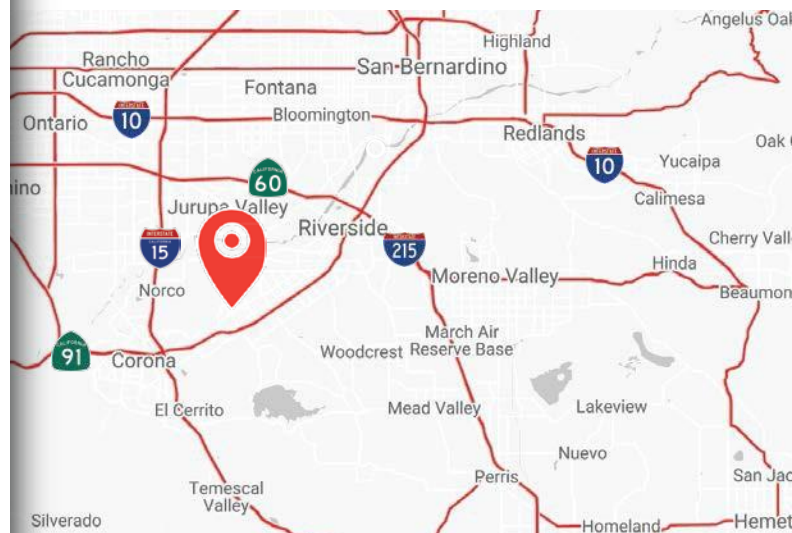

**Ashwill  
Associates**  
COMMERCIAL REAL ESTATE

Kyle Williams  
949.293.6788  
CAL DRE Lic# 02015940  
[kyle@ashwillassociates.com](mailto:kyle@ashwillassociates.com)  
Corp CAL DRE# 01291393

# FLOOR PLAN

10391 ARLINGTON AVENUE | RIVERSIDE, CA 92505

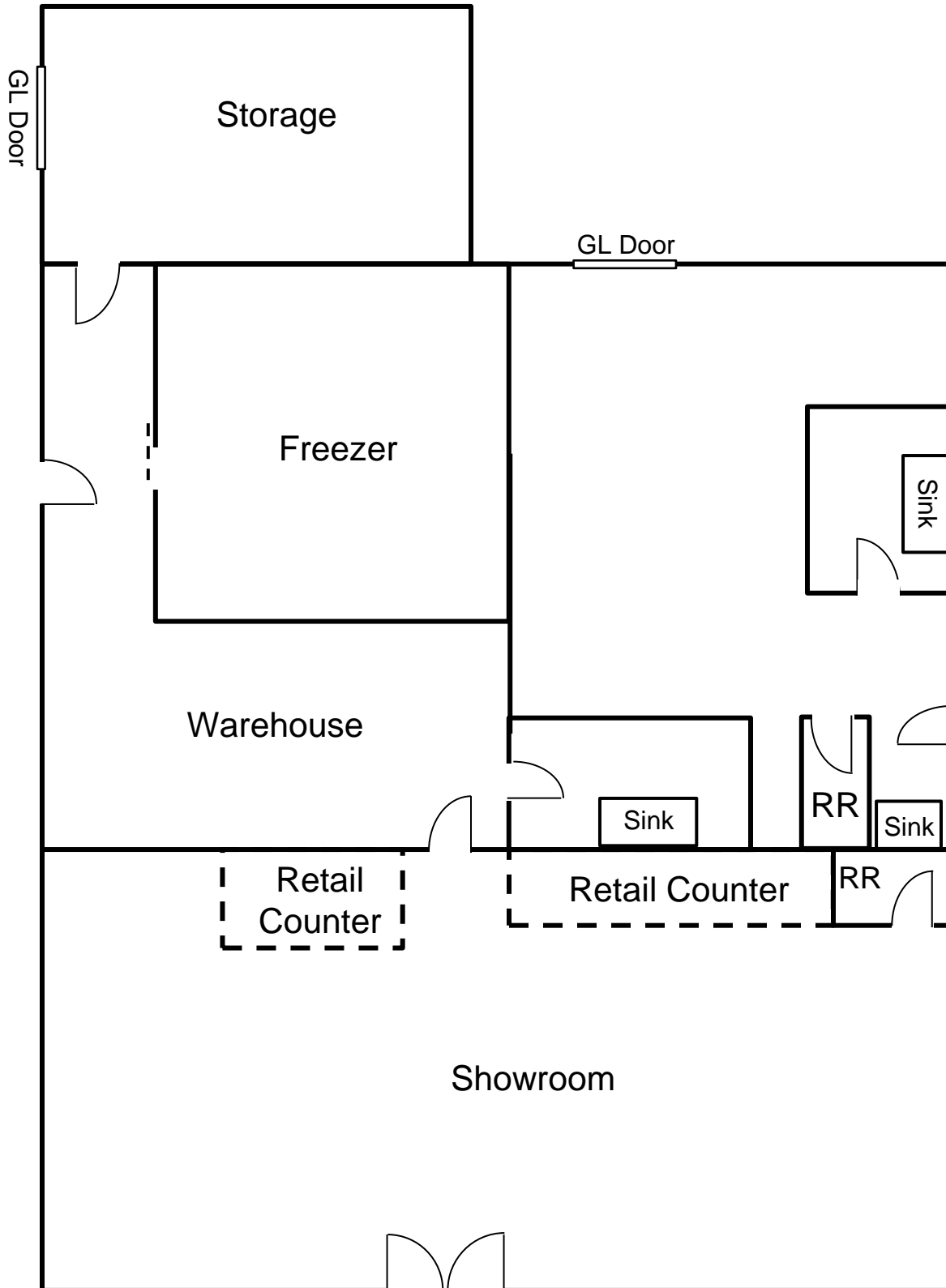

\*Not to Scale

**Ashwill**  
**Associates**  
COMMERCIAL REAL ESTATE

Kyle Williams | 949.293.6788  
CAL DRE Lic# 02015940  
[kyle@ashwillassociates.com](mailto:kyle@ashwillassociates.com)

# AERIAL VIEW

10391 ARLINGTON AVENUE | RIVERSIDE, CA 92505



Kyle Williams | 949.293.6788  
CAL DRE Lic# 02015940  
[kyle@ashwillassociates.com](mailto:kyle@ashwillassociates.com)

# P H O T O S

10391 ARLINGTON AVENUE | RIVERSIDE, CA 92505



Kyle Williams | 949.293.6788  
CAL DRE Lic# 02015940  
[kyle@ashwillassociates.com](mailto:kyle@ashwillassociates.com)