

# 850 SF OFFICE



## FOR LEASE



## 210-212 E 3rd Street

210 E 3rd St

Royal Oak, Michigan 48067

### Property Highlights

- 850 Square Feet of Office
- Downtown Royal Oak
- Located across the Royal Oak Town Square
- Walk to cafes and restaurants
- Convenient Parking
- One Private Room and One open Room

Three to five year lease

### OFFERING SUMMARY

Lease Rate:	\$24.00 SF/yr (MG)
Available SF:	850 SF
Lot Size:	29,146 SF
Building Size:	24,366 SF

### DEMOGRAPHICS

	1 MILE	3 MILES	5 MILES
Total Households	9,377	66,218	149,878
Total Population	17,849	138,806	335,582
Average HH Income	\$140,372	\$112,964	\$95,543

# 850 SF OFFICE



## FOR LEASE



# 850 SF OFFICE

## FOR LEASE



FIRST FLOOR	AREA CALCULATIONS
<div style="background-color: #f4a460; width: 15px; height: 10px; display: inline-block; margin-right: 5px;"></div> OCCUPANT AREA (USF) 306 S. TROY	7,127 USF
12% RENT FACTOR	855 SQ. FT.
<b>TOTAL RENTABLE SQ. FT.</b>	<b>7,982 RSF</b>

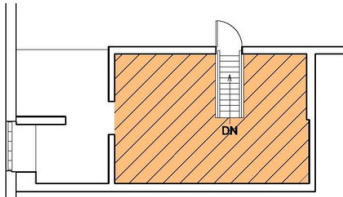

**MEZZ. FLOOR PLAN**  
SCALE: 1/8" = 1'-0"  
NORTH

306 S. TROY MEZZANINE  
 (NOT INCLUDED IN TOTAL RENTABLE SQ. FT.)



**210 E. THIRD STREET FLOOR PLAN**  
8-18-2020 SCALE: 3/32" = 1'-0"

PREPARED BY METRO CAD GROUP



Commercial Real Estate Services, Worldwide.

www.naifarbman.com

**Rick Ax**  
Associate Broker | 248.351.6319  
ax@farbman.com

NO WARRANTY, EXPRESS OR IMPLIED, IS MADE AS TO THE ACCURACY OF THE INFORMATION CONTAINED HEREIN. THIS INFORMATION IS SUBMITTED SUBJECT TO ERRORS, OMISSIONS, CHANGE OF PRICE, RENTAL OR OTHER CONDITIONS, WITHDRAWAL WITHOUT NOTICE, AND IS SUBJECT TO ANY SPECIAL LISTING CONDITIONS IMPOSED BY OUR PRINCIPALS, COOPERATING BROKERS, BUYERS, TENANTS AND OTHER PARTIES WHO RECEIVE THIS DOCUMENT SHOULD NOT RELY ON IT, BUT SHOULD USE IT AS A STARTING POINT OF ANALYSIS, AND SHOULD INDEPENDENTLY CONFIRM THE ACCURACY OF THE INFORMATION CONTAINED HEREIN THROUGH A DUE DILIGENCE REVIEW OF THE BOOKS, RECORDS, FILES AND DOCUMENTS THAT CONSTITUTE RELIABLE SOURCES OF THE INFORMATION DESCRIBED HEREIN. LOGOS ARE FOR IDENTIFICATION PURPOSES ONLY AND MAY BE TRADEMARKS OF THEIR RESPECTIVE COMPANIES. NAI Farbman, INC. CA BRE LIC. #01990696.

# 850 SF OFFICE

## FOR LEASE

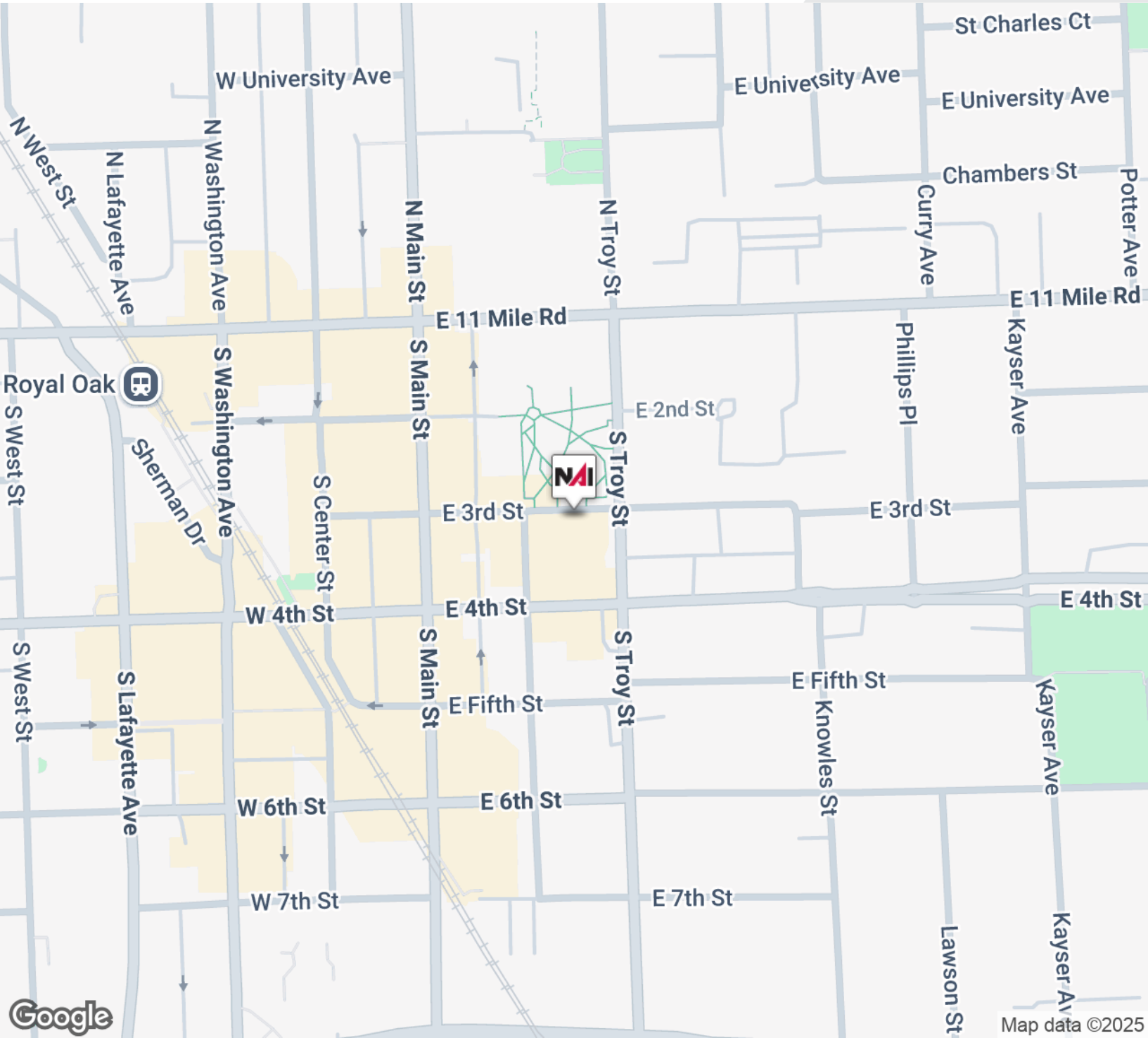

Commercial Real Estate Services, Worldwide.

[www.naifarbman.com](http://www.naifarbman.com)

**Rick Ax**  
Associate Broker | 248.351.6319  
[ax@farbman.com](mailto:ax@farbman.com)

NO WARRANTY, EXPRESS OR IMPLIED, IS MADE AS TO THE ACCURACY OF THE INFORMATION CONTAINED HEREIN. THIS INFORMATION IS SUBMITTED SUBJECT TO ERRORS, OMISSIONS, CHANGE OF PRICE, RENTAL OR OTHER CONDITIONS, WITHDRAWAL WITHOUT NOTICE, AND IS SUBJECT TO ANY SPECIAL LISTING CONDITIONS IMPOSED BY OUR PRINCIPALS, COOPERATING BROKERS, BUYERS, TENANTS AND OTHER PARTIES WHO RECEIVE THIS DOCUMENT SHOULD NOT RELY ON IT, BUT SHOULD USE IT AS A STARTING POINT OF ANALYSIS, AND SHOULD INDEPENDENTLY CONFIRM THE ACCURACY OF THE INFORMATION CONTAINED HEREIN THROUGH A DUE DILIGENCE REVIEW OF THE BOOKS, RECORDS, FILES AND DOCUMENTS THAT CONSTITUTE RELIABLE SOURCES OF THE INFORMATION DESCRIBED HEREIN. LOGOS ARE FOR IDENTIFICATION PURPOSES ONLY AND MAY BE TRADEMARKS OF THEIR RESPECTIVE COMPANIES. NAI Farbman, INC. CA BRE LIC. #01990696.

# 850 SF OFFICE

## FOR LEASE

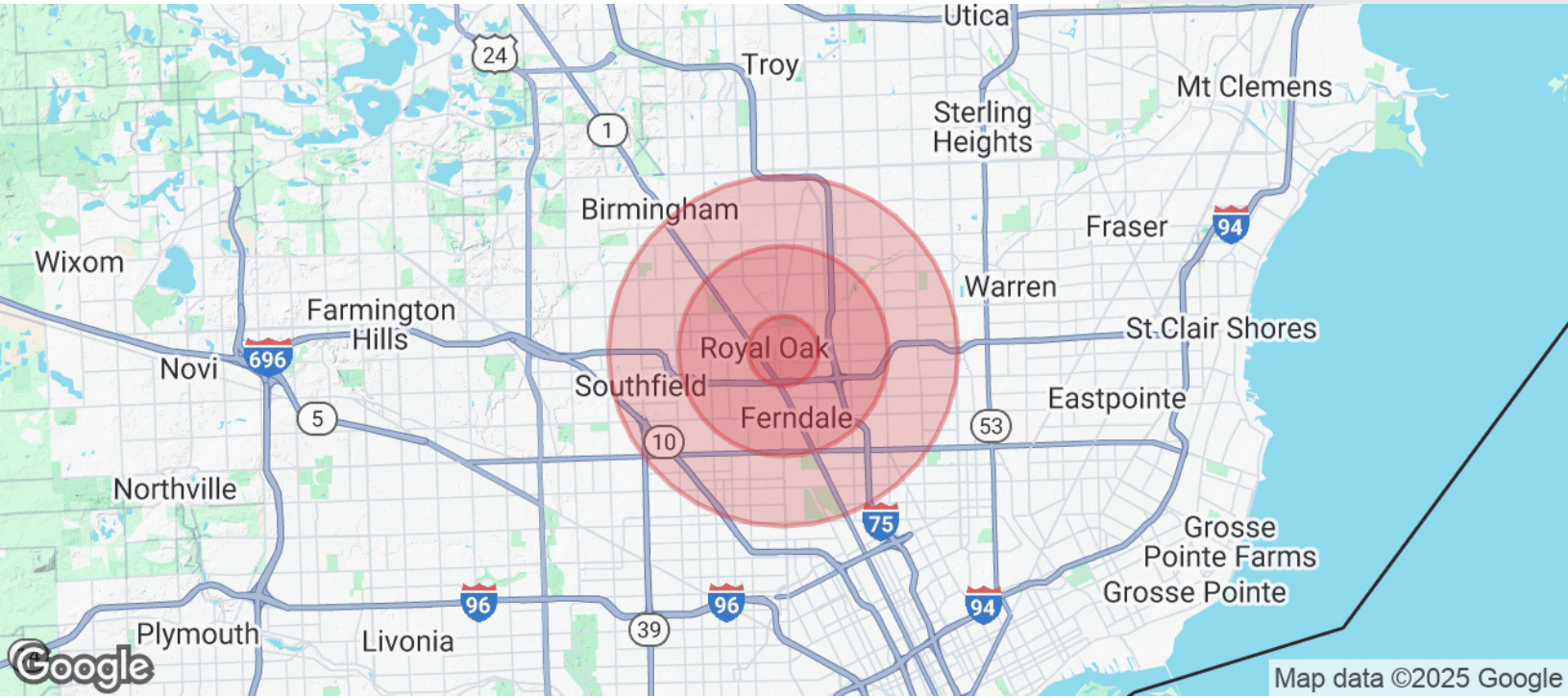

### POPULATION

### 1 MILE

### 3 MILES

### 5 MILES

Total Population	17,849	138,806	335,582
Average Age	40	41	41
Average Age (Male)	39	40	40
Average Age (Female)	41	42	43

### HOUSEHOLDS & INCOME

### 1 MILE

### 3 MILES

### 5 MILES

Total Households	9,377	66,218	149,878
# of Persons per HH	1.9	2.1	2.2
Average HH Income	\$140,372	\$112,964	\$95,543
Average House Value	\$418,844	\$299,404	\$253,429

Demographics data derived from AlphaMap



Commercial Real Estate Services, Worldwide.

www.naifarbman.com

**Rick Ax**

Associate Broker | 248.351.6319  
ax@farbman.com

NO WARRANTY, EXPRESS OR IMPLIED, IS MADE AS TO THE ACCURACY OF THE INFORMATION CONTAINED HEREIN. THIS INFORMATION IS SUBMITTED SUBJECT TO ERRORS, OMISSIONS, CHANGE OF PRICE, RENTAL OR OTHER CONDITIONS, WITHDRAWAL WITHOUT NOTICE, AND IS SUBJECT TO ANY SPECIAL LISTING CONDITIONS IMPOSED BY OUR PRINCIPALS, COOPERATING BROKERS, BUYERS, TENANTS AND OTHER PARTIES WHO RECEIVE THIS DOCUMENT SHOULD NOT RELY ON IT, BUT SHOULD USE IT AS A STARTING POINT OF ANALYSIS, AND SHOULD INDEPENDENTLY CONFIRM THE ACCURACY OF THE INFORMATION CONTAINED HEREIN THROUGH A DUE DILIGENCE REVIEW OF THE BOOKS, RECORDS, FILES AND DOCUMENTS THAT CONSTITUTE RELIABLE SOURCES OF THE INFORMATION DESCRIBED HEREIN. LOGOS ARE FOR IDENTIFICATION PURPOSES ONLY AND MAY BE TRADEMARKS OF THEIR RESPECTIVE COMPANIES. NAI Farbman, INC. CA BRE LIC. #01990696.