



Flex Office/Warehouse Available for Sublease in Inverness

14 INVERNESS DRIVE EAST, SUITE E120
ENGLEWOOD, CO

Space Available

2,150 SF

Lease Rate

Contact Broker

Space Configuration

±30% office

Loading

Grade level/drive-in (10' x 10')

Term

through February 28, 2028

(Direct Deal For Longer Term Possible)

Flex Office/Warehouse for Sublease Property Highlights

- Prominent Inverness Business Park setting by the Inverness Golf Club
- Two prime I-25 access points at County Line and Dry Creek, as well as access to E-470
- Nearby amenities include Park Meadows Mall and other major retail outlets, restaurants, Inverness Health Club and Golf Course
- Warehouse clear height of ±12'
- Parking Ratio of 2.5: 1,000 SF

For information, please contact:

Keith Bell

t 303-260-4332

keith.bell@nrmk.com

1800 Larimer Street,
Suite 1700,
Denver, CO 80202

nrmk.com



NEWMARK

The information contained herein has been obtained from sources deemed reliable but has not been verified and no guarantee, warranty or representation, either express or implied, is made with respect to such information. Terms of sale or lease and availability are subject to change or withdrawal without notice.

14 INVERNESS DRIVE EAST, SUITE E120, ENGLEWOOD, CO

Floorplan

SUITE DATA:

OFFICE AREA	702 SF
WAREHOUSE AREA	1,448 SF
TOTAL SUITE AREA	2,150 SF
CLEAR HEIGHT	12'-0"
○ GRADE LEVEL DOORS	1

SITE KEY PLAN:



BUILDING KEY PLAN:

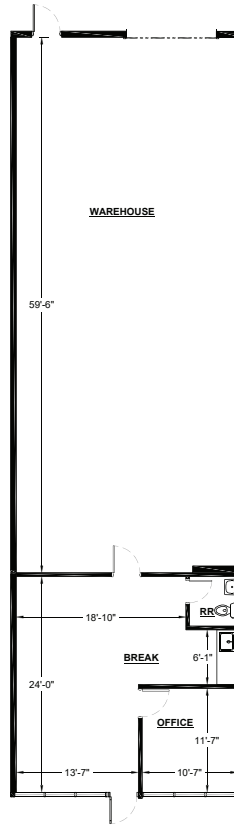
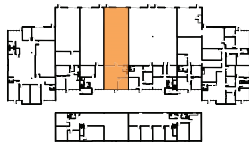

Space Available

2,150 SF

Lease Rate

Contact Broker

Space Configuration

±30% office

Loading

Grade level/Drive-in
(10' x 10')

Term

through February 28,
2028 (Direct Deal For
Longer Term Possible)

Map

