



## 7630-7642 McEwen Road

Washington Township, Ohio 45459

**LEASE RATE:**  
**\$6.75 PSF NNN**

### Property Highlights

- 8,584± - 23,983± SF Available
- 1 Drive-in door
- Dock platform with 2 dock positions
- 15' Clear height
- Fluorescent lighting
- Wet sprinkler system
- Park like setting with visibility from I-675
- Located in Washington Township - No city income tax!

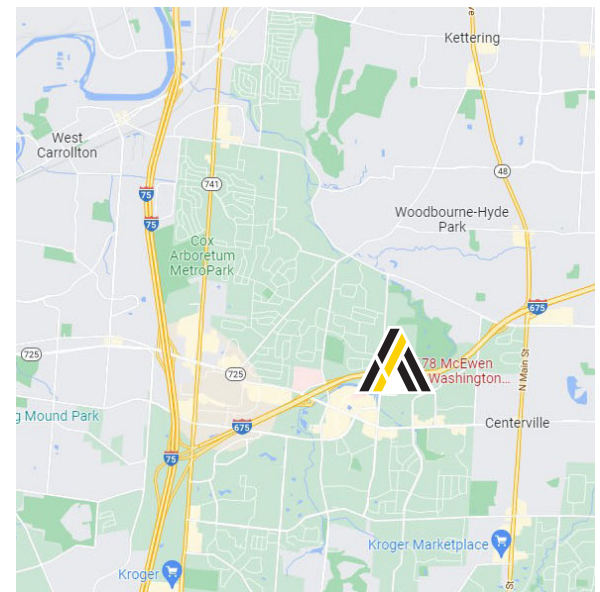

**Wade Elliott, SIOR**

Vice President

937.469.8270

Wade.Elliott@ApexCommercialGroup.com



**Alex Nikolai**

Senior Associate

937.222.7884

Alex.Nikolai@ApexCommercialGroup.com

# 7630-7642 McEwen Road

Washington Township, Ohio 45459

## Floor Plan

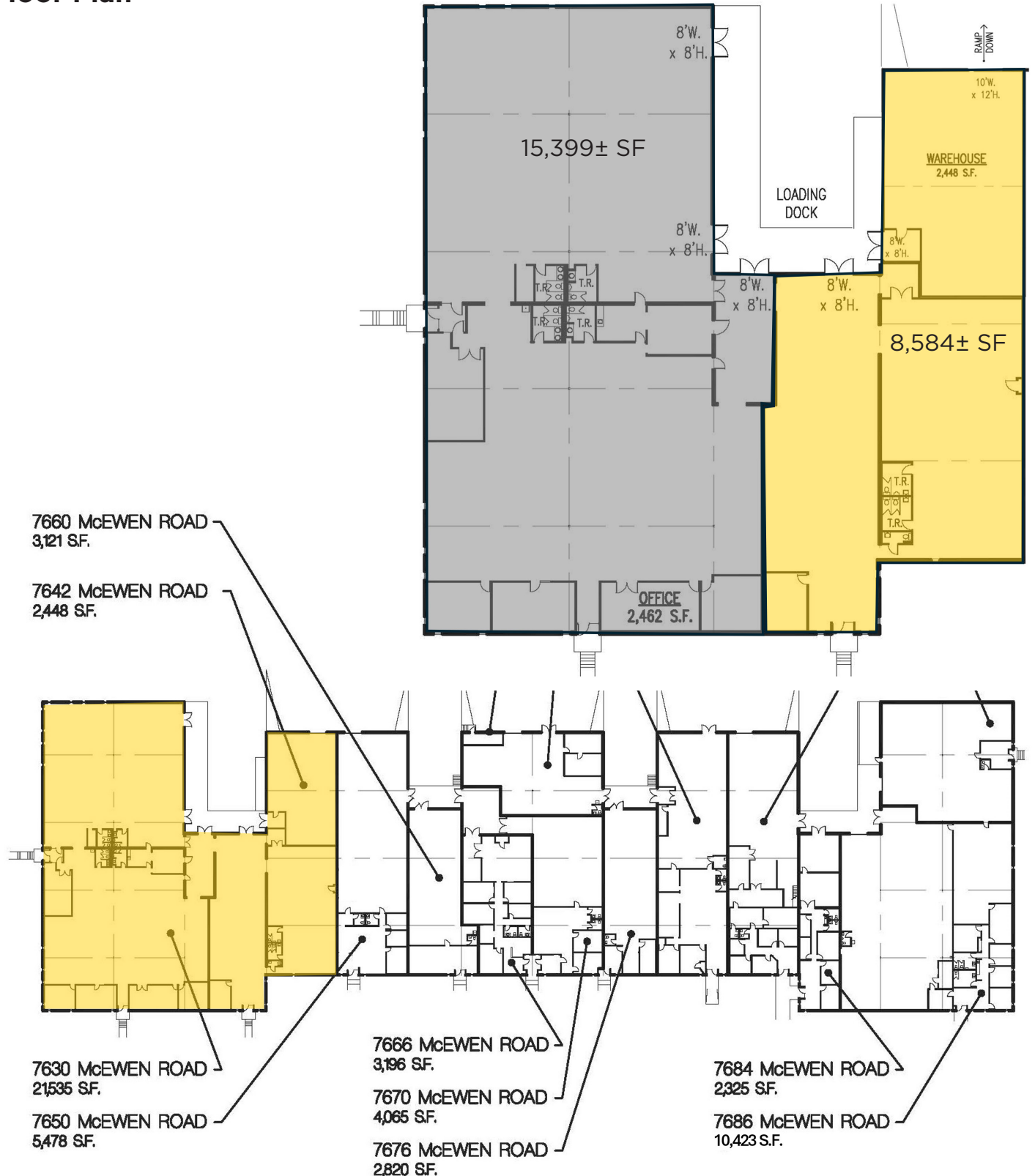

[ApexCommercialGroup.com](http://ApexCommercialGroup.com)