

BUILDING AREA CALCULATIONS - BUILDING D
 FIRST FLOOR = 10,888 SF
 MEZZANINE = 853 SF
 TOTAL GROSS BUILDING AREA = 11,741 SF

FIRST FLOOR PLAN
 Ceiling Height = 25'-9" / 21'-0"

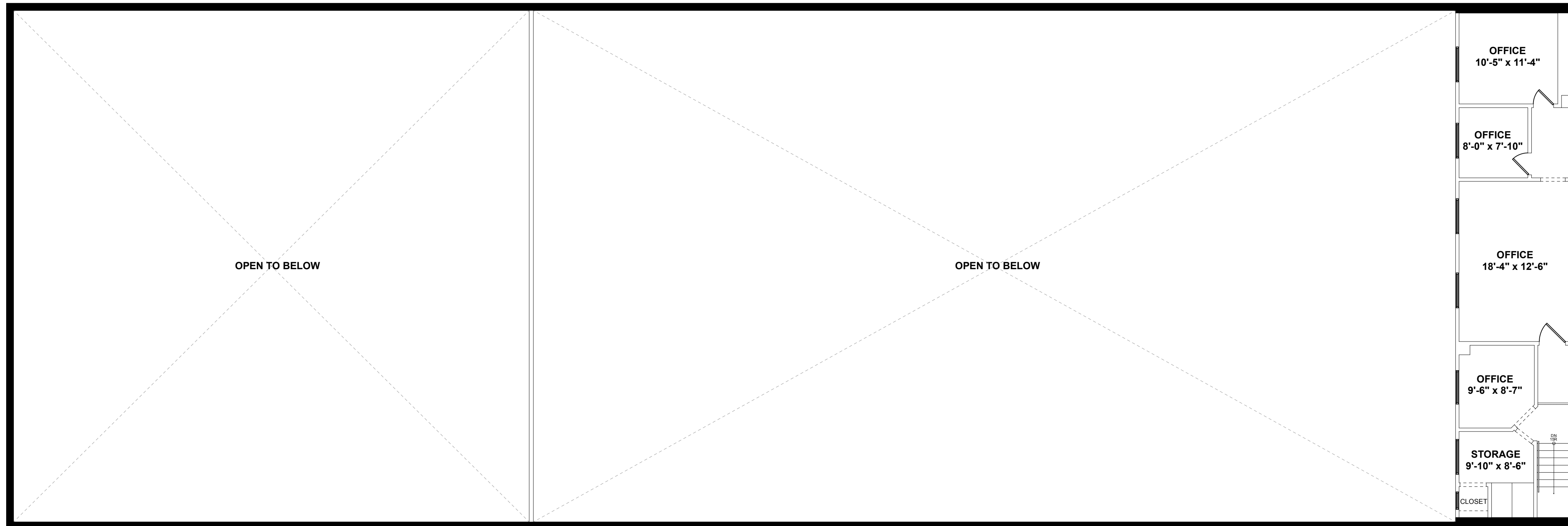

MEZZANINE FLOOR PLAN
 Ceiling Height = 8'-0"

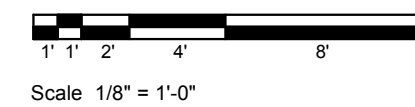

NATIONAL FLOOR PLANS
 398 COLUMBUS AVENUE, SUITE 100
 BOSTON, MA 02116 (800) 328-0217

REVISIONS			
DATE	BY	NO.	DESCRIPTION

**28 HASTINGS STREET
 BUILDING D
 MENDON, MA**

PROJECT NUMBER:	
DATE:	NOV 2024
SCALE:	AS NOTED
DRAWN BY:	APPROVED BY:

SHEET TITLE:
FLOOR PLANS

SHEET NUMBER:
A-6