

MIDWAY MARKETPLACE

1450 UNIVERSITY AVE W, ST. PAUL, MN



KRAUS-ANDERSON®
Realty Company

SPACE AVAILABLE

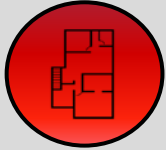

Multiple spaces available
-see site plan

SHOPPING CENTER



324,320 sf Regional
grocery anchored
community center

LOCATION



Located at the
intersection of University &
Hamline Avenues

ANCHOR TENANTS



Strong tenant mix
including, Cub Foods, TJ
Maxx, LA Fitness, and
Dollar Tree



	1 Mile	3 Miles	5 Miles
POPULATION	24,437	171,284	428,424
DAYTIME POP	22,351	153,002	485,843
HOUSEHOLDS	9,900	68,794	170,214
HOUSEHOLD INCOME	\$80,557	\$97,325	\$84,813



Retail Aerial

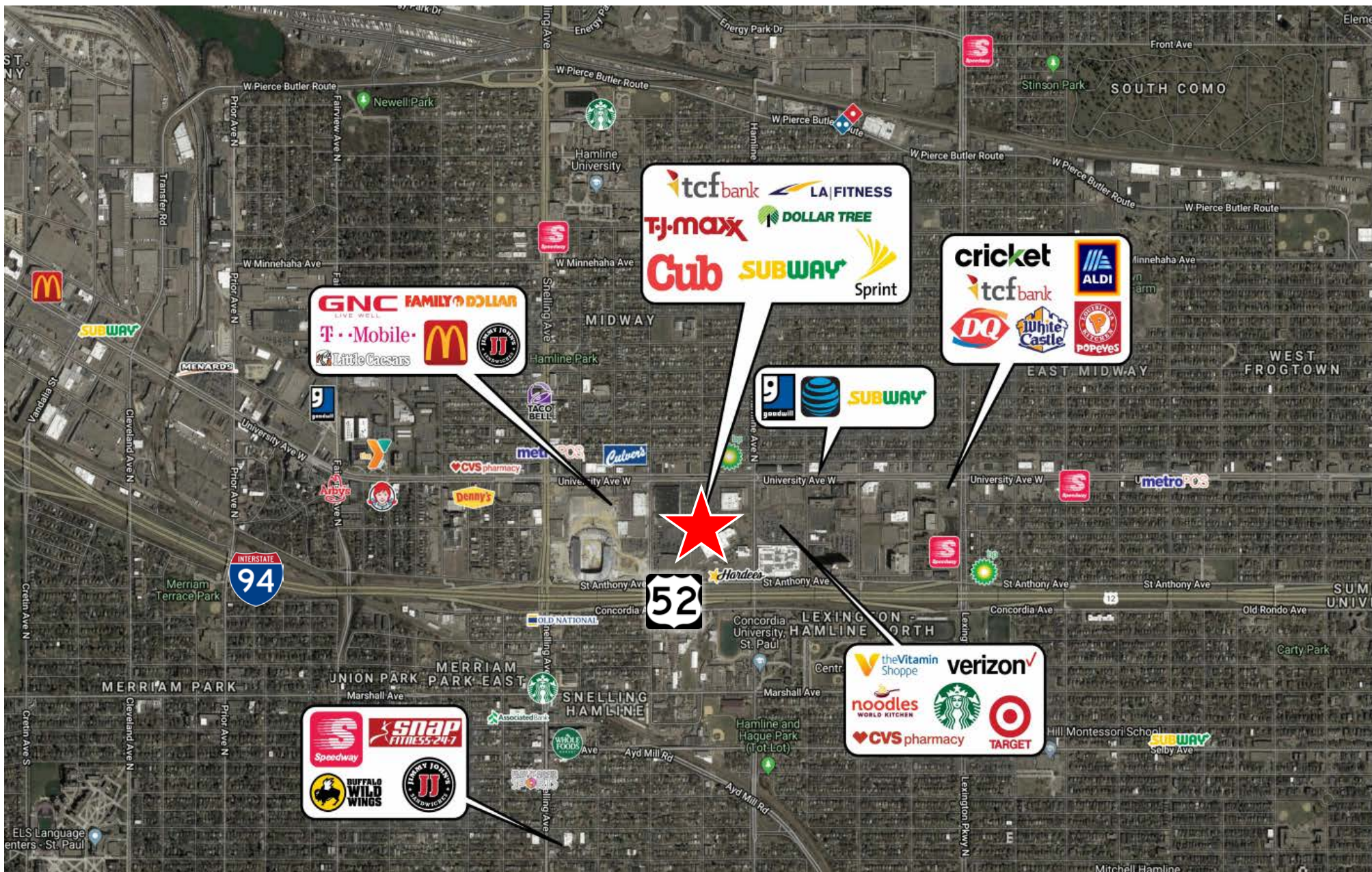

MIDWAY MARKETPLACE
ST. PAUL, MN





Aerial View



MIDWAY MARKETPLACE
ST. PAUL, MN



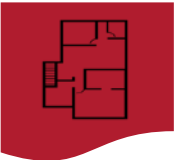

Site Plan

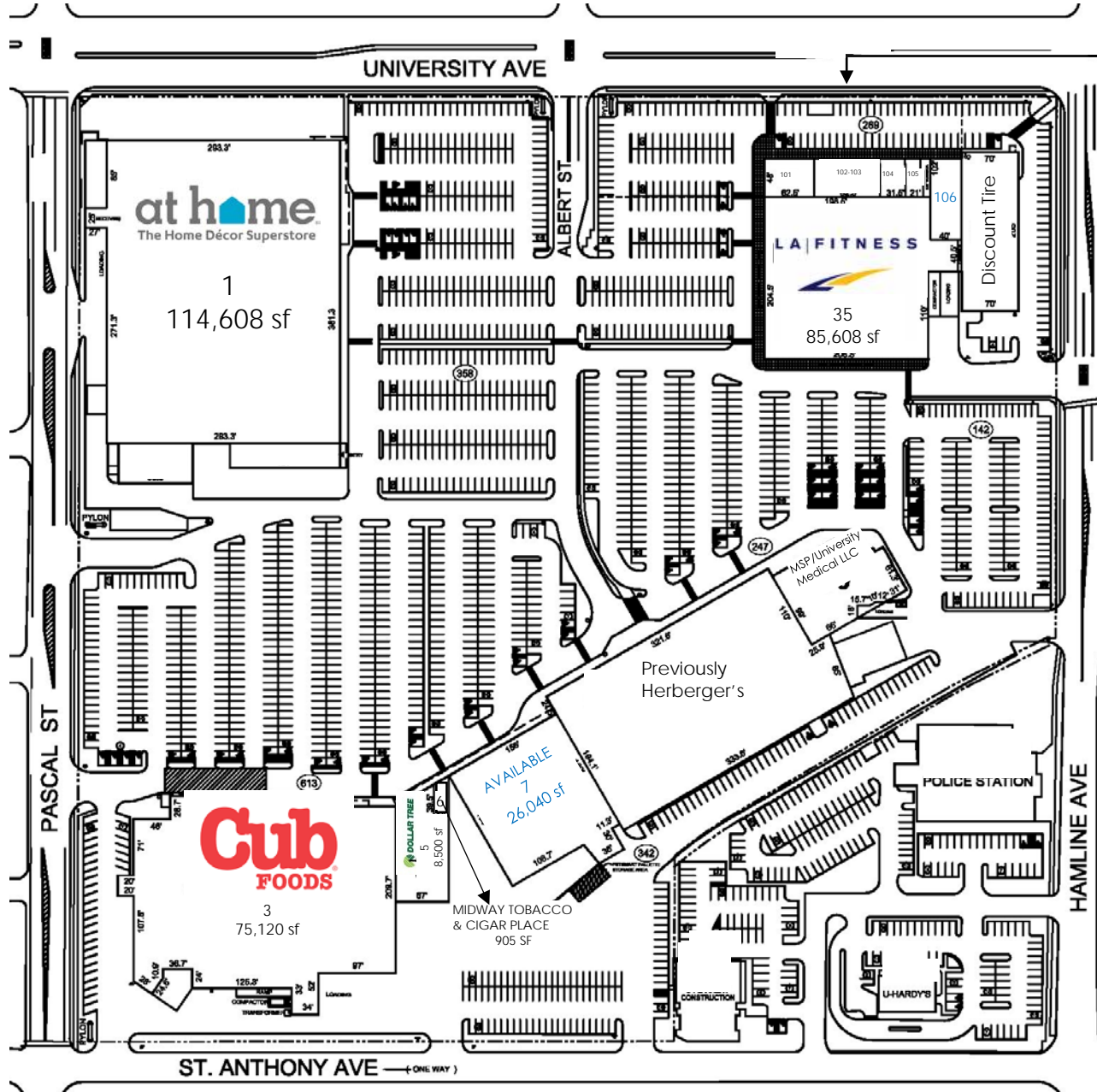

Cajun Kitchen	T-Mobile	ups	Mother Nature	AVAILABLE
---------------	----------	-----	---------------	-----------

Bays	Tenant	SF
106	AVAILABLE	4,080
105	MOTHER NATURE	1,000
104	THE UPS STORE	1,500
102-103	T-MOBILE	3,926
101	Chase Bank	3,033

Midway MarketPlace
 Site Area 20.28 Acres
 Leaseable Area 324,320 SF
 Parking Stalls 1,148

MIDWAY MARKETPLACE
 1450 UNIVERSITY AVENUE W., ST. PAUL, MN





Contact

Kraus-Anderson

501 South Eighth Street
Minneapolis, MN 55404

www.krausanderson.com

Main 612-332-7281
Fax 952-881-8114



Dan Mossey



O: 612-255-2420

C: 763-438-4751



dan.mossey@krausanderson.com