

# EMPIRE

BUSINESS  
PARK

The Denver Metro area's newest heavy industrial development, strategically located at I-25 and Erie Parkway.

Buildings Delivering Spring 2027!



**NEWMARK**

**Michael Wafer Jr, SIOR**  
Managing Director  
303-260-4407  
[mike.waferjr@nmrk.com](mailto:mike.waferjr@nmrk.com)

**Mike Wafer, SIOR**  
Executive Managing Director  
303-260-4242  
[mike.wafer@nmrk.com](mailto:mike.wafer@nmrk.com)

**Mike Viehmann, SIOR**  
Managing Director  
303-260-4340  
[mike.viehmann@nmrk.com](mailto:mike.viehmann@nmrk.com)

# Empire Business Park

is a modern, master-planned development catering to Industrial uses that require large secured sites for fleet parking and/or outside storage.

The site plan provides for 15,000 SF buildings on 3 +/- acre parcels, but is flexible and can accommodate specific build-to-suits from 5,000 to 75,000 + SF. Phase 1 (Buildings 1 - 4) delivering Spring 2027.

## Prime Location

- Immediate access and visibility to I-25, via Erie Parkway.
- Conveniently service the Denver Metro Area and Northern Colorado.
- Located in Unincorporated Weld County with an Erie, Colorado mailing address, benefiting from low sales tax rates and flexible zoning.
- Low Property Taxes - Current mill levy is 96.5, no additional metro district.
- Located in a Weld County Opportunity Zone.
- Significant planned new development for the corridor, such as the I-25 Erie Gateway project North of this site, which will encompass 1,280 acres of regionally scaled mixed-use development.

## Park Features

- High-image new construction buildings with oversized drive-in doors, clearstory windows, LED lighting, sprinklers and many other modern features. Fenced sites with significant yard space.
- Permissible I-2 Industrial zoning allowing for most manufacturing, distribution, automotive and outside storage uses.
- On-site property management.
- Build-to-suit options available.



# Site Plan

## Phase 1: Spec Buildings Delivering Spring 2027

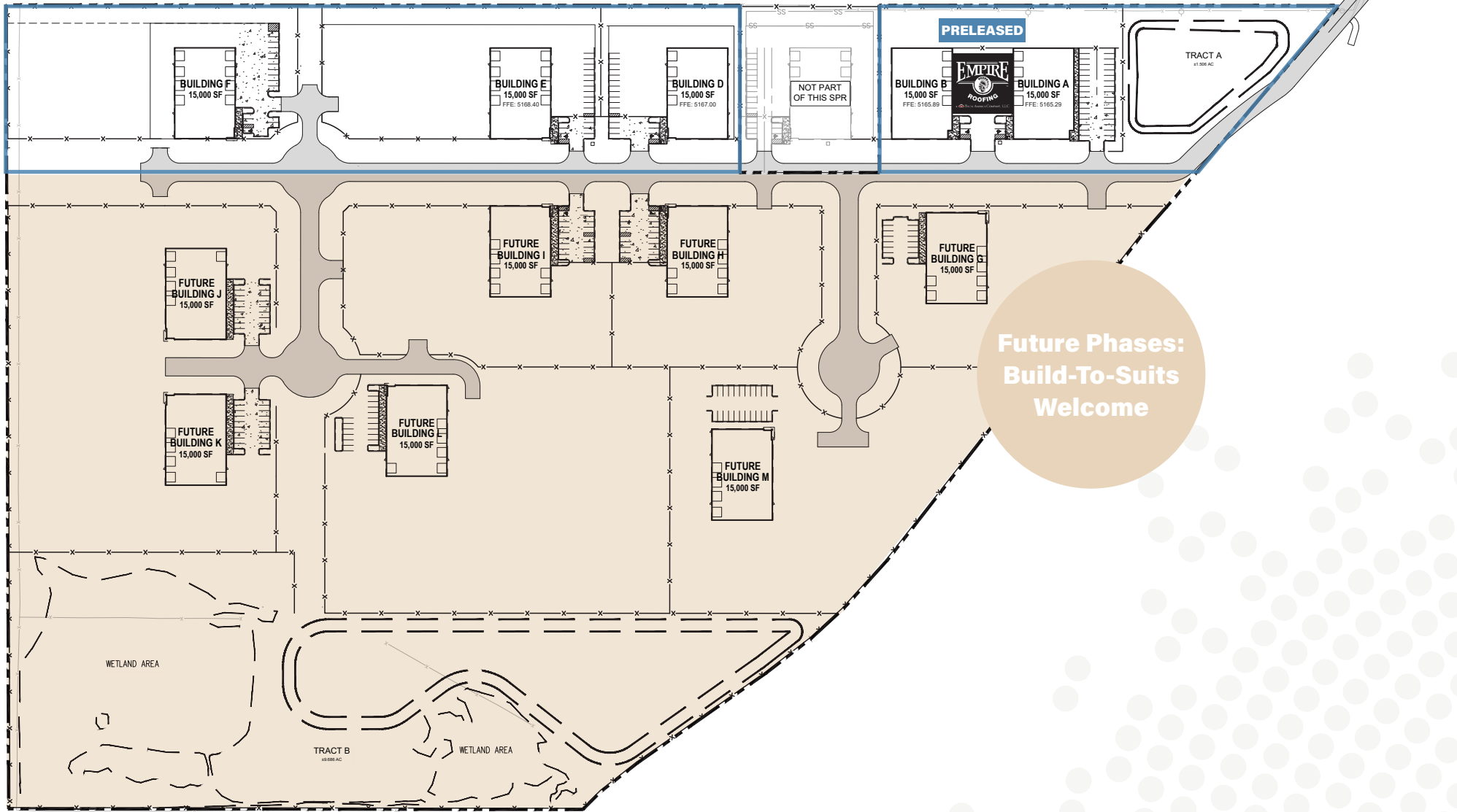

# Location Aerial



**Michael Wafer Jr, SIOR**  
Managing Director  
303-260-4407  
[mike.waferjr@nmrk.com](mailto:mike.waferjr@nmrk.com)

**Mike Wafer, SIOR**  
Executive Managing Director  
303-260-4242  
[mike.wafer@nmrk.com](mailto:mike.wafer@nmrk.com)

**Mike Viehmann, SIOR**  
Managing Director  
303-260-4340  
[mike.viehmann@nmrk.com](mailto:mike.viehmann@nmrk.com)



The information contained herein has been obtained from sources deemed reliable but has not been verified and no guarantee, warranty or representation, either express or implied, is made with respect to such information. Terms of sale or lease and availability are subject to change or withdrawal without notice.