

HIGH BAY NEW CONSTRUCTION

315

GREEN STREET

WRENTHAM, MA

50,000 - 105,450 RSF CLASS A WAREHOUSE



IMMEDIATE ACCESS TO I-495

INTERSTATE  
495

EXIT 38

WRENTHAM VILLAGE  
PREMIUM OUTLETS  
A SIMON CENTER

Lincoln

# NEW CONSTRUCTION • 176,800 RSF CLASS A WAREHOUSE

## BUILDING SPECIFICATIONS

ADDRESS	315 Green Street, Wrentham, MA 02093
SITE AREA	34.48 Acres
RENTABLE AREA	176,800 RSF
CLEAR HEIGHT	32'
YEAR BUILT	2024
LOADING	24 docks; 9'x10', manually operated and include mechanical levelers of 35,000 lbs. Vison panels, dock seals, bumpers and dock lights 1 drive-in door; 12'x14' and electrically operated
COLUMN SPACING	50'x50' (typical)
BUILDING DIMENSIONS	680'x260'
TRUCK COURT DEPTH	130'
BUILDING DEPTH	260'
SPEED BAY SIZE	60'
TRAILER STORAGE	33 spaces
PARKING	113 spaces
FLOOR	7" thick floor slab with Ashford Formula sealer/hardener
ROOF	White TPO
WINDOWS	16 4'x8' clerestory windows above truck doors
HEATING	Roof-mounted gas-fired units

## BUILDING SYSTEMS & UTILITIES

POWER	3,000 amp electrical service, 277/480V
FIRE PROTECTION	ESFR suppression system with ESFR Heads Diesel fire pump
LIGHTING	LED sensor lighting 30 FC at 36" AFF
WATER & SEWER	Town of Wrentham, soil absorption waste system
ELECTRIC	National Grid



315

GREEN STREET  
WRENTHAM, MA

# STATE-OF-THE-ART LOGISTICS & DISTRIBUTION FACILITY



## LOADING

**24** Docks  
**1** Drive-in Doors

## COLUMN SPACING

**50' x 50'**

## CLEAR HEIGHT

**32'**

## FLEXIBLE PARKING

**113** Employee Parking Spaces  
**33** Trailer Parking Spaces



**315**

**GREEN STREET**  
WRENTHAM, MA

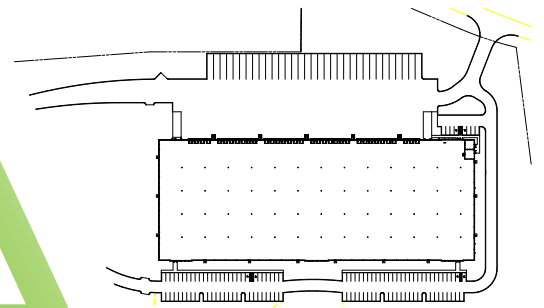



# SPACE OVERVIEW

**SPEC SUITE • 2,500 SF**

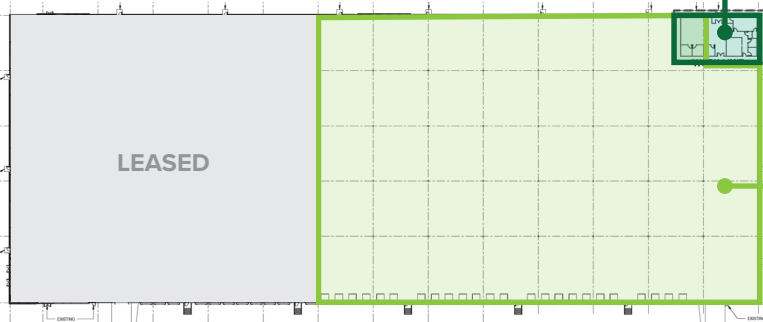

**WAREHOUSE • 24 DOCKS  
1 DRIVE-IN DOOR**

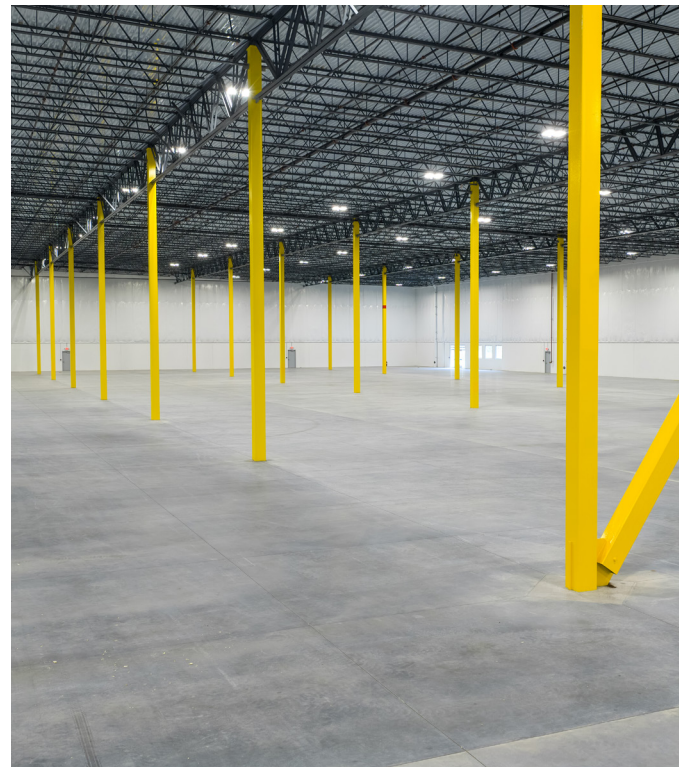

# ADDITIONAL PHOTOS



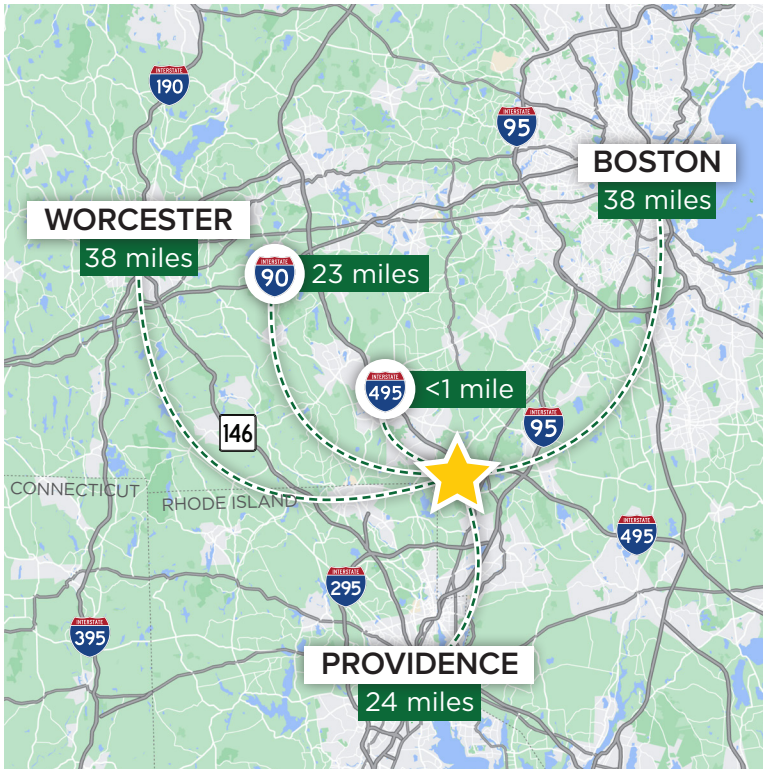

# SUPERIOR REGIONAL ACCESS

IN GREATER BOSTON'S PREMIER INDUSTRIAL CORRIDOR

## STRONG EMPLOYMENT BASE

HIGH CONCENTRATION OF LABOR WITHIN 10 MILES

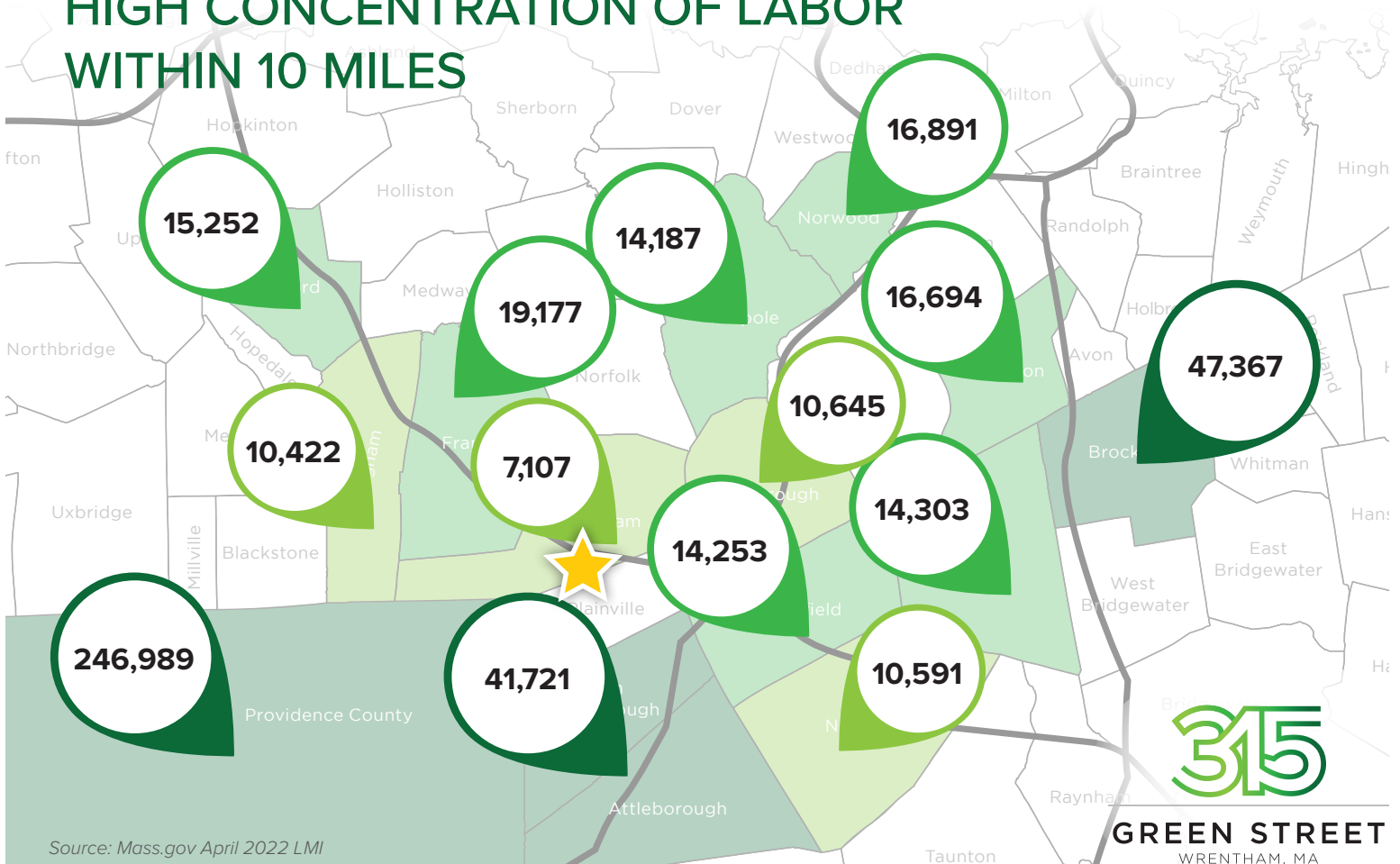

Source: Mass.gov April 2022 LMI



# CORPORATE NEIGHBORS



Exit 43

**ThermoFisher**  
SCIENTIFIC



Exit 41



Exit 38



**DELLEMC** **Stannah**

Exit 33A

**amazon**

Exit 27

**wayfair**



pitney bowes

**Lincoln**

**ELLISON PATTEN**  
Senior Vice President  
617.951.4136  
epatten@lpc.com

**MIKE OGASAPIAN, SIOR**  
Senior Vice President  
617.951.4132  
michael.ogasapian@lpc.com



**GREEN STREET**  
WRENTHAM, MA