

For Lease

±12,400 SF -
±206,458 SF
Warehouse /
Manufacturing
Space Available

➤➤ **NEW OWNERSHIP** with major improvements underway



STRONG INFILL LOCATION

NEW HVAC

HEAVY POWER

LED LIGHTING

ZONED A-2



LOGISTICS CENTER

625 S 27th Avenue, Phoenix, AZ

Casey Koziol

Associate
+1 602 459 2497
casey.koziol@colliers.com

Payson MacWilliam

Vice Chair
+1 602 222 5060
payson.macwilliam@colliers.com

Don MacWilliam, SIOR

Vice Chair
+1 602 222 5059
don.macwilliam@colliers.com



Property Highlights

12,400 - 206,458 SF available

- » **Building Size:** ±850,000 SF
- » **Available Sizes:**
 - 44,000 SF (Suite 118A)
 - 162,458 SF (Suite 115A)*

**can be demised down to 62,420 SF - 100,019 SF*

 - 206,458 SF (combined) — Move-in ready
 - 12,400 SF (Suite 121)
- » **22' Clear Height**
- » **A-2 Zoning, City of Phoenix**
- » **LED Lighting**
- » **100% HVAC**
- » **Heavy Power Available**
up to 3,000 AMPS
- » **Natural Gas** on-site
- » **Fire Sprinklers**
- » **Fully Fenced & Secure**
with on-site **Security**
- » **Drive-in Ramps Available**
- » **Major Improvements Completed**

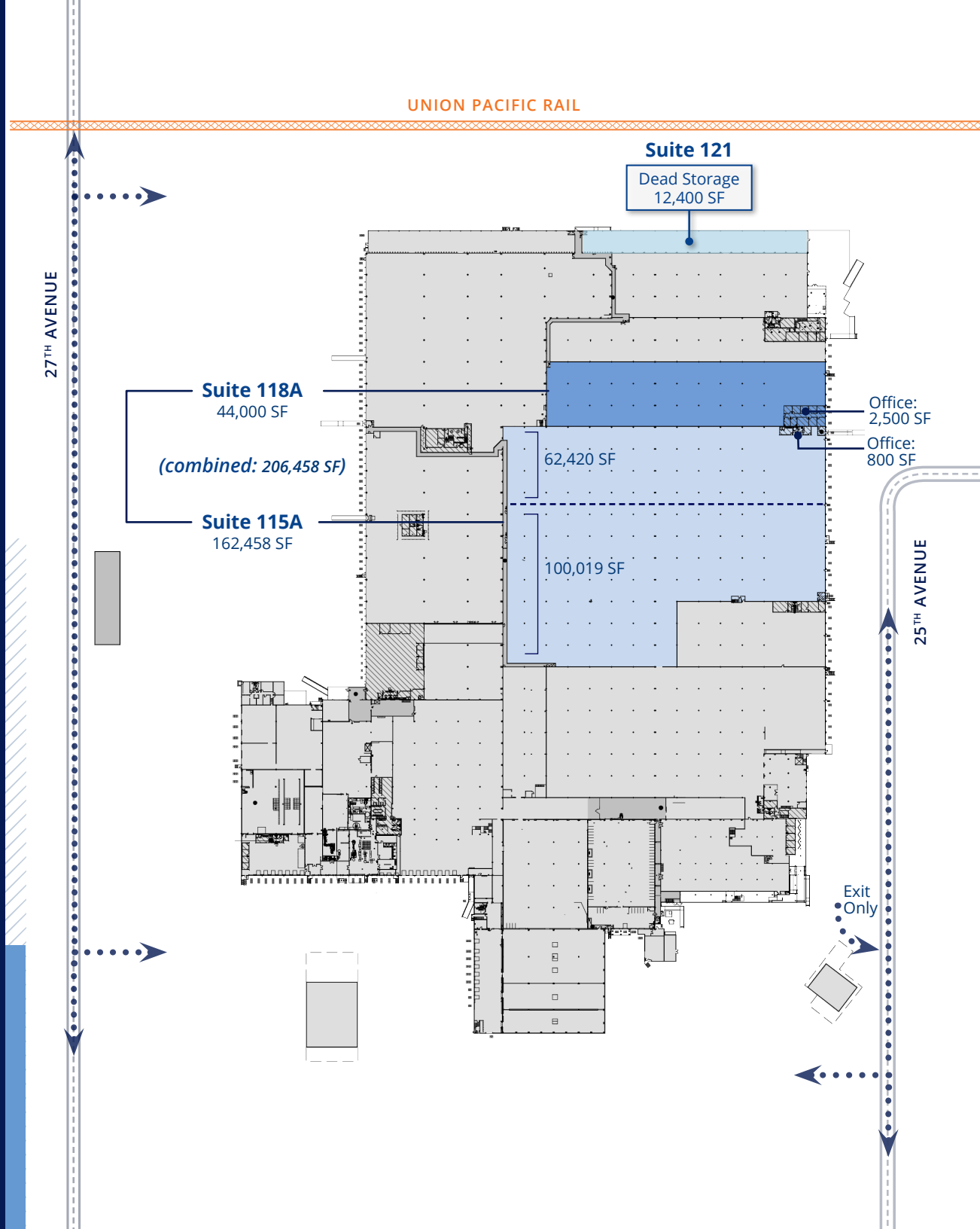

Suite 115-A

- » **Size:** 162,458 SF
- » **Docks:** Thirteen (13)
- » **Office:** 800 SF
- » **Power:** up to 3,000 AMPs
- » **Asking Rate:** \$0.75/SF NNN with \$0.15 opex
- » **Move-in Ready**

Suite 118-A

- » **Size:** 44,000 SF
- » **Docks:** Four (4)
- » **Office:** 2,500 SF
- » **Power:** up to 3,000 AMPs
- » **Asking Rate:** \$0.80/SF NNN with \$0.15 opex
- » **Move-in Ready**

*can be demised down to 60k-100k SF:



Suites Combined



Size:
206,458 SF



Office:
3,300 SF



Docks:
17



Power:
Up to
3,000 AMPs



MINUTES TO I-17 AND I-10

MIDTOWN

DOWNTOWN PHOENIX

AVAILABLE FOR LEASE

UNION PACIFIC RAIL

VAN BUREN STREET

27TH AVENUE

BUCKEYE ROAD

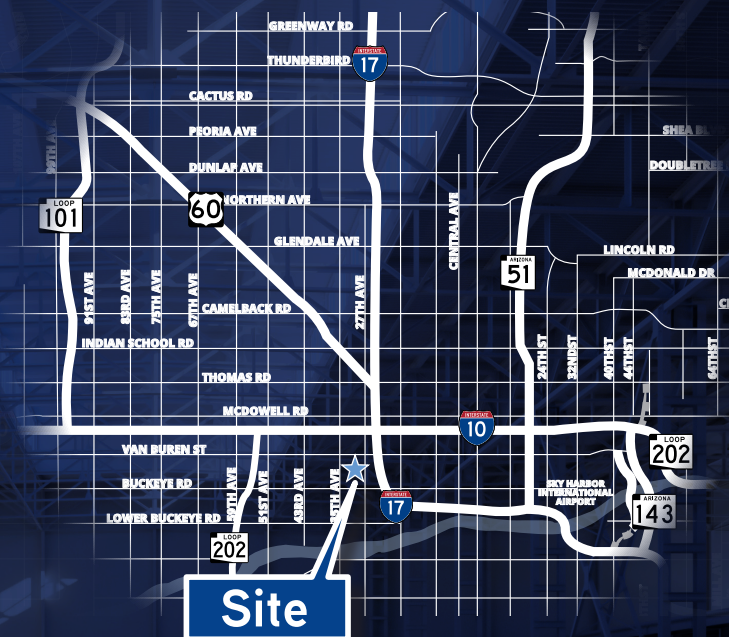

Site

 1.4 miles	 0.5 miles	 4.2 miles
 10 miles	 2.7 miles	 5.2 miles

For more information, contact:

Casey Koziol
Associate
+1 602 459 2497
casey.koziol@colliers.com

Payson MacWilliam
Vice Chair
+1 602 222 5060
payson.macwilliam@colliers.com

Don MacWilliam, SIOR
Vice Chair
+1 602 222 5059
don.macwilliam@colliers.com

Colliers
2390 E Camelback Rd, Ste 100
Phoenix, AZ 85016
www.colliers.com/arizona



This document has been prepared by Colliers for advertising and general information only. Colliers makes no guarantees, representations or warranties of any kind, expressed or implied, regarding the information including, but not limited to, warranties of content, accuracy and reliability. Any interested party should undertake their own inquiries as to the accuracy of the information. Colliers excludes unequivocally all inferred or implied terms, conditions and warranties arising out of this document and excludes all liability for loss and damages arising there from. This publication is the copyrighted property of Colliers and /or its licensor(s). © 2026. All rights reserved. This communication is not intended to cause or induce breach of an existing listing agreement. Colliers International AZ, LLC.