

INDUSTRIAL WAREHOUSE WITH PARKING ON LARGE LOT

AVAILABLE

1211 N LORING STREET
PORTLAND, OR 97227

+/-21,650 RSF SHELL
Freestanding Industrial Building
with Recent Upgrades

FOR SALE: \$3,400,000

RATE: \$0.70/RSF

JOSH BEAN, SIOR

josh@ecacre.com

BRIAN HANSON, MREF

brian@ecacre.com

503.205.0610

ETHOS COMMERCIAL ADVISORS LLC
1111 NE FLANDERS STREET, SUITE 201 | PORTLAND, OREGON 97232

These marketing materials do not constitute an offer to sell or lease, and do not constitute or contain promises, representations or warranties of any kind. The information in these marketing materials may contain approximations and images for illustration purposes. The owner, broker and their agents assume no risk or liability for inaccuracies, errors or omissions in these marketing materials. The terms and conditions of any transaction with respect to the property shall be contained exclusively in a written purchase and sale agreement or lease between the owner and the purchaser or tenant. Prospective purchasers or tenants should perform their own inspections of the property to verify its condition, permitted uses, and all other characteristics. | ©2026 Ethos Commercial Advisors LLC. All Rights Reserved. | 5.29.26



LICENSED IN OREGON, WASHINGTON, AND TEXAS

LOCATION

1211 N Loring is located in Portland's desirable close-in Northeast industrial submarket. With close proximity to downtown Portland, Albina MAX station, and all major arterials (I-5, I-84, and I-405), 1211 N Loring provides easy access throughout the entire metro area. The property is zoned Heavy Industrial (IH) and situated within an Enterprise Zone. The property allows for a wide array of uses including manufacturing, warehousing and freight movement, wholesale sales, and other industrial services.

HIGHLIGHTS

- 14' bottom of truss, 21' between – +/-29' clear height
- 1 grade loading door (15' W x 13.5' H)
- 4 dock high doors (at 39" high) with load levelers
- 200a 120/208v 3-phase power
- Fully sprinklered
- Concrete tilt-up construction
- New roof (2017)
- Built 1956
- Zoned Heavy Industrial (IH)
- Portland Enterprise Zone Program
- New LED warehouse lighting

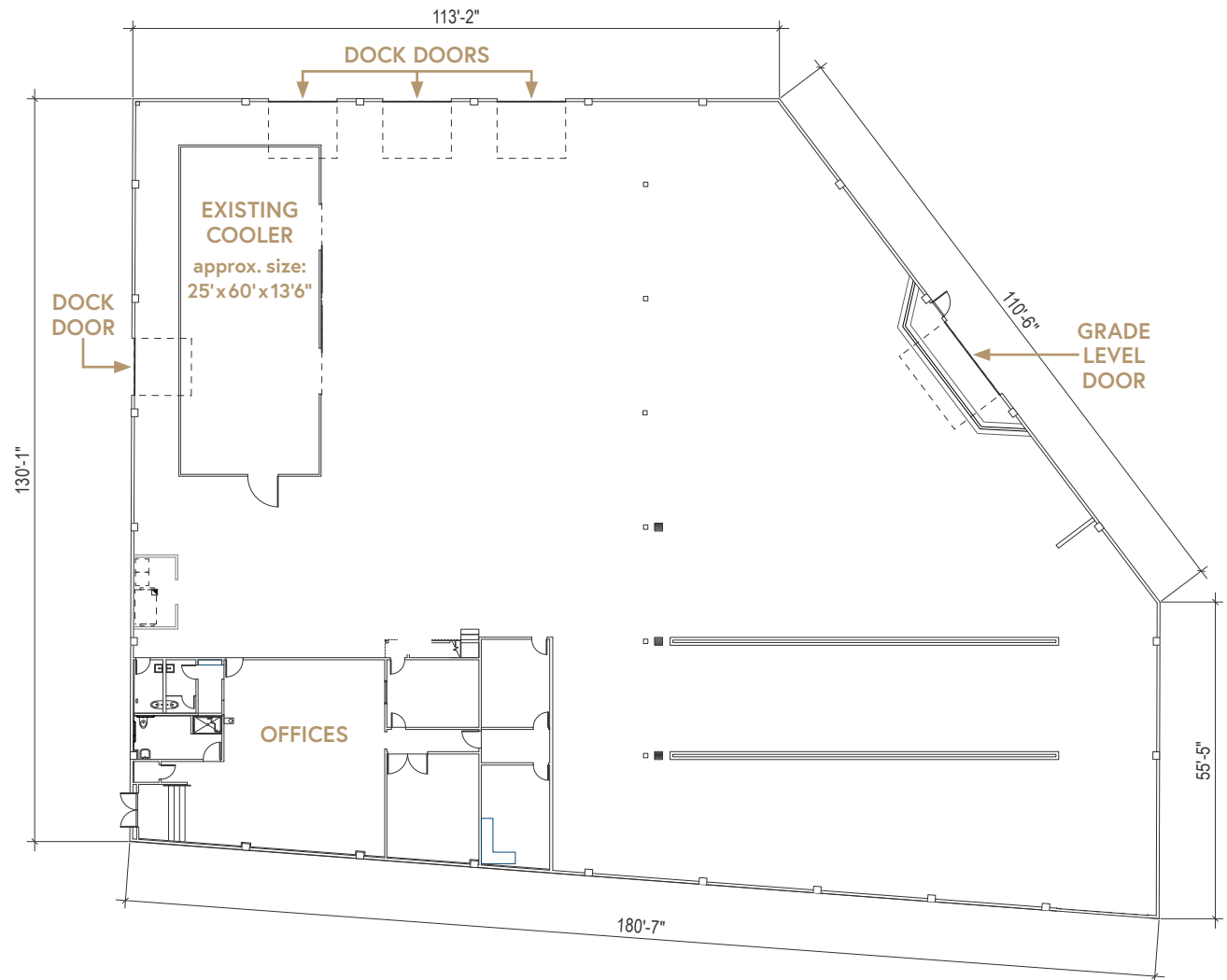

THIS DRAWING IS NOT TO SCALE AND IS FOR ILLUSTRATIVE PURPOSES ONLY.

BUILDING: +/-21,650 RSF **LOT:** +/-0.78 ACRES (2 Tax Lots)

MANUFACTURING / STORAGE: +/-18,873 RSF

**OFFICE, CONFERENCE ROOM, AND
KITCHENETTE / BREAKROOM:** +/-3,077 RSF (2-Story)



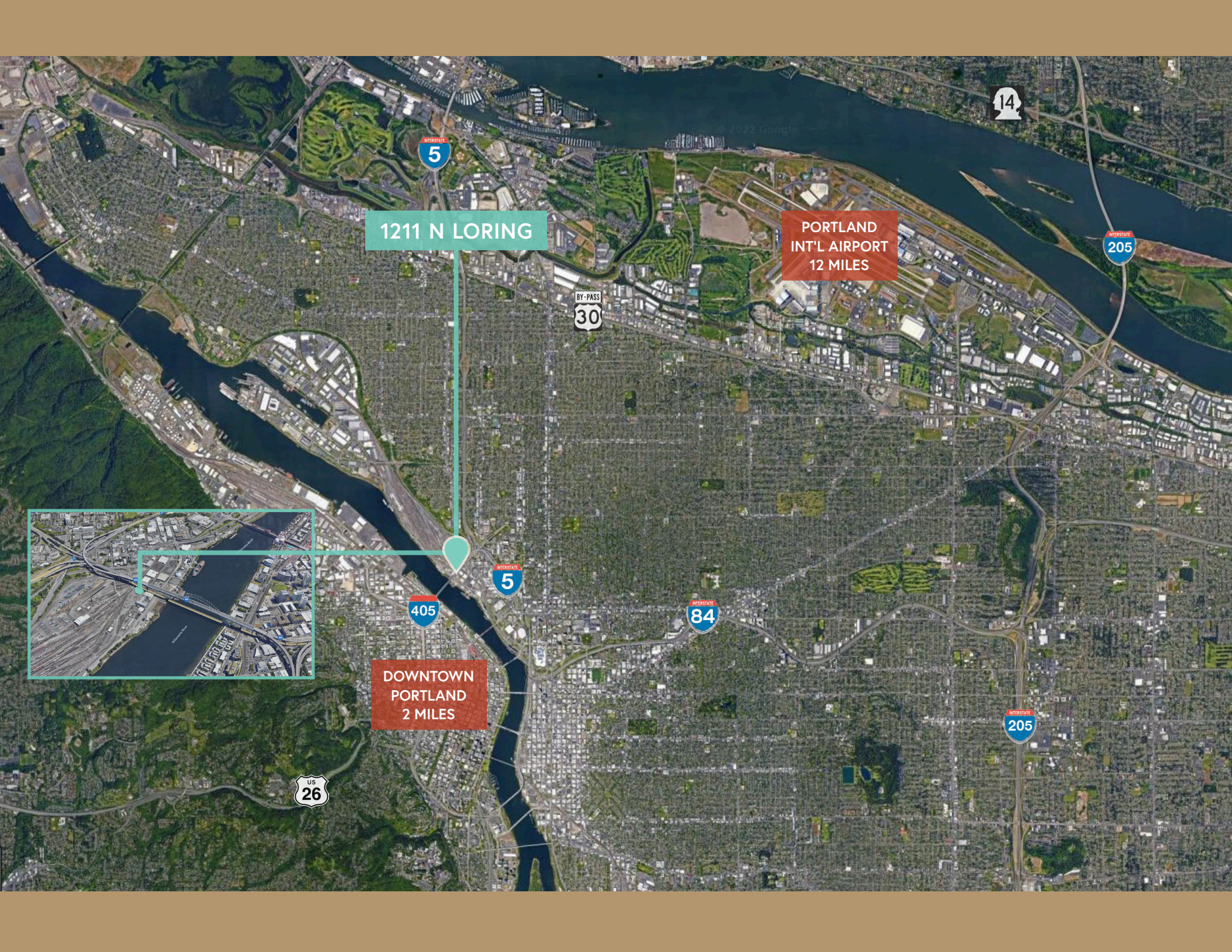

1211 N LORING

PORTLAND
INT'L AIRPORT
12 MILES



DOWNTOWN
PORTLAND
2 MILES

